

UNITED STATES
DEPARTMENT OF THE INTERIOR
GEOLOGICAL SURVEY

NM OIL & GAS COMMISSION
Artesia, NM 88210

30-005-61515

C/SF

APPLICATION FOR PERMIT TO DRILL, DEEPEN, OR PLUG BACK

1a. TYPE OF WORK
 DRILL DEEPEN PLUG BACK
 b. TYPE OF WELL
 OIL WELL GAS WELL OTHER
 SINGLE ZONE MULTIPLE ZONE

2. NAME OF OPERATOR
 MESA PETROLEUM CO. ✓

3. ADDRESS OF OPERATOR
 1000 VAUGHN BUILDING/MIDLAND, TEXAS 79701-4493

4. LOCATION OF WELL (Report location clearly and in accordance with any State requirements*)
 At surface 1980' FNL & 660' FEL SE 1/4 NE 1/4
 At proposed prod. zone SAME

14. DISTANCE IN MILES AND DIRECTION FROM NEAREST TOWN OR POST OFFICE*
 10 MILES NORTH/NORTHEAST OF ROSWELL, NEW MEXICO

10. DISTANCE FROM PROPOSED* LOCATION TO NEAREST PROPERTY OR LEASE LINE, FT. (Also to nearest drlg. unit line, if any) 660'/660'

18. DISTANCE FROM PROPOSED LOCATION* TO NEAREST WELL, DRILLING, COMPLETED, OR APPLIED FOR, ON THIS LEASE, FT. 1320'

21. ELEVATIONS (Show whether DF, RT, GR, etc.)
 3604' GR

23. PROPOSED CASING AND CEMENTING PROGRAM

SIZE OF HOLE	SIZE OF CASING	WEIGHT PER FOOT	SETTING DEPTH	QUANTITY OF CEMENT
17 1/2"	13 3/8"	48#	900'	SURFACE
11" or 12 1/4"	8 5/8"	24#	1600'	ISOLATE WATER, OIL & GAS
7 7/8"	4 1/2"	10.5#	4100'	COVER ALL PAY

Propose to drill 17 1/2" hole to approximately 900' to set 13 3/8" surface casing and cement to surface. Will reduce hole to 11" or 12 1/4" and drill to approximately 1600' to set 8 5/8" casing. Will nipple up RAM type BOPs, reduce hole to 7 7/8" and drill to total depth. Drilling medium will be air, foam, or mud as required.

RECEIVED
MAR 2 1982

GAS SALES ARE DEDICATED.

XC: MMS (6), TLS, GEN RCDS, ACCTG, MEC, LAND, PARTNERS, REM, ROSWELL, FILE

IN ABOVE SPACE DESCRIBE PROPOSED PROGRAM: If proposal is to deepen or plug back, give data on present productive zone and proposed new productive zone. If proposal is to drill or deepen directionally, give pertinent data on subsurface locations and measured and true vertical depths. Give blowout preventer program, if any.

24. SIGNED R. E. Mathew TITLE REGULATORY COORDINATOR DATE MARCH 1, 1982

(This space for Federal or State office use)

PERMIT NO. _____ APPROVAL DATE _____

APPROVED BY _____ TITLE _____ DATE 4-1-82

CONDITIONS OF APPROVAL, IF ANY:

*See Instructions On Reverse Side

Pointed ID-1
API + NL Book
4-9-82

Post ID-2
4-1-82
EXP. 1-1-82

A. Leases must be from the outer boundaries of the location.

Operator Mesa Petroleum Co.		Lease Bitter Lake Federal		Well No. #3
Unit Letter H	Section 6	Township 9 South	Range 25 East	County Chaves
Actual Postage Location of Well: 1980 feet from the North line and 660 feet from the East line				
Ground Level Elev. 3604	Producing Formation ABO	Pool UNDESIGNATED <i>pl</i>	Dedicated Acreage: NE/4 160 Acres	

- Outline the acreage dedicated to the subject well by colored pencil or hachure marks on the plat below.
- If more than one lease is dedicated to the well, outline each and identify the ownership thereof (both as to working interest and royalty).
- If more than one lease of different ownership is dedicated to the well, have the interests of all owners been consolidated by communitization, unitization, force-pooling, etc?

Yes No If answer is "yes," type of consolidation _____

If answer is "no," list the owners and tract descriptions which have actually been consolidated. (Use reverse side of this form if necessary.) _____

No allowable will be assigned to the well until all interests have been consolidated (by communitization, unitization, forced-pooling, or otherwise) or until a non-standard unit, eliminating such interests, has been approved by the Division.

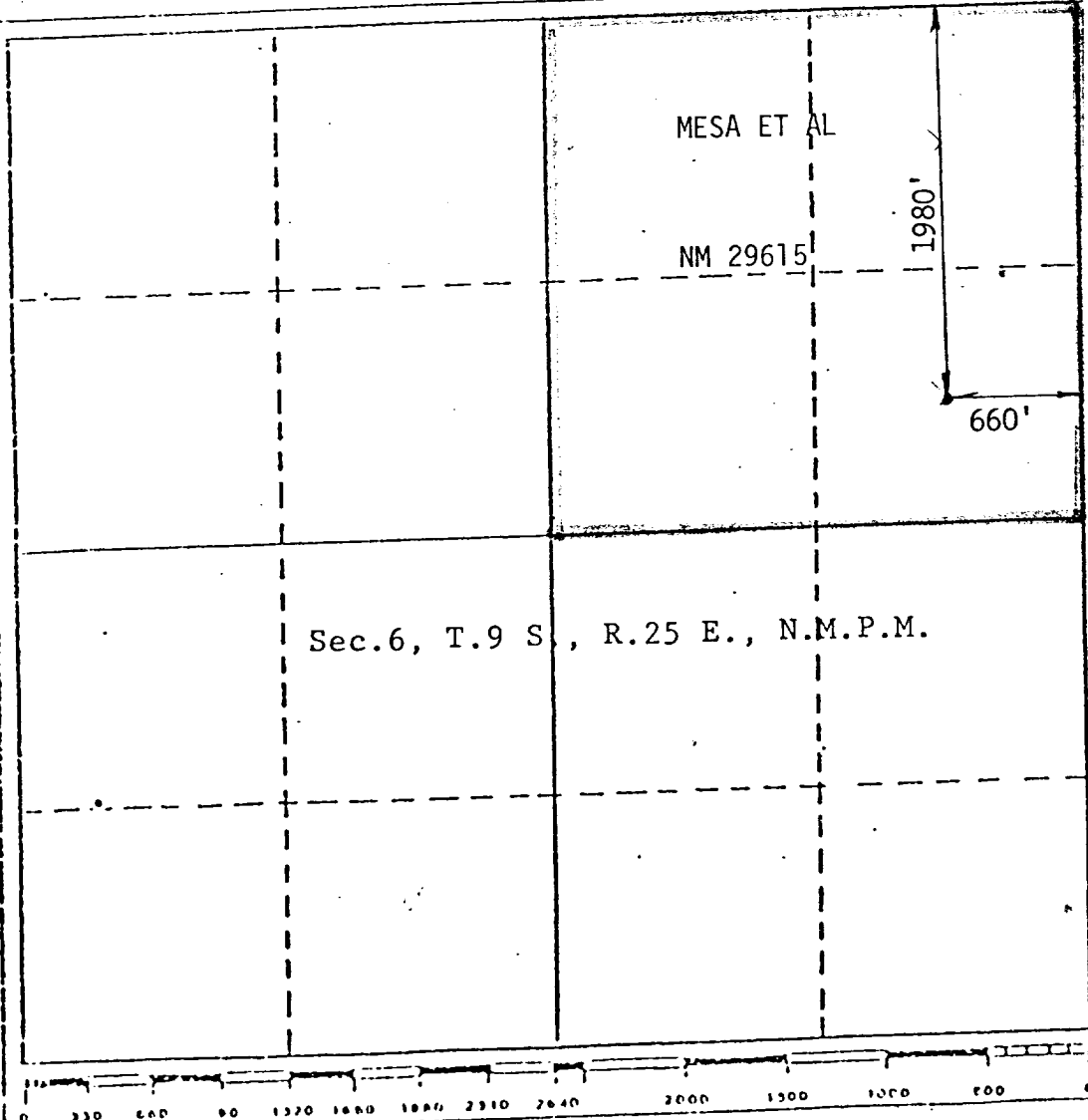

CERTIFICATION

I hereby certify that the information contained herein is true and complete to the best of my knowledge and belief.

R. E. Mathis

Name	R. E. MATHIS
Position	REGULATORY COORDINATOR
Company	MESA PETROLEUM CO.
Date	MARCH 1, 1982

I hereby certify that the well location shown on this plat was plotted from field notes of actual surveys made by me or under my supervision, and that the same is true and correct to the best of my knowledge and belief.

Date Surveyed: February 26, 1982

Registered Professional Engineer and/or Land Surveyor: 8280

John B. Jaquess

Certificate No. 6280

JOHN B. JAQUESS
REGISTERED PROFESSIONAL ENGINEER & LAND SURVEYOR

APPLICATION FOR PERMIT TO DRILL

MESA PETROLEUM CO.
BITTER LAKE FEDERAL #3
1980' FNL & 660' FEL, SEC 6, T9S, R25E
CHAVES COUNTY, NEW MEXICO

LEASE NO. NM-29615

In conjunction with Form 9331-C, Application For Permit to Drill subject well, the following additional information is provided:

1. Applicable portions of the GENERAL REQUIREMENTS FOR OIL AND GAS OPERATIONS ON FEDERAL LEASES, Roswell District, Geological Survey of September 1, 1980 will be adhered to.
2. Geological markers are estimated as follows:

SEVEN RIVERS	Surface
SAN ANDRES	380
GLORIETA	1400
TUBB	2820
ABO	3530
3. Hydrocarbon bearing strata may occur in the Abo formation(s). No fresh water is expected to be encountered below 900'.
4. The Casing and Blowout Preventer Program will be determined by hole conditions as encountered. See Exhibit VI. Anticipate drilling with air or foam using ram type preventer and rotating head for well control. The 13 3/8" casing will be set at approximately 900' to protect any fresh water zones and cemented to the surface. The 8 5/8" casing will be set at approximately 1600' if water zones have been encountered or omitted if not and ram type preventers installed. Sufficient amounts and kinds of cement would be used to ensure any water, gas, or oil zones encountered are isolated and shut off down to the casing point if run. The 4 1/2" production casing will be set at total depth or shallower depending upon the depth of the deepest commercial hydrocarbon bearing strata encountered.
5. No drill stem test or coring program is planned. The logging program may consist of a GR-CNL from surface total depth and FDC from casing point to total depth.
6. Anticipated drilling time is ten days with completion operations to follow as soon as a completion unit is available.

Blow-out Preventers hydril and choke manifold are all 900 Series

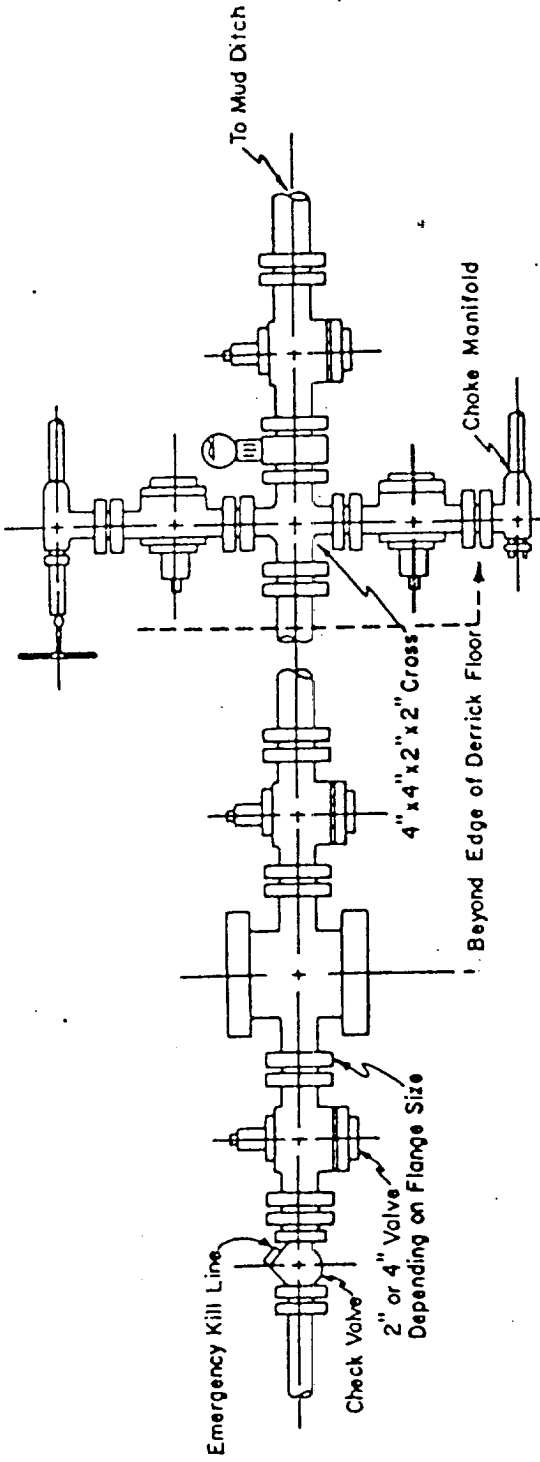

3,000 PSI WORKING PRESSURE
KILL, CHOKE, AND FILL CONNECTIONS

DETAIL OF 4" FLOW LINE CHOKE ASSEMBLY

Minimum assembly for 3,000 PSI working pressure will consist of three preventers.
The bottom and middle preventers may be Cameron.

NOTE: HYDRIL not installed on shallow-low pressure wells.
RAM type BOPs are API 10" X 3000 PSI

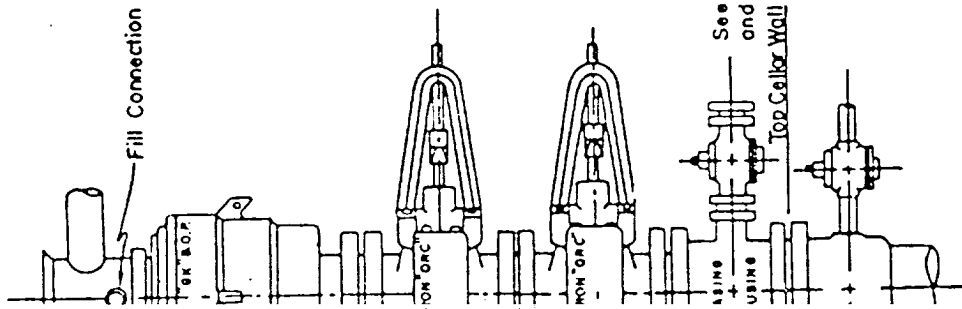

WORKING PRESSURE
ENTER HOOK-UP



E X H I B I T

V I