

JUN 16 1983

O. C. D.
ARTESIA, OFFICE

50-015-24474

Form C-101
Revised 10-1-78

NO. OF COPIES RECEIVED	
DISTRIBUTION	
SANTA FE	
FILE	
U.S.G.S.	
LAND OFFICE	
OPERATOR	

5A. Indicate Type of Lease
STATE ☒ FEE ☐

5. State Oil & Gas Lease No.

APPLICATION FOR PERMIT TO DRILL, DEEPEN, OR PLUG BACK

1a. Type of Work DRILL <input checked="" type="checkbox"/> DEEPEN <input type="checkbox"/> PLUG BACK <input type="checkbox"/>		7. Unit Agreement Name
b. Type of Well OIL WELL <input checked="" type="checkbox"/> GAS WELL <input type="checkbox"/> OTHER <input type="checkbox"/> SINGLE ZONE <input type="checkbox"/> MULTIPLE ZONE <input type="checkbox"/>		8. Farm or Lease Name Hondo Fee
2. Name of Operator Mesa Petroleum Co. ✓		9. Well No. 1
3. Address of Operator P.O. Box 2009 / Amarillo, TX 79189		10. Field and Pool, or Wildcat Unders. Delaware
4. Location of Well UNIT LETTER F LOCATED 1980 FEET FROM THE North LINE AND 1650 FEET FROM THE West LINE OF SEC. 32 TWP. 20S RGE. 28E NMPM		12. County Eddy
19. Proposed Depth 5000'		19A. Formation Delaware
20. Rotary or C.T. Rotary		
21. Elevations (Show whether DF, RT, etc.) 3217.1'	21A. Kind & Status Plug. Bond Blanket	21B. Drilling Contractor TMBR Drilling, Inc.
22. Approx. Date Work will start July 15, 1983		

23. PROPOSED CASING AND CEMENT PROGRAM

SIZE OF HOLE	SIZE OF CASING	WEIGHT PER FOOT	SETTING DEPTH	SACKS OF CEMENT	EST. TOP
17 1/2"	13 3/8"	48#	600	500	Surface
12 or 12 1/4"	8 5/8"	24#	2550 *	600	Circulate
7 7/8"	5 1/2"	14.5#	5000	500	cover all pay

(*or through bottom of Capitan Reef)

Propose to drill 17 1/2" hole with fresh water to approximately 600' and set 13 3/8" surface casing. Will circulate cement to surface; drill 12 or 12 1/4" hole with fresh water to approximately 2550 (bottom of Capitan Reef) and set 8 5/8" casing. Will circulate cement to surface, or at least 150' into surface casing; nipple up 3000 psi BOP's and drill 7 7/8" hole to TD.

APPROVAL VALID FOR 180 DAYS
PERMIT EXPIRES 12-17-83
UNLESS DRILLING UNDERWAY

XC: NMOC-D-A(0+6), CEN RCDS, ACCTG, OPS(FILE), MAT CONT, RES ENG, MIDLAND, HOBBS, PARTNERS

IN ABOVE SPACE DESCRIBE PROPOSED PROGRAM; IF PROPOSAL IS TO DEEPEN OR PLUG BACK, GIVE DATA ON PRESENT PRODUCTIVE ZONE AND PROPOSED NEW PRODU-
TIVE ZONE. GIVE BLOWOUT PREVENTER PROGRAM, IF ANY.

I hereby certify that the information above is true and complete to the best of my knowledge and belief.

Signed R. E. Madris Title Regulatory Coordinator Date June 15, 1983

(This space for State Use)

Original Signed By
Leslie A. Clements
Supervisor District II

APPROVED BY _____ TITLE _____ DATE JUN 17 1983

CONDITIONS OF APPROVAL, IF ANY:

Cement must be circulated to
surface behind 13 3/8" + 8 5/8" casing

NEW MEXICO OIL CONSERVATION COMMISSION
WELL LOCATION AND ACREAGE DEDICATION PLAT

Form O-122
Supersedes O-128
Effective 1-1-85

All distances must be from the outer boundaries of the Section

Mesa Petroleum Company			Arco Hondo Fee		1
F	32	20 South	28 East	Eddy	
1980		north	1650	west	
3217.1'		Delaware	Undesignated Delaware		40

- Outline the acreage dedicated to the subject well by colored pencil or hatchure marks on the plat below.
- If more than one lease is dedicated to the well, outline each and identify the ownership thereof (both as to working interest and royalty).
- If more than one lease of different ownership is dedicated to the well, have the interests of all owners been consolidated by communitization, unitization, force-pooling etc?

Yes ☐ No ☐ If answer is "yes" type of consolidation _____

If answer is "no" list the owners and tract descriptions which have actually been consolidated. (Use reverse side of this form if necessary.) _____

No allowable will be assigned to the well until all interests have been consolidated (by communitization, unitization, forced-pooling, or otherwise) or until a non-standard unit, eliminating such interests, has been approved by the Commission.

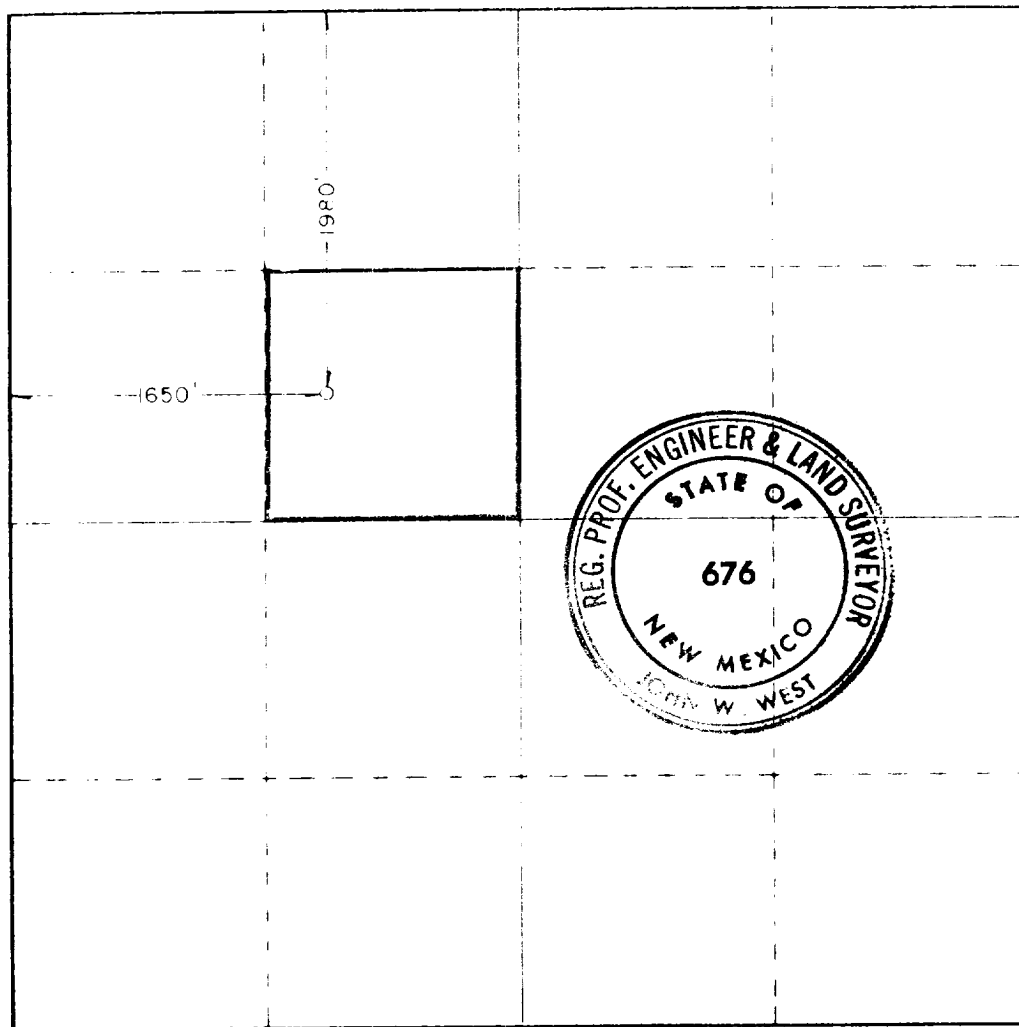

CERTIFICATION

I hereby certify that the information contained herein is true and complete to the best of my knowledge and belief.

R. E. Mathis

R. E. Mathis

Regulatory Coordinator

Mesa Petroleum Co.

June 15, 1983

I hereby certify that the well location shown on this plat was plotted from field notes of actual surveys made by me or under my supervision, and that the same is true and correct to the best of my knowledge and belief.

Jan. 25, 1983

Registered Professional Engineer
and Land Surveyor

John W. West

Certificate No.

John W. West N.M. L.S. 676

330 660 990 1320 1650 1980 2310 2640 2970 3300 3630 3960 4290 4620 4950 5280 5610 5940 6270 6600