

OIL CONSERVATION DIVISION  
P. O. BOX 2088  
SANTA FE, NEW MEXICO 87501

Form C-101  
Revised 10-78  
**30-013-25183**

NO. OF COPIES RECEIVED	
DISTRIBUTION:	
SANTA FE	<input checked="" type="checkbox"/>
FILE	<input checked="" type="checkbox"/>
U.S.G.S.	<input checked="" type="checkbox"/>
LAND OFFICE	<input checked="" type="checkbox"/>
OPERATOR	<input checked="" type="checkbox"/>

5A. Indicate Type of Lease  
STATE ☐ FEE ☒

5. State Oil & Gas Lease No.

APPLICATION FOR PERMIT TO DRILL, DEEPEN, OR PLUG BACK

a. Type of Work

DRILL ☒

DEEPEN ☐

PLUG BACK ☐

b. Type of Well

OIL WELL ☒

GAS WELL ☐

OTHER

SINGLE ZONE ☐

MULTIPLE ZONE ☒

Name of Operator

Santa Fe Exploration Company

Address of Operator

P. O. Box 1136, Roswell, NM 88202-1136

Location of Well

UNIT LETTER 0 LOCATED 2310 FEET FROM THE East LINE

330 FEET FROM THE South LINE OF SEC. 25 TWP. 22S RGE. 27E NMPM

7. Unit Agreement Name

8. Farm or Lease Name

Juan Pablo

9. Well No.

#1

10. Field and Pool, or Wildcat  
Herradura Bend Cherry Canyon

12. County

Eddy

19. Proposed Depth

5800'

19A. Formation

Bone Spring

20. Rotary or C.T.

CT & Rotary

Elevations (Show whether DF, KT, etc.)

3067.4 GL

21A. Kind & Status Plug. Bond

Statewide

21B. Drilling Contractor

Hegwer - LaRue

22. Approx. Date Work will start

May 1, 1985

PROPOSED CASING AND CEMENT PROGRAM

SIZE OF HOLE	SIZE OF CASING	WEIGHT PER FOOT	SETTING DEPTH	SACKS OF CEMENT	EST. TOP
17 1/2"	13-3/8"	54.5#	350'	100	Circ
12 1/4"	8-5/8"	24#	2300'	200	Circ
7-7/8"	5-1/2"	15.5#	5800'	460	

APPROVAL VALID FOR 180 DAYS  
PERMIT EXPIRES 11-2-85  
UNLESS DRILLING UNDERWAY

ABOVE SPACE DESCRIBE PROPOSED PROGRAM: IF PROPOSAL IS TO DEEPEN OR PLUG BACK, GIVE DATA ON PRESENT PRODUCTIVE ZONE AND PROPOSED NEW PRODUCTIVE ZONE. GIVE BLOWOUT PREVENTER PROGRAM, IF ANY.

I hereby certify that the information above is true and complete to the best of my knowledge and belief.

Signed Mike Williams Title Agent Date 5/1/85

(This space for State Use)

Original Signed By

Mike Williams

Oil & Gas Inspector

APPROVED BY

DATE MAY 2 1985

CONDITIONS OF APPROVAL, IF ANY

**NEW MEXICO OIL CONSERVATION COMMISSION  
WELL LOCATION AND ACREAGE DEDICATION PLAT**

Form C-102  
Supersedes C-128  
Effective 1-1-65

All distances must be from the outer boundaries of the Section.

Operator <b>Santa Fe Exploration</b>			Lease <b>Guan Pablo</b>		Well No. <b>1</b>
Unit Letter <b>0</b>	Section <b>25</b>	Township <b>22 South</b>	Range <b>27 East</b>	County <b>Eddy</b>	
Actual Footage Location of Well: <b>330.0</b> feet from the <b>South</b> line and <b>2310.0</b> feet from the <b>East</b> line					
Ground Level Elev. <b>3067.4</b>	Producing Formation <b>Delaware</b>	Pool <b>Herradura Bend Cherry Canyon</b>		Dedicated Acreage: <b>40</b> Acres	

1. Outline the acreage dedicated to the subject well by colored pencil or hatchure marks on the plat below.
2. If more than one lease is dedicated to the well, outline each and identify the ownership thereof (both as to working interest and royalty).
3. If more than one lease of different ownership is dedicated to the well, have the interests of all owners been consolidated by communitization, unitization, force-pooling, etc?

☐ Yes ☐ No If answer is "yes," type of consolidation \_\_\_\_\_

If answer is "no," list the owners and tract descriptions which have actually been consolidated. (Use reverse side of this form if necessary.) \_\_\_\_\_

No allowable will be assigned to the well until all interests have been consolidated (by communitization, unitization, forced-pooling, or otherwise) or until a non-standard unit, eliminating such interests, has been approved by the Commission.

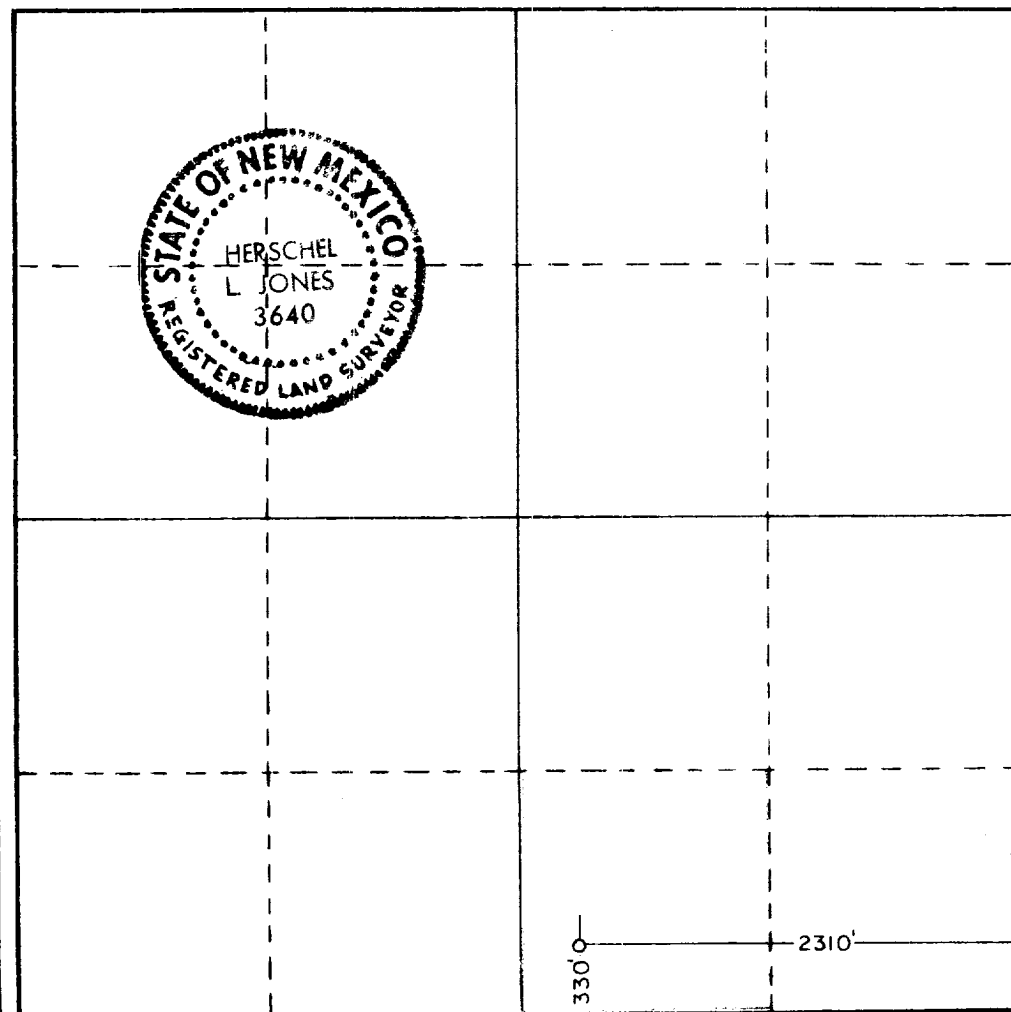

**CERTIFICATION**

I hereby certify that the information contained herein is true and complete to the best of my knowledge and belief.

*Steve L. Simmons*  
Name

Steve L. Simmons

Position

Agent

Company

Santa Fe Exploration Co.

Date

May 1, 1985

I hereby certify that the well location shown on this plat was plotted from field notes of actual surveys made by me or under my supervision, and that the same is true and correct to the best of my knowledge and belief.

Date Surveyed

4/27/85

Registered Professional Engineer and/or Land Surveyor

*Herschel L. Jones*  
Certificate No.

3640

0 330 660 990 1320 1650 1980 2310 2640 2000 1800 1600 1400 1200 1000 800 600 400 200 0

BLOWOUT PREVENTER SKETCH

Santa Fe Exploration Company

JUAN PABLO #1  
2310' FEL & 330' FSL, Sec. 25  
T22S, R27E  
Eddy County, New Mexico

RECEIVED BY

MAY 3 1965

O. C. D.  
ARTESIA, OFFICE

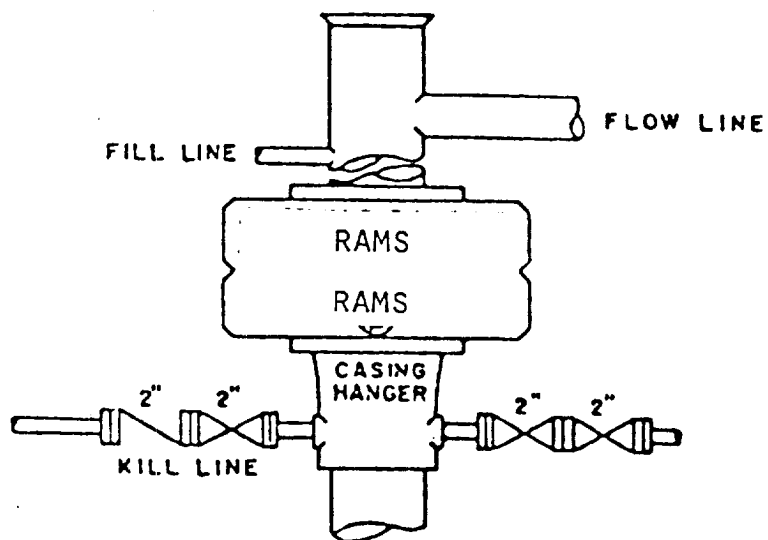

BOP STACK

BOP ARRANGEMENT

JUAN PABLO #1  
2310' FEL & 330' FSL  
Sec. 25, T22S, R27E  
Eddy County, New Mexico

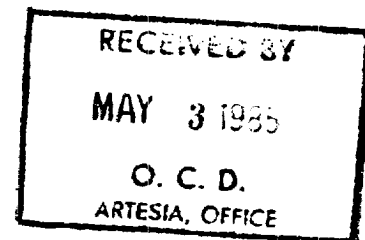

Mud Program:

0-350' Fresh Water  
350 - 2300' Brine Water 10#  
2300 - 5800' Cut Brine Water 9.1#

At TD run mud sweep and circulate for 2 hrs bottoms up.