

811 S. 1st ST.
ARTESIA, NM 88344
UNITED STATES
DEPARTMENT OF THE INTERIOR
BUREAU OF LAND MANAGEMENTSUBMIT IN TRIPLICATE*
(Other instructions
reverse side)FORM APPROVED
OMB NO. 1004-0136
Expires: February 28, 1995

APPLICATION FOR PERMIT TO DRILL OR DEEPEN

1. TYPE OF WORK

DRILL ☒DEEPEN ☐

2. TYPE OF WELL

OIL
WELL ☐GAS
WELL ☒

OTHER

SINGLE
ZONE ☐MULTIPLE
ZONE ☐

3. NAME OF OPERATOR

Santa Fe Energy Resources, Inc.

4. ADDRESS AND TELEPHONE NO.

550 W. Texas, Suite 1330; Midland, Texas 79701

(915) 682-6078

5. LOCATION OF WELL (Report location clearly and in accordance with State requirements)

At surface

(O) ~~773~~ FSL & ~~1980~~ FELAt proposed prod. zone ~~2055~~

6. LEASE DESIGNATION AND SERIAL NO.

NM-070522-A ^R

7. IF INDIAN, ALLOTTEE OR TRIBE NAME

8. UNIT AGREEMENT NAME

9. FARM OR LEASE NAME, WELL NO.

Indian Basin "F" #2

10. API WELL NO.

30-015-28987

11. FIELD AND POOL, OR WILDCAT

Indian Basin-Morrow 78960

12. SEC., T., R., M., or BLK.
AND SURVEY OR AREA

Sec. 25, T-21-S, R-23-E

13. COUNTY OR PARISH

Eddy

14. STATE

New Mexico

15. DISTANCE IN MILES AND DIRECTION FROM NEAREST TOWN OR POST OFFICE*

17 1/2 miles west of Carlsbad, New Mexico

16. DISTANCE FROM PROPOSED*

LOCATION TO NEAREST
PROPERTY OR LEASE LINE, FT.
(Also to nearest drlg. unit line, if any)

1140'

17. DISTANCE FROM PROPOSED LOCATION*

TO NEAREST WELL, DRILLING, COMPLETED,
OR APPLIED FOR, ON THIS LEASE, FT.

1879'

18. PROPOSED DEPTH

9650'

19. NO. OF ACRES ASSIGNED
TO THIS WELL

320

20. ROTARY OR CABLE TOOLS

Rotary

21. ELEVATIONS (Show whether DF, RT, GR, etc.)

3796' GR

Roswell Controlled Water Basin

22. APPROX. DATE WORK WILL START*

May 1, 1996

23.

PROPOSED CASING AND CEMENTING PROGRAM

SIZE OF HOLE	GRADE SIZE OF CASING	WEIGHT PER FOOT	SETTING DEPTH	QUANTITY OF CEMENT
12 1/4"	K-55 9 5/8"	36.0	1200'	575 sx to circulate
8 3/4"	K-55 & L-80 7"	26.0	9650'	680 sx TOC @ 6000'

We propose to drill to a depth sufficient to test the Morrow formation for gas. If productive, 7" casing will be run to TD. If non-productive, the well will be plugged and abandoned in a manner consistent with Federal Regulations. Specific programs as per Onshore Oil and Gas Order No. 1 are outlined in the following attachments:

Drilling Program

Exhibit A - Operations Plan

Exhibit B - BOP and Choke Manifold

Exhibit C - Drilling Fluid Program

Exhibit D - Auxiliary Equipment

Exhibit E - Topo Map at Location

Exhibit F - Map Showing Existing Wells

Exhibit F (A) - Plat of Location

Exhibit G - Well Site Layout

Surface Use and Operations Plan

H2S Drilling Operations Plan

Santa Fe Energy Resources, Inc. accepts all applicable terms, conditions, stipulations and restrictions concerning operations conducted on the leased land or portion thereof, as described above.

Bond Coverage: Blanket Bond

BLM Bond File No.: MT 0750

IN ABOVE SPACE DESCRIBE PROPOSED PROGRAM: If proposal is to deepen, give data on present productive zone and proposed new productive zone. If proposal is to drill or deepen directionally, give pertinent data on subsurface locations and measured and true vertical depths. Give blowout preventer program, if any.

24.

SIGNED

James P. Phil "Phil" Hinton

TITLE Agent for Santa Fe Energy

DATE

3-28-96

(This space for Federal or State office use)

PERMIT NO.

APPROVAL DATE

Application approval does not warrant or certify that the applicant holds legal or equitable title to those rights in the subject lease which would entitle the applicant to conduct operations thereon.

CONDITIONS OF APPROVAL, IF ANY:

(ORIG. SGD.) RICHARD L. MANUS

Area Manager

APPROVED BY

TITLE

DATE

5-16-96

*See Instructions On Reverse Side

Title 18 U.S.C. Section 1001, makes it a crime for any person knowingly and willfully to make to any department or agency of the United States any false, fictitious or fraudulent statements or representations as to any matter within its jurisdiction.

DISTRICT I
P. O. Box 1980
Hobbs, NM 88241-1980

State of New Mexico
Energy, Minerals, and Natural Resources Department

Form O-102
Revised 02-10-94
Instructions on back

DISTRICT II
P. O. Drawer DD
Artesia, NM 88211-0719

OIL CONSERVATION DIVISION
P. O. Box 2088
Santa Fe, New Mexico 87504-2088

Submit to the Appropriate
District Office
State Lease - 4 copies
Fee Lease - 3 copies

☒ AMENDED REPORT

DISTRICT IV
P. O. Box 2088
Santa Fe, NM 87507-2088

WELL LOCATION AND ACREAGE DEDICATION PLAT

1 API Number 30-015-28987		2 Pool Code 78960		3 Pool Name Indian Basin, Morrow		
4 Property Code		5 Property Name INDIAN BASIN 'F'			6 Well Number 2	
7 OGRID No.		8 Operator Name SANTA FE ENERGY RESOURCES, INC.			9 Elevation 3797'	

10 SURFACE LOCATION

UL or lot no. 0	Section 25	Township 21 SOUTH	Range 23 EAST, N.M.P.M.	Lot Ida	Feet from the 1115'	North/South line SOUTH	Feet from the 2055'	East/West line EAST	County EDDY
--------------------	---------------	----------------------	----------------------------	---------	------------------------	---------------------------	------------------------	------------------------	----------------

"BOTTOM HOLE LOCATION IF DIFFERENT FROM SURFACE

UL or lot no.	Section	Township	Range	Lot Ida	Feet from the	North/South line	Feet from the	East/West line	County
---------------	---------	----------	-------	---------	---------------	------------------	---------------	----------------	--------

12 Dedicated Acres 320	13 Joint or Infill	14 Consolidation Code	15 Order No.
---------------------------	--------------------	-----------------------	--------------

NO ALLOWABLE WELL BE ASSIGNED TO THIS COMPLETION UNTIL ALL INTERESTS HAVE BEEN
CONSOLIDATED OR A NON-STANDARD UNIT HAS BEEN APPROVED BY THE DIVISION

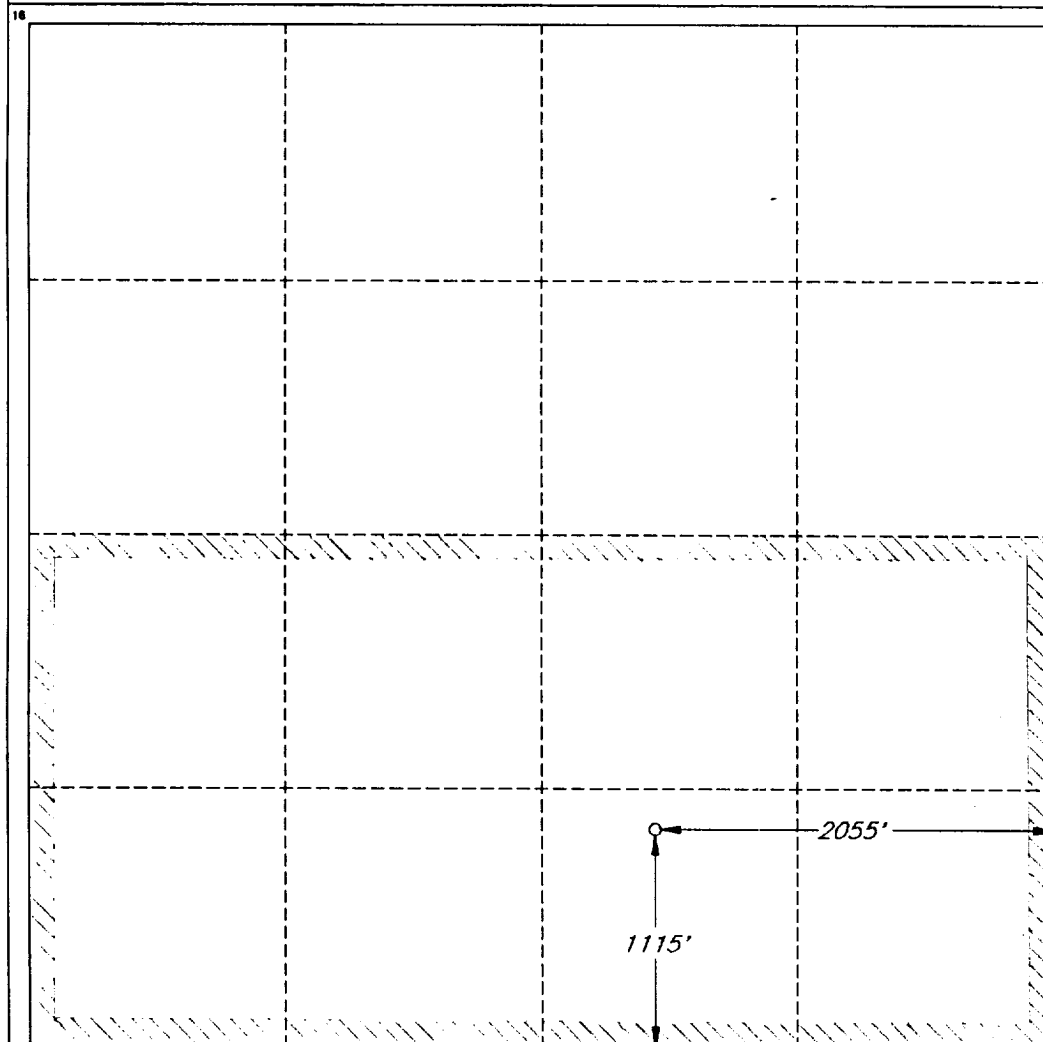

OPERATOR CERTIFICATION

I hereby certify that the information
contained herein is true and complete
to the best of my knowledge and belief.

Signature
James P. "Phil" Stinson
Printed Name
James P. "Phil" Stinson
Title
Agent for Santa Fe Energy
Date
4-11-96

SURVEYOR CERTIFICATION

I hereby certify that the well
location shown on this plat was
plotted from field notes of actual
surveys made by me or under
my supervision, and that the
same is true and correct to the
best of my belief.

Date of Survey
APRIL 2, 1996

Signature and Seal of
Professional Surveyor
V. LYNN
BEZNER
NO. 7920
Certified to Survey
V. L. BEZNER LAND SURVEYORS, #7920
JOB #44830 / S1 NE / V.H.B.

UNITED STATES
DEPARTMENT OF THE INTERIOR
BUREAU OF LAND MANAGEMENT

FORM APPROVED
Budget Bureau No. 1004-0135
Expires: March 31, 1993

SUNDRY NOTICES AND REPORTS ON WELLS

Do not use this form for proposals to drill or to deepen or reentry to a different reservoir.
Use "APPLICATION FOR PERMIT—" for such proposals

SUBMIT IN TRIPLICATE

1. Type of Well

☐ Oil Well ☒ Gas Well ☐ Other

2. Name of Operator

Santa Fe Energy Resources, Inc.

3. Address and Telephone No.

550 W. Texas, Suite 1330; Midland, Texas 79701 (915) 682-6373

4. Location of Well (Footage, Sec., T., R., M., or Survey Description)

(O) 1115' FSL & 2055' FEL Sec. 25, T-21-S, R-23-E

5. Lease Designation and Serial No.

NM 070522

6. If Indian, Allottee or Tribe Name

7. If Unit or CA, Agreement Designation

8. Well Name and No.

Indian Basin "F" #2

9. API Well No.

10. Field and Pool, or Exploratory Area

Indian Basin Morrow

11. County or Parish, State

Eddy, New Mexico

12. CHECK APPROPRIATE BOX(s) TO INDICATE NATURE OF NOTICE, REPORT, OR OTHER DATA

TYPE OF SUBMISSION

- ☐ Notice of Intent
☐ Subsequent Report
☐ Final Abandonment Notice

TYPE OF ACTION

- ☐ Abandonment
☐ Recompletion
☐ Plugging Back
☐ Casing Repair
☐ Altering Casing
☒ Other Move well location
☐ Change of Plans
☐ New Construction
☐ Non-Routine Fracturing
☐ Water Shut-Off
☐ Conversion to Injection
☐ Dispose Water

(Note: Report results of multiple completion on Well Completion or Recompletion Report and Log form.)

13. Describe Proposed or Completed Operations (Clearly state all pertinent details, and give pertinent dates, including estimated date of starting any proposed work. If well is directionally drilled, give subsurface locations and measured and true vertical depths for all markers and zones pertinent to this work.)*

We respectfully request that the proposed location of the subject well be moved per instructions from Barry Hunt. The proposed road is also re-routed.

The new location is (O) 1115' FSL & 2055' FEL, Sec. 25, T-21-S, R-23-E

A new C-102 (amended location plat) is attached.

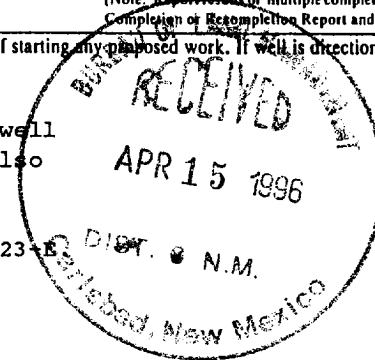

14. I hereby certify that the foregoing is true and correct

Signed James P. Johnston

Title Agent for Santa Fe Energy

Date 4-11-96

(This space for Federal or State office use)

Approved by (ORIG. SGD.) RICHARD L. MANUS
Conditions of approval, if any:

Area Manager

Date 5-16-96

EXHIBIT B
SANTA FE ENERGY RESOURCES, INC.
INDIAN BASIN "F" #2
1140' FSL & 1980' FEL
SEC 25, T-21-S, R-23-E
EDDY COUNTY, NEW MEXICO

