

C/SF

UNITED STATES
DEPARTMENT OF THE INTERIOR
BUREAU OF LAND MANAGEMENT

APPLICATION FOR PERMIT TO DRILL OR DEEPEN

1a. TYPE OF WORK
 DRILL DEEPEN

b. TYPE OF WELL
 OIL WELL GAS WELL OTHER
 SINGLE ZONE MULTIPLE ZONE

2. NAME OF OPERATOR
 ARCO Permian 990

3. ADDRESS AND TELEPHONE NO.
 P.O. Box 1610, Midland, TX 79702 915-688-5532

4. LOCATION OF WELL (Report location clearly and in accordance with any State requirements.*)
 At surface
 660' FNL, 660' FEL
 At proposed prod. zone
 SAME Unit A

5. LEASE DESIGNATION AND SERIAL NO.
 NM 22080

6. IF INDIAN, ALLOTTEE OR TRIBE NAME

7. UNIT AGREEMENT NAME

8. FARM OR LEASE NAME, WELL NO.
 BARCLAY FEDERAL 31
 20860

9. API WELL NO.
 30-015-31106

10. FIELD AND POOL, OR WILDCAT
 LIVINGSTON RIDGE (DEL)

11. SEC., T., R., M., OR BLK. AND SURVEY OR AREA
 1-23S-31E

12. COUNTY OR PARISH
 EDDY

13. STATE
 NM

14. DISTANCE IN MILES AND DIRECTION FROM NEAREST TOWN OR POST OFFICE*
 21 MILES EAST FROM LOVING

15. DISTANCE FROM PROPOSED* LOCATION TO NEAREST PROPERTY OR LEASE LINE, FT. (Also to nearest drlg. unit line, if any) 660

16. NO. OF ACRES IN LEASE
 1280.81

17. NO. OF ACRES ASSIGNED TO THIS WELL
 40

18. DISTANCE FROM PROPOSED LOCATION* TO NEAREST WELL, DRILLING, COMPLETED, OR APPLIED FOR, ON THIS LEASE, FT. 1320'

19. PROPOSED DEPTH
 8450'

20. ROTARY OR CABLE TOOLS
 ROTARY

21. ELEVATIONS (Show whether DF, RT, GR, etc.)
 3492

22. APPROX. DATE WORK WILL START*
 3/00

23. SECRETARY'S POTASH PROPOSED CASING AND CEMENTING CARLSBAD CONTROLLED WATER BASIN

SIZE OF HOLE	GRADE, SIZE OF CASING	WEIGHT PER FOOT	SETTING DEPTH	QUANTITY OF CEMENT
17-1/2	13-3/8 H-40	48 ST&C	860	700
11	8-5/8 J-55	32 ST&C	4600	1300
7-7/8	5-1/2 J-55	15.5 # LT&C	8450	900

SUBJECT WELL IS PLANNED AS A 8450' STRAIGHT HOLE.
 3,000 PSI BOPE WILL BE USED FROM 860' TO TD.

- ATTACHMENTS ARE AS FOLLOWS:
1. CERTIFIED LOCATION PLAT
 2. DRILLING PLAN WITH ATTACHMENTS
 3. SURFACE USE PLAN WITH ATTACHMENTS

APPROVAL SUBJECT TO
 GENERAL REQUIREMENTS AND
 SPECIAL STIPULATIONS
 ATTACHED



IN ABOVE SPACE DESCRIBE PROPOSED PROGRAM: If proposal is to deepen, give data on present productive zone and proposed new productive zone. If proposal is to drill or deepen directionally, give pertinent data on subsurface locations and measured and true vertical depths. Give blowout preventer program, if any.

24. SIGNED Lawrence Cherry TITLE REGULATORY COMPLIANCE DATE 2/7/00

(This space for Federal or State office use)

PERMIT NO. _____ APPROVAL DATE _____

Application approval does not warrant or certify that the applicant holds legal or equitable title to those rights in the subject lease which would entitle the applicant to conduct operations thereon.
 CONDITIONS OF APPROVAL, IF ANY:

APPROVED BY Stephen D. Selzman TITLE Acting State Director DATE 4/17/200
 *See Instructions On Reverse Side APPROVED FOR 1 YEAR

RECEIVED
FEB 16 2000
BLM
ROSWELL, NM

DISTRICT I

P.O. Box 1880, Hobbs, NM 88241-1880

State of New Mexico

Energy, Minerals and Natural Resources Department

Form C-102

Revised February 10, 1994

Submit to Appropriate District Office

State Lease - 4 Copies

Fee Lease - 3 Copies

DISTRICT II

P.O. Drawer 80, Artesia, NM 88211-0710

DISTRICT III

1000 Rio Brazos Rd., Artec, NM 87410

OIL CONSERVATION DIVISION

P.O. Box 2088

Santa Fe, New Mexico 87504-2088

DISTRICT IV

P.O. BOX 2088, SANTA FE, N.M. 87504-2088

AMENDED REPORT

WELL LOCATION AND ACREAGE DEDICATION PLAT

API Number	Pool Code	Pool Name <i>LIVINGSTON RIDGE (DEL)</i>
Property Code	Property Name BARCLAY FEDERAL	Well Number 31
OGRID No. 000990	Operator Name ARCO PERMIAN	Elevation 3492

Surface Location

UL or lot No.	Section	Township	Range	Lot Idn	Feet from the	North/South line	Feet from the	East/West line	County
LOT 1	1	23 S	31 E		660	NORTH	660	EAST	EDDY

Bottom Hole Location If Different From Surface

UL or lot No.	Section	Township	Range	Lot Idn	Feet from the	North/South line	Feet from the	East/West line	County

Dedicated Acres 40	Joint or Infill	Consolidation Code	Order No.
-----------------------	-----------------	--------------------	-----------

NO ALLOWABLE WILL BE ASSIGNED TO THIS COMPLETION UNTIL ALL INTERESTS HAVE BEEN CONSOLIDATED OR A NON-STANDARD UNIT HAS BEEN APPROVED BY THE DIVISION

LOT 4 40.00 ACRES	LOT 3 40.00 ACRES	LOT 2 40.00 ACRES	LOT 1 40.00 ACRES	<p>SEE DETAIL</p> <p>DETAIL</p>	<p>OPERATOR CERTIFICATION</p> <p>I hereby certify that the information contained herein is true and complete to the best of my knowledge and belief.</p> <p><i>Laurie Cherry</i> Signature</p> <p>Laurie Cherry Printed Name</p> <p>Reg/Comp. Asst. Title</p> <p>2-7-00 Date</p>
				<p>SURVEYOR CERTIFICATION</p> <p>I hereby certify that the well location shown on this plat was plotted from field notes of actual surveys made by me or under my supervision and that the same is true and correct to the best of my belief.</p> <p>JANUARY 22, 2000 Date Surveyed</p> <p>DC</p> <p>Signature & Seal of Professional Surveyor <i>Ronald E. Eidson</i></p> <p>RONALD E. EIDSON GARY EIDSON MACON McDONALD</p> <p>26-2000 00-11-0130</p> <p>Certificate No. 3239 12841 12185</p>	

VICINITY MAP

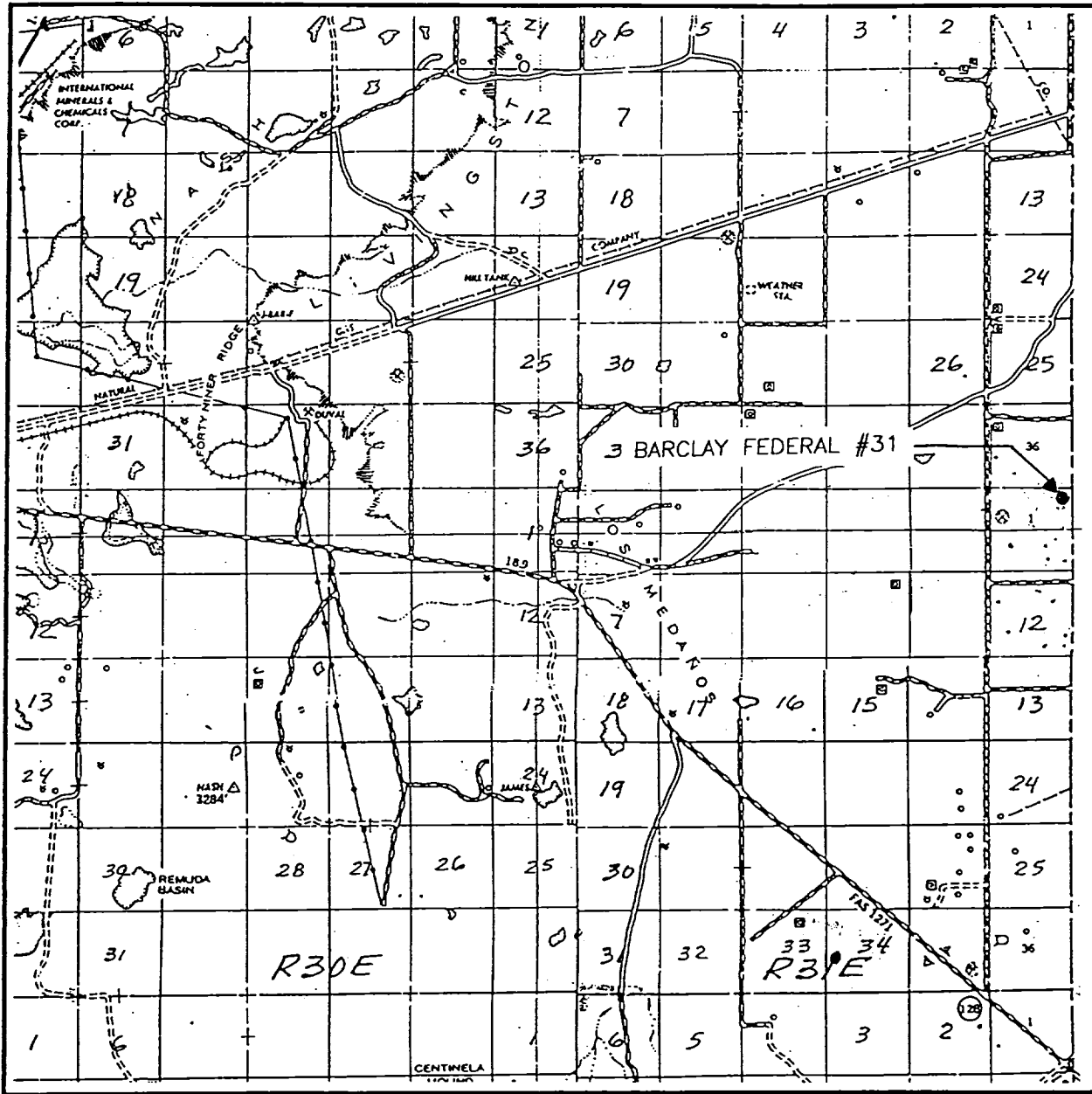

SCALE: 1" = 2 MILES

SEC. 1 TWP. 23-S RGE. 31-E
 SURVEY N.M.P.M.
 COUNTY EDDY
 DESCRIPTION 660' FNL & 660' FEL
 ELEVATION 3492
 OPERATOR ARCO PERMIAN
 LEASE BARCLAY FEDERAL

JOHN WEST SURVEYING
HOBBS, NEW MEXICO
(505 393-3117)

