



July 10, 2014

AMARILLO  
921 North Bivins  
Amarillo, Texas 79107  
Phone 806.467.0607  
Fax 806.467.0622

ARTESIA  
408 West Texas Ave.  
Artesia, New Mexico 88210  
Phone 575.746.8768  
Fax 575.748.8905

HOBBS  
318 East Taylor Street  
Hobbs, New Mexico 88241  
Phone 505.393.4261  
Fax 505.393.4658

MIDLAND  
2901 State Highway 349  
Midland, Texas 79706  
Phone 432.522.2133  
Fax 432.522.2180

OKLAHOMA CITY  
7700 North Hudson Ave  
Suite 10  
Oklahoma City, Oklahoma 73116  
Phone 405.486.7030  
Fax 806.467.0622

SAN ANTONIO  
13111 Lookout Way  
San Antonio, TX 78233  
Phone 210.265.8025  
Fax 210.568.2191

ENVIRONMENTAL CONSULTING  
ENGINEERING  
DRILLING  
CONSTRUCTION  
SPILL MANAGEMENT  
GENERAL CONTRACTING

Toll Free: 866.742.0742  
www.talonlpe.com

Mr. Tomas Oberding  
**NMOCD District I**  
1625 N. French Dr.  
Hobbs, NM 88240

Subject: **Soil Assessment and Remediation Work Plan**  
Devon Energy  
Thistle Unit #17H  
API #: 30-025-39893

Dear Dr. Oberding:

Devon Energy has contracted Talon/LPE (Talon) to perform soil assessment and remediation services at the above referenced location. The results of our soil assessment and proposed remediation activities consist of the following.

#### **Incident Date**

May 15, 2014

#### **Background Information**

The Thistle Unit No. 17H is located approximately fifty (50) miles southeast of Carlsbad in Lea County, New Mexico. The legal location for this site is Section 33, Township 23 South, and Range 33 East. More specifically the latitude and longitude for the release are 32.254365 North and -103.573475 West. A site plan is presented in Appendix I.

According to the soil survey provided by the United States Department of Agriculture Natural Resources Conservation Service, the soil in this area is made up of Berino-Cacique association, hummocky. The local surface and shallow geology, Quaternary Age sedimentary deposits, is comprised of sandy eolian deposits derived from sedimentary rock over calcareous sandy alluvium derived from sedimentary rock. Drainage courses in this area are normally dry. According to the New Mexico State Engineer web site indicates the nearest ground water data to be in S28-T23S-R33E. The ground water in Section 3 is reported to be a depth of 400' below ground surface (bgs). See Appendix II for the referenced groundwater data.

The ranking for this site is **0** based on the following:

Depth to ground water	>100'
Wellhead Protection Area	>1000'
Distance to surface water body	>1000'

## Incident Description

The SWD line was hit by road bore crew causing a release of 50 barrels produced water. The line was isolated and repaired. Approximately 95 percent of the release remained in the bell holes and the rest flowed down caliche road. A vac truck was immediately called to the location and recovered 50 barrels.

## Actions Taken

On May 28, 2014 Talon mobilized personnel to begin the site assessment and soil sampling activities for the construction of a work plan. Grab soil samples were collected within the bell holes utilizing a hand auger to a depth of 6-feet below ground surface.

All soil samples were collected by Talon personnel wearing clean nitrile gloves. The soil samples were placed in laboratory provided sample containers, iced and transported to Cardinal Laboratories in Hobbs, New Mexico for analysis. The samples were tested for TPH (Total Petroleum Hydrocarbons) using EPA Method 8015M, and volatile organics (BTEX) using EPA Method 8021B. The chloride samples were analyzed per Method SM4500Cl-B.

## Laboratory Results

See Appendix III for complete report of laboratory results.

May 29, 2014

Sample ID	Depth (feet)	BTEX (mg/kg)	Chlorides (mg/kg)	TPH (mg/kg) GRO	TPH (mg/kg) DRO
S-1	4'	<0.300	2720	<10	<10
S-2	6'	0.623	11100	<10	872
S-3	4'	<0.300	2680	<10	<10
S-4	6'	<0.300	1780	<10	<10

Based upon the site ranking of 0, NMOCD Recommended Remedial Action Levels (RRAL's) are 50 mg/kg for BTEX, 10 mg for Benzene, and 5,000 mg/kg for TPH. The chloride remediation standard to be 1,000 mg/kg based upon a water table depth greater than 100-feet deep.

### Proposed Remedial Actions

- A composite 20 millimeter liner will be installed under the pipeline at a depth of approximately 6-feet deep under the pipeline. The edges of the liner will be keyed into a trench excavated 3-feet deep at the boundaries of the bell holes.
- New soil will be transported to the location from a local borrow pit and placed over the top of the 20 millimeter liner.
- A final closure report documenting all remedial actions and analytical results will be provided to the OCD along with Final Form C-141.

Should you have any questions or if further information is required, please do not hesitate to contact our office at (575)-746-8768

Respectfully submitted,



Kimberly M. Wilson  
Project Manager



David J. Adkins  
District Manager

## **APPENDIX I**

### **SITE MAP**

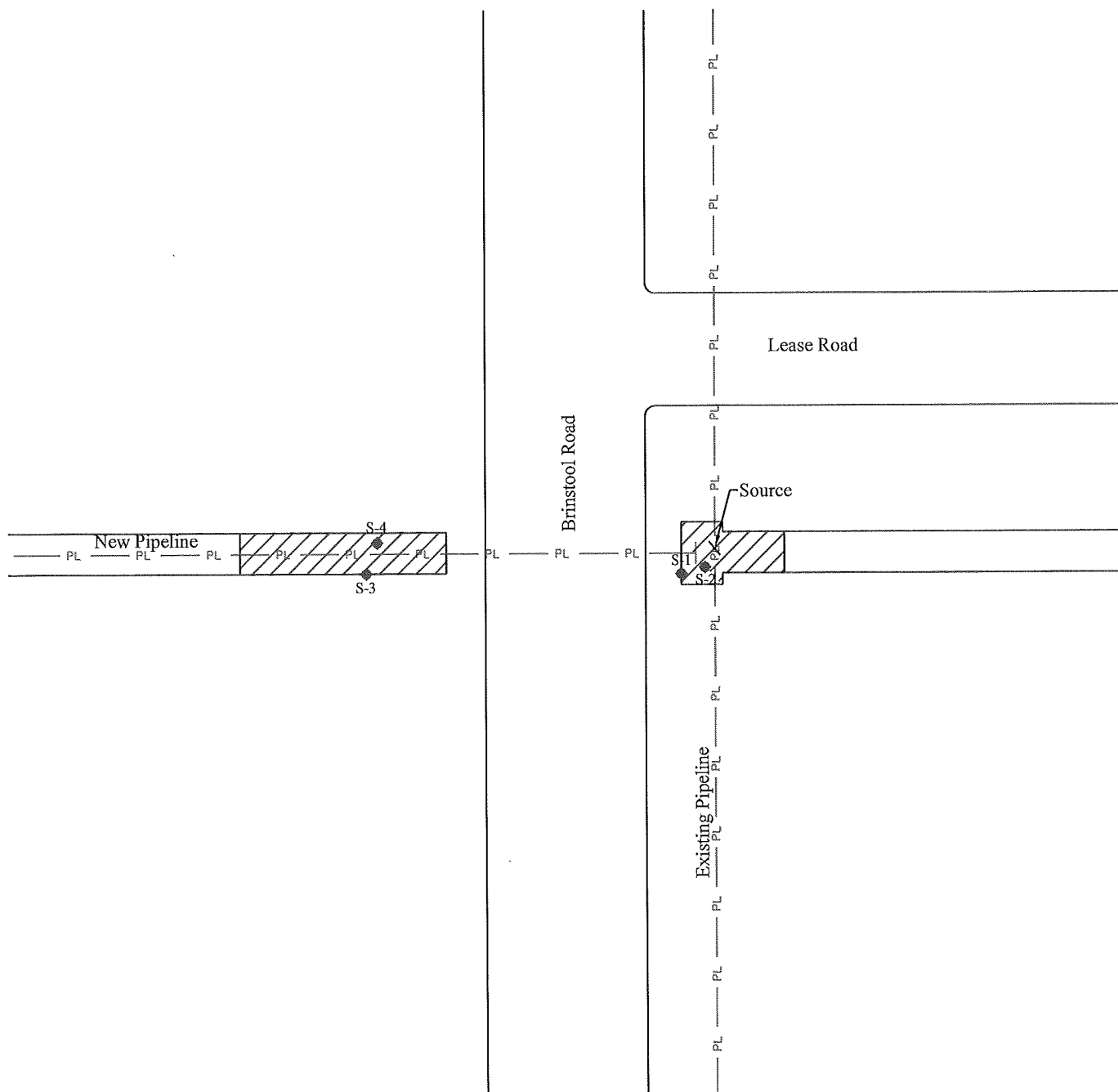

0 7.5 15  
Scale in Feet

Legend	
	- Sample Location
	- Pipeline



Date: 06/03/2014  
Scale: 1" = 15'  
Drawn By: TJS

Thistle #17  
Devon Energy Corporation  
Lea County, New Mexico  
Figure 1 - Site Plan

**APPENDIX II**  
**GROUNDWATER DATA**  
**INITIAL C-141**



# New Mexico Office of the State Engineer

## Water Column/Average Depth to Water

(A CLW##### in the  
POD suffix indicates the  
POD has been replaced  
& no longer serves a  
water right file.)

(R=POD has  
been replaced,  
O=orphaned,  
C=the file is  
closed)

(quarters are 1=NW 2=NE 3=SW 4=SE)

(quarters are smallest to largest)

(NAD83 UTM in meters)

(In feet)

POD Number	POD Sub-Code	basin	County	Q 64	Q 16	Q 4	Sec	Tws	Rng	X	Y	Distance	Depth Well	Depth Water	Water Column
C 02281			LE	3	4	4	28	23S	33E	634495	3571183*	1610	545	400	145
C 02279			LE	3	4	3	28	23S	33E	633691	3571173*	1800	650	400	250

Average Depth to Water: 400 feet

Minimum Depth: 400 feet

Maximum Depth: 400 feet

Record Count: 2

### UTMNAD83 Radius Search (in meters):

Easting (X): 634516

Northing (Y): 3569573

Radius: 2000

\*UTM location was derived from PLSS - see Help

The data is furnished by the NMOSE/ISC and is accepted by the recipient with the expressed understanding that the OSE/ISC make no warranties, expressed or implied, concerning the accuracy, completeness, reliability, usability, or suitability for any particular purpose of the data.

District I  
1425 N. French Dr., Hobbs, NM 88240  
District II  
811 E. First St., Artesia, NM 88210  
District III  
1000 Rio Brazos Road, Aztec, NM 87410  
District IV  
1220 N. St. Francis Dr., Santa Fe, NM 87505

State of New Mexico  
Energy Minerals and Natural Resources

Oil Conservation Division  
1220 South St. Francis Dr.  
Santa Fe, NM 87505

Form C-141  
Revised August 8, 2011

Submit 1 Copy to appropriate District Office in  
accordance with 19.15.29 NMAC.

**Release Notification and Corrective Action**

<b>OPERATOR</b>		<input type="checkbox"/> Initial Report	<input type="checkbox"/> Final Report
Name of Company	DEVON ENERGY	Contact	MATT STOUTT
Address	PO BOX 250 ARTESIA, NM 88211	Telephone No.	575-748-0188
Facility Name	THISTLE 17	Facility Type	SWD PIPELINE
Surface Owner	STATE	Mineral Owner	
		API No.	30-025-39893

**LOCATION OF RELEASE**

Unit Letter	Section	Township	Range	Feet from the	North/South Line	Feet from the	East/West Line	County
	33	23S	33E					LEA

Latitude 32 15.3920N Longitude 103 34.2668W

**NATURE OF RELEASE**

Type of Release	PRODUCED WATER	Volume of Release	50BBL	Volume Recovered	100%
Source of Release	SWD LINE	Date and Hour of Occurrence	5/15/14 11:20 AM	Date and Hour of Discovery	5/15/14 11:20 AM
Was Immediate Notice Given?	<input checked="" type="checkbox"/> Yes <input type="checkbox"/> No <input type="checkbox"/> Not Required	If YES, To Whom?	MATT STOUTT		
By Whom?	WATSON CONSTRUCTION	Date and Hour	5/15/14 11:30 AM		
Was a Watercourse Reached?	<input type="checkbox"/> Yes <input checked="" type="checkbox"/> No	If YES, Volume Impacting the Watercourse.			
If a Watercourse was Impacted, Describe Fully.*					
Describe Cause of Problem and Remedial Action Taken.*					
SWD LINE WAS HIT BY ROAD BORE CREW. VACUUM TRUCK WAS ON SITE AND USED TO CLEAN UP.					
Describe Area Affected and Cleanup Action Taken.*					
95% CONTAINED TO BELL HOLES WERE IMMEDIATELY HYDROVACCED OUT. 5% RAN DOWN CALICHE ROAD AND IMMEDIATELY CLEANED UP WITH BACKHOE.					

I hereby certify that the information given above is true and complete to the best of my knowledge and understand that; pursuant to NMOCD rules and regulations all operators are required to report and/or file certain release notifications and perform corrective actions for releases which may endanger public health or the environment. The acceptance of a C-141 report by the NMOCD marked as "Final Report" does not relieve the operator of liability should their operations have failed to adequately investigate and remediate contamination that poses a threat to ground water, surface water, human health or the environment. In addition, NMOCD acceptance of a C-141 report does not relieve the operator of responsibility for compliance with any other federal, state, or local laws and/or regulations.

**OIL CONSERVATION DIVISION**

Signature:	<i>[Signature]</i>		
Printed Name:	Matt Stoutt		
Title:	Assistant, Enforcement	Approval Date:	Expiration Date:
E-mail Address:	Matthew.Stoutt@DNV.com	Conditions of Approval:	Attached <input type="checkbox"/>
Date:	5-8-14	Phone:	575-513-5848

\* Attach Additional Sheets If Necessary



**APPENDIX III**  
**LABORATORY RESULTS**



PHONE (575) 393-2326 ° 101 E. MARLAND ° HOBBS, NM 88240

---

May 29, 2014

KIMBERLY WILSON

TALON LPE

408 W. TEXAS AVE.

ARTESIA, NM 88210

RE: THISTLE 17

Enclosed are the results of analyses for samples received by the laboratory on 05/28/14 17:00.

Cardinal Laboratories is accredited through Texas NELAP under certificate number T104704398-13-5. Accreditation applies to drinking water, non-potable water and solid and chemical materials. All accredited analytes are denoted by an asterisk (\*). For a complete list of accredited analytes and matrices visit the TCEQ website at [www.tceq.texas.gov/field/qa/lab\\_accred\\_certif.html](http://www.tceq.texas.gov/field/qa/lab_accred_certif.html).

Cardinal Laboratories is accredited through the State of Colorado Department of Public Health and Environment for:

Method EPA 552.2	Haloacetic Acids (HAA-5)
Method EPA 524.2	Total Trihalomethanes (TTHM)
Method EPA 524.4	Regulated VOCs (V1, V2, V3)

Accreditation applies to public drinking water matrices.

This report meets NELAP requirements and is made up of a cover page, analytical results, and a copy of the original chain-of-custody. If you have any questions concerning this report, please feel free to contact me.

Sincerely,

Celey D. Keene

Lab Director/Quality Manager

**Analytical Results For:**

TALON LPE  
KIMBERLY WILSON  
408 W. TEXAS AVE.  
ARTESIA NM, 88210  
Fax To: (575) 745-8905

Received: 05/28/2014  
Reported: 05/29/2014  
Project Name: THISTLE 17  
Project Number: 700794.107.01  
Project Location: NOT GIVEN

Sampling Date: 05/28/2014  
Sampling Type: Soil  
Sampling Condition: Cool & Intact  
Sample Received By: Celey D. Keene

**Sample ID: S-1 4' EASTSIDE (H401638-01)**

BTX 8021B		mg/kg		Analyzed By: MS					
Analyte	Result	Reporting Limit	Analyzed	Method Blank	BS	% Recovery	True Value QC	RPD	Qualifier
Benzene*	<0.050	0.050	05/29/2014	ND	2.07	103	2.00	3.77	
Toluene*	<0.050	0.050	05/29/2014	ND	2.05	102	2.00	3.01	
Ethylbenzene*	<0.050	0.050	05/29/2014	ND	1.96	98.2	2.00	3.78	
Total Xylenes*	<0.150	0.150	05/29/2014	ND	6.15	102	6.00	3.77	
Total BTX	<0.300	0.300	05/29/2014	ND					

Surrogate: 4-Bromofluorobenzene (PID) 106 % 89.4-126

Chloride, SM4500Cl-B		mg/kg		Analyzed By: AP					
Analyte	Result	Reporting Limit	Analyzed	Method Blank	BS	% Recovery	True Value QC	RPD	Qualifier
Chloride	2720	16.0	05/29/2014	ND	400	100	400	0.00	

TPH 8015M		mg/kg		Analyzed By: MS					
Analyte	Result	Reporting Limit	Analyzed	Method Blank	BS	% Recovery	True Value QC	RPD	Qualifier
GRO C6-C10	<10.0	10.0	05/29/2014	ND	190	94.9	200	1.85	
DRO >C10-C28	<10.0	10.0	05/29/2014	ND	199	99.3	200	0.141	

Surrogate: 1-Chlorooctane 90.9 % 65.2-140

Surrogate: 1-Chlorooctadecane 96.7 % 63.6-154

Cardinal Laboratories

\*=Accredited Analyte

PLEASE NOTE: Liability and Damages. Cardinal's liability and client's exclusive remedy for any claim arising, whether based in contract or tort, shall be limited to the amount paid by client for analyses. All claims, including those for negligence and any other cause whatsoever shall be deemed waived unless made in writing and received by Cardinal within thirty (30) days after completion of the applicable service. In no event shall Cardinal be liable for incidental or consequential damages, including, without limitation, business interruptions, loss of use, or loss of profits incurred by client, its subsidiaries, affiliates or successors arising out of or related to the performance of the services hereunder by Cardinal, regardless of whether such claim is based upon any of the above stated reasons or otherwise. Results relate only to the samples identified above. This report shall not be reproduced except in full with written approval of Cardinal Laboratories.

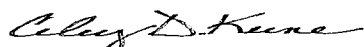

Celey D. Keene, Lab Director/Quality Manager

**Analytical Results For:**

TALON LPE  
KIMBERLY WILSON  
408 W. TEXAS AVE.  
ARTESIA NM, 88210  
Fax To: (575) 745-8905

Received: 05/28/2014  
Reported: 05/29/2014  
Project Name: THISTLE 17  
Project Number: 700794.107.01  
Project Location: NOT GIVEN

Sampling Date: 05/28/2014  
Sampling Type: Soil  
Sampling Condition: Cool & Intact  
Sample Received By: Celey D. Keene

**Sample ID: S-2 6' EASTSIDE (H401638-02)**

BTEx 8021B		mg/kg		Analyzed By: MS					
Analyte	Result	Reporting Limit	Analyzed	Method Blank	BS	% Recovery	True Value QC	RPD	Qualifier
Benzene*	<0.050	0.050	05/29/2014	ND	2.07	103	2.00	3.77	
Toluene*	<b>0.109</b>	0.050	05/29/2014	ND	2.05	102	2.00	3.01	
Ethylbenzene*	<b>0.085</b>	0.050	05/29/2014	ND	1.96	98.2	2.00	3.78	
Total Xylenes*	<b>0.430</b>	0.150	05/29/2014	ND	6.15	102	6.00	3.77	
Total BTEX	<b>0.623</b>	0.300	05/29/2014	ND					

Surrogate: 4-Bromofluorobenzene (PID) 110 % 89.4-126

Chloride, SM4500Cl-B		mg/kg		Analyzed By: AP					
Analyte	Result	Reporting Limit	Analyzed	Method Blank	BS	% Recovery	True Value QC	RPD	Qualifier
Chloride	<b>11100</b>	16.0	05/29/2014	ND	400	100	400	0.00	

TPH 8015M		mg/kg		Analyzed By: MS					
Analyte	Result	Reporting Limit	Analyzed	Method Blank	BS	% Recovery	True Value QC	RPD	Qualifier
GRO C6-C10	<10.0	10.0	05/29/2014	ND	190	94.9	200	1.85	
DRO >C10-C28	<b>872</b>	10.0	05/29/2014	ND	199	99.3	200	0.141	

Surrogate: 1-Chlorooctane 93.0 % 65.2-140

Surrogate: 1-Chlorooctadecane 110 % 63.6-154

Cardinal Laboratories

\*=Accredited Analyte

PLEASE NOTE: Liability and Damages. Cardinal's liability and client's exclusive remedy for any claim arising, whether based in contract or tort, shall be limited to the amount paid by client for analyses. All claims, including those for negligence and any other cause whatsoever shall be deemed waived unless made in writing and received by Cardinal within thirty (30) days after completion of the applicable service. In no event shall Cardinal be liable for incidental or consequential damages, including, without limitation, business interruptions, loss of use, or loss of profits incurred by client, its subsidiaries, affiliates or successors arising out of or related to the performance of the services hereunder by Cardinal, regardless of whether such claim is based upon any of the above stated reasons or otherwise. Results relate only to the samples identified above. This report shall not be reproduced except in full with written approval of Cardinal Laboratories.

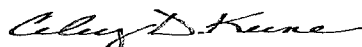

Celey D. Keene, Lab Director/Quality Manager

**Analytical Results For:**

TALON LPE  
KIMBERLY WILSON  
408 W. TEXAS AVE.  
ARTESIA NM, 88210  
Fax To: (575) 745-8905

Received: 05/28/2014  
Reported: 05/29/2014  
Project Name: THISTLE 17  
Project Number: 700794.107.01  
Project Location: NOT GIVEN

Sampling Date: 05/28/2014  
Sampling Type: Soil  
Sampling Condition: Cool & Intact  
Sample Received By: Celey D. Keene

**Sample ID: S-3 4' WESTSIDE (H401638-03)**

BTEX 8021B			mg/kg		Analyzed By: MS				
Analyte	Result	Reporting Limit	Analyzed	Method Blank	BS	% Recovery	True Value QC	RPD	Qualifier
Benzene*	<0.050	0.050	05/29/2014	ND	2.07	103	2.00	3.77	
Toluene*	<0.050	0.050	05/29/2014	ND	2.05	102	2.00	3.01	
Ethylbenzene*	<0.050	0.050	05/29/2014	ND	1.96	98.2	2.00	3.78	
Total Xylenes*	<0.150	0.150	05/29/2014	ND	6.15	102	6.00	3.77	
Total BTEX	<0.300	0.300	05/29/2014	ND					

Surrogate: 4-Bromofluorobenzene (PID) 105 % 89.4-126

Chloride, SM4500Cl-B			mg/kg		Analyzed By: AP				
Analyte	Result	Reporting Limit	Analyzed	Method Blank	BS	% Recovery	True Value QC	RPD	Qualifier
Chloride	2680	16.0	05/29/2014	ND	400	100	400	0.00	

TPH 8015M			mg/kg		Analyzed By: MS				
Analyte	Result	Reporting Limit	Analyzed	Method Blank	BS	% Recovery	True Value QC	RPD	Qualifier
GRO C6-C10	<10.0	10.0	05/29/2014	ND	190	94.9	200	1.85	
DRO >C10-C28	<10.0	10.0	05/29/2014	ND	199	99.3	200	0.141	

Surrogate: 1-Chlorooctane 88.7 % 65.2-140

Surrogate: 1-Chlorooctadecane 94.2 % 63.6-154

Cardinal Laboratories

\*=Accredited Analyte

PLEASE NOTE: Liability and Damages. Cardinal's liability and client's exclusive remedy for any claim arising, whether based in contract or tort, shall be limited to the amount paid by client for analyses. All claims, including those for negligence and any other cause whatsoever shall be deemed waived unless made in writing and received by Cardinal within thirty (30) days after completion of the applicable service. In no event shall Cardinal be liable for incidental or consequential damages, including, without limitation, business interruptions, loss of use, or loss of profits incurred by client, its subsidiaries, affiliates or successors arising out of or related to the performance of the services hereunder by Cardinal, regardless of whether such claim is based upon any of the above stated reasons or otherwise. Results relate only to the samples identified above. This report shall not be reproduced except in full with written approval of Cardinal Laboratories.

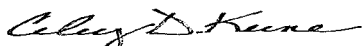

Celey D. Keene, Lab Director/Quality Manager

**Analytical Results For:**

TALON LPE  
KIMBERLY WILSON  
408 W. TEXAS AVE.  
ARTESIA NM, 88210  
Fax To: (575) 745-8905

Received: 05/28/2014  
Reported: 05/29/2014  
Project Name: THISTLE 17  
Project Number: 700794.107.01  
Project Location: NOT GIVEN

Sampling Date: 05/28/2014  
Sampling Type: Soil  
Sampling Condition: Cool & Intact  
Sample Received By: Celey D. Keene

**Sample ID: S-4 6' WESTSIDE (H401638-04)**

BTX 8021B		mg/kg		Analyzed By: MS					
Analyte	Result	Reporting Limit	Analyzed	Method Blank	BS	% Recovery	True Value QC	RPD	Qualifier
Benzene*	<0.050	0.050	05/29/2014	ND	2.07	103	2.00	3.77	
Toluene*	<0.050	0.050	05/29/2014	ND	2.05	102	2.00	3.01	
Ethylbenzene*	<0.050	0.050	05/29/2014	ND	1.96	98.2	2.00	3.78	
Total Xylenes*	<0.150	0.150	05/29/2014	ND	6.15	102	6.00	3.77	
Total BTX	<0.300	0.300	05/29/2014	ND					

Surrogate: 4-Bromofluorobenzene (PID) 106 % 89.4-126

Chloride, SM4500Cl-B		mg/kg		Analyzed By: AP					
Analyte	Result	Reporting Limit	Analyzed	Method Blank	BS	% Recovery	True Value QC	RPD	Qualifier
Chloride	1780	16.0	05/29/2014	ND	400	100	400	0.00	

TPH 8015M		mg/kg		Analyzed By: MS					
Analyte	Result	Reporting Limit	Analyzed	Method Blank	BS	% Recovery	True Value QC	RPD	Qualifier
GRO C6-C10	<10.0	10.0	05/29/2014	ND	190	94.9	200	1.85	
DRO >C10-C28	<10.0	10.0	05/29/2014	ND	199	99.3	200	0.141	

Surrogate: 1-Chlorooctane 96.9 % 65.2-140

Surrogate: 1-Chlorooctadecane 98.0 % 63.6-154

Cardinal Laboratories

\*=Accredited Analyte

PLEASE NOTE: Liability and Damages. Cardinal's liability and client's exclusive remedy for any claim arising, whether based in contract or tort, shall be limited to the amount paid by client for analyses. All claims, including those for negligence and any other cause whatsoever shall be deemed waived unless made in writing and received by Cardinal within thirty (30) days after completion of the applicable service. In no event shall Cardinal be liable for incidental or consequential damages, including, without limitation, business interruptions, loss of use, or loss of profits incurred by client, its subsidiaries, affiliates or successors arising out of or related to the performance of the services hereunder by Cardinal, regardless of whether such claim is based upon any of the above stated reasons or otherwise. Results relate only to the samples identified above. This report shall not be reproduced except in full with written approval of Cardinal Laboratories.

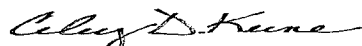

Celey D. Keene, Lab Director/Quality Manager

**Notes and Definitions**

ND	Analyte NOT DETECTED at or above the reporting limit
RPD	Relative Percent Difference
**	Samples not received at proper temperature of 6°C or below.
***	Insufficient time to reach temperature.
-	Chloride by SM4500Cl-B does not require samples be received at or below 6°C
	Samples reported on an as received basis (wet) unless otherwise noted on report

---

Cardinal Laboratories

\*=Accredited Analyte

PLEASE NOTE: Liability and Damages. Cardinal's liability and client's exclusive remedy for any claim arising, whether based in contract or tort, shall be limited to the amount paid by client for analyses. All claims, including those for negligence and any other cause whatsoever shall be deemed waived unless made in writing and received by Cardinal within thirty (30) days after completion of the applicable service. In no event shall Cardinal be liable for incidental or consequential damages, including, without limitation, business interruptions, loss of use, or loss of profits incurred by client, its subsidiaries, affiliates or successors arising out of or related to the performance of the services hereunder by Cardinal, regardless of whether such claim is based upon any of the above stated reasons or otherwise. Results relate only to the samples identified above. This report shall not be reproduced except in full with written approval of Cardinal Laboratories.

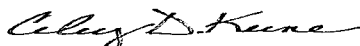

---

Celey D. Keene, Lab Director/Quality Manager

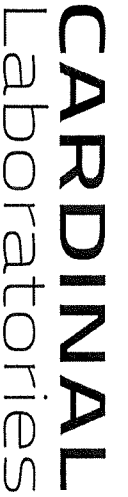

# CHAIN-OF-CUSTODY AND ANALYSIS REQUEST

101 East Marland, Hobbs, NM 88240  
(575) 393-2326 FAX (575) 393-2476

Company Name: <b>Talmon LLP</b>		P.O. #:	
Project Manager: <b>H. L. Lisen</b>		Company: <b>Talmon</b>	
Address: <b>408 W. Texas</b>		Attn:	
City: <b>Arlene</b>		Address:	
State: <b>NM</b> Zip: <b>88210</b>		City:	
Phone #: <b>575 746 8768</b> Fax #:		State:	
Project #: <b>700794 10701</b> Project Owner: <b>Dawn</b>		Zip:	
Project Name: <b>Thistle 17</b>		Phone #:	
Project Location:		Fax #:	
Sampler Name: <b>Rebbie DeBeauvoir</b>			

FOR LAB USE ONLY		MATRIX		PRESERV	SAMPLING
Lab I.D.	Sample I.D.	GROUNDWATER	WASTEWATER	OTHER :	
HY011038	01 S-1 4' Eastside				DATE
	02 S-2 6' Eastside				TIME
	03 S-3 4' Westside				
	04 S-4 6' Westside				

PLEASE NOTE: Liability and Damages. Cardholder's liability and client's exclusive remedy for any claim arising whether based in contract or tort shall be limited to the amount paid by the client for the analysis. All claims, including those for negligence and any other cause whatsoever shall be deemed waived unless made in writing and received by Cardinal within 30 days after completion of the applicable service. In no event shall Cardinal be liable for incidental or consequential damages, including without limitation, business interruptions, loss of use, or loss of profits incurred by client, its subsidiaries, affiliates or successors arising out of or related to the performance of services hereunder by Cardinal, regardless of whether such claim is based upon any of the above stated remedies or otherwise.	
Relinquished By: <b>Rebbie DeBeauvoir</b> Date: <b>5/28/14</b> Time: <b>5:00</b>	Received By: <b>Rebbie DeBeauvoir</b> Date: <b>5/28/14</b> Time: <b>5:00</b>
Relinquished By: <b>Rebbie DeBeauvoir</b> Date: <b>5/28/14</b> Time: <b>5:00</b>	Received By: <b>Rebbie DeBeauvoir</b> Date: <b>5/28/14</b> Time: <b>5:00</b>
Delivered By: <b>Rebbie DeBeauvoir</b> Date: <b>5/28/14</b> Time: <b>5:00</b>	Sample Condition: <b>Good</b> Checked By: <b>Rebbie DeBeauvoir</b> Date: <b>5/28/14</b> Time: <b>5:00</b>

REMARKS: <b>Chloride</b> <b>TPH</b> <b>BTEX</b>	
Phone Result: <input type="checkbox"/> Yes <input type="checkbox"/> No <input type="checkbox"/> Add'l Phone #:	Fax Result: <input type="checkbox"/> Yes <input type="checkbox"/> No <input type="checkbox"/> Add'l Fax #:





Date: 06/03/2014  
Scale: 1" = 15'  
Drawn By: TJS

Thistle #17  
Devon Energy Corporation  
Lea County, New Mexico  
Figure 1 - Site Plan

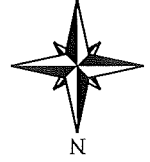
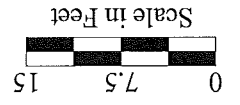

Legend  
◆ - Sample Location  
— PL — - Pipeline

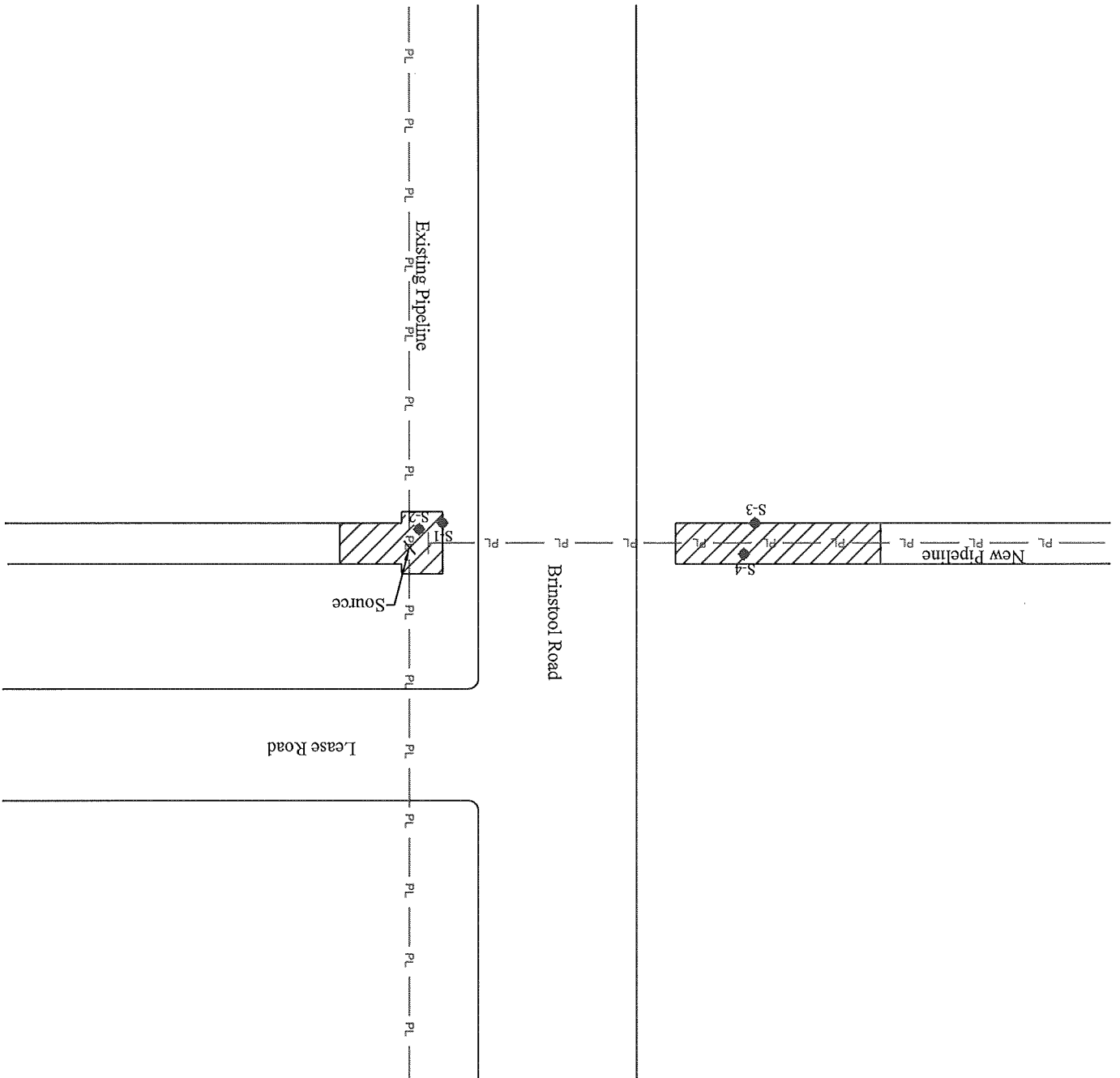



Date: 06/03/2014  
Scale: 1" = 15'  
Drawn By: TJS

Thistle #17  
Devon Energy Corporation  
Lea County, New Mexico  
Figure 1 - Site Plan

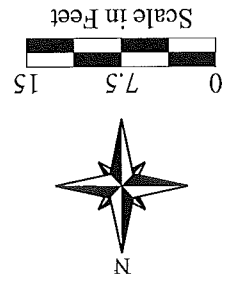

Legend  
◆ - Sample Location  
— PL — - Pipeline

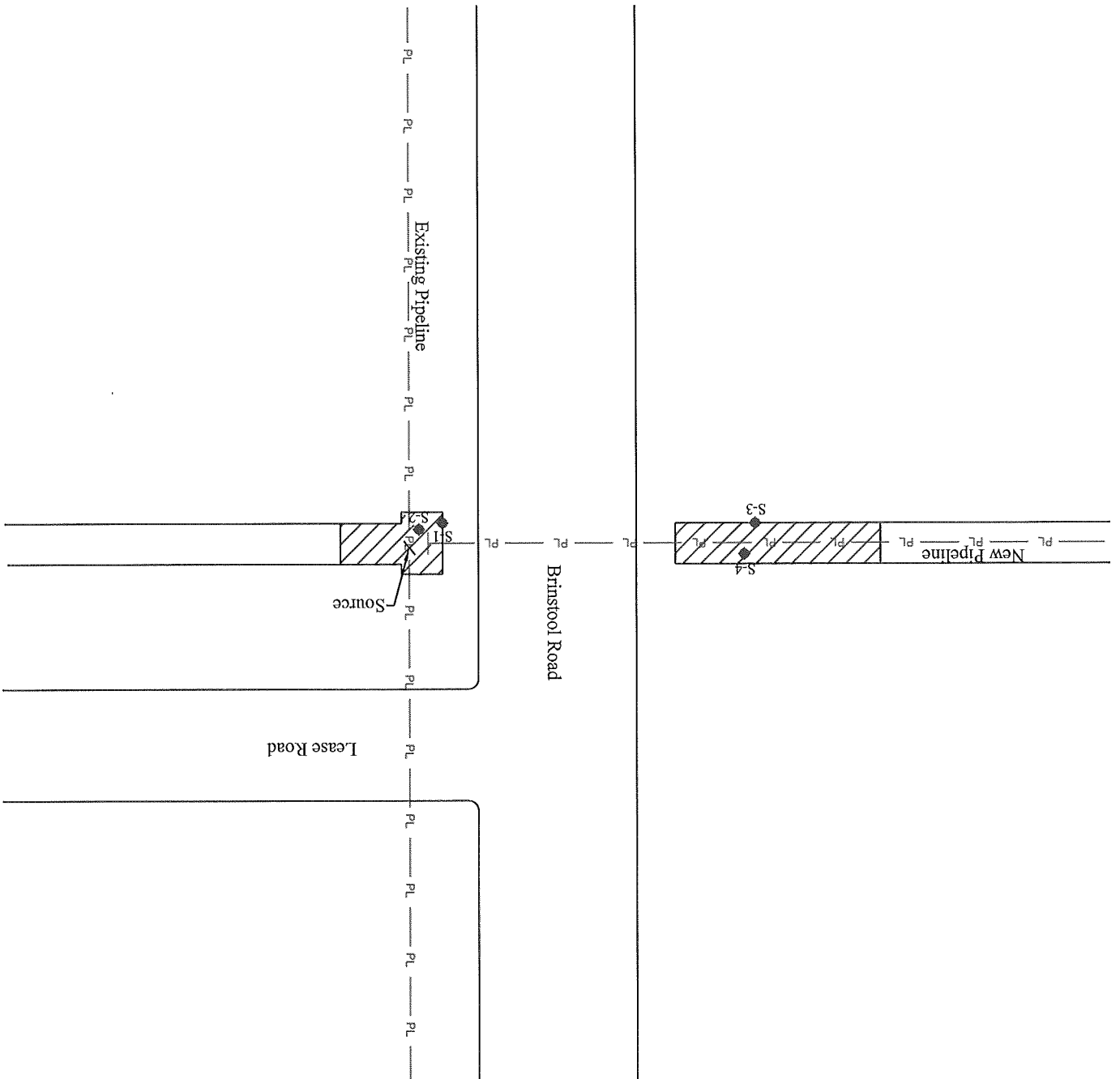



# New Mexico Office of the State Engineer

## Water Column/Average Depth to Water

(A CLW##### in the  
POD suffix indicates the  
POD has been replaced  
& no longer serves a  
water right file.)

(R=POD has  
been replaced,  
O=orphaned,  
C=the file is  
closed)

(quarters are 1=NW 2=NE 3=SW 4=SE)

(quarters are smallest to largest)

(NAD83 UTM in meters)

(In feet)

POD Number	POD Sub-		County	Q Q Q			Sec	Tws	Rng	X	Y	Distance	Depth	Depth	Water
	Code	basin		64	16	4							Well	Water	Column
C 02281			LE	3	4	4	28	23S	33E	634495	3571183*	1610	545	400	145
C 02279			LE	3	4	3	28	23S	33E	633691	3571173*	1800	650	400	250

Average Depth to Water: 400 feet

Minimum Depth: 400 feet

Maximum Depth: 400 feet

Record Count: 2

### UTMNAD83 Radius Search (in meters):

Easting (X): 634516

Northing (Y): 3569573

Radius: 2000

\*UTM location was derived from PLSS - see Help

The data is furnished by the NMOSE/ISC and is accepted by the recipient with the expressed understanding that the OSE/ISC make no warranties, expressed or implied, concerning the accuracy, completeness, reliability, usability, or suitability for any particular purpose of the data.