

HOBBS OCD

4024

District I
1625 N. French Dr., Hobbs, NM 88240
District II
1301 W. Grand Avenue, Artesia, NM 88210
District III
1000 Rio Brazos Road, Aztec, NM 87410
District IV
1220 S. St. Francis Dr., Santa Fe, NM 87505

State of New Mexico
Energy Minerals and Natural Resources

FEB 11 2014

Form C-141
Revised October 10, 2003

Oil Conservation Division
1220 South St. Francis Dr.
Santa Fe, NM 87505

RECEIVED

Submit 2 Copies to appropriate
District Office in accordance
with Rule 116 on back
side of form

Release Notification and Corrective Action

OPERATOR

☐ Initial Report ☒ Final Report

Name of Company Yates Petroleum Corporation	OGRID Number 25575	Contact Chase Settle
Address 104 S. 4 TH Street	Telephone No. 575-748-4171	REVIEWED Previously Approved by NMOCD 12/27/2013 <i>By Kristen Lynch at 1:27 pm, Sep 21, 2016</i>
Facility Name Atoka Bank BDJ State Com. #3-H	API Number 30-025-41058	
Surface Owner State	Mineral Owner State	Lease No. V-6582

LOCATION OF RELEASE

Unit Letter	Section	Township	Range	Feet from the	North/South Line	Feet from the	East/West Line	County
A	17	24S	33E	200	North	660	East	Lea

Latitude 32.22428 Longitude 103.58742

NATURE OF RELEASE

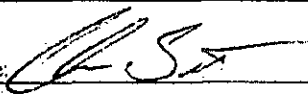
Type of Release 10.0# Brine Water & Mud Cut	Volume of Release 220 B/BW	Volume Recovered 200 B/BW
Source of Release Mud Gas Separator	Date and Hour of Occurrence 12/27/2013, AM	Date and Hour of Discovery 12/27/2013, AM
Was Immediate Notice Given? <input checked="" type="checkbox"/> Yes <input type="checkbox"/> No <input type="checkbox"/> Not Required	If YES, To Whom? Geoffrey Leking/NMOCD II	
By Whom? Robert Ashier/Yates Petroleum Corporation	Date and Hour 12/27/2013, AM	
Was a Watercourse Reached? <input type="checkbox"/> Yes <input checked="" type="checkbox"/> No	If YES, Volume Impacting the Watercourse. N/A	
If a Watercourse was Impacted, Describe Fully.* N/A		
Describe Cause of Problem and Remedial Action Taken.* Brine water/mud was released through a mud gas separator and deposited into a flare pit, flare pit overflowed onto location pad. Vacuum truck(s) were called and recovered remaining brine water/mud, backhoe was called to excavate impacted soils from pad.		
Describe Area Affected and Cleanup Action Taken.* An approximate area of 60 X 60'. Vertical and horizontal delineation samples will be taken and analysis ran for TPH & BTEX (Chlorides in soils for documentation). If initial analytical results for TPH & BTEX are under RRAL's (site ranking is 10) a Final Report, C-141 will be submitted to the OCD requesting closure. If the analytical results are above the RRAL a work plan will be submitted. TPH & BTEX analytical results are under RRAL's (site ranking is 10). 90.9% of the fluid was recovered from vacuum trucks and third party was contracted to remove impacted soil once fluid was recovered. Depth to Ground Water: 50-99' (approx. 80' per the ChevronTexaco trend map), Wellhead Protection Area: No, Distance to Surface Water Body: >1000', SITE RANKING IS 10. Based on analytical results, impacted soils excavated and depth to groundwater, Yates Petroleum Corporation requests closure.		
I hereby certify that the information given above is true and complete to the best of my knowledge and understand that pursuant to NMOCD rules and regulations all operators are required to report and/or file certain release notifications and perform corrective actions for releases which may endanger public health or the environment. The acceptance of a C-141 report by the NMOCD marked as "Final Report" does not relieve the operator of liability should their operations have failed to adequately investigate and remediate contamination that pose a threat to ground water, surface water, human health or the environment. In addition, NMOCD acceptance of a C-141 report does not relieve the operator of responsibility for compliance with any other federal, state, or local laws and/or regulations.		
Signature: 		OIL CONSERVATION DIVISION
Printed Name: Chase Settle		Approved by District Supervisor: G. Leking
Title: NM Environmental Regulatory Agent	Approval Date: 12/27/13	Expiration Date:
E-mail Address: csettle@yatespetroleum.com	Conditions of Approval:	Attached <input type="checkbox"/>
Date: Tuesday, February 11, 2014	Phone: 575-748-4171	IRP- 1RP 4024

nJXK1535046286
pJXK1535046370

2/11

DEC 22 2015

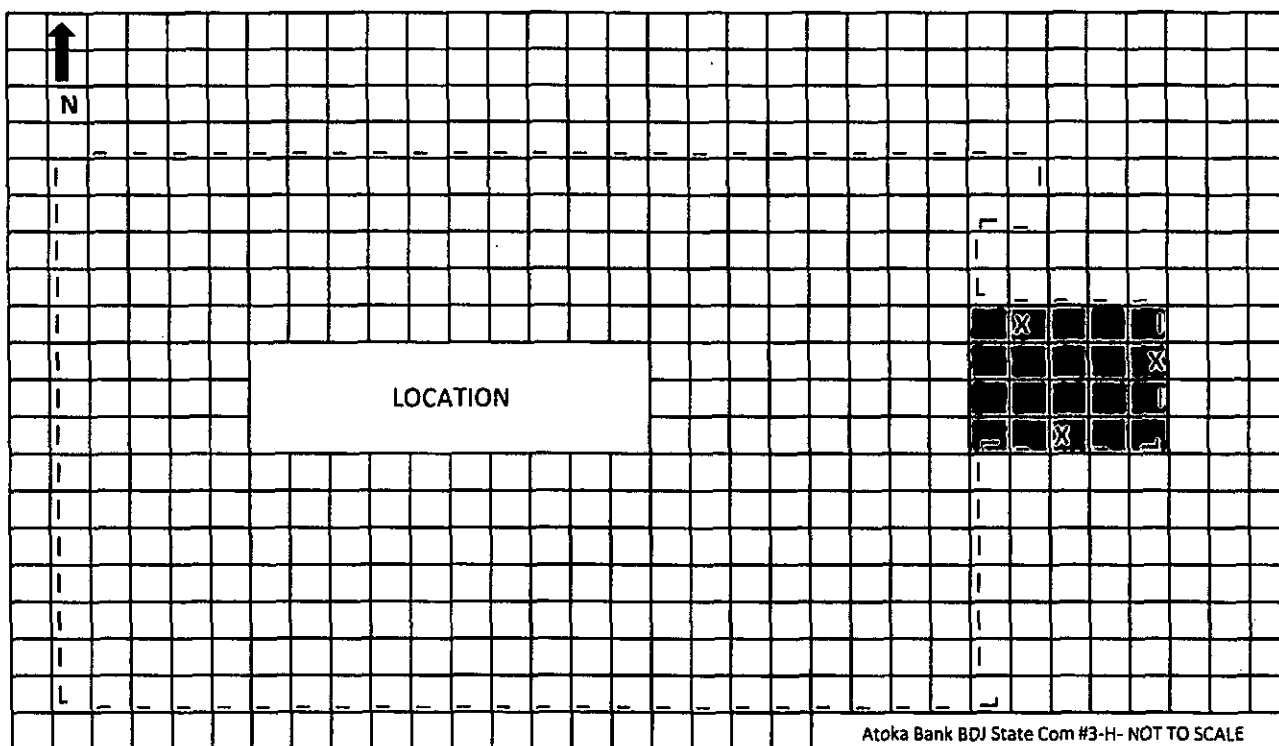

Release Area



Sample Location

Analytical Report H400296 (Cardinal)	Sample Area	Sample Date	Sample Type	Depth	BTEX	GRO	DRO	Chlorides
S1 1'	Release Area	1/27/2014	Hand Auger	1'	N/A	N/A	N/A	<16.0

Site Ranking is Zero (10). DTGW 50-99' (80', Section 17, T24S-R33E, Trend Map)

All results are ppm, Chlorides for documentation.

Released: 220 B/BW; Recovered: 200 B/BW Release Date: 12/27/2013



PHONE (575) 393-2326 • 101 E. MARLAND • HOBBS, NM 88240

February 07, 2014

CHASE SETTLE

YATES PETROLEUM CORPORATION

105 S 4th Street

Artesia, NM 88210

RE: ATOKA BANK BDJ STATE COM. #3-H

Enclosed are the results of analyses for samples received by the laboratory on 01/30/14 11:06.

Cardinal Laboratories is accredited through Texas NELAP under certificate number T104704398-13-5. Accreditation applies to drinking water, non-potable water and solid and chemical materials. All accredited analytes are denoted by an asterisk (*). For a complete list of accredited analytes and matrices visit the TCEQ website at www.tceq.texas.gov/field/qa/lab_accred_certif.html.

Cardinal Laboratories is accredited through the State of Colorado Department of Public Health and Environment for:

Method EPA 552.2	Haloacetic Acids (HAA-5)
Method EPA 524.2	Total Trihalomethanes (TTHM)
Method EPA 524.4	Regulated VOCs (V1, V2, V3)

Accreditation applies to public drinking water matrices.

This report meets NELAP requirements and is made up of a cover page, analytical results, and a copy of the original chain-of-custody. If you have any questions concerning this report, please feel free to contact me.

Sincerely,

A handwritten signature in black ink that reads "Celey D. Keene". The signature is fluid and cursive, with the first name "Celey" being more prominent.

Celey D. Keene

Lab Director/Quality Manager



PHONE (575) 393-2326 • 101 E. MARLAND • HOBBS, NM 88240

Analytical Results For:

YATES PETROLEUM CORPORATION
CHASE SETTLE
105 S 4th Street
Artesia NM, 88210
Fax To: (505) 748-4635

Received:	01/30/2014	Sampling Date:	01/27/2014
Reported:	02/07/2014	Sampling Type:	Soil
Project Name:	ATOKA BANK BDJ STATE COM. #3-H	Sampling Condition:	Cool & Intact
Project Number:	NOT GIVEN	Sample Received By:	Kathy Perez
Project Location:	ATOKA BANK BDJ STATE COM #3H		

Sample ID: S1 1' (H400296-01)

Chloride, SM4500Cl-B		mg/kg	Analyzed By: AP						
Analyte	Result	Reporting Limit	Analyzed	Method Blank	BS	% Recovery	True Value QC	RPD	Qualifier
Chloride	<16.0	16.0	02/07/2014	ND	400	100	400	3.92	

Cardinal Laboratories

*=Accredited Analyte

PLEASE NOTE: Liability and Damages. Cardinal's liability and client's exclusive remedy for any claim arising, whether based in contract or tort, shall be limited to the amount paid by client for analyses. All claims, including those for negligence and any other cause whatsoever shall be deemed waived unless made in writing and received by Cardinal within thirty (30) days after completion of the applicable service. In no event shall Cardinal be liable for incidental or consequential damages, including, without limitation, business interruptions, loss of use, or loss of profits incurred by client, its subsidiaries, affiliates or successors arising out of or related to the performance of the services hereunder by Cardinal, regardless of whether such claim is based upon any of the above stated reasons or otherwise. Results relate only to the samples identified above. This report shall not be reproduced except in full with written approval of Cardinal Laboratories.

Celey D. Keene, Lab Director/Quality Manager

Notes and Definitions

ND	Analyte NOT DETECTED at or above the reporting limit
RPD	Relative Percent Difference
**	Samples not received at proper temperature of 6°C or below.
***	Insufficient time to reach temperature.
-	Chloride by SM4500Cl-B does not require samples be received at or below 6°C Samples reported on an as received basis (wet) unless otherwise noted on report

Cardinal Laboratories

* = Accredited Analyte

PLEASE NOTE: Liability and Damages. Cardinal's liability and client's exclusive remedy for any claim arising, whether based in contract or tort, shall be limited to the amount paid by client for analyses. All claims, including those for negligence and any other cause whatsoever shall be deemed waived unless made in writing and received by Cardinal within thirty (30) days after completion of the applicable service. In no event shall Cardinal be liable for incidental or consequential damages, including, without limitation, business interruptions, loss of use, or loss of profits incurred by client, its subsidiaries, affiliates or successors arising out of or related to the performance of the services hereunder by Cardinal, regardless of whether such claim is based upon any of the above stated reasons or otherwise. Results relate only to the samples identified above. This report shall not be reproduced except in full with written approval of Cardinal Laboratories.



Celey D. Keene, Lab Director/Quality Manager

