

Fasken Oil and Ranch, Ltd. Laguna "16" State No. 2-H Work plan

Lea County, New Mexico

April 1, 2013



1RP-5042

Prepared for:

**Fasken Oil and Ranch, Ltd.
6101 Holiday Hill Road
Midland, Texas 79707**

approved
Jeffrey LeKing
Environmental Specialist

NMCCD - DIST 1

4/9/13

By:

**Safety & Environmental Solutions, Inc.
703 East Clinton Street
Hobbs, New Mexico 88240
(575) 397-0510**

TABLE OF CONTENTS

I. COMPANY CONTACTS.....	1
II. BACKGROUND.....	1
III. SURFACE AND GROUND WATER.....	1
IV. CHARACTERIZATION.....	1
V. WORK PERFORMED.....	2
VI. ACTION PLAN.....	2
VII. FIGURES & APPENDICES	2
Figure 1 – Vicinity Map.....	3
Figure 2 – Site Plan	4
Appendix A – C-141	5

I. Company Contacts

Representative	Company	Telephone	E-mail
Jimmy Carlile	Fasken Oil and Ranch	432-687-1777	jimmyc@forl.com
Bob Allen	SESI	575-397-0510	ballen@sesi-nm.com

II. Background

Safety and Environmental Solutions, Inc. (SESI) was engaged by Fasken Oil and Ranch (Fasken) to perform site assessment of a release area at the Laguna 16 State No. 2H located in Section 16 of Township 20 South, Range 32 East, Lea County, New Mexico.

The New Mexico Oil Conservation Division (OCD) C-141 was filed on March 13, 2013. The cause of the release was a dump valve on a vessel hung open. The open valve caused excess fluid to spill out of the flare stack. Approximately 120 barrels of produced fluids was released and 119 barrels were recovered. The majority of the spill was confined to the bermed area around the flare stack.

III. Surface and Ground Water

The nearest groundwater record is listed with the United States Geological Survey (USGS) is in Section 23 Range 32 East and Township 20 South, which is located 1.9 miles southeast of the site. The depth to groundwater was reported at 39.83 feet in January 30, 1996. The New Mexico Office of the State Engineer did not have records of any groundwater withdrawals in Township 20 South Range 32 East.

IV. Characterization

The target cleanup levels determined using the "Guidelines for Remediation of Leaks, Spills and Releases" (NMOCD, August 13, 1993).

Application of the OCD's ranking criteria for contaminated soils indicates 100 parts per million (ppm) Total Petroleum Hydrocarbons (TPH), as presented in the following determinations:

Depth to Ground Water:			
(Vertical distance from contaminants to seasonal high water elevation of groundwater)	Less than 50 feet	20 points	X
	50 feet to 99 feet	10 points	
	>100 feet	0 points	
Wellhead Protection Area:			
(Less than 200 feet from a private domestic water source; or less than 1000 feet from all other water sources)	Yes	20 points	
	No	0 points	X
Distance to Surface Water:			
(Horizontal distance to perennial lakes, ponds, rivers, streams, creeks, irrigation canals and ditches)	Less than 200 feet	20 points	
	200 feet to 1000 feet	10 points	
	>1000 feet	0 points	X
RANKING SCORE (TOTAL POINTS)			20

V. Work Performed

On March 25, 2013, SESI was onsite at the Laguna 16 State No. 2H and observed fluid level marks inside the bermed area around the flare stack. Minor spray was observed on the berm and just outside the berm to the west. One call will be made for this site for all lines within 100' of the flare stack.

No sampling was performed at the site.

VI. Action Plan

All impacted soil will be excavated from the area of the flare stack. The vertical and horizontal extent of contamination will be determined during excavation. The excavated soil will be transported to an approved NMOCD facility. Confirmation samples will be retrieved and properly preserved and transported under chain of custody to Cardinal Labs of Hobbs, New Mexico. The samples will be analyzed for Benzene, Toluene, Ethyl Benzene, Total Xylenes (BTEX EPA Method 8021) and Total Petroleum Hydrocarbons (TPH EPA Method 418.1).

The excavated areas will then be backfilled with clean soils and the berm will be reconstructed..

VII. Figures & Appendices

Figure 1 – Vicinity Map

Figure 2 – Site Plan

Appendix A – C-141

Figure 1
Vicinity Map

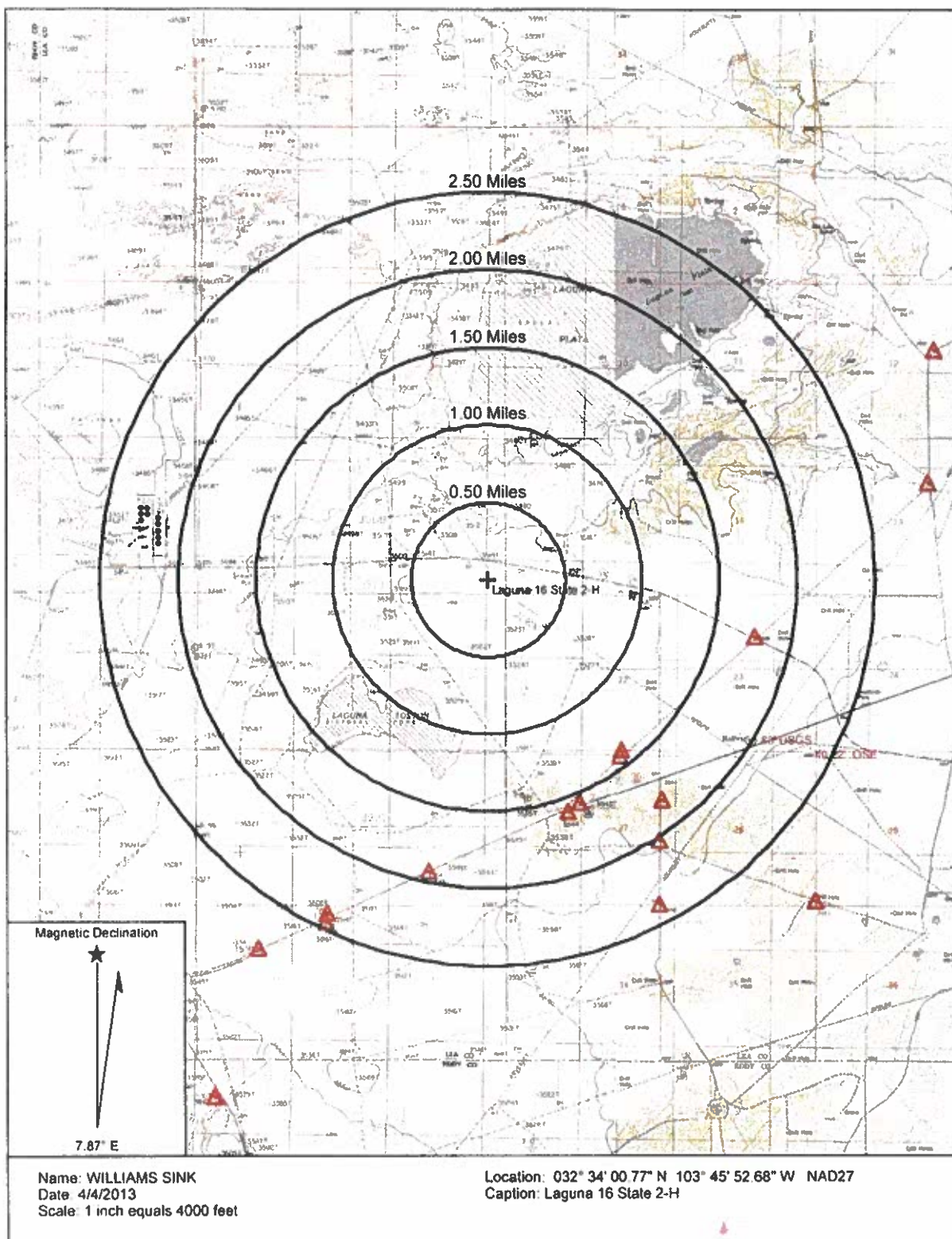

Figure 2 Site Plan

Google

© 2004 Google

Laguna High State 244 ©

243

5488



Appendix A

C-141