

Disclosure Report

Basin Environmental Service Technologies (BEST)

P.O. Box 2948, Hobbs, NM 88241

Phone: 575-393-2967

RICE OPERATING COMPANY
JUNCTION BOX DISCLOSURE* REPORT
BOX LOCATION

SWD SYSTEM	JUNCTION	UNIT	SECTION	TOWNSHIP	RANGE	COUNTY	BOX DIMENSIONS - FEET		
Blinebry-Drinkard (BD)	L-8 EOL	L	8	21S	37E	Lea	Length - n/a	Width - n/a	Depth - n/a
							same location		

LAND TYPE: BLM _____ STATE _____ FEE LANDOWNER Nymeyer Properties OTHER _____

Depth to Groundwater 79 feet NMOCD SITE ASSESSMENT RANKING SCORE: 10

Date Started 6/21/2017 Date Completed 9/15/2017 OCD Witness No

Soil Excavated 200 cubic yards Excavation Length 30 Width 15 Depth 12 feet

Soil Disposed 276 cubic yards Offsite Facility Sundance Services Location Eunice, NM

FINAL ANALYTICAL RESULTS: Sample Date 6/27/2017, 9/14/2017 Sample Depth 12 ft

TPH and Chloride laboratory test results completed by using an approved lab and testing procedures pursuant to NMOCD guidelines.

CHLORIDE FIELD TESTS

Sample Location	PID (field) ppm	GRO mg/kg	DRO mg/kg	Chloride mg/kg
5 pt. Bottom Comp.	0.0	<10	<10	1,390
4 Wall Comp.	0.1	<10	<10	640
Imported Top Soil	0.0			80

LOCATION	DEPTH	mg/kg
5 pt. bottom comp	12'	554
4 wall comp	n/a	1,285
imported top soil	n/a	86
background	6"	88
vertical delineation trench at 15' west of the junction	2'	1,001
	4'	991
	6'	1,204
	8'	2,234
	10'	2,571
	12'	4,852

General Description of Remedial Action: This junction was addressed during the pipeline replacement/upgrade program. A new, water-tight junction box was built in the same location as the former. An investigation was conducted using a backhoe to collect soil samples at regular intervals, creating a 30x15x12 ft deep excavation.

Each sample was field titrated for chloride and field screened for organic vapors using a PID, resulting in chloride concentrations increased with depth. A total of 276 yards of excavated soil were transported to a NMOCD approved facility for disposal, and clean soil was imported to use as backfill. Representative composite samples of the imported soil, excavation walls, and excavation bottom were sent to a commercial laboratory for analysis of chloride and TPH. The excavation was padded with 6 inches of imported soil, and a 20-mil, reinforced liner was installed and properly seated at 11.5 ft bgs. The top of the liner was padded with an additional 6 inches of imported soil, and the excavation was backfilled to ground surface with the imported soil. On 9/15/2017, the site was seeded with a blend of native vegetation and is expected to return to productive capacity at a normal rate. NMOCD was notified of potential groundwater impact on 3/15/2018.

ADDITIONAL EVALUATION IS **MEDIUM** PRIORITY

enclosures: geographical location map, area map, photos, lab results, PID (field) screenings, cross-section, chloride curve, revegetation form

I HEREBY CERTIFY THAT THE INFORMATION ABOVE IS TRUE AND COMPLETE TO THE BEST OF MY KNOWLEDGE AND BELIEF.

REPORT

ASSEMBLED BY Gentry Henry SIGNATURE _____ COMPANY Rice Operating Company

SITE SUPERVISOR Karanja Lewis SIGNATURE  COMPANY Basin Environmental Service Technologies

PROJECT LEADER Jacob Kamplain SIGNATURE (not available) DATE 3/1/2018

*This site is a "DISCLOSURE." It will be placed on a prioritized list of similar sites for further consideration.

Geographical Location Map

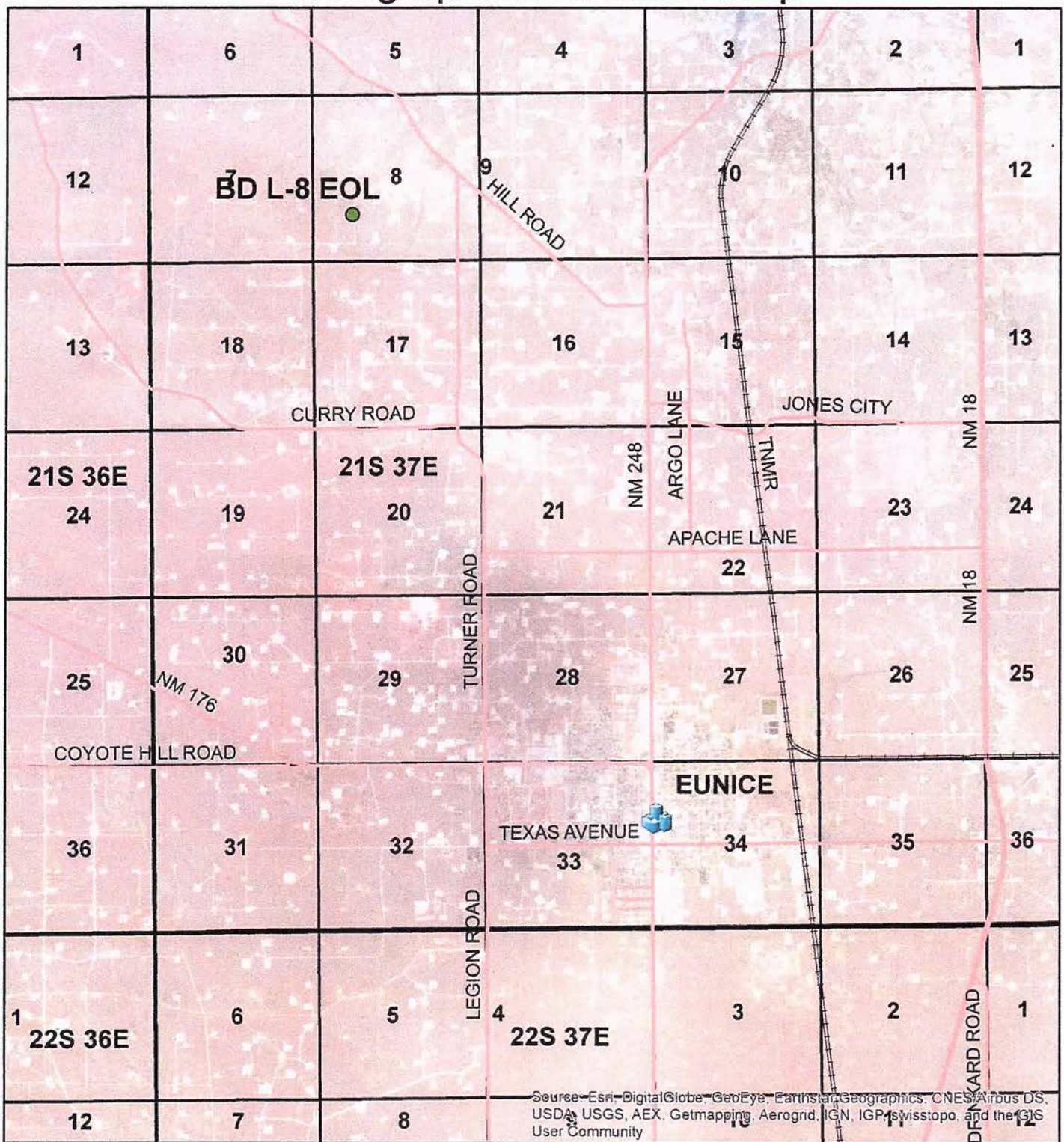

BD L-8 EOL

**Legals: UL/L sec. 8
T-21-S R-37-E
LEA COUNTY, NM**

**Underground facilities are
spatially projected
and need to be field verified.**

GPS: 32.489912, -103.189570

0 0.5 1
Miles

Drawing date: 5/27/15
Drafted by: L. Weinheimer



Area Map

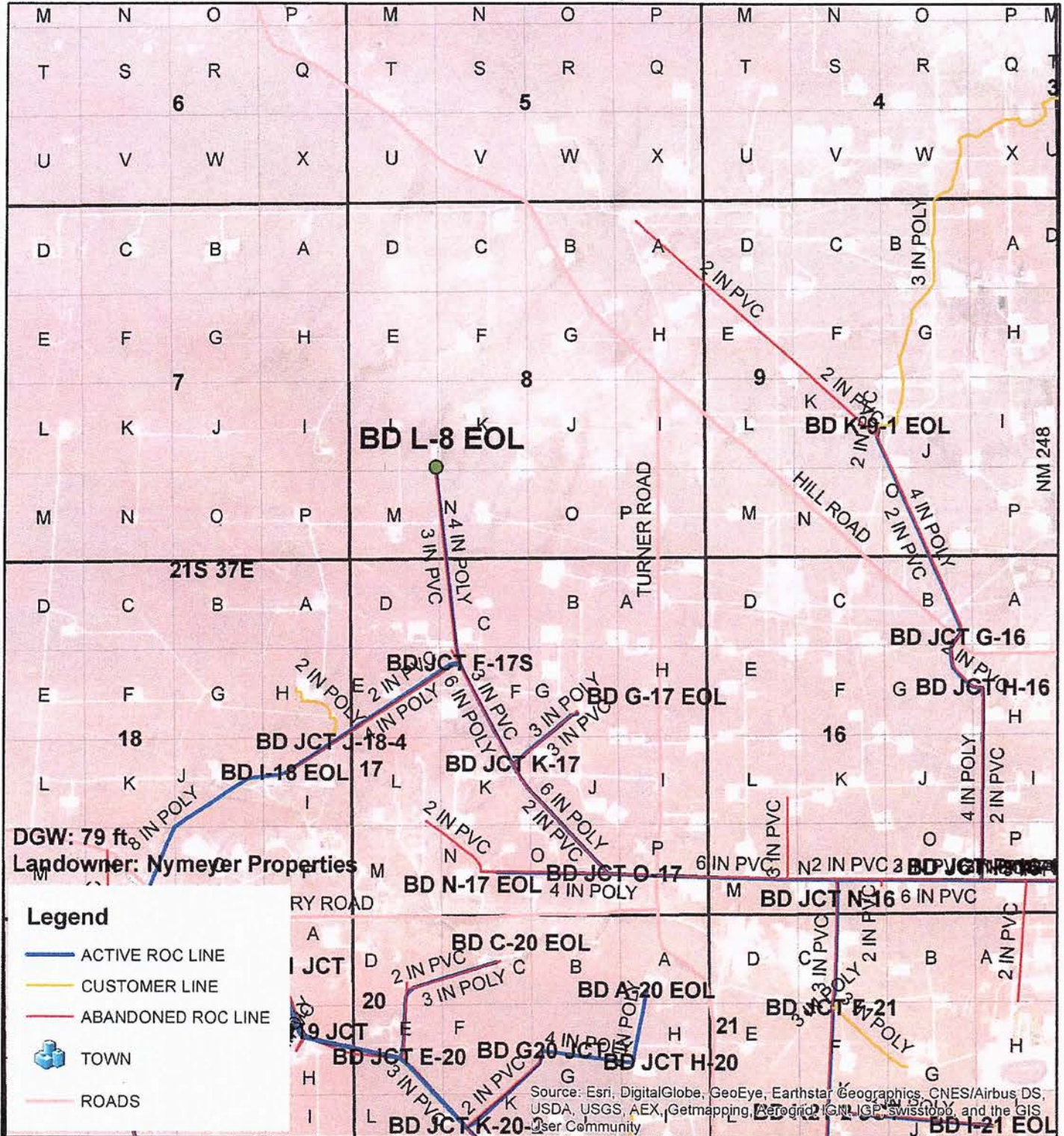

BD L-8 EOL

**Legals: UL/L sec. 8
T-21-S R-37-E
LEA COUNTY, NM**

Underground facilities are spatially projected and need to be field verified.

GPS: 32.489912, -103.189570

0 0.2 0.4

■ ■ ■ □ Miles

Drawing date: 5/27/15
Drafted by: L. Weinheimer



BD L-8 EOL

Unit L, Sec. 8, T21S, R37E



Current box with vertical excavated to the west,
facing south 6/21/2017



Exporting excavated soil,
facing north 6/26/2017



Excavating and collecting soil samples,
facing north, 6/27/2017



Importing soil,
facing northwest 6/27/2017



6 inch pad of imported soil,
facing south 6/28/2017



20-mil, reinforced liner installed at 11.5 ft bgs,
facing south 6/28/2017

BD L-8 EOL

Unit L, Sec. 8, T21S, R37E



Backfilling above liner with imported soil,
facing south 6/28/2017



Backfilling excavation,
facing northeast 6/29/2017



Hand seeding site, facing north 9/15/2017



Raking in the seed,
facing southwest 9/15/2017



PHONE (575) 393-2326 • 101 E. MARLAND • HOBBS, NM 88240

June 30, 2017

KATIE JONES

Rice Operating Company

112 W. Taylor

Hobbs, NM 88240

RE: BD L-8 EOL

Enclosed are the results of analyses for samples received by the laboratory on 06/27/17 16:15.

Cardinal Laboratories is accredited through Texas NELAP under certificate number T104704398-16-8. Accreditation applies to drinking water, non-potable water and solid and chemical materials. All accredited analytes are denoted by an asterisk (*). For a complete list of accredited analytes and matrices visit the TCEQ website at www.tceq.texas.gov/field/qa/lab_accred_certif.html.

Cardinal Laboratories is accredited through the State of Colorado Department of Public Health and Environment for:

Method EPA 552.2	Haloacetic Acids (HAA-5)
Method EPA 524.2	Total Trihalomethanes (TTHM)
Method EPA 524.4	Regulated VOCs (V1, V2, V3)

Accreditation applies to public drinking water matrices.

This report meets NELAP requirements and is made up of a cover page, analytical results, and a copy of the original chain-of-custody. If you have any questions concerning this report, please feel free to contact me.

Sincerely,

A handwritten signature in black ink that reads "Celey D. Keene". The signature is written in a cursive style with a large, stylized 'C' and 'K'.

Celey D. Keene

Lab Director/Quality Manager

Analytical Results For:

Rice Operating Company
KATIE JONES
112 W. Taylor
Hobbs NM, 88240
Fax To: (575) 397-1471

Received: 06/27/2017
Reported: 06/30/2017
Project Name: BD L-8 EOL
Project Number: (21 - 37)
Project Location: NONE GIVEN

Sampling Date: 06/27/2017
Sampling Type: Soil
Sampling Condition: ** (See Notes)
Sample Received By: Tamara Oldaker

Sample ID: 5 PT. BOTTOM COMP (H701687-01)

Chloride, SM4500Cl-B		mg/kg	Analyzed By: AC						
Analyte	Result	Reporting Limit	Analyzed	Method Blank	BS	% Recovery	True Value QC	RPD	Qualifier
Chloride	1390	16.0	06/28/2017	ND	432	108	400	0.00	
TPH 8015M		mg/kg	Analyzed By: MS						
Analyte	Result	Reporting Limit	Analyzed	Method Blank	BS	% Recovery	True Value QC	RPD	Qualifier
GRO C6-C10	<10.0	10.0	06/28/2017	ND	189	94.6	200	6.22	
DRO >C10-C28	<10.0	10.0	06/28/2017	ND	190	95.1	200	5.51	
Surrogate: 1-Chlorooctane	83.0 %	28.3-164							
Surrogate: 1-Chlorooctadecane	86.0 %	34.7-157							

Sample ID: 4 WALL COMP (H701687-02)

Chloride, SM4500Cl-B		mg/kg	Analyzed By: AC						
Analyte	Result	Reporting Limit	Analyzed	Method Blank	BS	% Recovery	True Value QC	RPD	Qualifier
Chloride	640	16.0	06/28/2017	ND	432	108	400	0.00	
TPH 8015M		mg/kg	Analyzed By: MS						
Analyte	Result	Reporting Limit	Analyzed	Method Blank	BS	% Recovery	True Value QC	RPD	Qualifier
GRO C6-C10	<10.0	10.0	06/28/2017	ND	189	94.6	200	6.22	
DRO >C10-C28	<10.0	10.0	06/28/2017	ND	190	95.1	200	5.51	
Surrogate: 1-Chlorooctane	90.9 %	28.3-164							
Surrogate: 1-Chlorooctadecane	85.2 %	34.7-157							

Cardinal Laboratories

*=Accredited Analyte

PLEASE NOTE: Liability and Damages. Cardinal's liability and client's exclusive remedy for any claim arising, whether based in contract or tort, shall be limited to the amount paid by client for analyses. All claims, including those for negligence and any other cause whatsoever shall be deemed waived unless made in writing and received by Cardinal within thirty (30) days after completion of the applicable service. In no event shall Cardinal be liable for incidental or consequential damages, including, without limitation, business interruptions, loss of use, or loss of profits incurred by client, its subsidiaries, affiliates or successors arising out of or related to the performance of the services hereunder by Cardinal, regardless of whether such claim is based upon any of the above stated reasons or otherwise. Results relate only to the samples identified above. This report shall not be reproduced except in full with written approval of Cardinal Laboratories.



Celey D. Keene, Lab Director/Quality Manager

Notes and Definitions

ND	Analyte NOT DETECTED at or above the reporting limit
RPD	Relative Percent Difference
**	Samples not received at proper temperature of 6°C or below.
***	Insufficient time to reach temperature.
-	Chloride by SM4500Cl-B does not require samples be received at or below 6°C
	Samples reported on an as received basis (wet) unless otherwise noted on report

Cardinal Laboratories

* = Accredited Analyte

PLEASE NOTE: Liability and Damages. Cardinal's liability and client's exclusive remedy for any claim arising, whether based in contract or tort, shall be limited to the amount paid by client for analyses. All claims, including those for negligence and any other cause whatsoever shall be deemed waived unless made in writing and received by Cardinal within thirty (30) days after completion of the applicable service. In no event shall Cardinal be liable for incidental or consequential damages, including, without limitation, business interruptions, loss of use, or loss of profits incurred by client, its subsidiaries, affiliates or successors arising out of or related to the performance of the services hereunder by Cardinal, regardless of whether such claim is based upon any of the above stated reasons or otherwise. Results relate only to the samples identified above. This report shall not be reproduced except in full with written approval of Cardinal Laboratories.



Celey D. Keene, Lab Director/Quality Manager

ARDINAL LABORATORIES

101 East Marland, Hobbs, NM 88240 2111 Beechwood, Abilene, TX 79603
(505) 393-2326 FAX (505) 393-2476 (325) 673-7001 FAX (325) 673-7020

[illegible]

† Cardinal cannot accept verbal changes. Please fax written changes to 505-393-2476

BASIN ENVIRONMENTAL SERVICE TECHNOLOGIES

PO Box 301 Lovington, NM 88260
PHONE: (575) 396-2378 FAX: (575) 396-1429
PID METER CALIBRATION & FIELD REPORT FORM

CK.	<input type="checkbox"/>	MODEL: PGM 7300	SERIAL NO: 590-000508
MODEL	<input type="checkbox"/>	MODEL: PGM 7300	SERIAL NO: 590-000504
NO.	<input checked="" type="checkbox"/>	MODEL: PGM 7300	SERIAL NO: 590-902690
	<input type="checkbox"/>	MODEL: PGM 7300	SERIAL NO: 590-000183

GAS COMPOSITION: ISOBUTYLENE 100 PPM / AIR: BALANCE

LOT NO: TFAO-248-100-11	EXPIRATION DATE: 5/21/2018
METER READING ACCURACY: 100 ppm	

ACCURACY : +/- 2%

COMPANY
RICE OPERATING

SYSTEM	JUNCTION	UNIT	SECTION	TOWN SHIP	RANGE
BD	L-8 EOL	L	8	21S	37E

SAMPLE ID	PID	SAMPLE ID	PID
4-Wall Composite	0.1		
5 Pt. Bottom Composite	0.0		

I verify that I have calibrated the above instrument in accordance to the manufacture operation manual.

SIGNATURE: _____

DATE: 6/27/2017

September 20, 2017

KATIE JONES

Rice Operating Company

112 W. Taylor

Hobbs, NM 88240

RE: BD L-8 EOL

Enclosed are the results of analyses for samples received by the laboratory on 09/14/17 13:45.

Cardinal Laboratories is accredited through Texas NELAP under certificate number T104704398-16-8. Accreditation applies to drinking water, non-potable water and solid and chemical materials. All accredited analytes are denoted by an asterisk (*). For a complete list of accredited analytes and matrices visit the TCEQ website at www.tceq.texas.gov/field/qa/lab_accred_certif.html.

Cardinal Laboratories is accredited through the State of Colorado Department of Public Health and Environment for:

Method EPA 552.2	Haloacetic Acids (HAA-5)
Method EPA 524.2	Total Trihalomethanes (TTHM)
Method EPA 524.4	Regulated VOCs (V1, V2, V3)

Accreditation applies to public drinking water matrices.

This report meets NELAP requirements and is made up of a cover page, analytical results, and a copy of the original chain-of-custody. If you have any questions concerning this report, please feel free to contact me.

Sincerely,



Celey D. Keene

Lab Director/Quality Manager

Analytical Results For:

Rice Operating Company
KATIE JONES
112 W. Taylor
Hobbs NM, 88240
Fax To: (575) 397-1471

Received: 09/14/2017
Reported: 09/20/2017
Project Name: BD L-8 EOL
Project Number: NONE GIVEN
Project Location: NONE GIVEN

Sampling Date: 09/14/2017
Sampling Type: Soil
Sampling Condition: ** (See Notes)
Sample Received By: Jodi Henson

Sample ID: IMPORTED TOP SOIL (H702480-01)

Chloride, SM4500Cl-B

mg/kg

Analyzed By: AC

Analyte	Result	Reporting Limit	Analyzed	Method Blank	BS	% Recovery	True Value QC	RPD	Qualifier
Chloride	80.0	16.0	09/15/2017	ND	432	108	400	3.64	

Cardinal Laboratories

*=Accredited Analyte

PLEASE NOTE: Liability and Damages. Cardinal's liability and client's exclusive remedy for any claim arising, whether based in contract or tort, shall be limited to the amount paid by client for analyses. All claims, including those for negligence and any other cause whatsoever shall be deemed waived unless made in writing and received by Cardinal within thirty (30) days after completion of the applicable service. In no event shall Cardinal be liable for incidental or consequential damages, including, without limitation, business interruptions, loss of use, or loss of profits incurred by client, its subsidiaries, affiliates or successors arising out of or related to the performance of the services hereunder by Cardinal, regardless of whether such claim is based upon any of the above stated reasons or otherwise. Results relate only to the samples identified above. This report shall not be reproduced except in full with written approval of Cardinal Laboratories.



Celey D. Keene, Lab Director/Quality Manager

Notes and Definitions

QM-07	The spike recovery was outside acceptance limits for the MS and/or MSD. The batch was accepted based on acceptable LCS recovery.
ND	Analyte NOT DETECTED at or above the reporting limit
RPD	Relative Percent Difference
**	Samples not received at proper temperature of 6°C or below.
***	Insufficient time to reach temperature.
-	Chloride by SM4500Cl-B does not require samples be received at or below 6°C Samples reported on an as received basis (wet) unless otherwise noted on report

Cardinal Laboratories

*=Accredited Analyte

PLEASE NOTE: Liability and Damages. Cardinal's liability and client's exclusive remedy for any claim arising, whether based in contract or tort, shall be limited to the amount paid by client for analyses. All claims, including those for negligence and any other cause whatsoever shall be deemed waived unless made in writing and received by Cardinal within thirty (30) days after completion of the applicable service. In no event shall Cardinal be liable for incidental or consequential damages, including, without limitation, business interruptions, loss of use, or loss of profits incurred by client, its subsidiaries, affiliates or successors arising out of or related to the performance of the services hereunder by Cardinal, regardless of whether such claim is based upon any of the above stated reasons or otherwise. Results relate only to the samples identified above. This report shall not be reproduced except in full with written approval of Cardinal Laboratories.

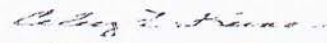

Celey D. Keene, Lab Director/Quality Manager

BASIN ENVIRONMENTAL SERVICE TECHNOLOGIES

PO Box 301 Lovington, NM 88260
PHONE: (575) 396-2378 FAX: (575) 396-1429
PID METER CALIBRATION & FIELD REPORT FORM

CK. ☐
MODEL ☐
NO. ☒

MODEL: PGM 7300 SERIAL NO: 590-000508
MODEL: PGM 7300 SERIAL NO: 590-000504
MODEL: PGM 7300 SERIAL NO: 590-902690
MODEL: PGM 7300 SERIAL NO: 590-000183

GAS COMPOSITION: ISOBUTYLENE 100 PPM / AIR: BALANCE

LOT NO: TFAO-248-100-11	EXPIRATION DATE: 5/21/2018
METER READING ACCURACY: 100 ppm	

ACCURACY : +/- 2%

COMPANY
RICE OPERATING

SYSTEM	JUNCTION	UNIT	SECTION	TOWN SHIP	RANGE
BD	L-8 EOL	L	8	21S	37E

SAMPLE ID	PID	SAMPLE ID	PID
Imported Soil	0.0		

I verify that I have calibrated the above instrument in accordance to the manufacture operation manual.

SIGNATURE: _____

DATE: 6/28/2017

BD L-8 EOL
Unit 'L', Sec. 8, T21S, R37E

Excavation Cross-Section

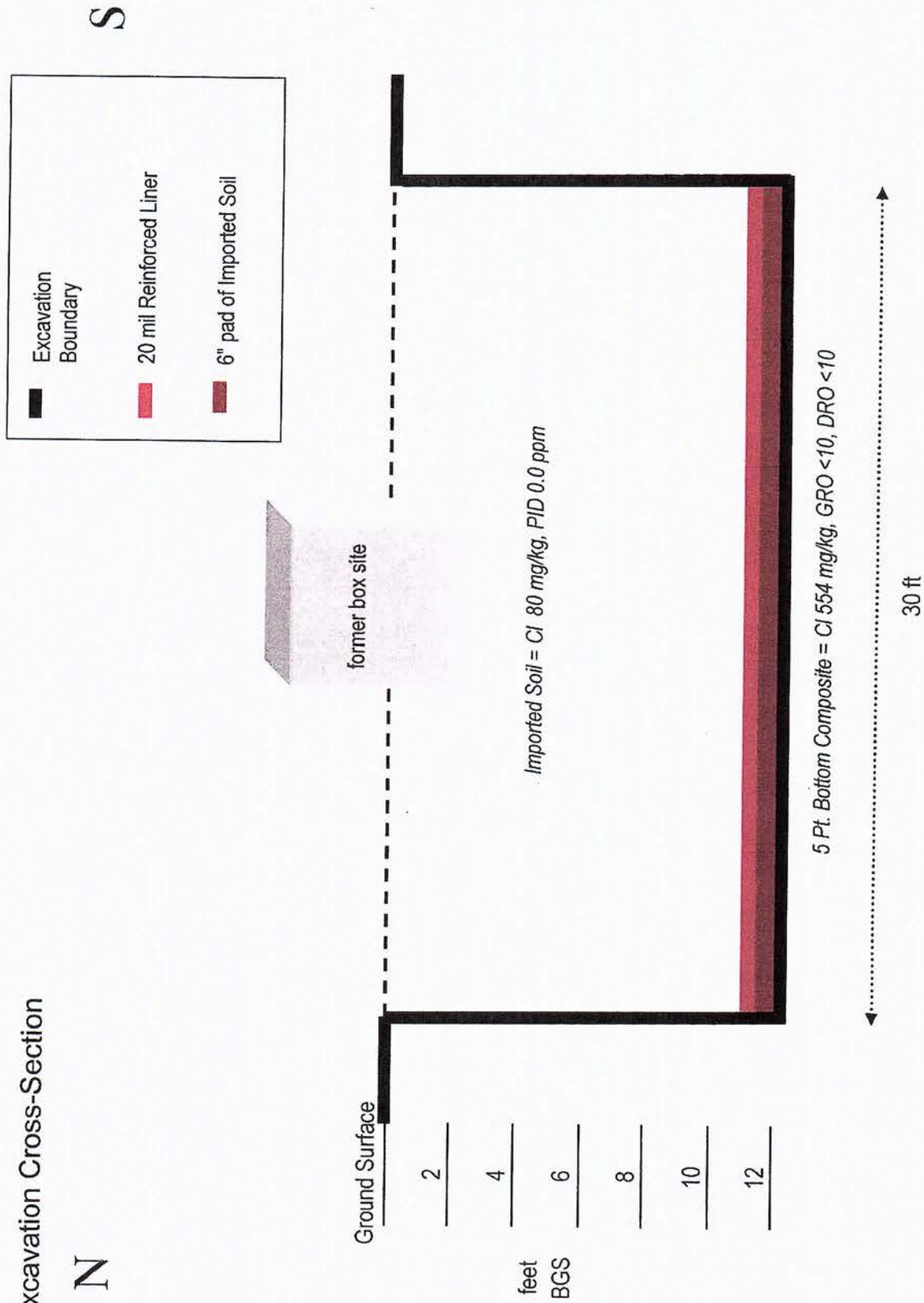

CHLORIDE CONCENTRATION CURVE

RICE Operating Company

BD L-8 EOL

Unit 'L', Sec. 8, T21S, R37E

Backhoe samples at 15' west of junction

Depth bgs (ft)	[Cl ⁻] ppm
2	1,001
4	991
6	1,204
8	2,234
10	2,571
12	4,852

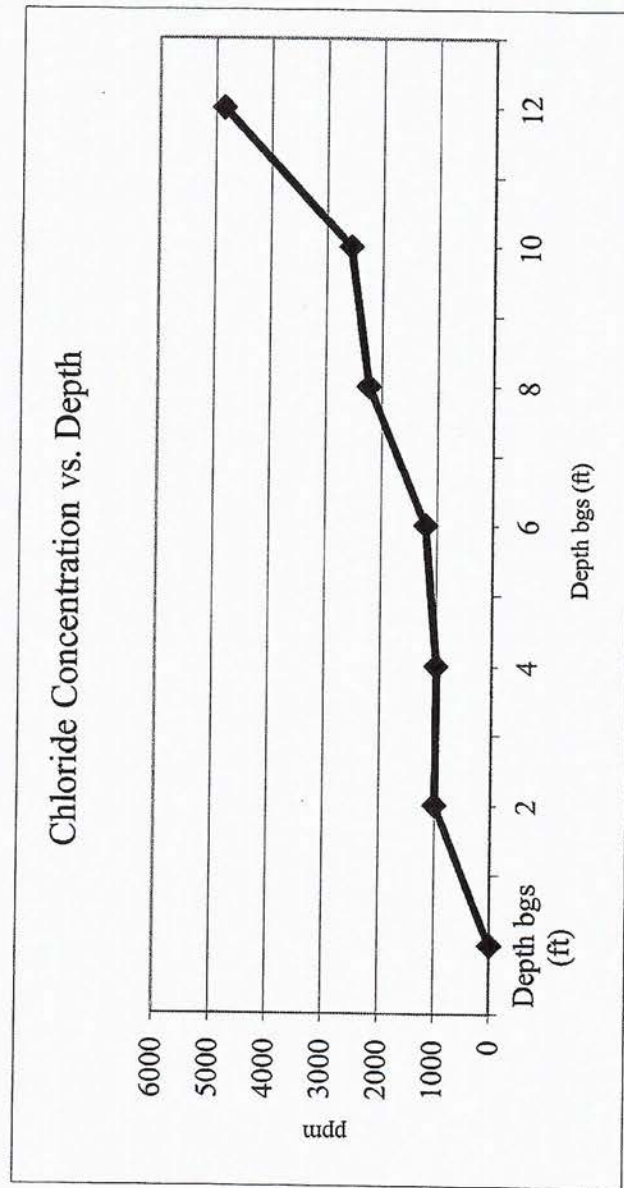

Groundwater = 79 ft

419 W. Cain
Hobbs, NM 88240



Phone: (575) 393-2967
Fax: (575) 393-0293

VEGETATION FORM

1. General Information

Site name: BD L-8 EOL						
U/L L	Section 8	Township 21S	Range 37E	County Lea	Latitude 32.489912	Longitude -103.18957
Contact Name: Jacob Kamplain						
Email: jkamplain@basinenv.com						
Site size:		6,423	Square feet			

2. Soils

**Do not rip caliche subsoils; caliche rocks brought to the surface by ripping shall be removed.*

Salvaged from site		Bioremediated		Imported	X	Blended		Depth (in)	
Texture: top soil		Describe soil & subsoil: sandy							
Soil prep methods:	Rip		Depth (in)		Disc		Depth (in)		Rollerpack
Date completed: 6/29/2017									

3. Bioremediation

Fertilizer		Hay		Other	
Type:				Describe:	
Lbs/acre:					

4. Seeding

**Attach seed bag tags to this form. Seed bag tags shall contain the site name and S-T-R.*

Custom Seed Mix	X	Prescribed Mix		Seed Mix Name: 6 lbs warm season mix	Date: 9/15/2017
Broadcast				Method: by hand	
Soil conditions during seed:	Dry	X	Damp	Wet	
Observations:					

5. Certification

I hereby certify that the information in this form and attachments is true and complete to the best of my knowledge and belief.

Name: Karanja Lewis	Title: Environmental Tech	Date: 9/15/2017
Signature:		