

APPROVED

By Olivia Yu at 10:27 am, Sep 05, 2018

NMOCD approves
1RP-4725 for closure.

talonlpe.com • 866.742.0742



Remediation Activities and Closure Report

Cockburn Fed 2

API # 30-025-36282 * 1RP-4725-0

Prepared For:

Devon Energy Corporation
6488 Seven Rivers Hwy
Artesia, New Mexico 88210

Prepared By:

TALON/LPE
408 W. Texas Avenue
Artesia, New Mexico 88210

May 28, 2018

Ms. Olivia Yu
NMOCD District 1
1625 N. French Dr.
Hobbs, NM 88240

Subject: **Remediation Activities and Closure Report**
Cockburn Fed 2
API # 30-025-36282 * **1RP-4725-0**

Dear Ms. Yu,

Devon Energy Corporation had contracted Talon/LPE (Talon) to perform soil assessment and remediation services at the above referenced location. The incident description, soil sampling results, remediation activities and closure request are submitted herein.

Site Information

The Cockburn Fed 2 is located approximately thirty-three (33) miles west of Hobbs, New Mexico. The legal location for this release is Unit Letter M, Section 10, Township 18 South and Range 33 East in Lea County, New Mexico. More specifically the latitude and longitude for the release are 32.7565918 North and -103.6573715 West. A site plan is presented in [Appendix I](#).

According to the soil survey provided by the United States Department of Agriculture Natural Resources Conservation Service, the soil in this area is made up of Kermit-Palomas fine sands with 0 to 12 percent slopes. Per the New Mexico Bureau of Geology and Mineral Resources, the local surface and shallow geology is Holocene to middle Pleistocene in age and is comprised of eolian sands and piedmont-slope deposits. Drainage courses in this area are normally dry.

Ground Water and Site Ranking

The New Mexico State Engineer web site indicates the average depth to ground water is 58' below ground surface (BGS). See [Appendix II](#) for referenced groundwater data. The USGS data base indicates an average groundwater depth to be 50-feet or less.

Therefore the ranking for this site is a **20** based on the following:

Depth to ground water	<50'
Wellhead Protection Area	>1000'
Distance to surface water body	>1000'

Based upon the site ranking of **20**, NMOCD Recommended Remedial Action Levels (RRAL) are 50 mg/kg for BTEX, 10 mg/kg for Benzene and <100 mg/kg for TPH. The recommended guideline for Total Chlorides is 600 mg/kg.

Incident Description and Initial Remedial Actions

On May 31, 2017, a fiberglass produced water tank at the Cockburn Fed 2 was struck by lightning resulting in a release of 140 barrels of fluid. All fluids were contained within the earthen berm on the location. A vac truck was called to the location and recovered 100 barrels of fluid. The battery was immediately shut-in. A site plan is presented in [Appendix I](#) which illustrates the impacted area.

Remedial Actions

In accordance with an approved work plan with stipulations from NMOCD District I office and follow-up emails, all remediation activities and stipulations were adhered too. See attached NMOCD emails regarding the stipulations/conditions in [Appendix III](#).

All impacted soil was excavated and transported to Lea Land, LLC, a NMOCD approved solid waste disposal facility.

The excavated areas on location were backfilled with new caliche, machine compacted and re-contoured to match the surrounding location.

Laboratory Results for Confirmation Sampling

See [Appendix IV](#) for complete report of laboratory results.

Sample ID	Depth (feet)	BTEX (mg/kg)	Chlorides (mg/kg)	TPH (mg/kg) GRO	TPH (mg/kg) DRO	TPH (mg/kg) EXT	Total TPH
S-1	5.0	-	64	<10.0	<10.0	11.9	11.9
North Sidewall	1.0	-	400	<10.0	<10.0	<10.0	<10.0
South Sidewall	1.0	-	16.0	<10.0	<10.0	<10.0	<10.0
East Sidewall	1.0	-	64.0	<10.0	<10.0	<10.0	<10.0
West Sidewall	1.0	-	16.0	<10.0	<10.0	<10.0	<10.0
S-4	1.0	-	96	-	-	-	-
North Sidewall	1.0	-	208	-	-	-	-
South Sidewall	1.0	-	16	-	-	-	-
West Sidewall	1.0	-	<16.0	-	-	-	-

Sample ID	Depth (feet)	BTEX (mg/kg)	Chlorides (mg/kg)	TPH (mg/kg) GRO	TPH (mg/kg) DRO	TPH (mg/kg) EXT	Total TPH
S-5	1	-	128	-	-	-	-
North Sidewall	1	-	144	-	-	-	-
South Sidewall	1	-	16.0	-	-	-	-
East Sidewall	1	-	48.0	-	-	-	-
West Sidewall	1	-	96.0	-	-	-	-

--Analyte Not Tested

Closure

On behalf of Devon Energy Company we respectfully request that no further actions be required at this site and that closure with regard to this incident be granted.

Should you have any questions or if further information is required, please do not hesitate to contact our office at (575)-746-8768

Respectfully submitted,

TALON/LPE



Jacob Laird
Environmental Scientist



Kimberly M. Wilson
Project Manager

Attachments:

- Appendix I Site Plan
- Appendix II Ground Water Data
- Appendix III Regulatory Emails
- Appendix IV Laboratory Results

APPENDIX I

SITE PLAN

Cockburn Fed 2
Devon Energy, Lea County, NM

Legend
Excavated Area
Sample Locations

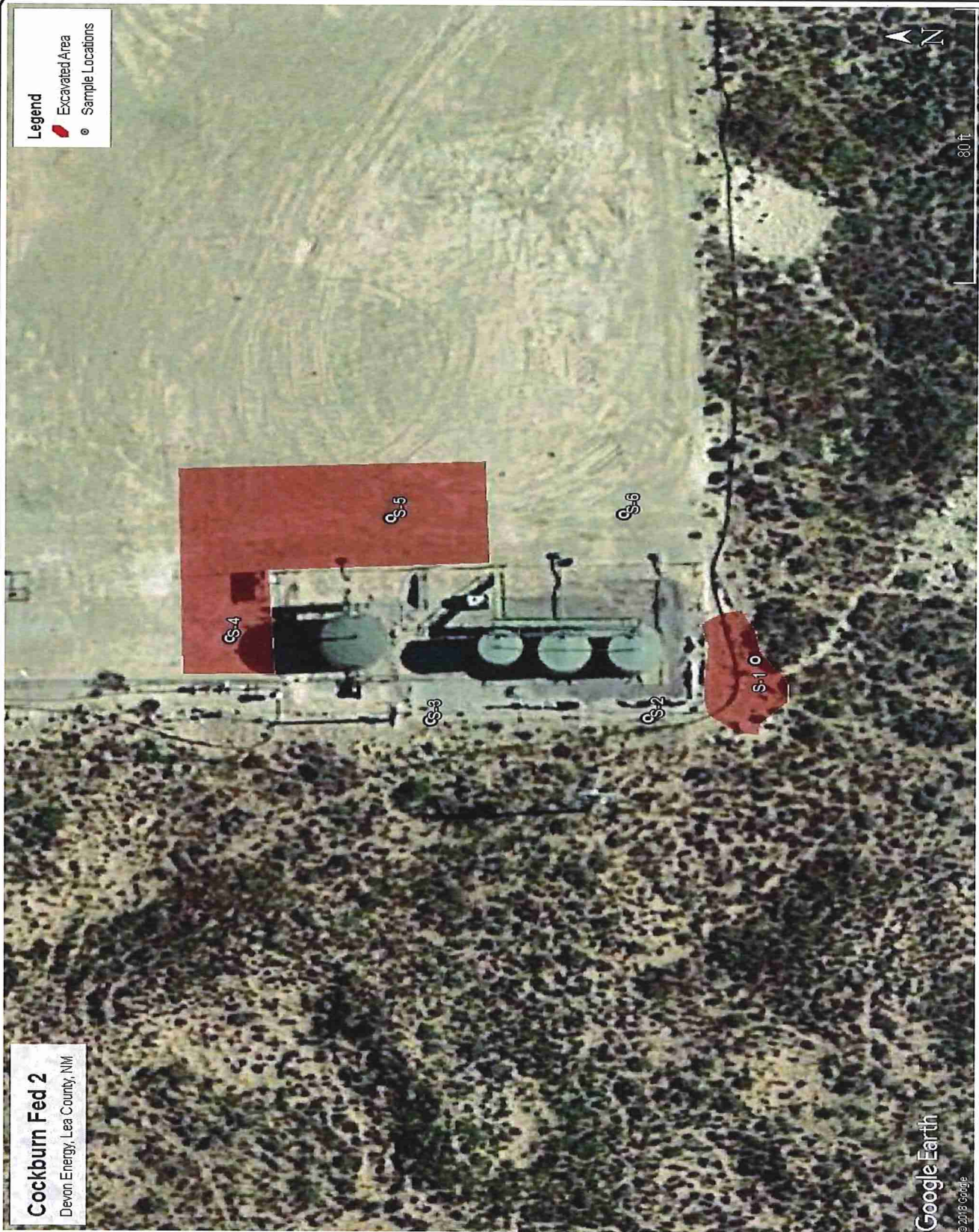

Date: 04-24-18
Scale: Not to Scale
Drawn By: JL

FIGURE 1
AERIAL MAP
Cockburn Fed 2
Lea County, NM
Prepared For: Devon Energy

APPENDIX II

GROUNDWATER DATA



New Mexico Office of the State Engineer Water Column/Average Depth to Water

(A CLW##### in the POD suffix indicates the POD has been replaced & no longer serves a water right file.)

(R=POD has been replaced,
O=orphaned,

C=the file is closed)

(quarters are 1=NW 2=NE 3=SW 4=SE)

(quarters are smallest to largest)

(NAD83 UTM in meters)

(In feet)

POD Number	Code	POD Sub-basin	County	Q	Q	Q	Sec	Tws	Rng	X	Y	Distance	DepthWell	DepthWater	Water Column
CP 00546 POD1	CP	LE		2	2	4	09	18S	33E	625464	3625597*	591	90	70	20
CP 00072 POD3	CP	LE		2	4	4	10	18S	33E	627076	3625223*	1313	70		
CP 01417 POD1	CP	LE					11	18S	33E	627036	3625738	1422	120	54	66
CP 00072 POD4	CP	LE		1	4	2	10	18S	33E	626865	3626028*	1442	70		
CP 00701	CP	LE			1	3	11	18S	33E	627373	3625534*	1663	100		
CP 00701 POD2	CP	LE		4	1	3	11	18S	33E	627472	3625433*	1736	100		
L 04649	L	LE		1	1	3	03	18S	33E	625644	3627213*	2126	100	45	55
CP 00758 POD1	CP	LE				3	04	18S	33E	624345	3626886*	2291	250		
CP 00072 POD5	CP	LE		2	1	4	11	18S	33E	628219	3625573	2496	100	64	36

Average Depth to Water: **58 feet**

Minimum Depth: **45 feet**

Maximum Depth: **70 feet**

Record Count:9

UTMNAD83 Radius Search (in meters):

Easting (X): 625769.33

Northing (Y): 3625090.43

Radius: 2500

*UTM location was derived from PLSS - see Help

The data is furnished by the NMOSE/ISC and is accepted by the recipient with the expressed understanding that the OSE/ISC make no warranties, expressed or implied, concerning the accuracy, completeness, reliability, usability, or suitability for any particular purpose of the data.

5/17/18 9:30 AM

WATER COLUMN/ AVERAGE DEPTH TO WATER

APPENDIX III

REGULATORY EMAILS

Kimberly M. Wilson

From: Yu, Olivia, EMNRD [Olivia.Yu@state.nm.us]
Sent: Thursday, April 12, 2018 8:32 AM
To: Kimberly M. Wilson; Tucker, Shelly
Cc: Shoemaker, Mike; David J. Adkins
Subject: RE: Cockburn Federal #2 * API: #30-25-36282 * 1RP-4725

Good morning Ms. Wilson:

NMOCD would appreciate more advanced notice for review given that 1RP-4725 occurred about 10 months ago. Also, please utilize USGS database as an additional reference to assess depth to groundwater. There are multiple wells within a 1 mile radius with more recent data indicating average depth to groundwater just under 50 ft. bgs.

NMOCD will consider vertical delineation completed for chlorides; however, not for TPH extended at S-1 area using the conservative estimated depth to groundwater. Please proceed to complete vertical delineation past 4 ft. bgs. for the area represented by S-1. Laboratory analyses of TPH extended and chlorides. 5' TPH, CL

As the remedial work is already underway, remove 1 ft. of TPH-impacted material at the area represented by S-1, in addition to the proposed 1 ft. at S-4 and S-5. Please be advised that confirmation bottom and sidewall samples are required for the excavated areas represented by S-1, S-4, and S-5.

In the remediation report, please include 1) a scaled map with confirmation sample locations marked with GPS coordinates and excavated areas outlined and 2) dated photo documentation of delineation/remediation activities.

NMOCD database indicates Fee surface. BLM can verify. If not, like approval from BLM required.

Thanks,
Olivia

-----Original Message-----

From: Kimberly M. Wilson <kwilson@talonlpe.com>
Sent: Tuesday, April 10, 2018 4:44 PM
To: Yu, Olivia, EMNRD <Olivia.Yu@state.nm.us>; Tucker, Shelly <stucker@blm.gov>
Cc: Shoemaker, Mike <Mike.Shoemaker@dvn.com>; David J. Adkins <dadkins@talonlpe.com>
Subject: Re: Cockburn Federal #2 * API: #30-25-36282 * 1RP-4725

I just talked to the construction department regarding the time frame of completion, it will take 2 days to complete this project.

Sent from my iPhone

> On Apr 10, 2018, at 2:30 PM, Kimberly M. Wilson <kwilson@talonlpe.com> wrote:

>

>

> RE: Cockburn Federal #2

> API: #30-25-36282

> 1RP-4725

>

> Dear Olivia and Shelly,

>

> Tomorrow, Wednesday May 11, 2018, we will be mobilizing to the Cockburn Federal #2 to begin remedial action on 1RP-4725 incident. Attached please find the Soil Assessment and Remediation Work Plan for the above reference location.

>

> Could we get a response on the work plan? This is going to be a small job and I would rather have something in writing from regulatory at the beginning of the job. I understand how busy the OCD and BLM are lately.

>

> Thank you for your consideration.

>

> Respectfully,

>

> Kimberly

>

> Kimberly M. Wilson

> Project Manager

> Office: 575.746.8768

> Direct: 575.616.4023

> Cell: 575.602.3826

> Fax: 575.746.8905

> Emergency: 866.742.0742

> Web: www.talonlpe.com

>

> [[cid:image004.png@01D3DoD8.6E896DDo](#)]

>

>

> <image001.gif>

> <Cockburn Federal #2 work plan.pdf>

> <image004.png>

APPENDIX IV

LABORATORY DATA



PHONE (575) 393-2326 ° 101 E. MARLAND ° HOBBS, NM 88240

April 23, 2018

KIMBERLY WILSON

TALON LPE

408 W. TEXAS AVE.

ARTESIA, NM 88210

RE: COCKBURN G FED #2

Enclosed are the results of analyses for samples received by the laboratory on 04/17/18 15:45.

Cardinal Laboratories is accredited through Texas NELAP under certificate number T104704398-17-10. Accreditation applies to drinking water, non-potable water and solid and chemical materials. All accredited analytes are denoted by an asterisk (*). For a complete list of accredited analytes and matrices visit the TCEQ website at www.tceq.texas.gov/field/qa/lab_accred_certif.html.

Cardinal Laboratories is accredited through the State of Colorado Department of Public Health and Environment for:

Method EPA 552.2	Haloacetic Acids (HAA-5)
Method EPA 524.2	Total Trihalomethanes (TTHM)
Method EPA 524.4	Regulated VOCs (V1, V2, V3)

Accreditation applies to public drinking water matrices.

This report meets NELAP requirements and is made up of a cover page, analytical results, and a copy of the original chain-of-custody. If you have any questions concerning this report, please feel free to contact me.

Sincerely,

Celey D. Keene

Lab Director/Quality Manager

Analytical Results For:

 TALON LPE
 KIMBERLY WILSON
 408 W. TEXAS AVE.
 ARTESIA NM, 88210
 Fax To: (575) 745-8905

 Received: 04/17/2018
 Reported: 04/23/2018
 Project Name: COCKBURN G FED #2
 Project Number: 700794.244.01
 Project Location: DEVON -LEA CO NM

 Sampling Date: 04/13/2018
 Sampling Type: Soil
 Sampling Condition: Cool & Intact
 Sample Received By: Tamara Oldaker

Sample ID: S-1 5' (H801054-01)

Chloride, SM4500Cl-B			mg/kg		Analyzed By: AC				
Analyte	Result	Reporting Limit	Analyzed	Method Blank	BS	% Recovery	True Value QC	RPD	Qualifier
Chloride	64.0	16.0	04/23/2018	ND	416	104	400	3.92	
TPH 8015M			mg/kg		Analyzed By: MS				
Analyte	Result	Reporting Limit	Analyzed	Method Blank	BS	% Recovery	True Value QC	RPD	Qualifier
GRO C6-C10*	<10.0	10.0	04/20/2018	ND	227	113	200	4.18	
DRO >C10-C28*	<10.0	10.0	04/20/2018	ND	232	116	200	2.75	
EXT DRO >C28-C36	11.9	10.0	04/20/2018	ND					
<hr/>									
Surrogate: 1-Chlorooctane	77.3 %	41-142							
Surrogate: 1-Chlorooctadecane	72.1 %	37.6-147							

Sample ID: S-1 NORTH SIDEWALL 1' (H801054-02)

Chloride, SM4500Cl-B			mg/kg		Analyzed By: AC				
Analyte	Result	Reporting Limit	Analyzed	Method Blank	BS	% Recovery	True Value QC	RPD	Qualifier
Chloride	400	16.0	04/23/2018	ND	416	104	400	3.92	
TPH 8015M			mg/kg		Analyzed By: MS				
Analyte	Result	Reporting Limit	Analyzed	Method Blank	BS	% Recovery	True Value QC	RPD	Qualifier
GRO C6-C10*	<10.0	10.0	04/20/2018	ND	227	113	200	4.18	
DRO >C10-C28*	<10.0	10.0	04/20/2018	ND	232	116	200	2.75	
EXT DRO >C28-C36	<10.0	10.0	04/20/2018	ND					
<hr/>									
Surrogate: 1-Chlorooctane	89.3 %	41-142							
Surrogate: 1-Chlorooctadecane	85.8 %	37.6-147							

Cardinal Laboratories

* = Accredited Analyte

PLEASE NOTE: Liability and Damages. Cardinal's liability and client's exclusive remedy for any claim arising, whether based in contract or tort, shall be limited to the amount paid by client for analyses. All claims, including those for negligence and any other cause whatsoever shall be deemed waived unless made in writing and received by Cardinal within thirty (30) days after completion of the applicable service. In no event shall Cardinal be liable for incidental or consequential damages, including, without limitation, business interruptions, loss of use, or loss of profits incurred by client, its subsidiaries, affiliates or successors arising out of or related to the performance of the services hereunder by Cardinal, regardless of whether such claim is based upon any of the above stated reasons or otherwise. Results relate only to the samples identified above. This report shall not be reproduced except in full with written approval of Cardinal Laboratories.

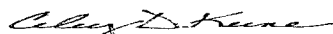

Celey D. Keene, Lab Director/Quality Manager

Analytical Results For:

 TALON LPE
 KIMBERLY WILSON
 408 W. TEXAS AVE.
 ARTESIA NM, 88210
 Fax To: (575) 745-8905

 Received: 04/17/2018
 Reported: 04/23/2018
 Project Name: COCKBURN G FED #2
 Project Number: 700794.244.01
 Project Location: DEVON -LEA CO NM

 Sampling Date: 04/13/2018
 Sampling Type: Soil
 Sampling Condition: Cool & Intact
 Sample Received By: Tamara Oldaker

Sample ID: S-1 SOUTH SIDEWALL 1' (H801054-03)

Chloride, SM4500Cl-B		mg/kg		Analyzed By: AC					
Analyte	Result	Reporting Limit	Analyzed	Method Blank	BS	% Recovery	True Value QC	RPD	Qualifier
Chloride	16.0	16.0	04/23/2018	ND	416	104	400	3.92	
TPH 8015M		mg/kg		Analyzed By: MS					
Analyte	Result	Reporting Limit	Analyzed	Method Blank	BS	% Recovery	True Value QC	RPD	Qualifier
GRO C6-C10*	<10.0	10.0	04/20/2018	ND	227	113	200	4.18	
DRO >C10-C28*	<10.0	10.0	04/20/2018	ND	232	116	200	2.75	
EXT DRO >C28-C36	<10.0	10.0	04/20/2018	ND					
Surrogate: 1-Chlorooctane	85.6 %	41-142							
Surrogate: 1-Chlorooctadecane	80.8 %	37.6-147							

Sample ID: S-1 EAST SIDEWALL 1' (H801054-04)

Chloride, SM4500Cl-B		mg/kg		Analyzed By: AC					
Analyte	Result	Reporting Limit	Analyzed	Method Blank	BS	% Recovery	True Value QC	RPD	Qualifier
Chloride	64.0	16.0	04/23/2018	ND	416	104	400	3.92	
TPH 8015M		mg/kg		Analyzed By: MS					
Analyte	Result	Reporting Limit	Analyzed	Method Blank	BS	% Recovery	True Value QC	RPD	Qualifier
GRO C6-C10*	<10.0	10.0	04/20/2018	ND	227	113	200	4.18	
DRO >C10-C28*	<10.0	10.0	04/20/2018	ND	232	116	200	2.75	
EXT DRO >C28-C36	<10.0	10.0	04/20/2018	ND					
Surrogate: 1-Chlorooctane	87.5 %	41-142							
Surrogate: 1-Chlorooctadecane	84.1 %	37.6-147							

Cardinal Laboratories

*=Accredited Analyte

PLEASE NOTE: Liability and Damages. Cardinal's liability and client's exclusive remedy for any claim arising, whether based in contract or tort, shall be limited to the amount paid by client for analyses. All claims, including those for negligence and any other cause whatsoever shall be deemed waived unless made in writing and received by Cardinal within thirty (30) days after completion of the applicable service. In no event shall Cardinal be liable for incidental or consequential damages, including, without limitation, business interruptions, loss of use, or loss of profits incurred by client, its subsidiaries, affiliates or successors arising out of or related to the performance of the services hereunder by Cardinal, regardless of whether such claim is based upon any of the above stated reasons or otherwise. Results relate only to the samples identified above. This report shall not be reproduced except in full with written approval of Cardinal Laboratories.

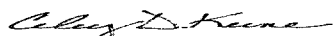

Celey D. Keene, Lab Director/Quality Manager

Analytical Results For:

 TALON LPE
 KIMBERLY WILSON
 408 W. TEXAS AVE.
 ARTESIA NM, 88210
 Fax To: (575) 745-8905

 Received: 04/17/2018
 Reported: 04/23/2018
 Project Name: COCKBURN G FED #2
 Project Number: 700794.244.01
 Project Location: DEVON -LEA CO NM

 Sampling Date: 04/13/2018
 Sampling Type: Soil
 Sampling Condition: Cool & Intact
 Sample Received By: Tamara Oldaker

Sample ID: S-1 WEST SIDEWALL 1' (H801054-05)

Chloride, SM4500Cl-B		mg/kg	Analyzed By: AC						
Analyte	Result	Reporting Limit	Analyzed	Method Blank	BS	% Recovery	True Value QC	RPD	Qualifier
Chloride	16.0	16.0	04/23/2018	ND	416	104	400	3.92	
TPH 8015M		mg/kg	Analyzed By: MS						
Analyte	Result	Reporting Limit	Analyzed	Method Blank	BS	% Recovery	True Value QC	RPD	Qualifier
GRO C6-C10*	<10.0	10.0	04/21/2018	ND	197	98.6	200	2.26	
DRO >C10-C28*	<10.0	10.0	04/21/2018	ND	207	103	200	3.38	
EXT DRO >C28-C36	<10.0	10.0	04/21/2018	ND					
Surrogate: 1-Chlorooctane	88.4 %	41-142							
Surrogate: 1-Chlorooctadecane	73.2 %	37.6-147							

Cardinal Laboratories

*=Accredited Analyte

PLEASE NOTE: Liability and Damages. Cardinal's liability and client's exclusive remedy for any claim arising, whether based in contract or tort, shall be limited to the amount paid by client for analyses. All claims, including those for negligence and any other cause whatsoever shall be deemed waived unless made in writing and received by Cardinal within thirty (30) days after completion of the applicable service. In no event shall Cardinal be liable for incidental or consequential damages, including, without limitation, business interruptions, loss of use, or loss of profits incurred by client, its subsidiaries, affiliates or successors arising out of or related to the performance of the services hereunder by Cardinal, regardless of whether such claim is based upon any of the above stated reasons or otherwise. Results relate only to the samples identified above. This report shall not be reproduced except in full with written approval of Cardinal Laboratories.



Celey D. Keene, Lab Director/Quality Manager

Notes and Definitions

ND	Analyte NOT DETECTED at or above the reporting limit
RPD	Relative Percent Difference
**	Samples not received at proper temperature of 6°C or below.
***	Insufficient time to reach temperature.
-	Chloride by SM4500Cl-B does not require samples be received at or below 6°C Samples reported on an as received basis (wet) unless otherwise noted on report

Cardinal Laboratories

*=Accredited Analyte

PLEASE NOTE: Liability and Damages. Cardinal's liability and client's exclusive remedy for any claim arising, whether based in contract or tort, shall be limited to the amount paid by client for analyses. All claims, including those for negligence and any other cause whatsoever shall be deemed waived unless made in writing and received by Cardinal within thirty (30) days after completion of the applicable service. In no event shall Cardinal be liable for incidental or consequential damages, including, without limitation, business interruptions, loss of use, or loss of profits incurred by client, its subsidiaries, affiliates or successors arising out of or related to the performance of the services hereunder by Cardinal, regardless of whether such claim is based upon any of the above stated reasons or otherwise. Results relate only to the samples identified above. This report shall not be reproduced except in full with written approval of Cardinal Laboratories.

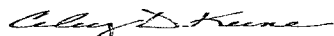

Celey D. Keene, Lab Director/Quality Manager

CHAIN-OF-CUSTODY AND ANALYSIS REQUEST

† Cardinal cannot accept verbal changes. Please fax written changes to (575) 393-2326

April 13, 2018

DAVID ADKINS

TALON LPE

408 W. TEXAS AVE.

ARTESIA, NM 88210

RE: COCKBURN G FED #2

Enclosed are the results of analyses for samples received by the laboratory on 04/13/18 10:05.

Cardinal Laboratories is accredited through Texas NELAP under certificate number T104704398-17-10. Accreditation applies to drinking water, non-potable water and solid and chemical materials. All accredited analytes are denoted by an asterisk (*). For a complete list of accredited analytes and matrices visit the TCEQ website at www.tceq.texas.gov/field/qa/lab_accred_certif.html.

Cardinal Laboratories is accredited through the State of Colorado Department of Public Health and Environment for:

Method EPA 552.2	Haloacetic Acids (HAA-5)
Method EPA 524.2	Total Trihalomethanes (TTHM)
Method EPA 524.4	Regulated VOCs (V1, V2, V3)

Accreditation applies to public drinking water matrices.

This report meets NELAP requirements and is made up of a cover page, analytical results, and a copy of the original chain-of-custody. If you have any questions concerning this report, please feel free to contact me.

Sincerely,



Celey D. Keene

Lab Director/Quality Manager

Analytical Results For:

 TALON LPE
 DAVID ADKINS
 408 W. TEXAS AVE.
 ARTESIA NM, 88210
 Fax To: (575) 745-8905

 Received: 04/13/2018
 Reported: 04/13/2018
 Project Name: COCKBURN G FED #2
 Project Number: 700794.244.01
 Project Location: DEVON -LEA CO NM

 Sampling Date: 04/12/2018
 Sampling Type: Soil
 Sampling Condition: Cool & Intact
 Sample Received By: Tamara Oldaker

Sample ID: S-4 BOTTOM 1.0' (H801037-01)

Chloride, SM4500CI-B			mg/kg		Analyzed By: AC				
Analyte	Result	Reporting Limit	Analyzed	Method Blank	BS	% Recovery	True Value QC	RPD	Qualifier
Chloride	96.0	16.0	04/13/2018	ND	432	108	400	3.77	

Sample ID: S-4 NORTH SIDE WALL (H801037-02)

Chloride, SM4500Cl-B		mg/kg		Analyzed By: AC						
Analyte	Result	Reporting Limit	Analyzed	Method Blank	BS	% Recovery	True Value QC	RPD	Qualifier	
Chloride	208	16.0	04/13/2018	ND	432	108	400	3.77		

Sample ID: S-4 SOUTH SIDE WALL (H801037-03)

Chloride, SM4500Cl-B			mg/kg		Analyzed By: AC					
Analyte	Result	Reporting Limit	Analyzed	Method Blank	BS	% Recovery	True Value QC	RPD	Qualifier	
Chloride	16.0	16.0	04/13/2018	ND	432	108	400	3.77		

Sample ID: S-4 WEST SIDE WALL (H801037-04)

Chloride, SM4500Cl-B			mg/kg		Analyzed By: AC					
Analyte	Result	Reporting Limit	Analyzed	Method Blank	BS	% Recovery	True Value QC	RPD	Qualifier	
Chloride	<16.0	16.0	04/13/2018	ND	432	108	400	3.77		

Cardinal Laboratories

* = Accredited Analyte

PLEASE NOTE: Liability and Damages. Cardinal's liability and client's exclusive remedy for any claim arising, whether based in contract or tort, shall be limited to the amount paid by client for analyses. All claims, including those for negligence and any other cause whatsoever shall be deemed waived unless made in writing and received by Cardinal within thirty (30) days after completion of the applicable service. In no event shall Cardinal be liable for incidental or consequential damages, including, without limitation, business interruptions, loss of use, or loss of profits incurred by client, its subsidiaries, affiliates or successors arising out of or related to the performance of the services hereunder by Cardinal, regardless of whether such claim is based upon any of the above stated reasons or otherwise. Results relate only to the samples identified above. This report shall not be reproduced except in full with written approval of Cardinal Laboratories.

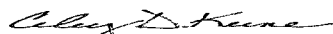

Celey D. Keene, Lab Director/Quality Manager

Analytical Results For:

 TALON LPE
 DAVID ADKINS
 408 W. TEXAS AVE.
 ARTESIA NM, 88210
 Fax To: (575) 745-8905

 Received: 04/13/2018
 Reported: 04/13/2018
 Project Name: COCKBURN G FED #2
 Project Number: 700794.244.01
 Project Location: DEVON -LEA CO NM

 Sampling Date: 04/12/2018
 Sampling Type: Soil
 Sampling Condition: Cool & Intact
 Sample Received By: Tamara Oldaker

Sample ID: S-5 EAST SIDE WALL (H801037-05)

Chloride, SM4500Cl-B mg/kg			Analyzed By: AC						
Analyte	Result	Reporting Limit	Analyzed	Method Blank	BS	% Recovery	True Value QC	RPD	Qualifier
Chloride	48.0	16.0	04/13/2018	ND	432	108	400	3.77	

Sample ID: S-5 BOTTOM 1.0' (H801037-06)

Chloride, SM4500Cl-B mg/kg			Analyzed By: AC						
Analyte	Result	Reporting Limit	Analyzed	Method Blank	BS	% Recovery	True Value QC	RPD	Qualifier
Chloride	128	16.0	04/13/2018	ND	432	108	400	3.77	

Sample ID: S-5 NORTH SIDE WALL (H801037-07)

Chloride, SM4500Cl-B mg/kg			Analyzed By: AC						
Analyte	Result	Reporting Limit	Analyzed	Method Blank	BS	% Recovery	True Value QC	RPD	Qualifier
Chloride	144	16.0	04/13/2018	ND	432	108	400	3.77	

Sample ID: S-5 WEST SIDE WALL (H801037-08)

Chloride, SM4500Cl-B mg/kg			Analyzed By: AC						
Analyte	Result	Reporting Limit	Analyzed	Method Blank	BS	% Recovery	True Value QC	RPD	Qualifier
Chloride	96.0	16.0	04/13/2018	ND	416	104	400	0.00	

Sample ID: S-5 SOUTH SIDE WALL (H801037-09)

Chloride, SM4500Cl-B mg/kg			Analyzed By: AC						
Analyte	Result	Reporting Limit	Analyzed	Method Blank	BS	% Recovery	True Value QC	RPD	Qualifier
Chloride	16.0	16.0	04/13/2018	ND	416	104	400	0.00	

Cardinal Laboratories

*=Accredited Analyte

PLEASE NOTE: Liability and Damages. Cardinal's liability and client's exclusive remedy for any claim arising, whether based in contract or tort, shall be limited to the amount paid by client for analyses. All claims, including those for negligence and any other cause whatsoever shall be deemed waived unless made in writing and received by Cardinal within thirty (30) days after completion of the applicable service. In no event shall Cardinal be liable for incidental or consequential damages, including, without limitation, business interruptions, loss of use, or loss of profits incurred by client, its subsidiaries, affiliates or successors arising out of or related to the performance of the services hereunder by Cardinal, regardless of whether such claim is based upon any of the above stated reasons or otherwise. Results relate only to the samples identified above. This report shall not be reproduced except in full with written approval of Cardinal Laboratories.

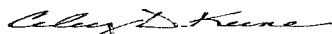

Celey D. Keene, Lab Director/Quality Manager

Notes and Definitions

ND	Analyte NOT DETECTED at or above the reporting limit
RPD	Relative Percent Difference
**	Samples not received at proper temperature of 6°C or below.
***	Insufficient time to reach temperature.
-	Chloride by SM4500Cl-B does not require samples be received at or below 6°C Samples reported on an as received basis (wet) unless otherwise noted on report

Cardinal Laboratories

*=Accredited Analyte

PLEASE NOTE: Liability and Damages. Cardinal's liability and client's exclusive remedy for any claim arising, whether based in contract or tort, shall be limited to the amount paid by client for analyses. All claims, including those for negligence and any other cause whatsoever shall be deemed waived unless made in writing and received by Cardinal within thirty (30) days after completion of the applicable service. In no event shall Cardinal be liable for incidental or consequential damages, including, without limitation, business interruptions, loss of use, or loss of profits incurred by client, its subsidiaries, affiliates or successors arising out of or related to the performance of the services hereunder by Cardinal, regardless of whether such claim is based upon any of the above stated reasons or otherwise. Results relate only to the samples identified above. This report shall not be reproduced except in full with written approval of Cardinal Laboratories.

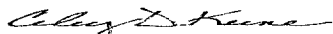

Caley D. Keene, Lab Director/Quality Manager

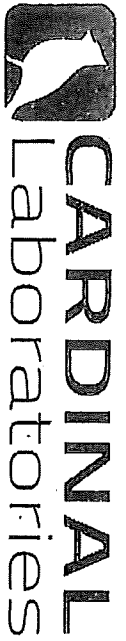

CHAIN-OF-CUSTODY AND ANALYSIS REQUEST

101 East Marland, Hobbs, NM 88240
(575) 393-2326 FAX (575) 393-2476

Page 1 of 1

Company Name: <u>Labon/UPS</u>		P.O. #:		ANALYSIS REQUEST	
Project Manager: <u>Kimberly M Wilson</u>		Company: <u>Labon</u>			
Address: <u>40842 Texas</u>		Attn:			
City: <u>Atsila</u>		Address:			
Phone #: <u>575-602-3826</u> Fax #:		City:			
Project #: <u>780794.244.01</u> Project Owner: <u>Labon</u>		State:			
Project Location: <u>Lee City</u>		Phone #:			
Sample Name: <u>41m Wilson</u>		Fax #:			
FOR LAB USE ONLY		MATRIX		PRESERV	
Lab I.D.		Sample I.D.			
H801037		(G)RAB OR (C)OMP.			
		# CONTAINERS			
		GROUNDWATER			
		WASTEWATER			
		SOIL			
		OIL			
		SLUDGE			
		OTHER :			
		ACID/BASE:			
		ICE / COOL			
		OTHER :			
		DATE			
		TIME			
1 5-4 Bottom 1.0'		G		4/12/18	
2 5-4 Well sidewall		G		1	
3 5-4 South sidewall		G		1	
4 5-4 West sidewall		G		1	
5 5-4 East sidewall		G		1	
6 5-5 Bottom 1.0'		G		1	
7 5-5 North sidewall		G		1	
8 5-5 West sidewall		G		1	
9 5-5 South sidewall		G		1	

PLEASE NOTE: Liability and Damages. Cardinal's liability and clients exclusive remedy for any claim arising whether based in contract or tort, shall be limited to the amount paid by the client for the analysis. All claims including those for negligence and any other cause whatsoever shall be deemed waived unless made in writing and received by Cardinal within 30 days after completion of the applicable service. In no event shall Cardinal be liable for incidental or consequential damages, including without limitation, business interruptions, loss of use, or loss of profits incurred by client, its subsidiaries, affiliates or successors arising out of or related to the performance of services rendered by Cardinal, regardless of whether such claim is based upon any of the above stated reasons or otherwise.

Relinquished By: Kimberly M Wilson Date: 4/12/18 Received By: Bob Frost Date: 4-13-18

Delivered By: Bob Frost Time: 10:05 Received By: Michael Black Time: 5:45

Sample Condition: ☒ Cool ☒ Intact ☒ Yes ☒ No

Checked By: Michael Black (Initials)

REMARKS: Rush

Phone Result: ☐ Yes ☐ No Add'l Phone #:

Fax Result: ☐ Yes ☐ No Add'l Fax #:

† Cardinal cannot accept verbal changes. Please fax written changes to (575) 393-2326