

1625 N. French Drive  
Hobbs, NM 88240FORM APPROVED  
OMB No. 1004-0136  
Expires November 30, 2000UNITED STATES  
DEPARTMENT OF THE INTERIOR  
BUREAU OF LAND MANAGEMENT

## APPLICATION FOR PERMIT TO DRILL OR REENTER

F04-09

449

1a. Type of Work: <input checked="" type="checkbox"/> DRILL <input type="checkbox"/> REENTER		7. If Unit or CA Agreement, Name and No.	
1b. Type of Well: <input checked="" type="checkbox"/> Oil Well <input type="checkbox"/> Gas Well <input type="checkbox"/> Other <input type="checkbox"/> Single Zone <input type="checkbox"/> Multiple Zone		8. Lease Name and Well No. James Federal, Well No. 8 5073	
2. Name of Operator Harvard Petroleum Corp. 10155		9. API Well No. 30-025-36665	
3a. Address P.O. Box 936 Roswell, NM 88202	3b. Phone No. (include area code) 505/ 523-1581	10. Field and Pool, or Exploratory TRISTE DEAN, Sand Dune Se. Delaware, West	
4. Location of Well (Report location clearly and in accordance with any State requirements. *) At surface 330' FSL & 2310' FEL At proposed prod. zone same		11. Sec., T., R., M., or Blk. and Survey or Area Sec. 29-T23S-R32E	
14. Distance in miles and direction from nearest town or post office* 36.5 miles east of Carlsbad, NM Carlsbad Controlled Water Basin		12. County or Parish Lea	13. State NM
15. Distance from proposed* location to nearest property or lease line, ft. (Also to nearest drig. unit line, if any) 330'	16. No. of Acres in lease 1440	17. Spacing Unit dedicated to this well 40	
18. Distance from proposed location* to nearest well, drilling, completed, applied for, on this lease, ft. 679	19. Proposed Depth 8700'	20. BLM/BIA Bond No. on file NM-1109	
21. Elevations (Show whether DF, KDB, RT, GL, etc.) 3672' GL	22. Approximate date work will start* April 15, 2004	23. Estimated duration 3 - 4 weeks	

## 24. Attachments

The following, completed in accordance with the requirements of Onshore Oil and Gas Order No. 1, shall be attached to this form:

- |   |  |
|---|--|
| 1. Well plat certified by a registered surveyor.  | 4. Bond to cover the operations unless covered by an existing bond on file (see Item 20 above).    |
| 2. A Drilling Plan.   | 5. Operator certification.   |
| 3. A Surface Use Plan (if the location is on National Forest System Lands, the SUPO shall be filed with the appropriate Forest Service Office). | 6. Such other site specific information and/or plans as may be required by the authorized officer. |

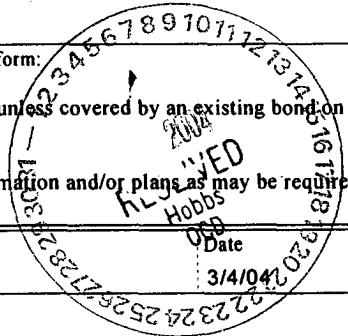
25. Signature <i>George R. Smith</i>	Name (Printed/Typed) George R. Smith	
Title Agent for: Harvard Petroleum Corp.		
Approved by (Signature) /S/ JOE G. LARA	Name (Printed/Typed) /S/ JOE G. LARA	
Title ACTING FIELD MANAGER	Office CARLSBAD FIELD OFFICE	Date APR 05 2004

Application approval does not warrant or certify that the applicant holds legal or equitable title to those rights in the subject lease which would entitle the applicant to conduct operations thereon.

Conditions of approval, if any, are attached.

APPROVAL FOR 1 YEAR

Title 18 U.S.C. Section 1001 and Title 43 U.S.C. Section 1212, make it a crime for any person knowingly and willfully to make to any department or agency of the United States any false, fictitious or fraudulent statements or representations as to any matter within its jurisdiction.

\*(Instructions on reverse)

Lease Responsibility Statement: Harvard Petroleum Corp. accepts all applicable terms, conditions, stipulations, and restrictions concerning operations conducted on the leased land or portion thereof.

APPROVAL SUBJECT TO  
GENERAL REQUIREMENTS AND  
SPECIAL STIPULATIONS  
ATTACHED*K.R.D.*  
George R. Smith, agent*K.E.*

B

District I  
1825 N. French Dr. Hobbs, NM 88240

District II  
811 South First, Artesia, NM 88210

District III  
1000 Rio Brazos Rd., Aztec NM 87410

District IV  
2040 South Pacheco, Santa Fe, NM 87505

State of New Mexico  
Energy, Minerals & Natural Resources

OIL CONSERVATION DIVISION

2040 South Pacheco  
Santa Fe, N M 87505

Form C-102

Revised March 17, 1999  
Submit to Appropriate District Office

State Lease - 4 Copies

Fee Lease - 3 Copies

☐ AMENDED REPORT

WELL LOCATION AND ACREAGE DEDICATION PLAT

API Number <b>30-025-36665</b>	Pool Code <b>5381859945</b>	Pool Name <b>Trisk Draw</b>
Property Code <b>5073</b>	Property Name <b>JAMES FEDERAL</b>	Well Number <b>8</b>
OGRID No. <b>10155</b>	Operation Name <b>HARVARD PETROLEUM CORP.</b>	Elevation <b>3681</b>

Surface Location

UL or Lot No. <b>0</b>	Section <b>29</b>	Township <b>23-S</b>	Range <b>32-E</b>	Lat Idn.	Feet from the <b>330</b>	North/South line <b>SOUTH</b>	Feet from the <b>2310</b>	East/West line <b>EAST</b>	County <b>LEA</b>
---------------------------	----------------------	-------------------------	----------------------	----------	-----------------------------	----------------------------------	------------------------------	-------------------------------	----------------------

Bottom Hole Location If Different From Surface

UL or Lot No.	Section	Township	Range	Lat Idn.	Feet from the	North/South line	Feet from the	East/West line	County
Dedicated Acres <b>40</b>	Joint or Infill	Consolidation Code	Order No.						

NO ALLOWABLE WILL BE ASSIGNED TO THIS COMPLETION UNTIL ALL INTEREST HAVE BEEN CONSOLIDATED OR A NON-STANDARD UNIT HAS BEEN APPROVED BY THE DIVISION

	<b>OPERATOR CERTIFICATION</b> I HEREBY CERTIFY THAT THE INFORMATION HEREIN IS TRUE AND CORRECT TO THE BEST OF MY KNOWLEDGE AND BELIEF.
	Signature <i>George R. Smith</i>
	Printed Name <b>George R. Smith</b>
	Title <b>agent</b>
	Date <b>3/4/04</b>
	<b>SURVEYOR CERTIFICATION</b> I HEREBY CERTIFY THAT THE WELL LOCATION SHOWN ON THIS PLAT WAS PLOTTED FROM FIELD NOTES OF ACTUAL SURVEYS MADE BY ME OR UNDER MY SUPERVISION, AND THAT THE SAME IS TRUE AND CORRECT TO THE BEST OF MY KNOWLEDGE AND BELIEF.
	Date of Survey <b>JUNE 21, 2002</b>
	Signature and Seal of Professional Surveyor 

## APPLICATION FOR DRILLING

### HARVARD PETROLEUM CORP.

James Federal, Well No. 8  
330' FSL & 2310 FEL, Sec. 29-T23S-R32E  
Lea County, New Mexico  
Lease No.: NM-0559539  
(Development Well)

In conjunction with Form 3160-3, Application for Permit to Drill subject well, Harvard Petroleum Corp. submits the following items of pertinent information in accordance with BLM requirements:

1. The geologic surface formation is recent Permian with quaternary alluvium and other surficial deposits.
2. The estimated tops of geologic markers are as follows:

Rustler	1120'	Lower Brushy Canyon	8220'
Salt	1470'	Bone Spring	8470'
Delaware	4640'	Bone Spring Sand	8560'
Cherry Canyon	5660'	T.D.	8700'
Brushy Canyon	7300'		

3. The estimated depths at which water, oil or gas formations are anticipated to be encountered:

Water: Surface water between 100' - 300'.

Oil: Possible in the Delaware 4640 - 8500' and the Bone Spring below 8500'.

Gas: None expected.

#### 4. Proposed Casing Program:

HOLE SIZE	CASING SIZE	WEIGHT	GRADE	JOINT	SETTING DEPTH	QUANTITY OF CEMENT
17 1/2"	13 3/8"	54.5#	J-55	ST&C	555'	Circ. 400 sx "C"
11"	8 5/8"	24.0#	J-55	ST&C	2,500'	
11"	8 5/8"	32.0#	J-55	ST&C	4,500'	Circ. 1200 sx 35/65 Poz + 100 sx "H"
7 7/8"	5 1/2"	15.5#	K-55	LT&C	6,850'	450 sx 35/65/ Poz + 100 sx "C" neat
7 7/8"	5 1/2"	15.5#	K-55	LT&C	8,700'	400 sx 15/61/11 Poz-C-CSE

5. **Proposed Control Equipment:** A 10" 3000 psi wp Shaffer Type "E" BOP will be installed on the 8 5/8" casing. Casing and BOP will be tested before drilling out with 7 7/8", according to Onshore Oil & Gas Order No. 8 and will be tested weekly. Request variance in testing to the maximum expected surface pressure of 1914 psi.

6. MUD PROGRAM:	MUD WEIGHT	VIS.	W/L CONTROL
0' - 550': Fresh water w/gel spud mud:	8.4 - 9.0 ppg	32 - 38	No W/L control
550' - 4500': Cut Brine w/gel & lime:	9.0 - 10.0 ppg	28 - 30	No W/L control
4500' - 8700': Fresh Wtr w/gel & starch:	8.4 - 8.8 ppg	29 - 31	W/L control 10-15 cc +/-

7. **Auxiliary Equipment:** Blowout Preventer, Kelly cock, flow sensors and stabbing valve.

#### 8. Testing, Logging, and Coring Program:

Drill Stem Tests: None unless conditions warrant.

Logging: T.D. to 4500': GR-CNL-LDT-DLL

T.D. to Surface: GR-Neutron

Coring: Rotary sidewall as dictated by logs.

**HARVARD PETROLEUM CORP.**

James Federal, Well No. 8

Page 2

9. No abnormal pressures or temperatures are anticipated. In the event abnormal pressures are encountered the proposed mud program will be modified to increase the mud weight. Estimated evacuated BHP = 3480 psi and a surface pressure of 1914 psi with a temperature of 147°.
10. H<sub>2</sub>S: None expected. None in previous wells.
11. Anticipated starting date: April 15, 2004.  
Anticipated completion of drilling operations: Approximately 3 – 4 weeks.

## **MULTI POINT SURFACE USE AND OPERATIONS PLAN**

### **HARVARD PETROLEUM CORP.**

James Federal, Well No. 8  
330' FSL & 2310' FEL, Sec. 29-T23S-T32E  
Lea County, New Mexico  
Lease No.: NM-0559539  
(Development Well)

This plan is submitted with the Application for Permit to Drill the above described well. The purpose of the plan is to describe the location of the proposed well; the proposed construction activities and operations plan to be followed in rehabilitating the surface and environmental effects associated with the operations.

#### **1. EXISTING ROADS:**

- A. Exhibit "A" is a portion of a BLM Topographic map showing the location of the proposed well as staked. The well site location is approximately 36.5 road miles east of Carlsbad, NM. Traveling east of Carlsbad on County Rd #605, CR-29 and NM Highways 31 and 128, there will be 34.1 miles of paved highway and 2 miles of oilfield roads.
- B. Directions: Travel southeast from Carlsbad, NM on County Rd. # 605, the refinery road, for 12.5 mile to NM Highway #31. Turn left on NM #31 for approximately 2.5 miles, and then turn east onto NM Highway # 128 for 17.4 miles to CR-29. Turn left (north) onto CR-29 and continue north 1.7 miles; turn right (east) for 1.6 miles to the Littlejack Fed. #1 well pad. The road continues east for 1.0 mile to the James Fed. #3 well site. Take the access road on the south side that runs southwest for approximately .3 mile, turn southeast for .4 mile to the State "IG" #1. Turn north for .2 mile toward the James Fed. #1. The proposed access road is staked on the west side of the access road and will run west for 250 feet to the southeast corner of the proposed well site.

#### **2. PLANNED ACCESS ROAD:**

- A. Length and Width: The proposed access road will be approximately 250 feet long. The proposed and existing roads are color coded on Exhibit "A".
- B. Construction: The proposed access road will be constructed by grading and topping with compacted caliche. The surface will be properly drained.
- C. Turnouts: None required.
- D. Culverts: None.
- E. Cuts and Fills: Minor cuts of 2 - 3 foot dunes will be required.
- F. Gates, Cattle guards. None required.
- G. Off lease right of way: Will use road ROW No. NM-108399

#### **3. LOCATION OF EXISTING WELLS:**

- A. Existing wells within a two-mile radius are shown on Exhibit "C".

**HARVARD PETROLEUM CORP.**

James Federal, Well No. 8

Page 2

**4. LOCATION OF EXISTING AND/OR PROPOSED FACILITIES;**

- A. Harvard Petroleum Corp. has production facilities on the lease at this time.
- B. If the well proves to be commercial, the necessary production facilities will be installed on the drilling pad. A 2 7/8" J55 steel oil flow line will run north parallel to the road to the James Fed. No. 1 and then west parallel to a water line ROW toward the James Fed. #2. The pipeline will turn north parallel to the access road to the James Fed., Well No. 3 well site and tank battery 1980' FSL & 2306' FWL, Sec. 29-T28S-R32E. Another 3" poly SDR 11 water flow line will parallel the access road north to the James Fed. #1 injection well.

**5. LOCATION AND TYPE OF WATER SUPPLY:**

- A. It is planned to drill the proposed well with fresh water that will be obtained from private or commercial sources and will be transported over the existing and proposed access roads

**6. SOURCE OF CONSTRUCTION MATERIALS:**

- A. Caliche for surfacing the proposed access road and well site pad will be obtained from the location, if available, or from a State pit in SE4 SW4 Sec. 32-T23S-R32E. No surface materials will be disturbed except those necessary for actual grading and leveling of the drill site and access road.

**7. METHODS OF HANDLING WASTE DISPOSAL:**

- A. Drill cuttings will be disposed of in the reserve pits.
- B. Drilling fluids will be allowed to evaporate in the reserve pits until the pits are dry.
- C. All pits will be fenced with normal fencing materials to prevent livestock from entering the area.
- D. Water produced during operations will be collected in tanks at the James Fed., Well #1 water disposal well, a BLM approved disposal system.
- E. Oil produced during operations will be stored in tanks until sold.
- F. Current laws and regulations pertaining to the disposal of human waste will be complied with.
- G. Trash, waste paper, garbage and junk will be contained in trash bins to prevent scattering by the wind and will be removed for deposit in an approved sanitary landfill within 30 days after finishing drilling and/or completion operations.

**8. ANCILLARY FACILITIES:**

- A. None required.

**HARVARD PETROLEUM CORP.**

James Federal, Well No. 8

Page 3

**9. WELL SITE LAYOUT:**

- A. Exhibit "D" shows the relative location and dimensions of the well pad, reserve pits, and major rig components. The pad and pit area has been staked and flagged, 400' X 400'.
- B. Mat Size: 255' X 160', plus 120' X 120' reserve pits on the north.
- C. Cut & Fill: The location will require a 3 foot cut on the north and west with fill to the south and east.
- D. The surface will be topped with compacted caliche and the reserve pits will be plastic lined.

**10. PLANS FOR RESTORATION OF THE SURFACE:**

- A. After completion of drilling and/or completion operations, all equipment and other material not required for operations will be removed. Pits will be filled and the location cleaned of all trash and junk to leave the well site in an aesthetically pleasing a condition as possible.
- B. Any unguarded pits containing fluids will be fenced until they are filled.
- C. If the proposed well is non-productive, all rehabilitation and/or vegetation requirements of the Bureau of Land Management will be complied with and will be accomplished as expeditiously as possible. All pits will be filled and leveled as soon as they are dry enough to be worked.

**11. OTHER INFORMATION:**

- A. Topography: The proposed well site and access road are located on top of Bootleg Ridge with the access road and location having an overall 2% slope to the northeast with a pad slope to the southeast. The location has an elevation of 3681' GL.
- B. Soil: The topsoil at the well site is a brown to yellowish-red fine sand to a fine sandy loam soil with occasional small sand dunes. There should be caliche at a depth of 40 to 60 inches. The soil is part of the Maljamar and Palomas fine sands land complex.
- C. Flora and Fauna: The vegetation cover has a very sparse to fair grass cover of three-awn, sand burr and bluestem, with the primary cover being plants of mesquite, yucca, broomweed, shinnery oak brush, sage, cacti and miscellaneous weeds and wildflowers. The wildlife consists of rabbits, coyotes, antelope, rattlesnakes, lizards, dove, quail and other wildlife typical of the semi-arid desert land.
- D. Ponds and Streams: None.
- E. Residences and Other Structures: None in the immediate vicinity, except oil well production facilities.
- F. Land Use: Cattle grazing.

**HARVARD PETROLEUM CORP.**

James Federal, Well No. 8

Page 4

**11. OTHER INFORMATION: cont.....**

- G. Surface Ownership: The proposed well site and access road is on Federal surface and minerals.
- H. There is no evidence of archaeological, historical or cultural sites in the staked area. Archaeological Survey Consultants, P. O. Box D, Roswell, NM 88202, has conducted an archaeological survey and their report was submitted to the appropriate government agencies.

**12. OPERATOR'S REPRESENTATIVE:**

- A. The field representative for assuring compliance with the approved use and operations plan is as follows:

Jeff Harvard  
HARVARD PETROLEUM CORP.  
P. O. Box 936  
Roswell, NM 88202  
Office Phone: (505) 623-1581  
Cell Phone: (505) 626-7938

**13. CERTIFICATION:**

I hereby certify that I have inspected the proposed drill site and access route; that I am familiar with the conditions which presently exist the statements made in the plan are, to the best of my knowledge, true and correct; and, that the work associated with the operations proposed herein will be performed by Harvard Petroleum Corp. and its contractors and subcontractors in conformity with this plan and the terms and conditions under which it is approved. This statement is subject to the provisions of 18 U.S.C. 1001 for the filing of a false statement.

March 4, 2004

  
\_\_\_\_\_  
George R. Smith  
Agent for: Harvard Petroleum Corp.



EXHIBIT "C"  
HARVARD PETROLEUM CORP.  
James Federal, Well No. 8  
330' FSL & 2310' FEL, Sec. 29-T23S-R32E  
Existing Wells



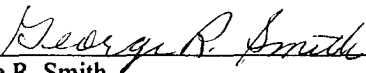
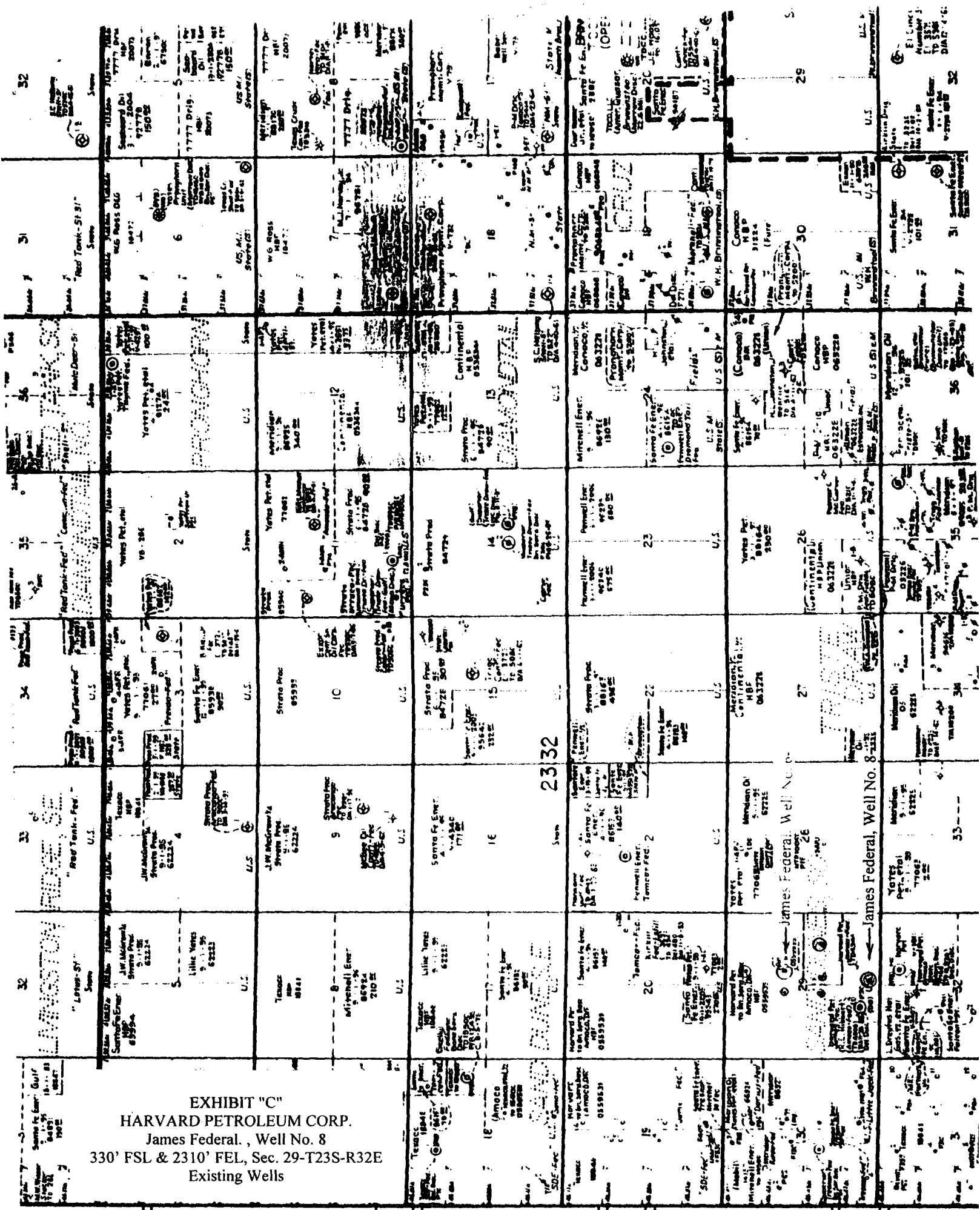
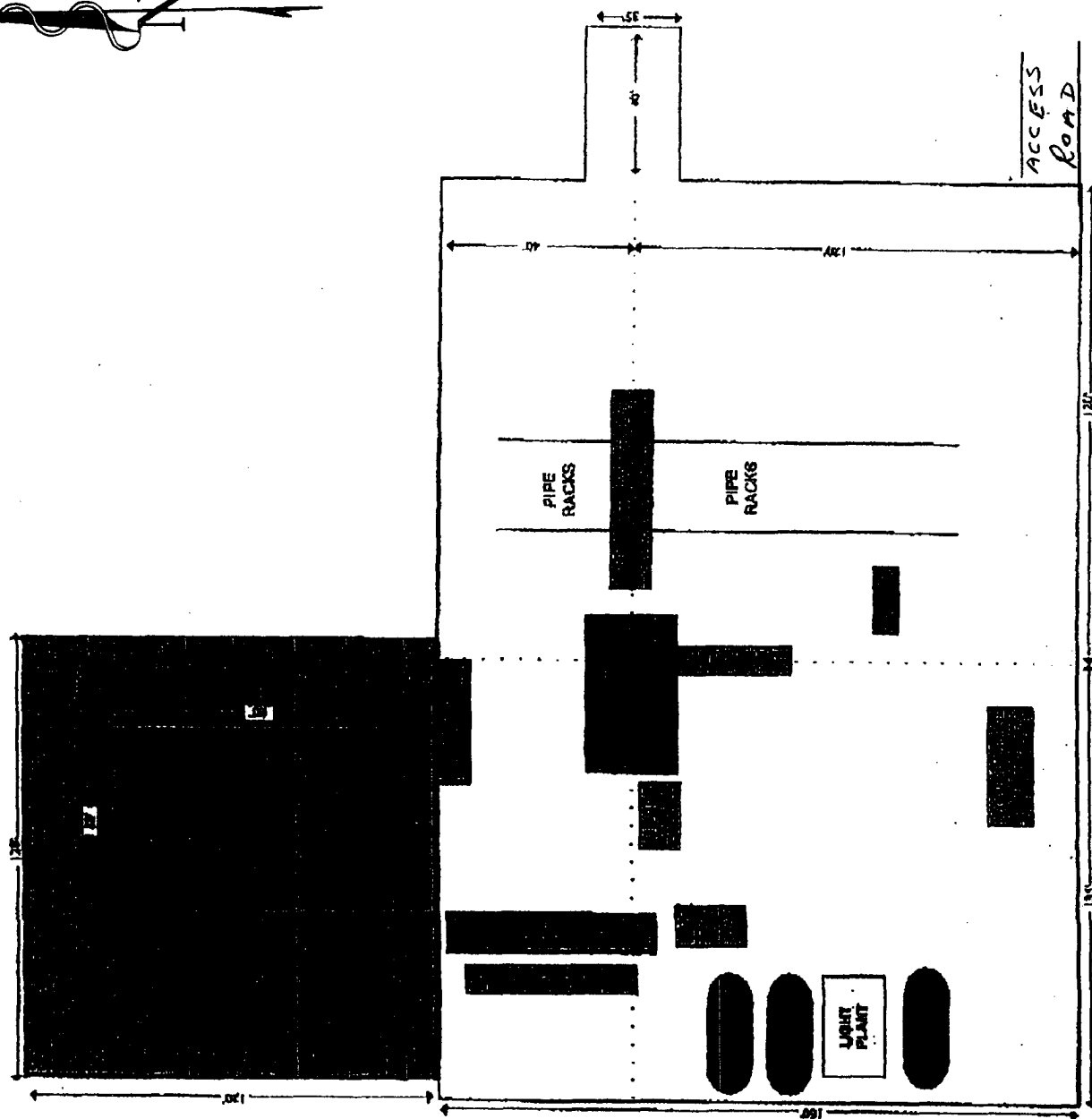

EXHIBIT "D"  
HARVARD PETROLEUM CORP.  
James Federal, Well No. 8  
Pad & Pit Layout

RIG #

**BLOWOUT PREVENTOR ARRANGEMENT**

2M SYSTEM

10" SHAFFER TYPE "E", 3000 psi WP

80 GALLON, 4 STATION KOOMEY ACCUMULATOR

3000 psi WP CHOKE MANIFOLD

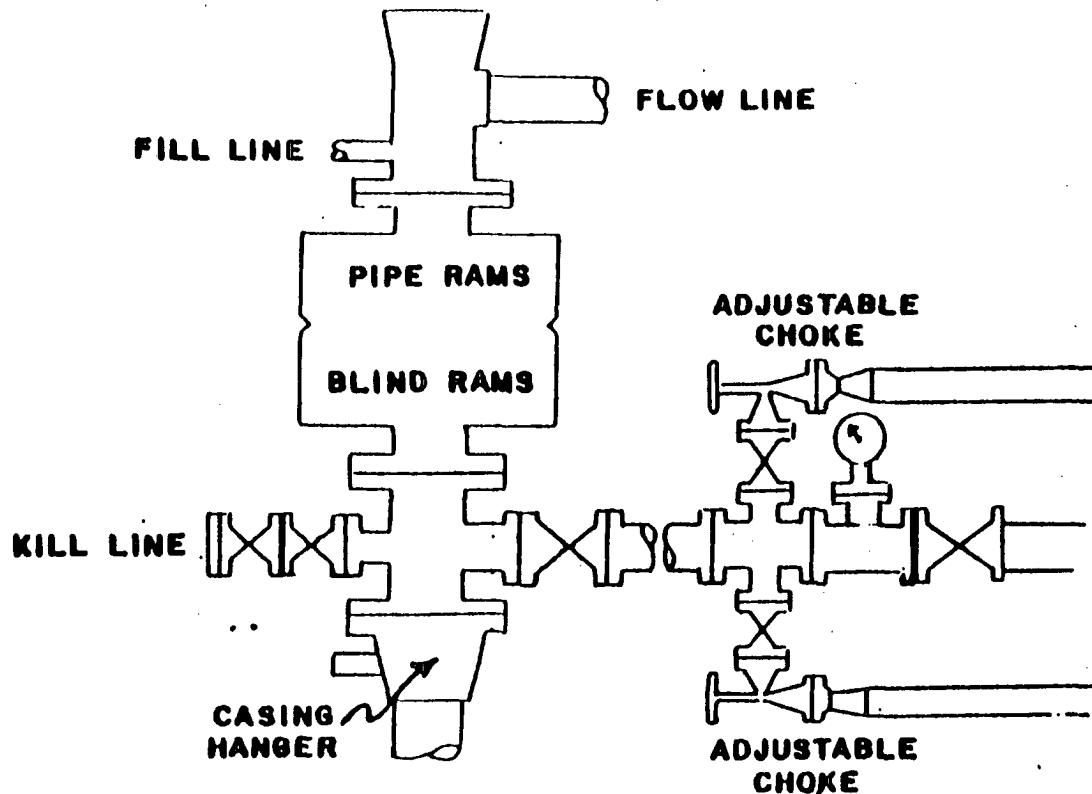

EXHIBIT "E"  
HARVARD PETROLEUM CORP.  
James Federal, Well No. 8  
BOP Specifications