

District I
1625 N. French Dr., Hobbs, NM 88240
District II
1301 W. Grand Avenue, Artesia, NM 88210
District III
1000 Rio Brazos Road, Aztec, NM 87410
District IV
1220 S. St. Francis Dr., Santa Fe, NM 87505

State of New Mexico
Energy Minerals and Natural Resources

Form C-101
March 4, 2004

Oil Conservation Division
1220 South St. Francis Dr.
Santa Fe, NM 87505

Submit to appropriate District Office
State Lease - 6 Copies
Fee Lease - 5 Copies

☐ AMENDED REPORT

APPLICATION FOR PERMIT TO DRILL, RE-ENTER, DEEPEN, PLUGBACK, OR ADD A ZONE

Operator Name and Address Morexco, Inc. P. O. Box 1591 Roswell, NM 88202-1591		OGRID Number 015262
Property Code 33863	Property Name Big Stick Fee	API Number 30-041-20905
		Well No. 1

Surface Location

UL or lot no.	Section	Township	Range	Lot Idn	Feet from the	North/South line	Feet from the	East/West line	County
M	3	7S	33E		660	S	660	W	Roosevelt

Proposed Bottom Hole Location If Different From Surface

UL or lot no.	Section	Township	Range	Lot Idn	Feet from the	North/South line	Feet from the	East/West line	County
Proposed Pool 1 Chaveroo, Permo Penn, N					Proposed Pool 2				

Drilling Pit Location and Other Information

UL or lot no.	Section	Township	Range	Lot Idn	Feet from the	North/South line	Feet from the	East/West line	County
M	3	7S	33E		660	S	660	W	Roosevelt
Depth to ground water 100' or more				Distance from nearest fresh water well 1+ miles		Distance from nearest surface water 1000' or more			
Work Type Code N		Well Type Code O		Cable/Rotary R		Lease Type Code P		Ground Level Elevation 4390'	
Multiple N		Proposed Depth 9300'		Formation Penn		Contractor J.W. Drilling		Spud Date 5/5/04	

Proposed Casing and Cement Program

Hole Size	Casing Size	Casing weight/foot	Setting Depth	Sacks of Cement	Estimated TOC
17 1/4	13 5/8	48# J-55	450	450 sxs	surface
12 1/4	8 5/8	32/24# J-55	4000	775 sxs	surface
7 7/8	5 1/2	17# J55/N80	9300	1400 sxs 2 stg	~4000'

²² Describe the proposed program. If this application is to DEEPEN or PLUG BACK, give the data on the present productive zone and proposed new productive zone. Describe the blowout prevention program, if any. Use additional sheets if necessary.

Operator proposes to drill to a depth sufficient to test the Penn Sands for oil. If sufficient shows are encountered, 3 1/2 casing will be run & cemented at T.D. If no shows, the well will be P & A in a manner consistent with OCD specifications.

²³ I hereby certify that the information given above is true and complete to the best of my knowledge and belief. I further certify that the drilling pit will be constructed according to NMOCD guidelines ☒ a general permit ☐, or an (attached) alternative OCD-approved plan ☐.

Signature:

Printed name: Donald G. Becker, Jr.

Title: President

E-mail Address: morexco@earthlink.net

Date: 4/26/04

Phone: 505-627-1290

OIL CONSERVATION DIVISION

Approved by:

Title: PETROLEUM ENGINEER

Approval Date: APR 26 2004

Expiration Date:

Conditions of Approval:

Attached ☐

District I
PO Box 1980, Hobbs, NM 88241-1980

District II
PO Drawer DD, Artesia, NM 88211-0719

District III
1000 Rio Brasos Rd., Aztec, NM 87410

District IV
PO Box 2088, Santa Fe, NM 87504-2088

State of New Mexico
Energy, Minerals & Natural Resources Department

Form C-102
Revised February 10, 1994
Submit to Appropriate District Office
State Lease - 4 Copies
Fee Lease - 3 Copies

OIL CONSERVATION DIVISION

PO Box 2088
Santa Fe, NM 87504-2088

☐ AMENDED REPORT

WELL LOCATION AND ACREAGE DEDICATION PLAT

1 API Number 30-041-20905	2 Pool Code	3 Pool Name
4 Property Code 33863	5 Property Name Big Stick Fee	6 Well Number 1
7 OGRID No. 15262	8 Operator Name Morexco, Inc.	9 Elevation 4390

¹⁰Surface Location

UL or lot no.	Section	Township	Range	Lot Idn	Feet from the	North/South line	Feet from the	East/West line	County
M	3	7 S	33 E		660	South	660	West	Roosevelt

¹¹Bottom Hole Location If Different From Surface

UL or lot no.	Section	Township	Range	Lot Idn	Feet from the	North/South line	Feet from the	East/West line	County

12 Dedicated Acres 160	13 Joint or Infill	14 Consolidation Code	15 Order No.
-------------------------------------	-----------------------	--------------------------	-----------------

NO ALLOWABLE WILL BE ASSIGNED TO THIS COMPLETION UNITL ALL INTERESTS HAVE BEEN CONSOLIDATED
OR A NON-STANDARD UNIT HAS BEEN APPROVED BY THE DIVISION

<div>16</div> <p>Big Stick Fee No. 1 Elev. 4390'</p>	<div>17 OPERATOR CERTIFICATION</div> <p>I hereby certify that the information contained herein is true and complete to the best of my knowledge and belief.</p> <p>Signature Donald G. Becker Jr.</p> <p>Printed Name President</p> <p>Title</p> <p>Date</p>		
	<div>18 SURVEYOR CERTIFICATION</div> <p>I hereby certify that the well location shown on this plat was plotted from field notes of actual surveys made by me or under my supervision, and that the same is true and correct to the best of my belief.</p> <p>April 22, 2004</p> <p>Date of Survey</p> <p>Signature and Seal of Professional Surveyor</p> <p>Certificate Number 10324</p>		

District I
1625 N. French Dr., Hobbs, NM 88240
District II
1301 W. Grand Avenue, Artesia, NM 88210
District III
1000 Rio Brazos Road, Aztec, NM 87410
District IV
1220 S. St. Francis Dr., Santa Fe, NM 87505

State of New Mexico
Energy Minerals and Natural Resources

Oil Conservation Division
1220 South St. Francis Dr.
Santa Fe, NM 87505

Form C-144
March 12, 2004

For drilling and production facilities, submit to
appropriate NMOCD District Office.
For downstream facilities, submit to Santa Fe
office

Pit or Below-Grade Tank Registration or Closure

Is pit or below-grade tank covered by a "general plan"? Yes ☐ No ☐

Type of action: Registration of a pit or below-grade tank ☐ Closure of a pit or below-grade tank ☐

Operator: <u>Morexco, Inc.</u> Telephone: <u>627-1290</u> e-mail address: <u>morexco@earthlink.net</u>		
Address: <u>P. O. Box 1591 Roswell, NM 88202-1591</u>		
Facility or well name: <u>Big Stick #1</u> API #: <u>30-041-20905</u> U/L or Qtr/Qtr. <u>M</u> Sec <u>3</u> T <u>7S</u> R <u>33E</u>		
County: <u>Roosevelt</u> Latitude <u>33° 43 min</u> Longitude <u>103° 33 min</u> NAD: 1927 <input type="checkbox"/> 1983 <input type="checkbox"/> Surface Owner Federal <input type="checkbox"/> State <input type="checkbox"/> Private <input type="checkbox"/> Indian <input checked="" type="checkbox"/>		
Pit Type: Drilling <input checked="" type="checkbox"/> Production <input type="checkbox"/> Disposal <input type="checkbox"/> Workover <input type="checkbox"/> Emergency <input type="checkbox"/> Lined <input checked="" type="checkbox"/> Unlined <input type="checkbox"/> Liner type: Synthetic <input checked="" type="checkbox"/> Thickness <u>20</u> mil Clay <input type="checkbox"/> Volume _____ bbl	Below-grade tank Volume: _____ bbl Type of fluid: _____ Construction material: _____ Double-walled, with leak detection? Yes <input type="checkbox"/> If not, explain why not. _____	
Depth to ground water (vertical distance from bottom of pit to seasonal high water elevation of ground water.)	Less than 50 feet	(20 points)
	50 feet or more, but less than 100 feet	(10 points)
	100 feet or more	(0 points) <u>0</u>
Wellhead protection area: (Less than 200 feet from a private domestic water source, or less than 1000 feet from all other water sources.)	Yes	(20 points)
	No	(0 points) <u>0</u>
Distance to surface water: (horizontal distance to all wetlands, playas, irrigation canals, ditches, and perennial and ephemeral watercourses.)	Less than 200 feet	(20 points)
	200 feet or more, but less than 1000 feet	(10 points)
	1000 feet or more	(0 points) <u>0</u>
Ranking Score (Total Points)		<u>0</u>

If this is a pit closure: (1) attach a diagram of the facility showing the pit's relationship to other equipment and tanks. (2) Indicate disposal location:

onsite ☐ offsite ☐ If offsite, name of facility: _____. (3) Attach a general description of remedial action taken including remediation start date and end date. (4) Groundwater encountered: No ☐ Yes ☐ If yes, show depth below ground surface: _____ ft. and attach sample results. (5) Attach soil sample results and a diagram of sample locations and excavations.

I hereby certify that the information above is true and complete to the best of my knowledge and belief. I further certify that the above-described pit or below-grade tank has been/will be constructed or closed according to NMOCD guidelines ☒, a general permit ☐, or an (attached) alternative NMOCD-approved plan ☐.

Date: 4/26/04

Printed Name/Title: Donald G. Becker, Jr./President Signature: _____

Your certification and NMOCD approval of this application/closure does not relieve the operator of liability should the contents of the pit or tank contaminate ground water or otherwise endanger public health or the environment. Nor does it relieve the operator of its responsibility for compliance with any other federal, state, or local laws and/or regulations.

Approval:

Date: 4/26/04

Printed Name/Title: PAUL F KAUTZ Signature: _____

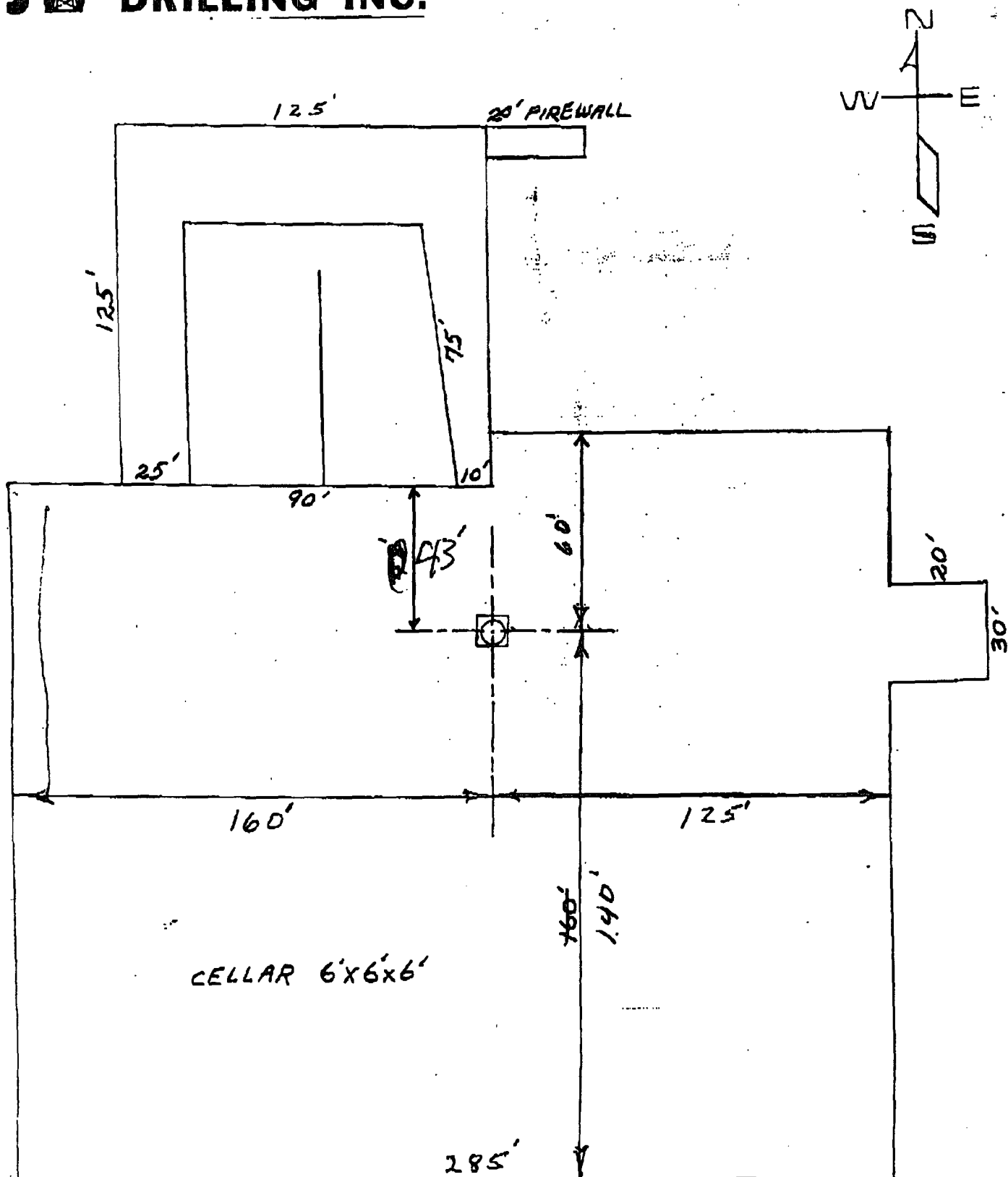

C-101/C-144 DRILLING PIT REGISTRATION CODITIONS OF APPROVAL

API number:	30-041-20905		
OGRID:		Operator:	MOREXCO INC
			PO BOX 1591
			ROSWELL NM 88202-1591
		Property:	BIG STICK FEE # 1

surface	ULSTR:	M	3	T	7S	R	33E

XXXXXX	Pit must be lined with a minimum of a 12 mil re-enforced or 20 mil re-enforced liner.
XXXXXX	The pit must be deep enough so that when pit is closed it can be covered with 3 feet of dirt and surface leveled
XXXXXX	If the pit is to be encapsulated in place, the liner is to be a minimum thickness of 20 mil re-enforced liner
	When using a 12 mil nylon re-enforced liner. The contents of the pit must be removed along with the liner and disposed of in an approved facility within 6 months of completion of the well.
XXXXXX	When using a 20 mil liner. The pit must be closed within 6 months of completion of the well.
	This site has a Ranking Score of 20 points or higher . The contents of the pit must be removed along with the liner and disposed of in an approved facility within 6 months of completion of the well.
XXXXXX	Before pit is closed, submit a subsequent Form C-144 along with any additional information which may be applicable to the appropriate NMOCD District Office for approval.
XXXXXX	Notify appropriate NMOCD District Office by E-mail 48 hrs prior to closing pit.
XXXXXX	The operator is required to comply with NMOCD guidelines.
XXXXXX	OCD approval does not release the operator of its responsibilities for compliance with any other federal, state, or local laws and/or regulations.

Drilling Pit Registration Approval

District Supervisor Chris Williams
District Geologist Paul F Kautz

505-393-6161

ext 102
ext 104

Drilling Pit closure

Environmental Spec Larry Johnson
Environmental Spec Paul Sheeley

505-393-6161

ext 111 lwjohnson@state.nm.us
ext 113 psheeley@state.nm.us