

District I
1625 N. French Dr., Hobbs, NM 88240
District II
1301 W. Grand Avenue, Artesia, NM 88210
District III
1000 Rio Brazos Road, Aztec, NM 87410
District IV
1220 S. St. Francis Dr., Santa Fe, NM 87505

State of New Mexico
Energy Minerals and Natural Resources

Oil Conservation Division
1220 South St. Francis Dr.
Santa Fe, NM 87505

Form C-144
March 12, 2004

For drilling and production facilities, submit to appropriate NMOCD District Office.
For downstream facilities, submit to Santa Fe office

Pit or Below-Grade Tank Registration or Closure

Is pit or below-grade tank covered by a "general plan"? Yes ☐ No ☐

Type of action: Registration of a pit or below-grade tank ☒ Closure of a pit or below-grade tank ☐

Operator: <u>Chesapeake</u> Telephone: <u>432 685-7443</u> e-mail address: <u>mwhitefield@chkeenergy.com</u>		
Address: <u>550 W. Texas Ave. #1300 Midland, Tx. 79701</u>		
Facility or well name: <u>Burrus #26-2</u>	API #: <u>36715</u>	U/L or Qtr/Qtr: <u>SW/NW</u> Sec: <u>26</u> T: <u>12</u> R: <u>38</u>
County: <u>Lea</u>	Latitude: _____	Longitude: _____
NAD: 1927 <input type="checkbox"/> 1983 <input type="checkbox"/> Surface Owner Federal <input type="checkbox"/> State <input type="checkbox"/> Private <input checked="" type="checkbox"/> Indian <input type="checkbox"/>		
Pit Type: Drilling <input checked="" type="checkbox"/> Production <input type="checkbox"/> Disposal <input type="checkbox"/> Workover <input type="checkbox"/> Emergency <input type="checkbox"/> Lined <input type="checkbox"/> Unlined <input type="checkbox"/> Liner type: Synthetic <input checked="" type="checkbox"/> Thickness <u>12</u> mil Clay <input type="checkbox"/> Volume <u>9670</u> bbl	Below-grade tank Volume: _____ bbl Type of fluid: _____ Construction material: _____ Double-walled, with leak detection? Yes <input type="checkbox"/> If not, explain why not: _____	
Depth to ground water (vertical distance from bottom of pit to seasonal high water elevation of ground water.)	Less than 50 feet (20 points) 50 feet or more, but less than 100 feet (10 points) <u>100 feet or more</u> (0 points) <u>0</u>	
Wellhead protection area: (Less than 200 feet from a private domestic water source, or less than 1000 feet from all other water sources.)	Yes (20 points) <u>No</u> (0 points) <u>0</u>	
Distance to surface water: (horizontal distance to all wetlands, playas, irrigation canals, ditches, and perennial and ephemeral watercourses.)	Less than 200 feet (20 points) 200 feet or more, but less than 1000 feet (10 points) <u>1000 feet or more</u> (0 points) <u>0</u>	
Ranking Score (Total Points)		

If this is a pit closure: (1) attach a diagram of the facility showing the pit's relationship to other equipment and tanks. (2) Indicate disposal location: onsite ☐ offsite ☐ If offsite, name of facility: _____ (3) Attach a general description of remedial action taken including remediation start date and end date. (4) Groundwater encountered: No ☐ Yes ☐ If yes, show depth below ground surface _____ ft. and attach sample results. (5) Attach soil sample results and a diagram of sample locations and excavations.

I hereby certify that the information above is true and complete to the best of my knowledge and belief. I further certify that the above-described pit or below-grade tank has been/will be constructed or closed according to NMOCD guidelines ☐, a general permit ☐, or an (attached) alternative OCD-approved plan ☐.

Date: 5-24-04

Printed Name/Title: Mike Whitefield Field Rep.

Signature: [Signature]

Your certification and NMOCD approval of this application/closure does not relieve the operator of liability should the contents of the pit or tank contaminate ground water or otherwise endanger public health or the environment. Nor does it relieve the operator of its responsibility for compliance with any other federal, state, or local laws and/or regulations.

Approval:

Date: 6/2/05

PETROLEUM ENGINEER

Printed Name/Title: _____

Signature: [Signature]

MIDLAND, TX (915) 684-7446
 OKLAHOMA CITY, OK (405) 810-0021
 VICTORIA, TX (361) 576-5297

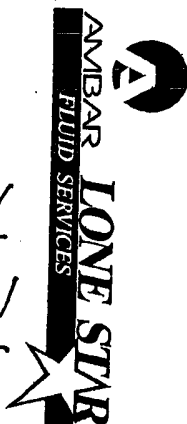

HOUSTON, TX (281) 877-1200
 LAFAYETTE, LA (337) 237-5300
 NEW ORLEANS, LA (504) 566-0411

Drq. Pit

Subject	Chesapeake Operating, Inc		Page No.	of
File			By	N. Newland
			Date	

BURRUS # 26-2

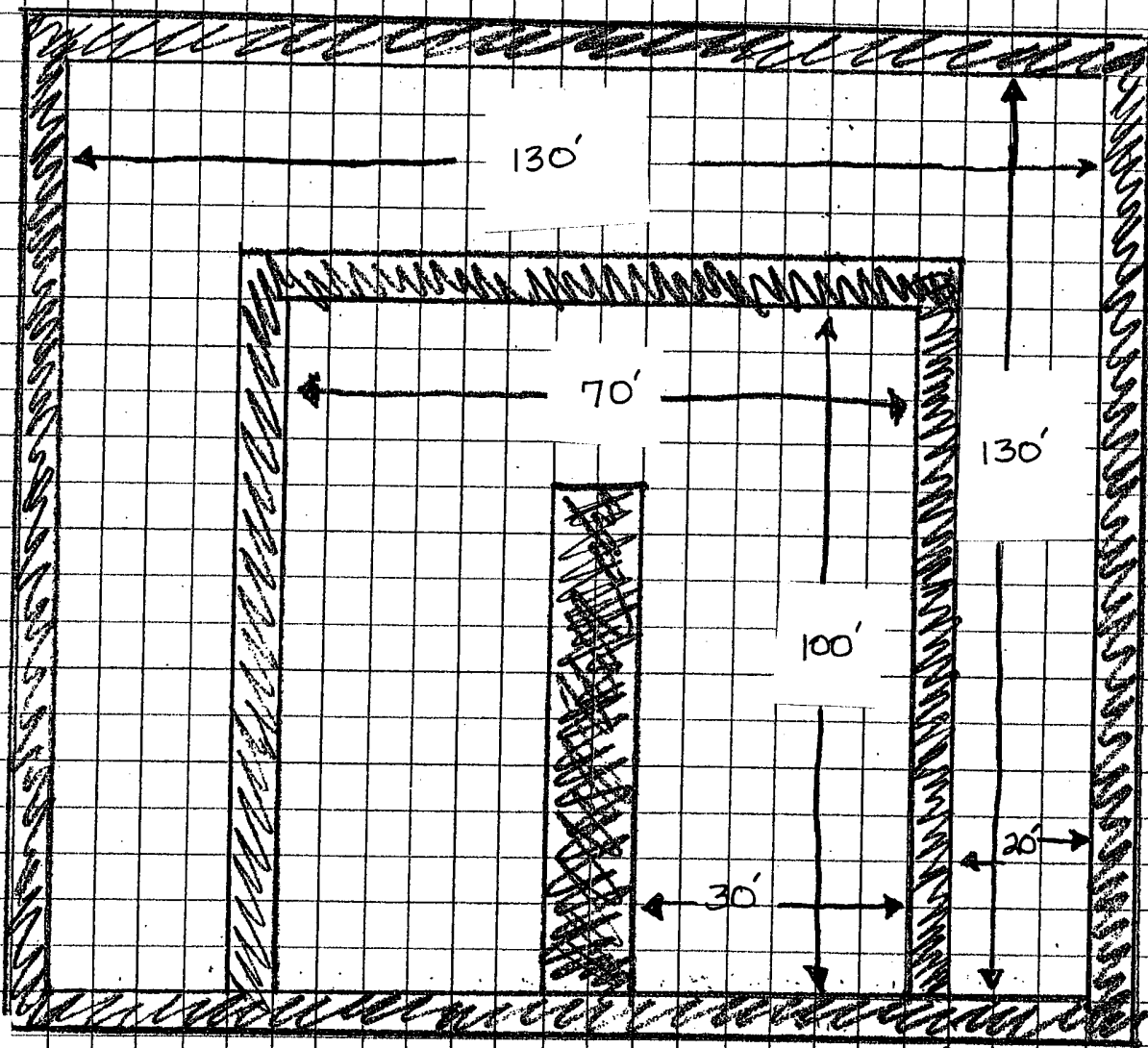

Approx. 9670 bbls. +/-

Well Bore

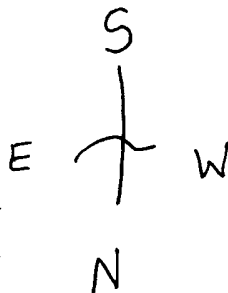

WALL BERMS DRLG PIT

