

UNITED STATES
DEPARTMENT OF THE INTERIOR
BUREAU OF LAND MANAGEMENT

SUNDRY NOTICES AND REPORTS ON WELLS
Do not use this form for proposals to drill or to re-enter an abandoned well. Use form 3160-3 (APD) for such proposals.

FORM APPROVED
OMB NO. 1004-0135
Expires: November 30, 2000

5. Lease Serial No.
NMNM104724

6. If Indian, Allottee or Tribe Name

7. If Unit or CA/Agreement, Name and/or No.
NMNM103145X

8. Well Name and No.
WEST TEAS UNIT 945

9. API Well No.
30-025-36079-00-S1

10. Field and Pool, or Exploratory
W TEAS

11. County or Parish, and State
LEA COUNTY, NM

SUBMIT IN TRIPLICATE - Other instructions on reverse side.

1. Type of Well

☒ Oil Well ☐ Gas Well ☐ Other

2. Name of Operator
CHESAPEAKE OPERATING INC

Contact: LINDA GOOD
E-Mail: lgood@chkenergy.com

3a. Address
P O BOX 18496
OKLAHOMA CITY, OK 73154

3b. Phone No. (include area code)
Ph: 405.767.4275
Fx: 405.879.9583

4. Location of Well (Footage, Sec., T., R., M., or Survey Description)

Sec 9 T20S R33E SENE 2612FNL 330FEL

12. CHECK APPROPRIATE BOX(ES) TO INDICATE NATURE OF NOTICE, REPORT, OR OTHER DATA

TYPE OF SUBMISSION	TYPE OF ACTION			
<input type="checkbox"/> Notice of Intent	<input type="checkbox"/> Acidize	<input type="checkbox"/> Deepen	<input type="checkbox"/> Production (Start/Resume)	<input type="checkbox"/> Water Shut-Off
<input checked="" type="checkbox"/> Subsequent Report	<input type="checkbox"/> Alter Casing	<input type="checkbox"/> Fracture Treat	<input type="checkbox"/> Reclamation	<input type="checkbox"/> Well Integrity
<input type="checkbox"/> Final Abandonment Notice	<input type="checkbox"/> Casing Repair	<input type="checkbox"/> New Construction	<input type="checkbox"/> Recomplete	<input checked="" type="checkbox"/> Other
	<input type="checkbox"/> Change Plans	<input type="checkbox"/> Plug and Abandon	<input type="checkbox"/> Temporarily Abandon	Site Facility Diagram/Security Plan
	<input type="checkbox"/> Convert to Injection	<input type="checkbox"/> Plug Back	<input type="checkbox"/> Water Disposal	

13. Describe Proposed or Completed Operation (clearly state all pertinent details, including estimated starting date of any proposed work and approximate duration thereof. If the proposal is to deepen directionally or recomplete horizontally, give subsurface locations and measured and true vertical depths of all pertinent markers and zones. Attach the Bond under which the work will be performed or provide the Bond No. on file with BLM/BIA. Required subsequent reports shall be filed within 30 days following completion of the involved operations. If the operation results in a multiple completion or recompletion in a new interval, a Form 3160-4 shall be filed once testing has been completed. Final Abandonment Notices shall be filed only after all requirements, including reclamation, have been completed, and the operator has determined that the site is ready for final inspection.)

Attached is the Site Facility Diagram for the WTU 945.

(PN 819425)

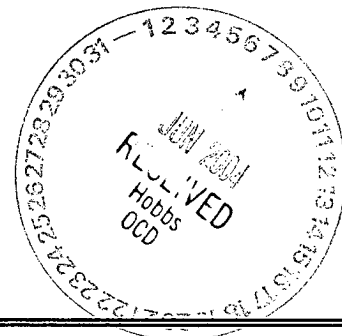

14. I hereby certify that the foregoing is true and correct.

**Electronic Submission #31174 verified by the BLM Well Information System
For CHESAPEAKE OPERATING INC, sent to the Hobbs
Committed to AFMS for processing by ARMANDO LOPEZ on 06/01/2004 (04AL0100SE)**

Name (Printed/Typed) LINDA GOOD

Title AUTHORIZED REPRESENTATIVE

Signature (Electronic Submission)

Date 05/26/2004

THIS SPACE FOR FEDERAL OR STATE OFFICE USE

Approved By **ACCEPTED**

DAVID R GLASS
Title PETROLEUM ENGINEER

Date 06/02/2004

Conditions of approval, if any, are attached. Approval of this notice does not warrant or certify that the applicant holds legal or equitable title to those rights in the subject lease which would entitle the applicant to conduct operations thereon.

Office Hobbs

Title 18 U.S.C. Section 1001 and Title 43 U.S.C. Section 1212, make it a crime for any person knowingly and willfully to make to any department or agency of the United States any false, fictitious or fraudulent statements or representations as to any matter within its jurisdiction.

**** BLM REVISED ** BLM REVISED ** BLM REVISED ** BLM REVISED ** BLM REVISED ****

GW

CHESAPEAKE OPERATING, INC.

CHK Name & Number:
API number:
County:
State:
Field:
Qtr Qtr Calls:
Sec/Twnshp/Rng:
Number of Acres:

WTU 945 819425
30-025-36079
LEA
NM
TEAS, YATES-SEVEN RIVERS WEST
SE NE
9-20S-33E
40

Regulatory Agency:
Lease Sign Type:
CA#:
APD Lease #:
Federal/Indian:
Last Violation:
District:
Field Office:

BLM
FEDERAL
NMNM 103145X
NMNM 104724
FEDERAL
UNKNOWN
PERMIAN
HOBBS

1

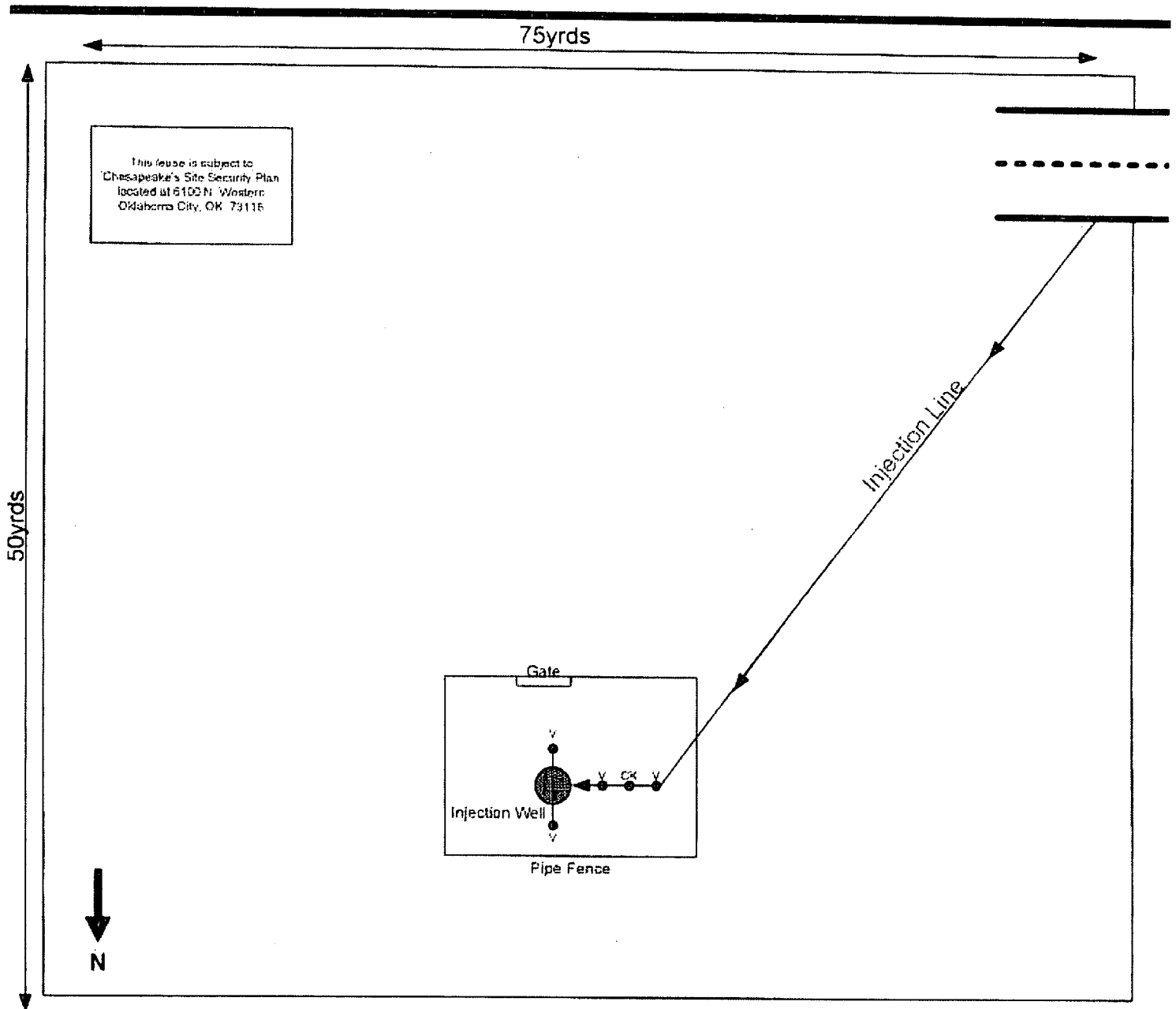

Direction of Flow off Site: NE

Prepared by: B. Blevins
Date: 05/10/04

Approved by:
Date: