

Submit 3 Copies To Appropriate District
Office
District I
1625 N. French Dr., Hobbs, NM 88240
District II
1301 W. Grand Ave., Artesia, NM 88210
District III
1000 Rio Brazos Rd., Aztec, NM 87410
District IV
1220 S. St. Francis Dr., Santa Fe, NM
87505

State of New Mexico
Energy, Minerals and Natural Resources

Form C-103
March 4, 2004

OIL CONSERVATION DIVISION
1220 South St. Francis Dr.
Santa Fe, NM 87505

WELL API NO. 30-025-30265
5. Indicate Type of Lease STATE <input checked="" type="checkbox"/> FEE <input type="checkbox"/>
6. State Oil & Gas Lease No. LG-6555
7. Lease Name or Unit Agreement Name Chiso -B-, 8711 JV-P Com
8. Well Number 1
9. OGRID Number 003002
10. Pool name or Wildcat Ojo Chiso, Morrow

SUNDRY NOTICES AND REPORTS ON WELLS (DO NOT USE THIS FORM FOR PROPOSALS TO DRILL OR TO DEEPEN OR PLUG BACK TO A DIFFERENT RESERVOIR. USE "APPLICATION FOR PERMIT" (FORM C-101) FOR SUCH PROPOSALS.) 1. Type of Well: Oil Well <input type="checkbox"/> Gas Well <input checked="" type="checkbox"/> Other	
2. Name of Operator BTA Oil Producers	
3. Address of Operator 104 S. Pecos, Midland, TX 79701	
4. Well Location Unit Letter <u>K</u> : <u>1980</u> feet from the <u>South</u> line and <u>2310</u> feet from the <u>West</u> line Section <u>14</u> Township <u>22S</u> Range <u>34E</u> NMPM Lea County	
11. Elevation (Show whether DR, RKB, RT, GR, etc.) 3477' GR	
Pit or Below-grade Tank Application (For pit or below-grade tank closures, a form C-144 must be attached) Pit Location: UL <u> </u> Sect <u> </u> Twp <u> </u> Rng <u> </u> Pit type <u> </u> Depth to Groundwater <u> </u> Distance from nearest fresh water well <u> </u> Distance from nearest surface water <u> </u> Below-grade Tank Location UL <u> </u> Sect <u> </u> Twp <u> </u> Rng <u> </u> ; <u> </u> feet from the <u> </u> line and <u> </u> feet from the <u> </u> line	

12. Check Appropriate Box to Indicate Nature of Notice, Report or Other Data
NOTICE OF INTENTION TO:

PERFORM REMEDIAL WORK ☐ PLUG AND ABANDON ☐
TEMPORARILY ABANDON ☐ CHANGE PLANS ☐
PULL OR ALTER CASING ☐ MULTIPLE COMPLETION ☐
OTHER: ONE TIME off-lease movement of hydrocarbon ☒

SUBSEQUENT REPORT OF:

REMEDIAL WORK ☐ ALTERING CASING ☐
COMMENCE DRILLING OPNS. ☒ PLUG AND ABANDONMENT ☐
CASING TEST AND CEMENT JOB ☐
OTHER: ☐

13. Describe proposed or completed operations. (Clearly state all pertinent details, and give pertinent dates, including estimated date of starting any proposed work). SEE RULE 1103. For Multiple Completions: Attach wellbore diagram of proposed completion or recompletion.

BTA Oil Producers respectfully requests permission for off-lease movement, after measurement, of hydrocarbons for this lease. This is a one-time request. Future production will continue to be measured and stored on each individual location, as it has been. The basis of this request is to prevent waste and to be able to take advantage of current market pricing. The production from each lease will be measured accurately by gauging and will be documented at both locations prior to and after transporting. With such accurate record-keeping, we do not anticipate payout complications. We believe that, by moving the measured hydrocarbons to a central point for sale, we are not hurting the value of production.

This well has not produced condensate since 2/1999. The current stock on hand is 41 bbls. Our intent is to put together a few smaller volumes at one central location in order to make a full load for transporter pick up, rather than have small volumes of stock at individual locations that sit for extremely long periods of time.

We propose to move the stock on hand at this lease to BTA's 8016 JV-P State 2 #2 in UL -L-, Sec. 2, T23S-R34E, Lea Co., NM (API 30-025-31739).

I hereby certify that the information above is true and complete to the best of my knowledge and belief. I further certify that any pit or below-grade tank has been/will be constructed or closed according to NMOC guidelines ☐, a general permit ☐ or an (attached) alternative OCD-approved plan ☐.

SIGNATURE Pam Inskeep TITLE Regulatory Administrator DATE 06/10/2004

Type or print name Pam Inskeep E-mail address: pinskeep@btaoil.com Telephone No. (432) 682-3753

(This space for State use)

APPROVED BY Larry W. Wink TITLE OFFICE REPRESENTATIVE II/STAFF MANAGER DATE

Conditions of approval, if any:

JUN 22 2004

MEXICO OIL CONSERVATION COMMISSION
WELL LOCATION AND ACREAGE DEDICATION PLAT

Form C-102
 Supersedes C-128
 Effective 1-1-65

All distances must be from the outer boundaries of the Section.

Operator BTA OIL PRODUCERS		Lease Chiso "B", 8711 JV-P		Well No. 1
Unit Letter "K"	Section 14	Township 22-S	Range 34-E	County LEA
Actual Footage Location of Well: 1980 feet from the SOUTH line and 2310 feet from the WEST line				
Ground Level Elev. 3477	Producing Formation OJO CHISO	Pool MORROW	Dedicated Acreage: 320 Acres	

1. Outline the acreage dedicated to the subject well by colored pencil or hachure marks on the plat below.
2. If more than one lease is dedicated to the well, outline each and identify the ownership thereof (both as to working interest and royalty). Farmout from Pogo LG - 6555 1/8 State Royalty
 Farmout from Pogo V - 698 1/6 State Royalty
3. If more than one lease of different ownership is dedicated to the well, have the interests of all owners been consolidated by communization, unitization, force-pooling, etc?

☒ Yes ☐ No If answer is "yes," type of consolidation Communization

If answer is "no," list the owners and tract descriptions which have actually been consolidated. (Use reverse side of this form if necessary.) _____

No allowable will be assigned to the well until all interests have been consolidated (by communization, unitization, forced-pooling, or otherwise) or until a non-standard unit, eliminating such interests, has been approved by the Commission.

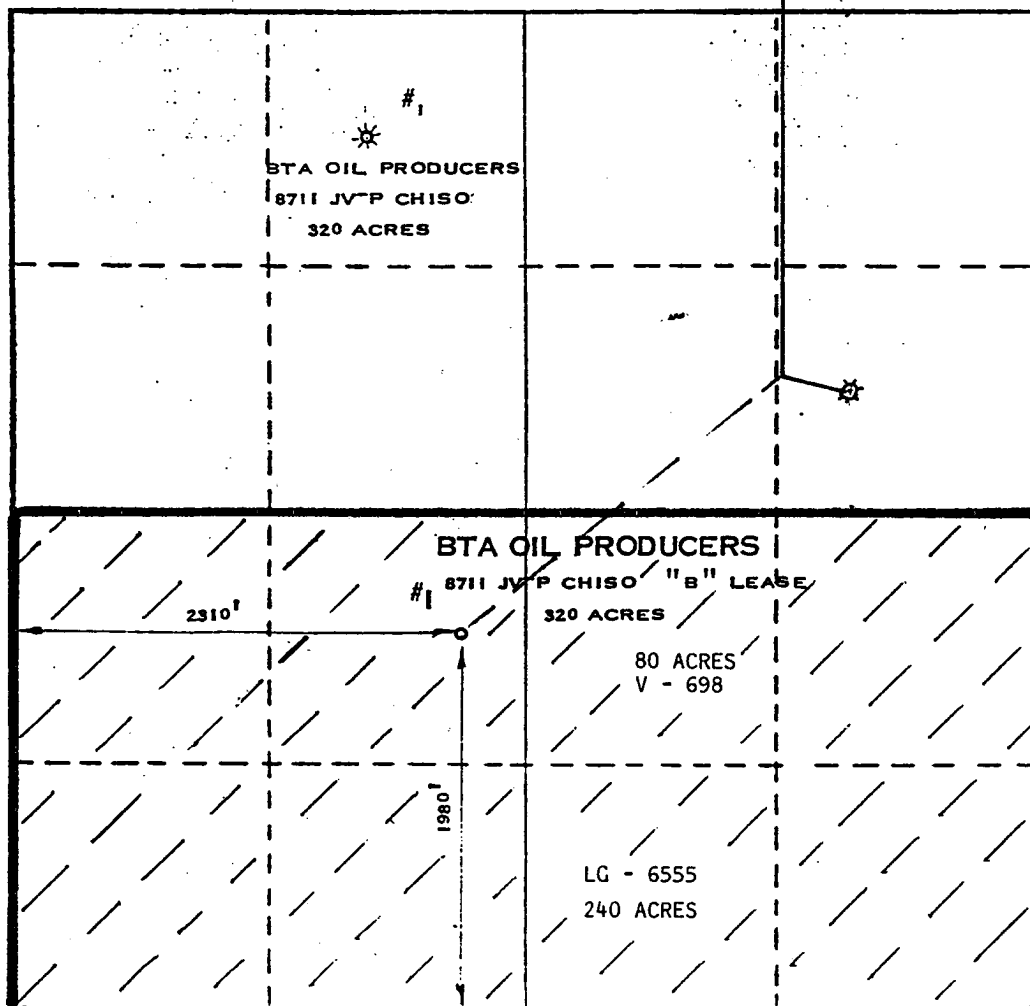

CERTIFICATION

I hereby certify that the information contained herein is true and complete to the best of my knowledge and belief.

Dorothy Houghton
 Name

DOROTHY HOUGHTON

Position

Regulatory Supervisor

Company

BTA OIL PRODUCERS

Date

2/25/88

I hereby certify that the well location shown on this plat was plotted from field notes of actual surveys made by me or under my supervision, and that the same is true and correct to the best of my knowledge and belief.

Date Surveyed

FEBRUARY 24, 1988

Registered Professional Engineer and/or Land Surveyor

Max A Schumann Jr
MAX A SCHUMANN JR

Certificate No.

1510

