

District I  
4625 N. French Dr., Hobbs, NM 88240  
District II  
1301 W. Grand Avenue, Artesia, NM 88210  
District III  
1000 Rio Brazos Road, Aztec, NM 87410  
District IV  
1220 S. St. Francis Dr., Santa Fe, NM 87505

State of New Mexico  
Energy Minerals and Natural Resources

Oil Conservation Division  
1220 South St. Francis Dr.  
Santa Fe, NM 87505

Form C-144  
March 12, 2004

For drilling and production facilities, submit to appropriate NMOCD District Office.  
For downstream facilities, submit to Santa Fe office

**Pit or Below-Grade Tank Registration or Closure**

Is pit or below-grade tank covered by a "general plan"? Yes ☐ No ☐  
Type of action: Registration of a pit or below-grade tank ☒ Closure of a pit or below-grade tank ☐

Operator: <u>Chesapeake Operating, Inc.</u> Telephone: <u>(432)685-4310</u> e-mail address: <u>bcoffman@chkenegy.com</u>				
Address: <u>P. O. Box 11050 Midland, TX 79702-8050</u>				
Facility or well name: <u>CC "3" W State #1</u> API #: <u>30-225-36794</u> U/l or Qtr/Qtr M <u>Sec 3 T 21S R 35E</u>				
County: <u>Lea</u> Latitude <u>N32 30' 12.6"</u> Longitude <u>W103 21' 38.9"</u> NAD: 1927 <input type="checkbox"/> 1983 <input type="checkbox"/> Surface Owner Federal <input type="checkbox"/> State <input checked="" type="checkbox"/> Private <input type="checkbox"/> Indian <input type="checkbox"/>				
<table border="1"> <tr> <td> <b>Pit</b>  Type: Drilling <input checked="" type="checkbox"/> Production <input type="checkbox"/> Disposal <input type="checkbox"/>  Workover <input type="checkbox"/> Emergency <input type="checkbox"/>  Lined <input checked="" type="checkbox"/> Unlined <input type="checkbox"/>  Liner type: Synthetic <input checked="" type="checkbox"/> Thickness <u>12</u> mil Clay <input type="checkbox"/> Volume <u>15948</u> bbl </td> <td> <b>Below-grade tank</b>  Volume: _____ bbl Type of fluid: _____  Construction material: _____  Double-walled, with leak detection? Yes <input type="checkbox"/> If not, explain why not: _____ </td> </tr> </table>			<b>Pit</b> Type: Drilling <input checked="" type="checkbox"/> Production <input type="checkbox"/> Disposal <input type="checkbox"/> Workover <input type="checkbox"/> Emergency <input type="checkbox"/> Lined <input checked="" type="checkbox"/> Unlined <input type="checkbox"/> Liner type: Synthetic <input checked="" type="checkbox"/> Thickness <u>12</u> mil Clay <input type="checkbox"/> Volume <u>15948</u> bbl	<b>Below-grade tank</b> Volume: _____ bbl Type of fluid: _____ Construction material: _____ Double-walled, with leak detection? Yes <input type="checkbox"/> If not, explain why not: _____
<b>Pit</b> Type: Drilling <input checked="" type="checkbox"/> Production <input type="checkbox"/> Disposal <input type="checkbox"/> Workover <input type="checkbox"/> Emergency <input type="checkbox"/> Lined <input checked="" type="checkbox"/> Unlined <input type="checkbox"/> Liner type: Synthetic <input checked="" type="checkbox"/> Thickness <u>12</u> mil Clay <input type="checkbox"/> Volume <u>15948</u> bbl	<b>Below-grade tank</b> Volume: _____ bbl Type of fluid: _____ Construction material: _____ Double-walled, with leak detection? Yes <input type="checkbox"/> If not, explain why not: _____			
Depth to ground water (vertical distance from bottom of pit to seasonal high water elevation of ground water.)	Less than 50 feet (20 points) 50 feet or more, but less than 100 feet (10 points) <u>100 feet or more</u> (0 points) <input checked="" type="radio"/>			
Wellhead protection area: (Less than 200 feet from a private domestic water source, or less than 1000 feet from all other water sources.)	Yes (20 points) <u>No</u> (0 points) <input checked="" type="radio"/>			
Distance to surface water: (horizontal distance to all wetlands, playas, irrigation canals, ditches, and perennial and ephemeral watercourses.)	Less than 200 feet (20 points) 200 feet or more, but less than 1000 feet (10 points) <u>1000 feet or more</u> (0 points) <input checked="" type="radio"/>			
Ranking Score (Total Points)		0		

If this is a pit closure: (1) attach a diagram of the facility showing the pit's relationship to other equipment and tanks. (2) Indicate disposal location: onsite ☐ offsite ☐ If offsite, name of facility: \_\_\_\_\_ (3) Attach a general description of remedial action taken including remediation start date and end date. (4) Groundwater encountered: No ☐ Yes ☐ If yes, show depth below ground surface: \_\_\_\_\_ ft and attach sample results. (5) Attach soil sample results and a diagram of sample locations and excavations.

I hereby certify that the information above is true and complete to the best of my knowledge and belief. I further certify that the above-described pit or below-grade tank has been/will be constructed or closed according to NMOCD guidelines ☐, a general permit ☐, or an (attached) alternative OCD-approved plan ☐.

Printed Name/Title: Brenda Coffman Regulatory Analyst

Signature: Brenda Coffman

Your certification and NMOCD approval of this application/closure does not relieve the operator of liability should the contents of the pit or tank contaminate ground water or otherwise endanger public health or the environment. Nor does it relieve the operator of its responsibility for compliance with any other federal, state, or local laws and/or regulations.

Approval:

Date: 8/2/04  
Printed Name/Title: PETROLEUM ENGINEER

Signature: [Signature]

MIDLAND, TX  
OKLAHOMA CITY, OK  
VICTORIA, TX

(915) 884-7446  
(405) 810-0021  
(361) 578-5297

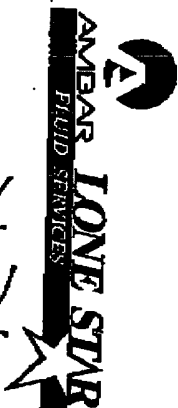

HOUSTON, TX  
LA FAYETTE, LA  
NEW ORLEANS, LA

(281) 877-1200  
(337) 237-5300  
(504) 568-0411

219.71

Subject Chesapeake Operating, Inc.

File

Page No.

of

By A. H. H. H.

Date

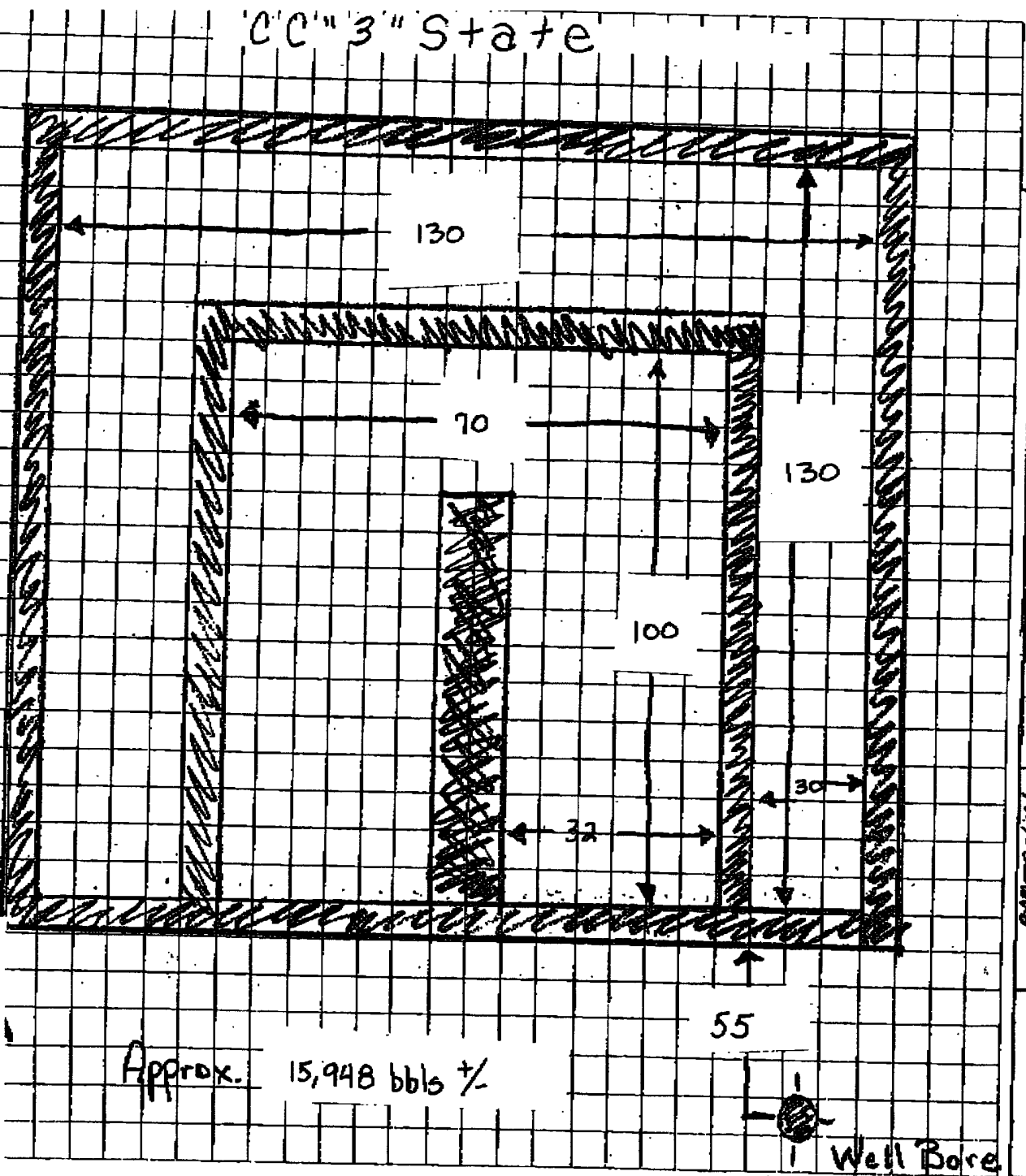

# WALL BERM DRWG PIT CC "3" State

