

Submit 3 Copies To Appropriate District Office

District I

1625 N. French Dr., Hobbs, NM 88240

District II

1301 W. Grand Ave., Artesia, NM 88210

District III

1000 Rio Brazos Rd., Aztec, NM 87410

District IV

1220 S. St. Francis Dr., Santa Fe, NM 87505

State of New Mexico  
Energy, Minerals and Natural Resources

OIL CONSERVATION DIVISION  
1220 South St. Francis Dr.  
Santa Fe, NM 87505

Form C-103  
Revised June 10, 2003

WELL API NO.

30-025-36801

5. Indicate Type of Lease

STATE ☐ FEE ☒

6. State Oil & Gas Lease No.

7. Lease Name or Unit Agreement Name  
Burrus 27

8. Well Number

9

9. OGRID Number

147179

10. Pool name or Wildcat  
Tonto:Seven Rivers

SUNDRY NOTICES AND REPORTS ON WELLS

(DO NOT USE THIS FORM FOR PROPOSALS TO DRILL OR TO DEEPEN OR PLUG BACK TO A DIFFERENT RESERVOIR. USE "APPLICATION FOR PERMIT" (FORM C-101) FOR SUCH PROPOSALS.)

1. Type of Well:

Oil Well ☒ Gas Well ☐ Other

2. Name of Operator

Chesapeake Operating, Inc.

3. Address of Operator

P. O. Box 11050  
Midland, TX 79702-8050

4. Well Location

Unit Letter F : 1473 feet from the North line and 2056 feet from the West line

Section 27

Township 12S

Range 38E

NMPM

County Lea

11. Elevation (Show whether DR, RKB, RT, GR, etc.)  
3802' GR

12. Check Appropriate Box to Indicate Nature of Notice, Report or Other Data

NOTICE OF INTENTION TO:

PERFORM REMEDIAL WORK ☐ PLUG AND ABANDON ☐

TEMPORARILY ABANDON ☐ CHANGE PLANS ☐

PULL OR ALTER CASING ☐ MULTIPLE COMPLETION ☐

OTHER: Move Location ☒

SUBSEQUENT REPORT OF:

REMEDIAL WORK ☐ ALTERING CASING ☐

COMMENCE DRILLING OPNS. ☐ PLUG AND ABANDONMENT ☐

CASING TEST AND CEMENT JOB ☐

OTHER: ☐

13. Describe proposed or completed operations. (Clearly state all pertinent details, and give pertinent dates, including estimated date of starting any proposed work). SEE RULE 1103. For Multiple Completions: Attach wellbore diagram of proposed completion or recompletion.

Please, change the location FROM 1473' FNL & 2306' FWL of Section 27, T12S, R38E TO: 1473' FNL & 2056' FWL of Section 27, T12S, R38E. Attached is a new C-102 showing the correct location and Form C-144 with attachments.

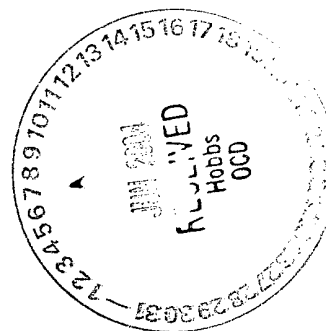

I hereby certify that the information above is true and complete to the best of my knowledge and belief.

SIGNATURE Brenda Coffman

TITLE Regulatory Analyst

DATE 06/03/2004

Type or print name Brenda Coffman

bcoffman@chkenergy.com

E-mail address:

Telephone No. (432)685-4373

(This space for State use)

APPROVED BY Chris Williams

Conditions of approval, if any:

TITLE DISTRICT SUPERVISOR/GENERAL MANAGER

DATE SEP 21 2004

**DISTRICT I**  
1625 N. French Dr., Hobbs, NM 88240

State of New Mexico

Form C-102

Energy, Minerals, and Natural Resources Department

Revised August 15, 2000

**DISTRICT II**  
1301 W. Grand Avenue, Artesia, NM 88210

**OIL CONSERVATION DIVISION**

Submit to Appropriate District Office

State Lease - 4 copies

Fee Lease - 3 copies

**DISTRICT III**  
1000 Rio Brazos Rd., Aztec, NM 87410

1220 South St. Francis Dr.

Santa Fe, New Mexico 87505

**DISTRICT IV**  
1220 S. St. Francis Dr., Santa Fe, NM 87505

☐ AMENDED REPORT

**WELL LOCATION AND ACREAGE DEDICATION PLAT**

<sup>1</sup> API Number	<sup>2</sup> Pool Code 59470	<sup>3</sup> Pool Name Junto; Seven Rivers
<sup>4</sup> Property Code	<sup>5</sup> Property Name BURRUS 27	<sup>6</sup> Well Number 9
<sup>7</sup> OGRID No. 147179	<sup>8</sup> Operator Name CHESAPEAKE OPERATING, INC.	<sup>9</sup> Elevation 3802'

**<sup>10</sup> Surface Location**

UL or lot no.	Section	Township	Range	Lot Idn	Feet from the	North/South line	Feet from the	East/West line	County
F	27	12 SOUTH	38 EAST, N.M.P.M.		1473'	NORTH	2056'	WEST	LEA

**<sup>11</sup> Bottom Hole Location If Different From Surface**

UL or lot no.	Section	Township	Range	Lot Idn	Feet from the	North/South line	Feet from the	East/West line	County
<sup>12</sup> Dedicated Acres 40	<sup>13</sup> Joint or Infill	<sup>14</sup> Consolidation Code	<sup>15</sup> Order No.						

**NO ALLOWABLE WELL BE ASSIGNED TO THIS COMPLETION UNTIL ALL INTERESTS HAVE BEEN CONSOLIDATED OR A NON-STANDARD UNIT HAS BEEN APPROVED BY THE DIVISION**

<div><p><sup>16</sup></p><p>NAD 27 TC ZONE X = 886647 Y = 807118 LAT.: N 33°15'10" LONG.: W 103°05'11"</p></div>	<div><p><b><sup>17</sup> OPERATOR CERTIFICATION</b></p><p>I hereby certify that the information contained herein is true and complete to the best of my knowledge and belief.</p><p><i>Brenda Coffman</i> Signature Brenda Coffman Printed Name Regulatory Analyst Title 6-3-04 Date</p><p><b><sup>18</sup> SURVEYOR CERTIFICATION</b></p><p>I hereby certify that the well location shown on this plat was plotted from field notes of actual surveys made by me or under my supervision, and that the same is true and correct to the best of my belief.</p><p>MAY 10, 2004 Date of Survey Signature and Seal of Professional Surveyor <i>V. L. Beznar</i> Certificate Number V. L. BEZNER R.P.S. #7920 JOB #95004 / 145 SE / E.U.O.</p></div>
--	--

District I  
1625 N. French Dr., Hobbs, NM 88240  
District II  
1301 W. Grand Avenue, Artesia, NM 88210  
District III  
1000 Rio Brazos Road, Aztec, NM 87410  
District IV  
1220 S. St. Francis Dr., Santa Fe, NM 87505

State of New Mexico  
Energy Minerals and Natural Resources  
Oil Conservation Division  
1220 South St. Francis Dr.  
Santa Fe, NM 87505

Form C-144  
March 12, 2004

For drilling and production facilities, submit to appropriate NMOCD District Office.  
For downstream facilities, submit to Santa Fe office

**Pit or Below-Grade Tank Registration or Closure**

Is pit or below-grade tank covered by a "general plan"? Yes ☐ No ☐

Type of action: Registration of a pit or below-grade tank ☒ Closure of a pit or below-grade tank ☐

Operator: <u>Chesapeake</u> Telephone: <u>432-683-7443</u> e-mail address: <u>mwhitefield@chkenenergy.com</u>		
Address: <u>550 W. Texas Ave. #1300 Midland, Tx. 79701</u>		
Facility or well name: <u>Burrus 27-9</u> API #: <u>30-025-3680</u> or Qtr/Qtr <u>F</u> Sec <u>27 T 12 R 3E</u>		
County: <u>Lea</u> Latitude <u>N33°15'10"</u> Longitude <u>W103°05'11"</u> NAD: 1927 <input type="checkbox"/> 1983 <input type="checkbox"/> Surface Owner Federal <input type="checkbox"/> State <input checked="" type="checkbox"/> Private <input checked="" type="checkbox"/> Indian <input type="checkbox"/> <span style="float: right;">MOW</span>		
<b>Pit</b> Type: Drilling <input checked="" type="checkbox"/> Production <input type="checkbox"/> Disposal <input type="checkbox"/> Workover <input type="checkbox"/> Emergency <input type="checkbox"/> Lined <input checked="" type="checkbox"/> Unlined <input type="checkbox"/> Liner type: Synthetic <input checked="" type="checkbox"/> Thickness <u>12</u> mil Clay <input type="checkbox"/> Volume <u>15,948</u> bbl	<b>Below-grade tank</b> Volume: _____ bbl Type of fluid: _____ Construction material: _____ Double-walled, with leak detection? Yes <input type="checkbox"/> If not, explain why not. _____	
Depth to ground water (vertical distance from bottom of pit to seasonal high water elevation of ground water.)	<u>Less than 50 feet</u> 50 feet or more, but less than 100 feet <u>100 feet or more</u>	(20 points) <u>23.57</u> (10 points) (0 points) <u>0</u>
Wellhead protection area: (Less than 200 feet from a private domestic water source, or less than 1000 feet from all other water sources.)	Yes <u>No</u>	(20 points) (0 points) <u>0</u>
Distance to surface water: (horizontal distance to all wetlands, playas, irrigation canals, ditches, and perennial and ephemeral watercourses.)	Less than 200 feet 200 feet or more, but less than 1000 feet <u>1000 feet or more</u>	(20 points) (10 points) (0 points) <u>0</u>
Ranking Score (Total Points)		<u>20</u>

**If this is a pit closure:** (1) attach a diagram of the facility showing the pit's relationship to other equipment and tanks. (2) Indicate disposal location: onsite ☐ offsite ☐ If offsite, name of facility \_\_\_\_\_. (3) Attach a general description of remedial action taken including remediation start date and end date. (4) Groundwater encountered: No ☐ Yes ☐ If yes, show depth below ground surface \_\_\_\_\_ ft. and attach sample results. (5) Attach soil sample results and a diagram of sample locations and excavations.

I hereby certify that the information above is true and complete to the best of my knowledge and belief. I further certify that the above-described pit or below-grade tank has been/will be constructed or closed according to NMOCD guidelines ☒, a general permit ☐, or an (attached) alternative OCD-approved plan ☐.

Date: 6-1-04

Printed Name/Title: Mike Whitefield Field Rep. Signature: [Signature]

Your certification and NMOCD approval of this application/closure does not relieve the operator of liability should the contents of the pit or tank contaminate ground water or otherwise endanger public health or the environment. Nor does it relieve the operator of its responsibility for compliance with any other federal, state, or local laws and/or regulations.

Approval:

Date: 9/9/04

Printed Name/Title: CHRIS WILLIAMS DIST. SUPV Signature: [Signature]

MIDLAND, TX (915) 684-7446  
 OKLAHOMA CITY, OK (405) 810-0021  
 VICTORIA, TX (361) 576-5297



HOUSTON, TX (281) 877-1200  
 LAFAYETTE, LA (337) 237-5300  
 NEW ORLEANS, LA (504) 566-0411

*Drq. Pit*

Subject	<i>Chesapeake Operating, Inc</i>		Page No.	of
File			By <i>N. Newland</i>	Date

BURRUS 27-9

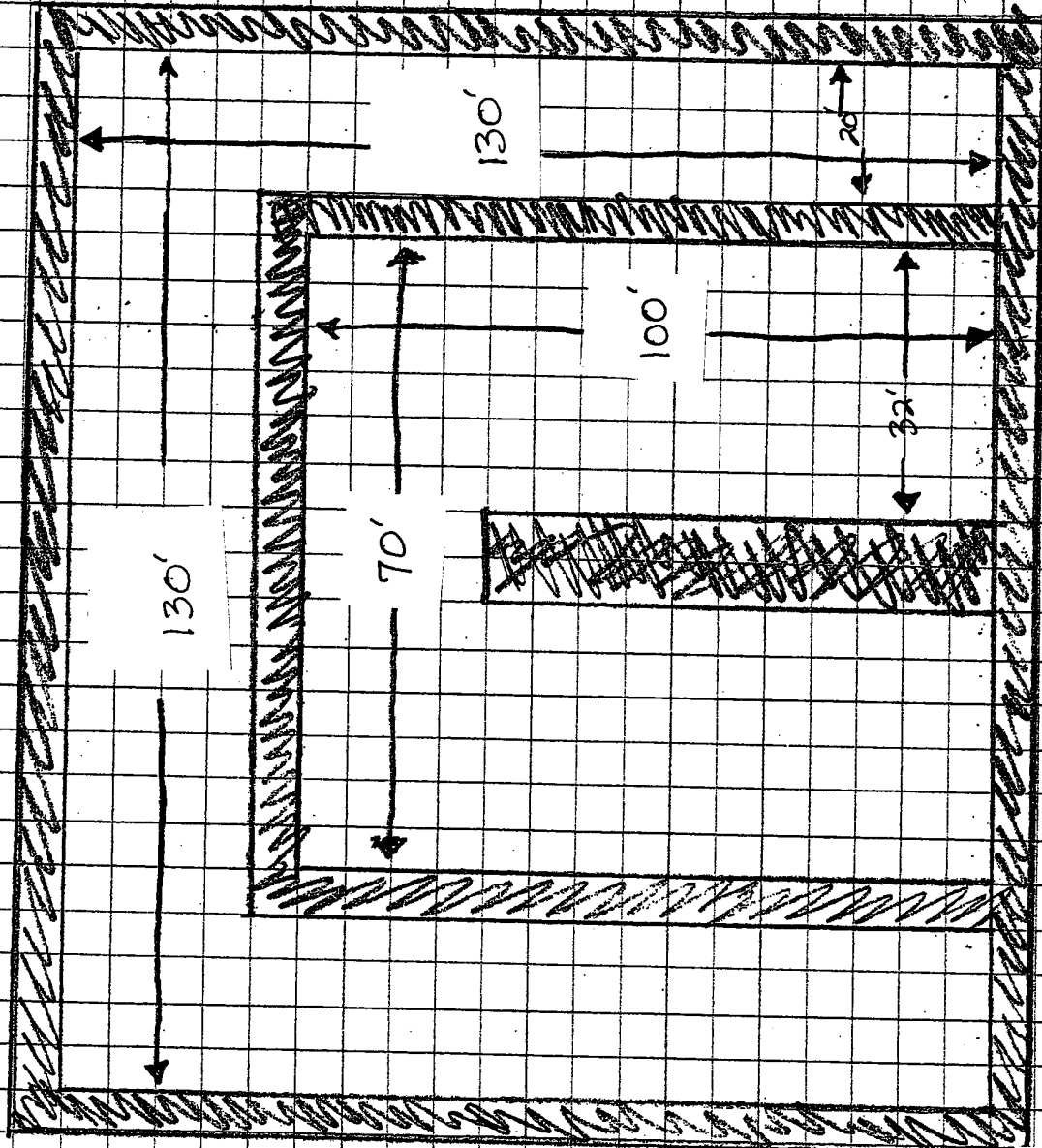

Approx. 15,948 bbls +/-

Well Bore

# WALL BERM DRWG PIT

BURRUS 27-9

