

District I  
1625 N. French Dr., Hobbs, NM 88240  
District II  
1301 W. Grand Avenue, Artesia, NM 88210  
District III  
1000 Rio Brazos Road, Aztec, NM 87410  
District IV  
1220 S. St. Francis Dr., Santa Fe, NM 87505

State of New Mexico  
Energy Minerals and Natural Resources

Form C-101  
May 27, 2004

Oil Conservation Division  
1220 South St. Francis Dr.  
Santa Fe, NM 87505

Submit to appropriate District Office

☐ AMENDED REPORT

**APPLICATION FOR PERMIT TO DRILL, RE-ENTER, DEEPEN, PLUGBACK, OR ADD A ZONE**

<sup>1</sup> Operator Name and Address MAR Oil & Gas Corp PO Box 5155, Santa Fe, New Mexico 87502		<sup>2</sup> OGRID Number 151228
<sup>3</sup> Property Code 30415	<sup>4</sup> Property Name Malmar Unit	<sup>5</sup> API Number 30 - 025-36879
<sup>9</sup> Proposed Pool 1 Maljamar - Grayburg - San Andres		<sup>10</sup> Proposed Pool 2

**Surface Location**

UL or lot no.	Section	Township	Range	Lot Idn	Feet from the	North/South line	Feet from the	East/West line	County
P	7	17S	33E		1310	South	330	East	Lea

**Proposed Bottom Hole Location If Different From Surface**

UL or lot no.	Section	Township	Range	Lot Idn	Feet from the	North/South line	Feet from the	East/West line	County

**Additional Well Information**

<sup>11</sup> Work Type Code N	<sup>12</sup> Well Type Code O	<sup>13</sup> Cable/Rotary R	<sup>14</sup> Lease Type Code P 5	<sup>15</sup> Ground Level Elevation 4216
<sup>16</sup> Multiple NA	<sup>17</sup> Proposed Depth 4700	<sup>18</sup> Formation Graybury San Andres	<sup>19</sup> Contractor Paterson	<sup>20</sup> Spud Date October, 2004
Depth to Groundwater 140'		Distance from nearest fresh water well 5280'		Distance from nearest surface water 10 miles
<b>Pit:</b> Liner: Synthetic Plastic 40 mils thick Clay <input type="checkbox"/> Pit Volume: 4500 bbls Drilling Method: Closed-Loop System <input type="checkbox"/> Fresh Water X Brine X				

**Proposed Casing and Cement Program**

Hole Size	Casing Size	Casing weight/foot	Setting Depth	Sacks of Cement	Estimated TOC
12 1/4	8 5/8	20-24 #	1300'	1087	Surface
7 7/8"	5 1/2"	15-15.5 #	4700'	905	500' in Surf Csg

<sup>22</sup> Describe the proposed program. If this application is to DEEPEN or PLUG BACK, give the data on the present productive zone and proposed new productive zone. Describe the blowout prevention program, if any. Use additional sheets if necessary.

Infill drill Grayburg-San Andres to proposed depth of 4700', Surface: drill 12 1/4" hole to 1300' or 25' into top of the Salt, no blow out prevention will be used while drilling surface hole, Run 8 5/8" surface casing and cement back to surface  
NU BOP, drill 7 7/8" hole to proposed TD, Run Logs, Run 5 1/2" casing to surface, cement production casing 500' into bottom of surface casing.

Attachments: A-BOP Schematic  
Attachment B - Rig Layout  
Attachment C - Cement Procedure  
Attachment D - Mud Program  
Attachment E - Location Plat  
Attachment F - Map of Unit Boundary

Permit Expires 1 Year From Approval  
Date Unless Drilling Underway

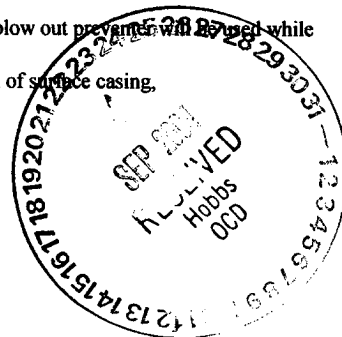

<sup>23</sup> I hereby certify that the information given above is true and complete to the best of my knowledge and belief. I further certify that the drilling pit will be constructed according to NMOC guidelines X, a general permit <input type="checkbox"/> , or an (attached) alternative OCD-approved plan <input type="checkbox"/> .		<b>OIL CONSERVATION DIVISION</b>	
Printed name: Duane C. Winkler		Approved by:	
Title: V.P. Operations		Title: <b>PETROLEUM ENGINEER</b>	
E-mail Address: duanecwinkler@earthlink.net		Approval Date: <b>SEP 24 2004</b> Expiration Date:	
Date: September 23, 2004	Phone: 505-989-1977	Conditions of Approval Attached <input type="checkbox"/>	

## State of New Mexico

## DISTRICT I

1625 N. FRENCH DR., HOBBBS, NM 88240

Energy, Minerals and Natural Resources Department

## DISTRICT II

1301 W. GRAND AVENUE, ARTESIA, NM 88210

## DISTRICT III

1000 Rio Brazos Rd., Artec, NM 87410

## DISTRICT IV

1220 S. ST. FRANCIS DR., SANTA FE, NM 87505

## OIL CONSERVATION DIVISION

1220 SOUTH ST. FRANCIS DR.

Santa Fe, New Mexico 87505

Form C-102

Revised JUNE 10, 2003

Submit to Appropriate District Office

State Lease - 4 Copies

Fee Lease - 3 Copies

## WELL LOCATION AND ACREAGE DEDICATION PLAT

☐ AMENDED REPORT

API Number <b>30-D25-36879</b>	Pool Code <b>43329</b>	Pool Name <b>Maljamar GB/5A</b>
Property Code <b>30415</b>	Property Name <b>MALMAR UNIT</b>	Well Number <b>419</b>
GRID No. <b>151228</b>	Operator Name <b>MAR OIL &amp; GAS CORPORATION</b>	Elevation <b>4216'</b>

## Surface Location

UL or lot No.	Section	Township	Range	Lot Idn	Feet from the	North/South line	Feet from the	East/West line	County
P	7	17-S	33-E		1310'	SOUTH	330'	EAST	LEA

## Bottom Hole Location If Different From Surface

UL or lot No.	Section	Township	Range	Lot Idn	Feet from the	North/South line	Feet from the	East/West line	County

Dedicated Acres <b>40</b>	Joint or Infill	Consolidation Code	Order No.
------------------------------	-----------------	--------------------	-----------

NO ALLOWABLE WILL BE ASSIGNED TO THIS COMPLETION UNTIL ALL INTERESTS HAVE BEEN CONSOLIDATED  
OR A NON-STANDARD UNIT HAS BEEN APPROVED BY THE DIVISION

LOT 1									
41.33 AC LOT 2									
41.43 AC LOT 3									
41.53 AC LOT 4									
41.63 AC									

GEODETIC COORDINATES  
NAD 27 NME

Y=671831.2 N  
X=696194.4 E

LAT.=32°50'43.14" N  
LONG.=103°41'40.25" W

330'

1310'

**OPERATOR CERTIFICATION**

I hereby certify the the information contained herein is true and complete to the best of my knowledge and belief.

*[Signature]*  
Signature

**Dwayne C Winkler**  
Printed Name

**UP Operations**  
Title

**9/23/04**  
Date

**SURVEYOR CERTIFICATION**

I hereby certify that the well location shown on this plat was plotted from field notes of actual surveys made by me or under my supervision, and that the same is true and correct to the best of my belief.

**JULY 8, 2004**

Date Surveyed **REV. 09/14/04** JR

Signature & Seal of Professional Surveyor

*[Signature]* **9/15/04**

**04.13.121E**

Certificate No. **GARY E. ELLISON** 12641

**SECTION 7, TOWNSHIP 17 SOUTH, RANGE 33 EAST, N.M.P.M.,**  
LEA COUNTY, NEW MEXICO

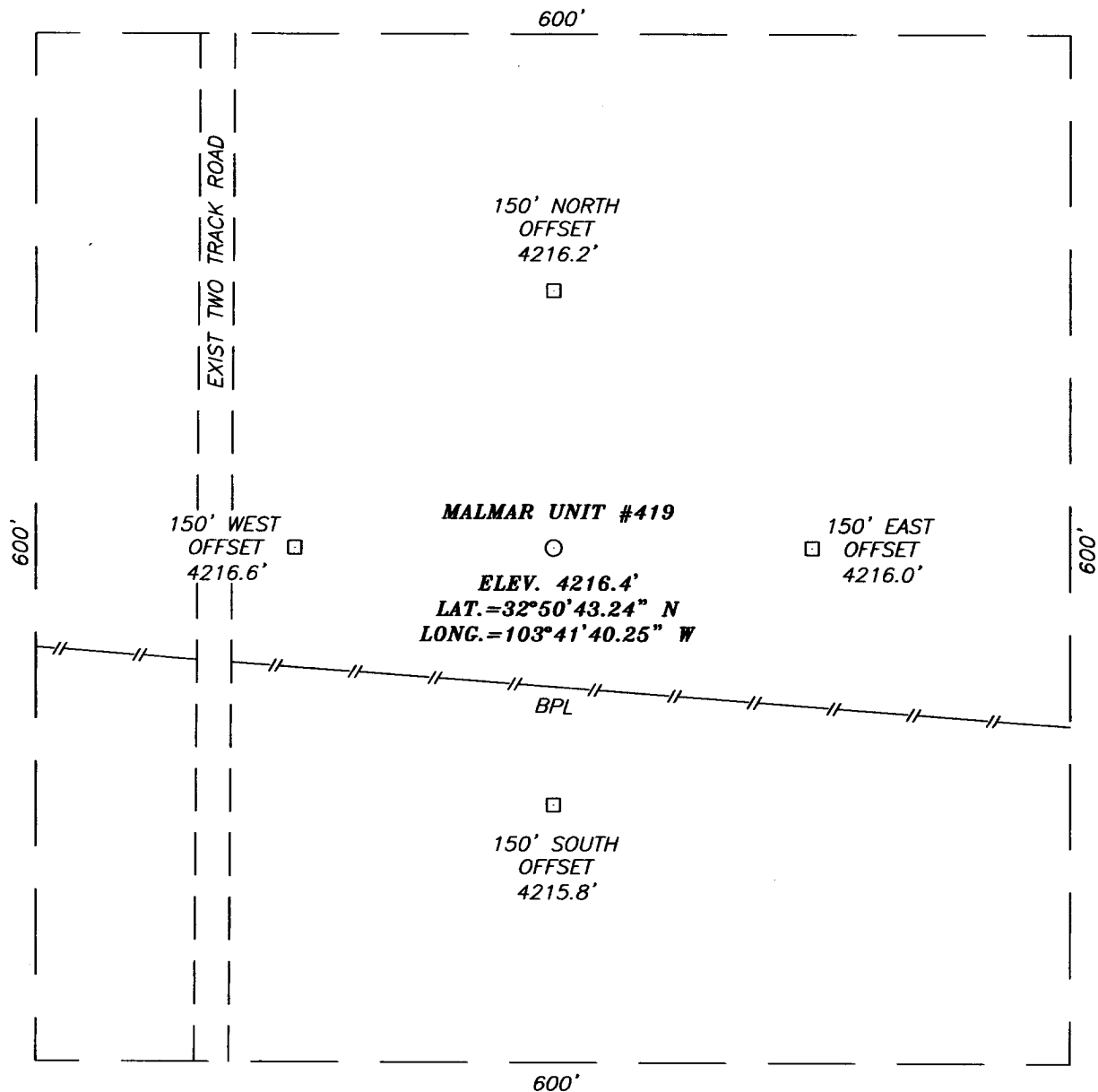

**DIRECTIONS TO LOCATION**

FROM THE INTERSECTION OF U.S. HWY #82 AND CO. RD. L-122 (HUMMINGBIRD RD.) GO SOUTH ON HUMMINGBIRD RD. FOR APPROX. 3.1 MILES TO A CALICHE ROAD ON THE RIGHT, TURN RIGHT (WEST) AND GO APPROX. 1.1 MILES TO A TWO TRACK ROAD ON THE LEFT, TURN LEFT (SOUTH) AND GO 0.1 MILES. PROPOSED LOCATION IS APPROX. 200' EAST.

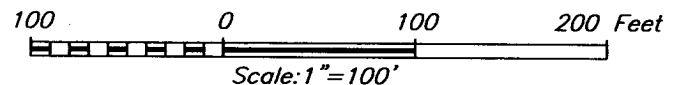

**MAR OIL & GAS CORPORATION**

MALMAR UNIT # 419 WELL  
LOCATED 1310 FEET FROM THE SOUTH LINE  
AND 330 FEET FROM THE EAST LINE OF SECTION 7,  
TOWNSHIP 17 SOUTH, RANGE 33 EAST, N.M.P.M.,  
LEA COUNTY, NEW MEXICO.

Survey Date: 07/08/04		Sheet 1 of 1 Sheets	
W.O. Number: 04.13.1211		Dr By: J. RIVERO	Rev 1:09/14/04
Date: 07/12/04	Disk: CD#10	04131211	Scale: 1"=100'

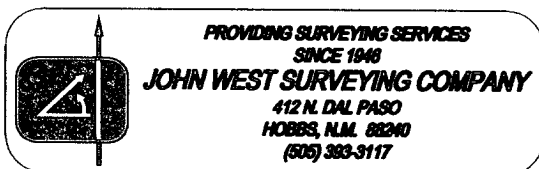

# VICINITY MAP

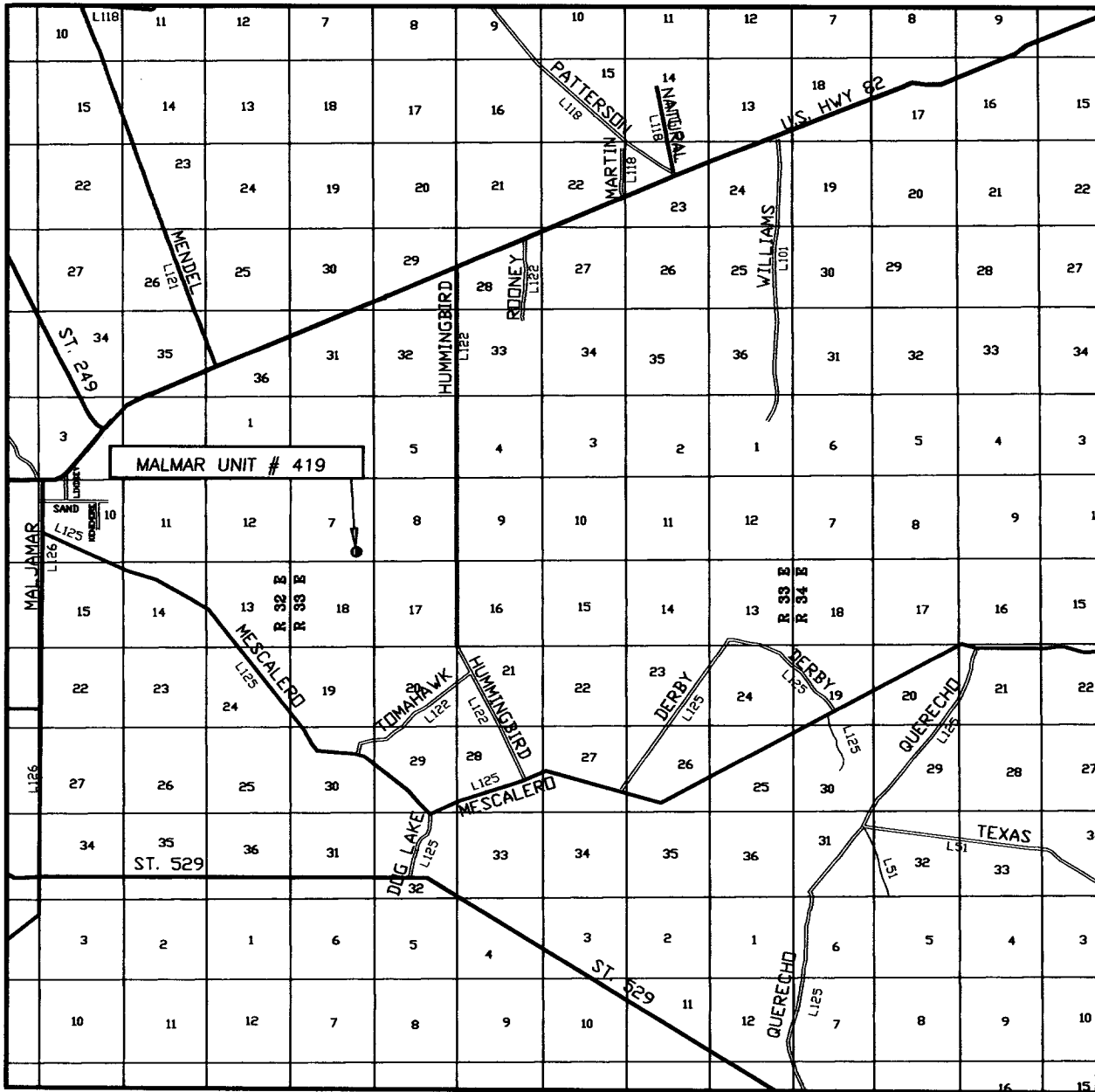

SCALE: 1" = 2 MILES

SEC. 7 TWP. 17-S RGE. 33-E

SURVEY N.M.P.M.

COUNTY LEA

DESCRIPTION 1310' FSL & 330' FEL

ELEVATION 4216'

OPERATOR MAR OIL & GAS CORPORATION

LEASE MALMAR UNIT

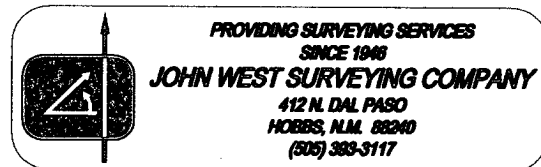

# LOCATION VERIFICATION MAP

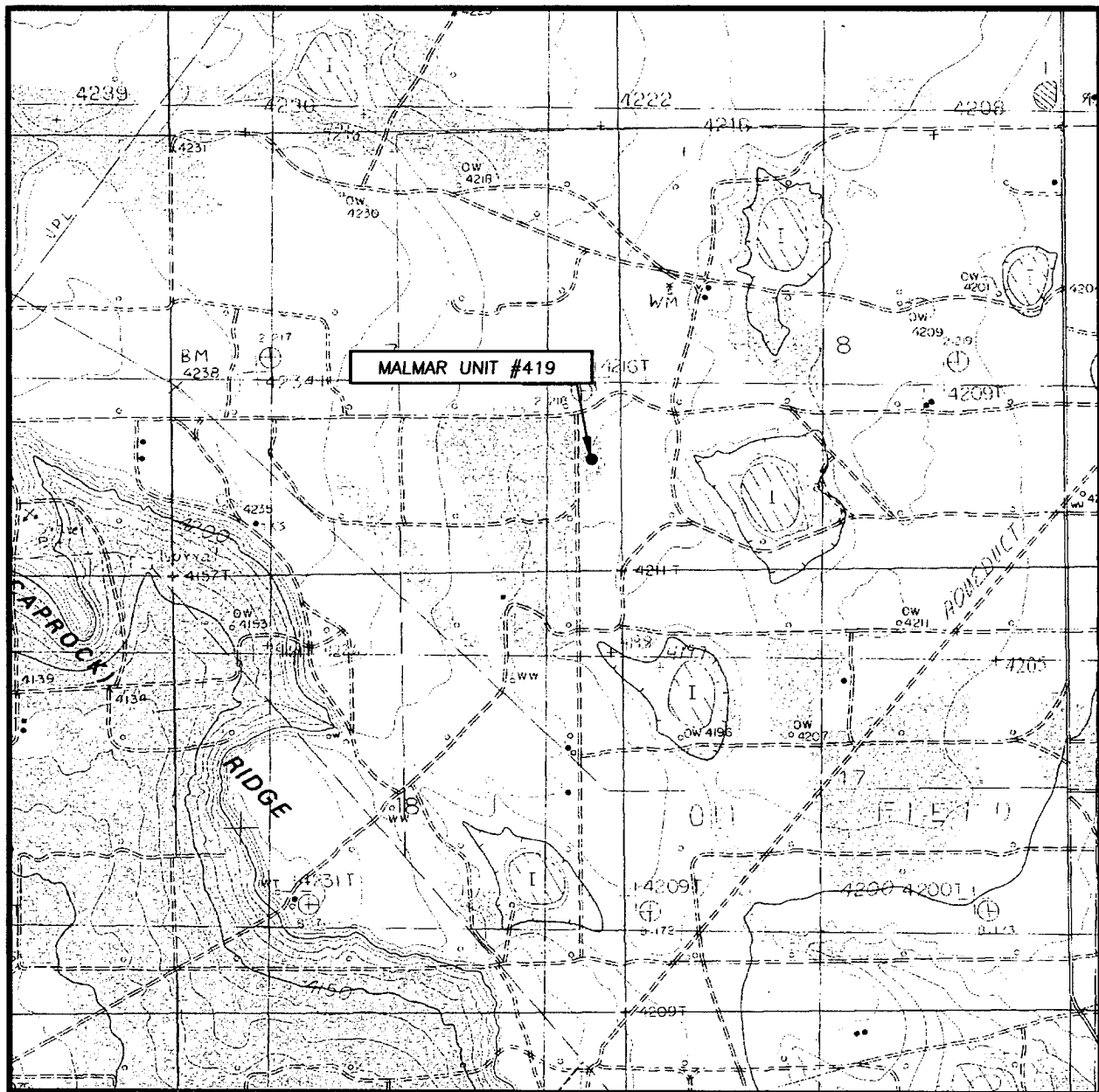

SCALE: 1" = 2000'

CONTOUR INTERVAL:  
DOG LAKE, N.M. - 5'

SEC. 7 TWP. 17-S RGE. 33-E

SURVEY N.M.P.M.

COUNTY LEA

DESCRIPTION 1310' FSL & 330' FEL

ELEVATION 4216'

OPERATOR MAR OIL & GAS CORPORATION

LEASE MALMAR UNIT

U.S.G.S. TOPOGRAPHIC MAP  
DOG LAKE, N.M.

