

NEW MEXICO OIL CONSERVATION COMMISSION

Well Location and Acreage Dedication Plat **Supersedes plat 5/6/57**

Section A.

Date July 19, 1957

Operator The Texas Company Lease United Royalty "A"  
Well No. 4 Unit Letter K Section 19 Township 24 South Range 38 East NMPM  
Located 1980 Feet From South Line, 2303.4 Feet From West Line  
County Lea G. L. Elevation 3176' Dedicated Acreage 40 Acres  
Name of Producing Formation Lower Clear Fork Pool Dollarhide (Drinkard)

1. Is the Operator the only owner\* in the dedicated acreage outlined on the plat below?  
Yes X No       .
2. If the answer to question one is "no," have the interests of all the owners been consolidated by communitization agreement or otherwise? Yes        No       . If answer is "yes," Type of Consolidation
3. If the answer to question two is "no," list all the owners and their respective interests below:

Owner

Land Description

<u>Owner</u>	<u>Land Description</u>

Section B

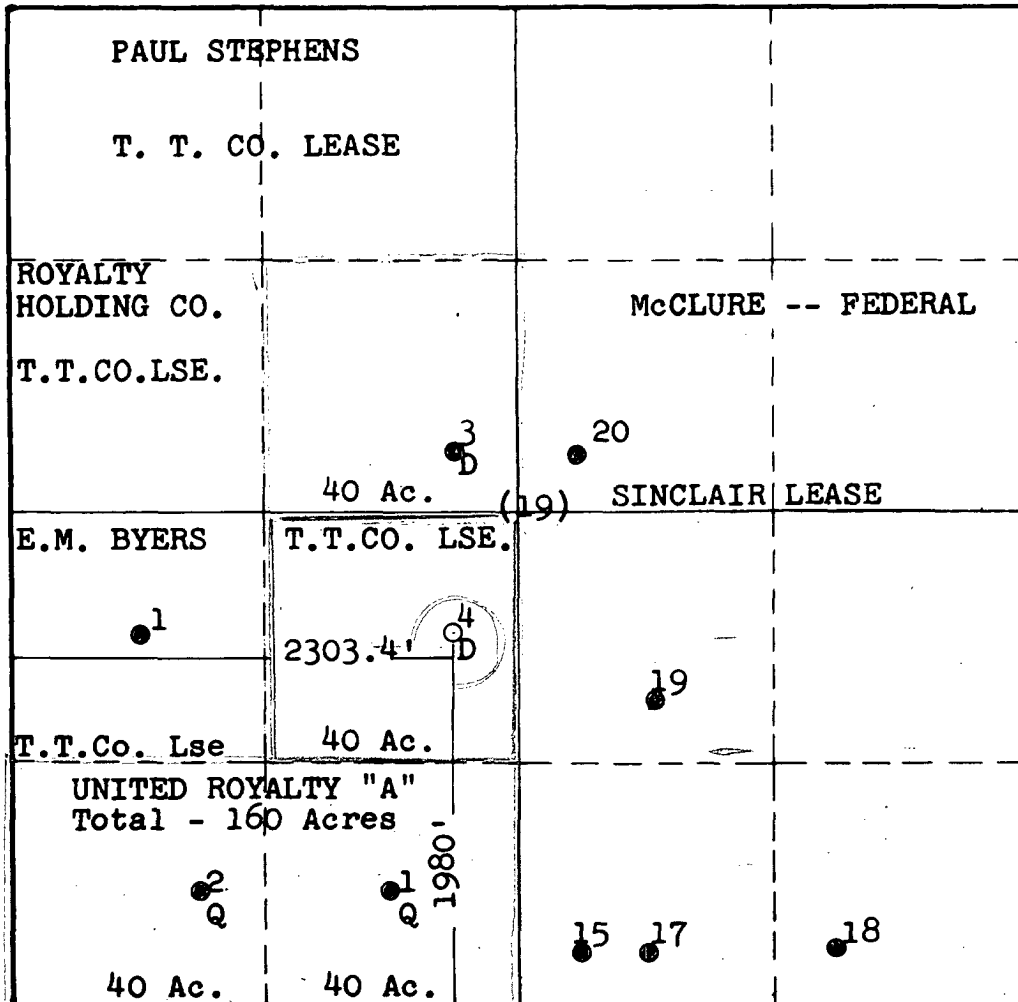

LEGEND

D- Dollarhide Drinkard  
Q- Dollarhide Queen

This is to certify that the information in Section A above is true and complete to the best of my knowledge and belief.

THE TEXAS COMPANY

J. J. Elton (Operator)  
Div. (Representative) Civil Engr  
P. O. Box 1720  
Fort Worth, Texas  
Address

This is to certify that the well location shown on the plat in Section B was plotted from field notes of actual surveys made by me or under my supervision and that the same is true and correct to the best of my knowledge and belief.

Date Surveyed 5/4/57  
J. J. Elton  
Registered Professional  
(Engineer and/or Land Surveyor.)

Certificate No. 8174