

Submit to Appropriate  
District Office  
State Lease - 6 copies  
Fee Lease - 5 copies

State of New Mexico  
Energy, Minerals and Natural Resources Department

Form C-101  
Revised 1-1-89

OIL CONSERVATION DIVISION

DISTRICT I  
P.O. Box 1980, Hobbs, NM 88240

DISTRICT II  
P.O. Drawer DD, Artesia, NM 88210

DISTRICT III  
1000 Rio Brazos Rd., Aztec, NM 87410

P.O. Box 2088

Santa Fe, New Mexico 87504-2088

API NO. (assigned by OCD on New Wells)

30-025-30291

5. Indicate Type of Lease

STATE ☐

FEE ☒

6. State Oil & Gas Lease No.

APPLICATION FOR PERMIT TO DRILL, DEEPEN, OR PLUG BACK

1a. Type of Work:

DRILL ☒

RE-ENTER ☐

DEEPEN ☐

PLUG BACK ☐

b. Type of Well:

OIL  
WELL ☐

GAS  
WELL ☐

OTHER

Water Injection

SINGLE  
ZONE ☒

MULTIPLE  
ZONE ☐

7. Lease Name or Unit Agreement Name

West Dollarhide Queen Sand  
Unit

2. Name of Operator

Sirgo Operating, Inc.

8. Well No.

129

3. Address of Operator

P.O. Box 3531, Midland, Texas 79702

9. Pool name or Wildcat

Dollarhide Queen

4. Well Location

Unit Letter M : 660 Feet From The South Line and 1090 Feet From The West Line

Section 19

Township 24S

Range 38E

NMPM

Lea

County

10. Proposed Depth

3900'

11. Formation

Queen

12. Rotary or C.T.

Rotary

13. Elevations (Show whether DF, RT, GR, etc.)

3125' GR

14. Kind & Status Plug. Bond

Cash Statewide

15. Drilling Contractor

Peterson

16. Approx. Date Work will start

January 1990

17. PROPOSED CASING AND CEMENT PROGRAM

SIZE OF HOLE	SIZE OF CASING	WEIGHT PER FOOT	SETTING DEPTH	SACKS OF CEMENT	EST. TOP
12-1/4"	8-5/8"	24#	420'	250	surface
7-7/8"	5-1/2"	15.5 & 17#	3900'	1000 sx.	surface

The Queen zone will be selectively perforated and acidized as needed for optimum water injectivity rates.

IN ABOVE SPACE DESCRIBE PROPOSED PROGRAM: IF PROPOSAL IS TO DEEPEN OR PLUG BACK, GIVE DATA ON PRESENT PRODUCTIVE ZONE AND PROPOSED NEW PRODUCTIVE ZONE. GIVE BLOWOUT PREVENTER PROGRAM, IF ANY.

I hereby certify that the information above is true and complete to the best of my knowledge and belief.

SIGNATURE Bonnie Altwater TITLE Production Technician DATE 1-10-90

TYPE OR PRINT NAME

TELEPHONE NO.

(This space for State Use)

ORIGINAL SIGNED BY JERRY SEXTON

APPROVED BY DISTRICT I SUPERVISOR

TITLE

DATE

CONDITIONS OF APPROVAL, IF ANY:

NSL-2488 & WFX-570

Permit Expires 6 Months From Approval  
Date Unless Drilling Underway.

JAN 19 1990

# MEXICO OIL CONSERVATION COMMISSION WELL LOCATION AND ACREAGE DEDICATION PLAT

Form C-102  
Supersedes C-128  
Effective 1-1-65

All distances must be from the outer boundaries of the Section.

Operator <b>Sirgo Operating, Inc.</b>			Lease <b>West Dollarhide Queen Sand Unit</b>		Well No. <b>129</b>
Unit Letter <b>M</b>	Section <b>19</b>	Township <b>24 South</b>	Range <b>38 East</b>	County <b>Lea County, N.M.</b>	
Actual Footage Location of Well: <b>1090</b> feet from the <b>West</b> line and <b>660</b> feet from the <b>South</b> line					
Ground Level Elev. <b>3125.</b>	Producing Formation <b>Queen</b>		Pool <b>Dollarhide Queen</b>		Dedicated Acreage: <b>40</b> Acres

1. Outline the acreage dedicated to the subject well by colored pencil or hachure marks on the plat below.
2. If more than one lease is dedicated to the well, outline each and identify the ownership thereof (both as to working interest and royalty).
3. If more than one lease of different ownership is dedicated to the well, have the interests of all owners been consolidated by communitization, unitization, force-pooling, etc?

☒ Yes    ☐ No    If answer is "yes," type of consolidation Unitization, R-2356

If answer is "no," list the owners and tract descriptions which have actually been consolidated. (Use reverse side of this form if necessary.) \_\_\_\_\_

No allowable will be assigned to the well until all interests have been consolidated (by communitization, unitization, forced-pooling, or otherwise) or until a non-standard unit, eliminating such interests, has been approved by the Commission.

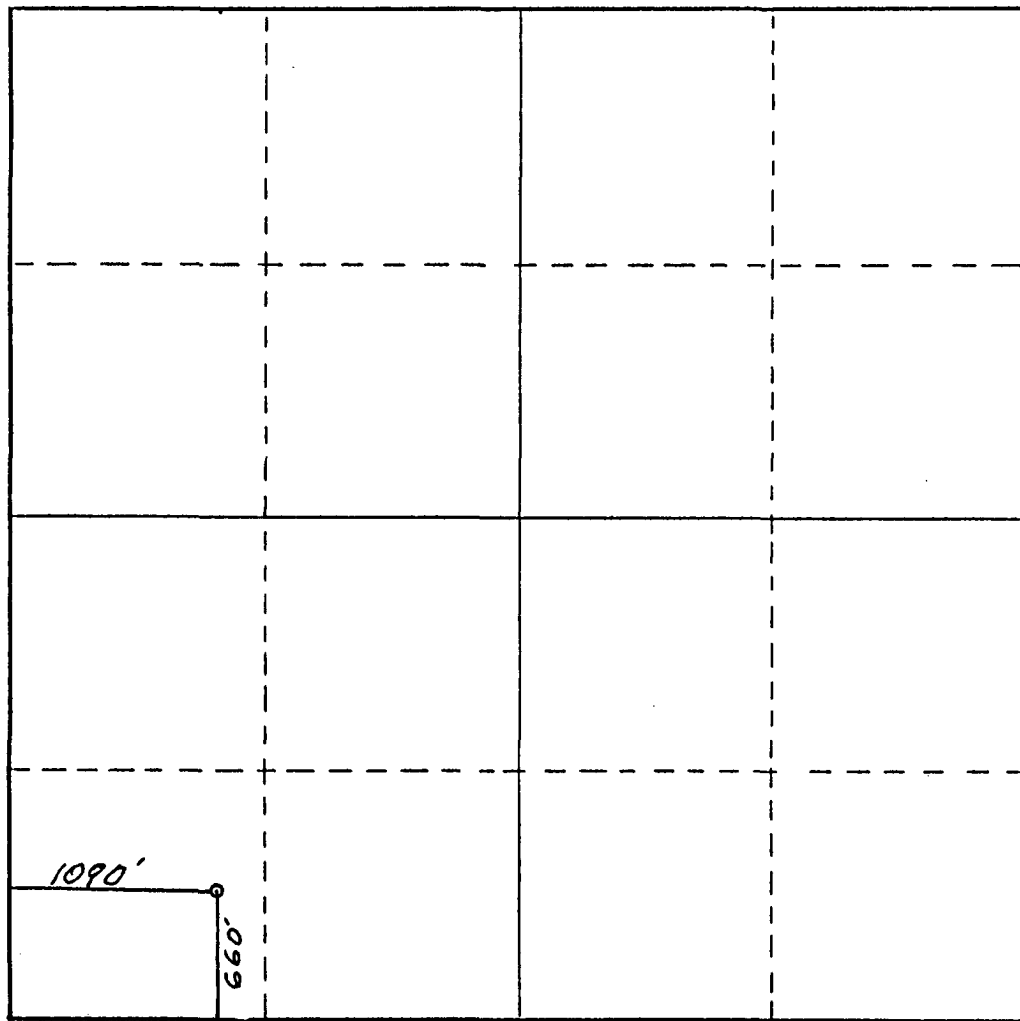

## CERTIFICATION

I hereby certify that the information contained herein is true and complete to the best of my knowledge and belief.

*Bonnie Atwater*

Name  
**Bonnie Atwater**

Position  
**Production Technician**

Company  
**Sirgo Operating, Inc.**

Date  
**1-10-90**

I hereby certify that the well location shown on this plat was plotted from field notes of actual surveys made by me or under my supervision, and that the same is true and correct to the best of my knowledge and belief.

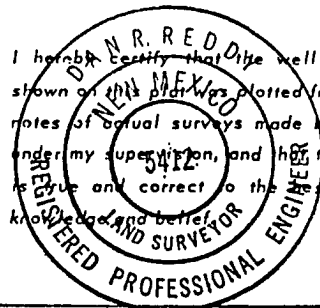

Date Surveyed

**January 13, 1988**

Registered Professional Engineer  
and/or Land Surveyor

*San R. Redd*

Certificate No.  
**NM PE&LS NO. 5412**

0 330 660 990 1320 1650 1980 2310 2640 2000 1500 1000 500 0

# BOP

