

Submit 3 Copies To Appropriate District Office  
District I  
1625 N. French Dr., Hobbs, NM 88240  
District II  
1301 W. Grand Ave., Artesia, NM 88210  
District III  
1000 Rio Brazos Rd., Aztec, NM 87410  
District IV  
1220 S. St. Francis Dr., Santa Fe, NM 87505

State of New Mexico  
Energy, Minerals and Natural Resources

Form C-103  
May 27, 2004

OIL CONSERVATION DIVISION  
1220 South St. Francis Dr.  
Santa Fe, NM 87505

|                                      |  |
|--------------------------------------|--|
| WELL API NO.                         | 30-025-36624   |
| 5. Indicate Type of Lease            | STATE <input checked="" type="checkbox"/> FEE <input type="checkbox"/> |
| 6. State Oil & Gas Lease No.         |  |
| 7. Lease Name or Unit Agreement Name | HARDY 36 STATE   |
| 8. Well Number                       | 28   |
| 9. OGRID Number                      | 217817   |
| 10. Pool name or Wildcat             | HARDY; STRAWN, NORTH   |

SUNDRY NOTICES AND REPORTS ON WELLS  
(DO NOT USE THIS FORM FOR PROPOSALS TO DRILL OR TO DEEPEN OR PLUG BACK TO A DIFFERENT RESERVOIR. USE "APPLICATION FOR PERMIT" (FORM C-101) FOR SUCH PROPOSALS.)

1. Type of Well: Oil Well ☒ Gas Well ☐ Other ☐

2. Name of Operator  
CONOCOPHILLIPS CO.

3. Address of Operator P.O. BOX 2197 WL3 6108  
HOUSTON, TX 77252

4. Well Location  
Unit Letter H : 2374 feet from the NORTH line and 511 feet from the EAST line  
Section 36 Township 20S Range 37E NMPM County LEA

11. Elevation (Show whether DR, RKB, RT, GR, etc.)  
3494 GL

Pit or Below-grade Tank Application ☐ or Closure ☐

Pit type \_\_\_\_\_ Depth to Groundwater \_\_\_\_\_ Distance from nearest fresh water well \_\_\_\_\_ Distance from nearest surface water \_\_\_\_\_

Pit Liner Thickness: \_\_\_\_\_ mil Below-Grade Tank: Volume \_\_\_\_\_ bbls; Construction Material \_\_\_\_\_

12. Check Appropriate Box to Indicate Nature of Notice, Report or Other Data

NOTICE OF INTENTION TO:

PERFORM REMEDIAL WORK ☐ PLUG AND ABANDON ☐  
TEMPORARILY ABANDON ☐ CHANGE PLANS ☐  
PULL OR ALTER CASING ☐ MULTIPLE COMPL ☐

OTHER: ☐

SUBSEQUENT REPORT OF:

REMEDIAL WORK ☐ ALTERING CASING ☐  
COMMENCE DRILLING OPNS. ☒ P AND A ☐  
CASING/CEMENT JOB ☒

OTHER: ☐

13. Describe proposed or completed operations. (Clearly state all pertinent details, and give pertinent dates, including estimated date of starting any proposed work). SEE RULE 1103. For Multiple Completions: Attach wellbore diagram of proposed completion or recompletion.

Attached is a revised wellbore schematic.

I hereby certify that the information above is true and complete to the best of my knowledge and belief. I further certify that any pit or below-grade tank has been/will be constructed or closed according to NMOCD guidelines ☐, a general permit ☐ or an (attached) alternative OCD-approved plan ☐.

SIGNATURE Deborah Marberry TITLE REGULATORY ANALYST DATE 12/03/2004

Type or print name DEBORAH MARBERRY  
For State Use Only

E-mail address: deborah.marberry@conocophillips.com Telephone No. (832)486-2326

APPROVED BY: [Signature] TITLE PETROLEUM ENGINEER DATE FEB 22 2005  
Conditions of Approval (if any):

END OF WELL SCHEMATIC

Well Name: Hardy 36 State #28  
API #: 30-025-36624

Spud Date: 2-Oct-04

Rig Release Date: 2-Nov-04  
Rig RKB (ft): 19.50

Wood Group Dry Hole Tree

11" 3M X 7-1/16" 5M TBG HEAD

11" WG22 3M x 8-5/8" SOW CSG HEAD

**Surface Casing** Date set 10/10/2004  
Size 8-5/8 in  
Set at 1343.5 ft  
Wt. 24 ppf Grade J-55  
Hole Size 12 1/4 in  
Wash Out 100 %  
Est. T.O.C. Surface ft

☒ New  
☐ Used

Csg Shoe @ 1344 ft

**Cement** Date cmt'd: 10/10/2004  
Lead : 575 sks 35:65 Poz:C +5% D44+6%D;  
+1/4ppsD29+.2%D46+2%S1 @12.4 ppg  
Tail : 320 sks C+1/4ppsD29+.2%D46+2%S  
@14.8 ppg  
Note : 204 sks cmt returns

Shoe Test: N/A EMW  
W.O.C. for 42 hrs (plug bump to drlg cmt)

**Production Casing** Date set 10/31/2004  
Size 5-1/2 in  
Wt. 15.5 ppf Grade J-55  
PBTD 8016 ft (top of Float Collar)  
Hole Size 7-7/8 in Wash Out:      %  
T.O.C. Surface ft  
Marker Jt. Top 6957 ft Length: 19.00 ft  
Marker Jt. Top 6976 ft Length: 19.00 ft  
DV Tool 3900 ft

☒ New  
☐ Used

Csg Shoe @ 8062 ft

**Cement** Date cmt'd: 11/1/2004  
Stg 1 Lead : 805 sks 50:50 Poz:H+5%D44+2%D2  
+5ppsD42+.2%D167+.25%D65+1/4ppsD29  
+.2%D46 @ 13.2 ppg  
Stg 1 Tail : N/A

Note :       
Displacement Fluid: Water/Mud

Stg 2 Lead : 1590 sks 35:65 Poz:C+5%D44+6%D;  
+1/4ppsD29+.3%B159 @ 12.4 ppg  
Stg 2 Tail : 100 sks C Neat @ 14.8 ppg

Note : 209 sks cmt returns  
Displacement Fluid: Water

Mud Wt. = 10 ppg @ TD

BHL VS=628 ft  
/S Ref: 0N,0E,41.88Az Kick-off Pt 5712 ft  
Max Angle 17.8 deg @ 7214 ft MD

TD @ 8,072 ft MD 8,001 ft TVD

CENTRALIZER LOCATION:

|             |   |        |           |
|-------------|---|--------|-----------|
| Surface:    | <u>1/SJ, 1/3JTS T/Surface</u>                         | Total: | <u>10</u> |
| Production: | <u>1/2JTS F/8026' T/7226', 1/4JTS F/7049' T/1334'</u> | Total: | <u>44</u> |
| Notes:      | <u>CMT BASKET ABOVE AND BELOW DV TOOL</u>             |        |           |

**PROPOSED HARDY 36 STATE #28 PLAT  
NORTH HARDY STRAWN POOL**

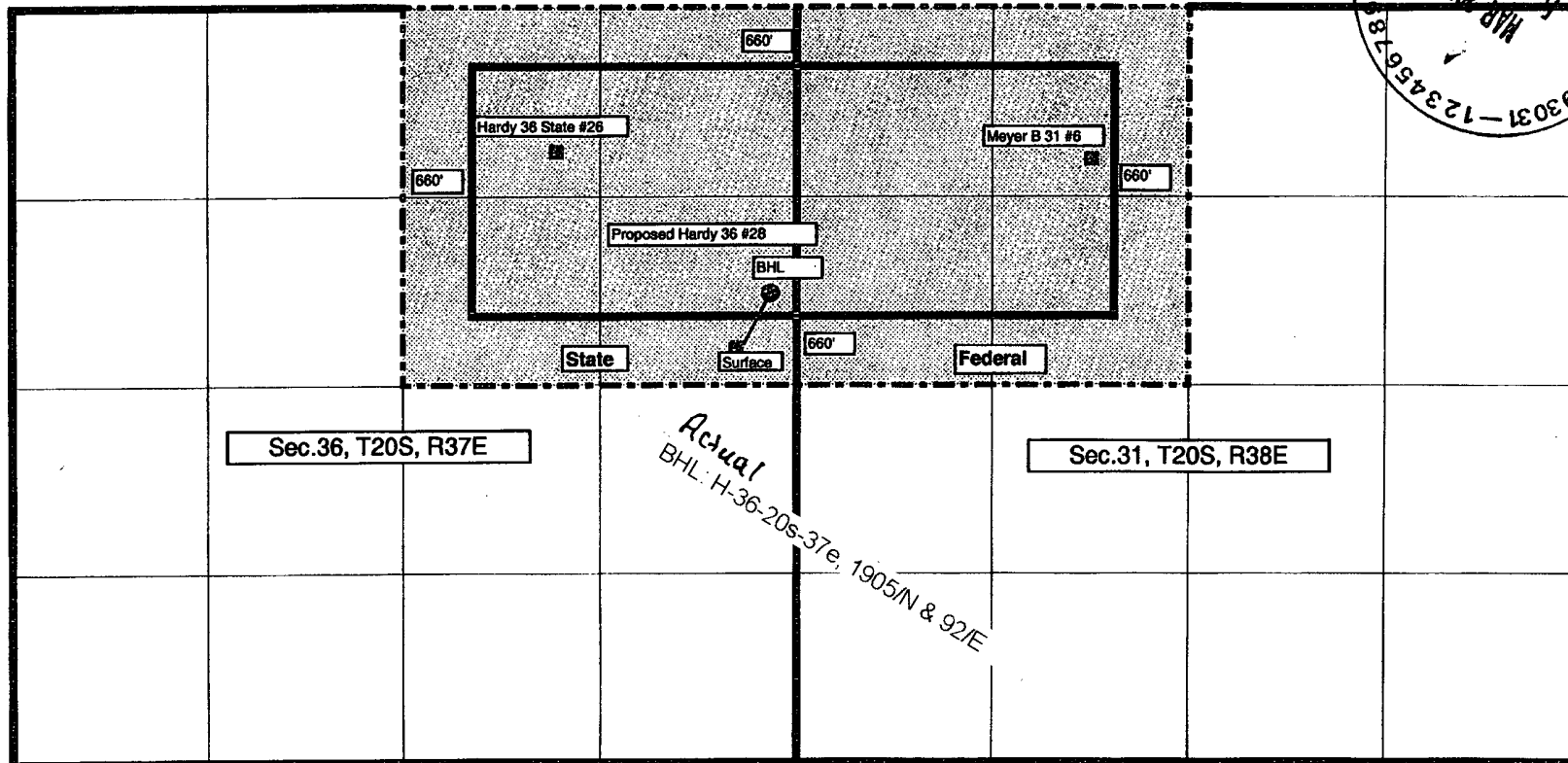
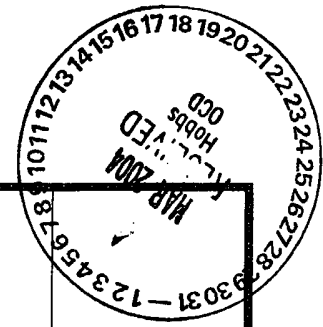

Hardy 36 State #28 proposed Surface Location at 2374' FNL & 511' FEL & Bottomhole Location at 1950' FNL & 175' FEL  
 We are proposing the green area to be the project area for the Hardy 36 State #28 directional well.  
 Interior to red outline designates legal location for proposed well.  
 \* Well placements are approximate.