

## District I

1625 N. French Dr., Hobbs, NM 88240

## District II

1301 W. Grand Avenue, Artesia, NM 88210

## District III

1000 Rio Brazos Road, Aztec, NM 87410

## District IV

1220 S. St. Francis Dr., Santa Fe, NM 87505

State of New Mexico  
Energy Minerals and Natural Resources

Form C-101

May 27, 2004

Oil Conservation Division  
1220 South St. Francis Dr.  
Santa Fe, NM 87505

Submit to appropriate District Office

☐ AMENDED REPORT

## APPLICATION FOR PERMIT TO DRILL, RE-ENTER, DEEPEN, PLUGBACK, OR ADD A ZONE

Operator Name and Address CHEVRON U.S.A. INC. 15 SMITH ROAD, MIDLAND, TX 79705		OGRID Number 4323 ✓
Property Code 2683 ✓	Property Name H.T. MATTERN "C"	API Number 30-025-37108
Proposed Pool 1 PENROSE SKELLY GRAYBURG ✓ 50350		Proposed Pool 2
		Well No. 17 ✓

## 7 Surface Location

UL or lot no.	Section	Township	Range	Lot Idn	Feet from the 1980'	North/South line	Feet from the 1980'	East/West line	County
F	18	21-S	37-E			NORTH		WEST	LEA

## 8 Proposed Bottom Hole Location If Different From Surface

UL or lot no.	Section	Township	Range	Lot Idn	Feet from the	North/South line	Feet from the	East/West line	County

## Additional Well Information

Work Type Code N	Well Type Code O	Cable/Rotary ROTARY	Lease Type Code P	Ground Level Elevation 3498'
Multiple N	Proposed Depth 4350'	Formation GRAYBURG	Contractor	Spud Date 4-24-05
Depth to Groundwater		Distance from nearest fresh water well		Distance from nearest surface water
Pit: Liner: Synthetic <input type="checkbox"/> mils thick Clay <input type="checkbox"/> Pit Volume: _____ bbls Drilling Method: _____ Closed-Loop System <input type="checkbox"/> SEE C-144 Fresh Water <input type="checkbox"/> Brine <input type="checkbox"/> Diesel/Oil-based <input type="checkbox"/> Gas/Air				

## 21 Proposed Casing and Cement Program

Hole Size	Casing Size	Casing weight/foot	Setting Depth	Sacks of Cement	Estimated TOC
11"	8 5/8"	24#	400'	250 SX	CIRCULATE
7 7/8"	5 1/2"	15.5#	4350'	1000 SX	CIRCULATE

22 Describe the proposed program. If this application is to DEEPEN or PLUG BACK, give the data on the present productive zone and proposed new productive zone. Describe the blowout prevention program, if any. Use additional sheets if necessary.

SURFACE CASING: 250 SX CL C CMT W/2% CACL + 0.25 PPS CELLOFLAKE (J-55 SLURRY)  
 SLURRY PROPERTIES: 14.8 PPG, 1.34 FT3/SK, 6.29 GPS MIX WATER  
 PRODUCTION CASING: LEAD IN W/600 SX (35:65) POZ (FLY ASH) CLASS C CMT W/6% BENTONITE + 5% SODIUM CHLORIDE + 0.25 PPS CELLOFLAKE + 0.4% FLUID LOSS ADDITIVE  
 TAIL IN W/400 SX (50:50) POZ (FLY ASH) CLASS C CMT W/5% SODIUM CHLORIDE + 2% BENTONITE + 0.25 PPS CELLOFLAKE  
 SLURRY PROPERTIES: 12.4 PPG, 2.15 FT3/SK, 11.97 GPS MIX WATER & 14.2 PPG, 1.35 FT3/SX, 6.33 PGS MIX WATER  
 BOP PROGRAM: SEE ATTACHED DIAGRAM

Permit Expires 1 Year From Approval  
Date Unless Drilling Underway

23 I hereby certify that the information given above is true and complete to the best of my knowledge and belief. I further certify that the drilling pit will be constructed according to NMOCD guidelines ☒, a general permit ☐, or an (attached) alternative OCD-approved plan ☐.

## OIL CONSERVATION DIVISION

Approved by:

Title:

PETROLEUM ENGINEER

Approval Date:

MAR 02 2005

Expiration Date:

Printed name: DENISE PINKERTON

Title: REGULATORY SPECIALIST

E-mail Address: LEAKEJD@CHEVRONTXACO.COM

Date: 2-28-2005

Phone: 432-687-7375

Conditions of Approval Attached ☐

BOP

CAPSTAR #12

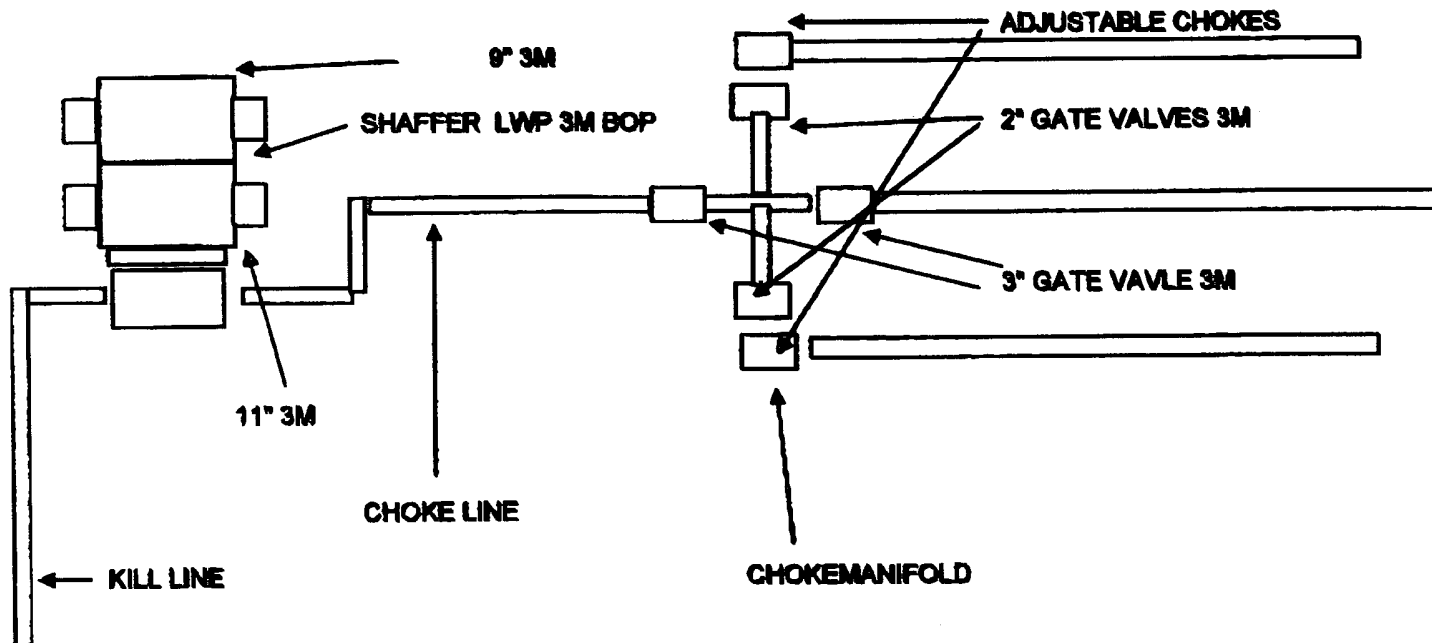

**SECTION 18, TOWNSHIP 21 SOUTH, RANGE 37 EAST, N.M.P.M.,**  
 LEA COUNTY, NEW MEXICO

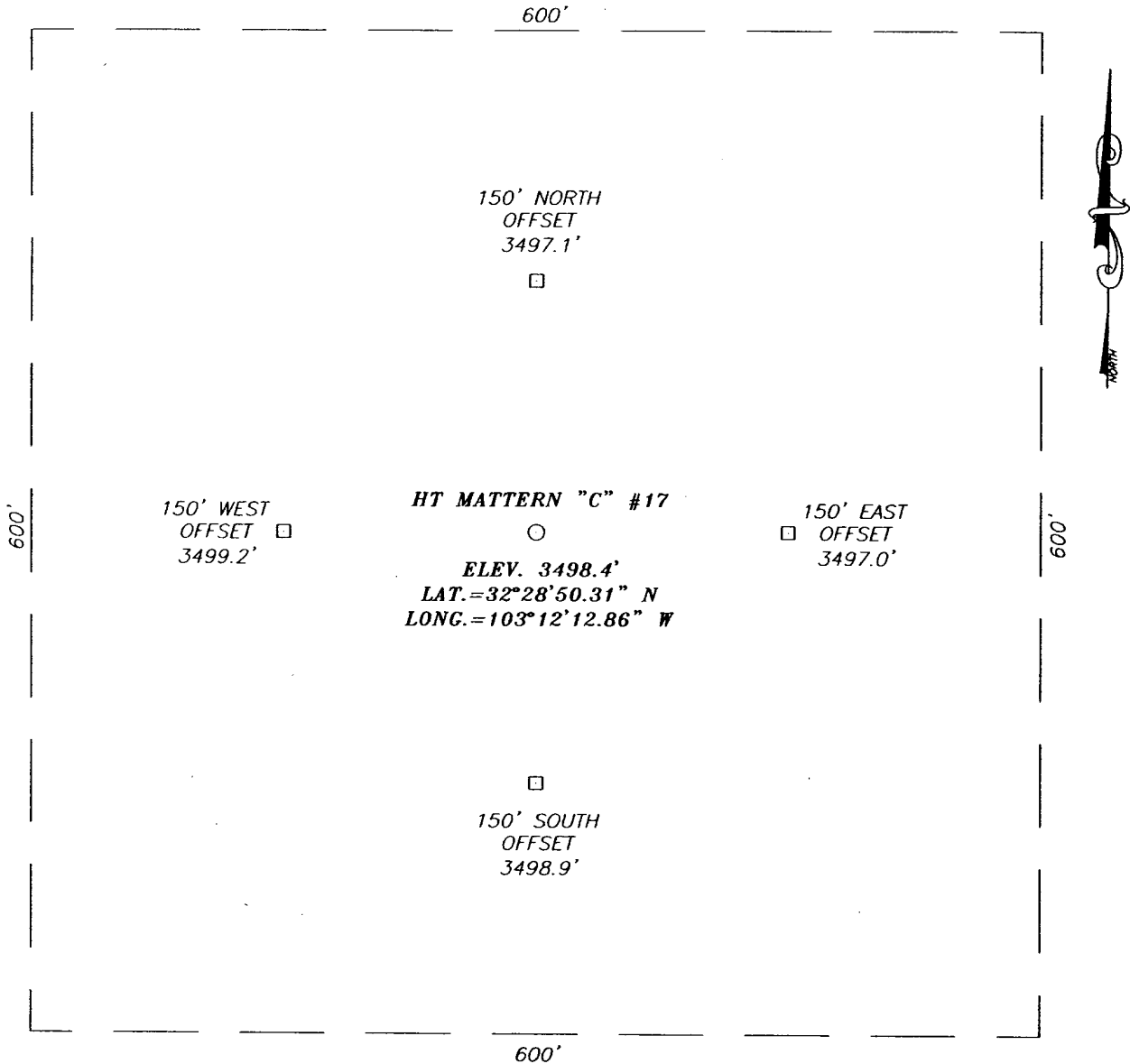

**DIRECTIONS TO LOCATION**

FROM THE INTERSECTION OF ST. HWY. #8 AND CO. RD. #33 (N. TURNER RD.) GO NORTH ON CO. RD. #33 FOR APPROX. 2.0 MILES. TURN LEFT (WEST) AND GO APPROX. 1.0 MILE. TURN RIGHT (NORTH) AND GO APPROX. 0.1 MILES TO A "Y" IN THE ROAD. TURN RIGHT (NORTH) AND GO APPROX. 0.3 MILES. FOLLOW ROAD TO THE LEFT (WEST) AND GO APPROX. 0.4 MILES. PROPOSED LOCATION IS APPROX. 1000' WEST OF THIS POINT.

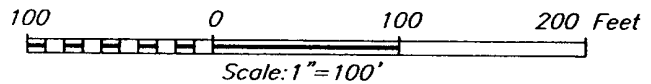

**CHEVRON U.S.A., INC.**

HT MATTERN "C" #17 WELL  
 LOCATED 1980 FEET FROM THE NORTH LINE  
 AND 1980 FEET FROM THE WEST LINE OF SECTION 18,  
 TOWNSHIP 21 SOUTH, RANGE 37 EAST, N.M.P.M.,  
 LEA COUNTY, NEW MEXICO.

Survey Date: 1/11/05	Sheet 1 of 1 Sheets
W.O. Number: 04.11.1724	Dr By: J.R.
Date: 1/13/05	Disk: CD#5
04111724	Scale: 1"=100'

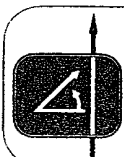

PROVIDING SURVEYING SERVICES  
 SINCE 1946  
**JOHN WEST SURVEYING COMPANY**  
 412 N. DAL PASO  
 HOBBS, N.M. 88240  
 (505) 393-3117

## VICINITY MAP



SCALE: 1" = 2 MILES

SEC. 18 TWP. 21-S RGE. 37-E

SURVEY N.M.P.M.

COUNTY \_\_\_\_\_ LEA \_\_\_\_\_

DESCRIPTION 1980' FNL & 1980' FWL

ELEVATION 3498'

OPERATOR CHEVRON U.S.A., INC.

LEASE HT MATERN "C"

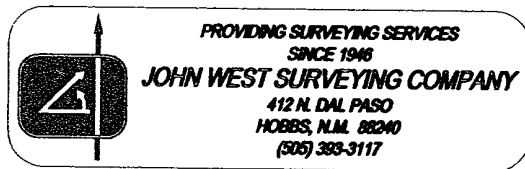

# LOCATION VERIFICATION MAP

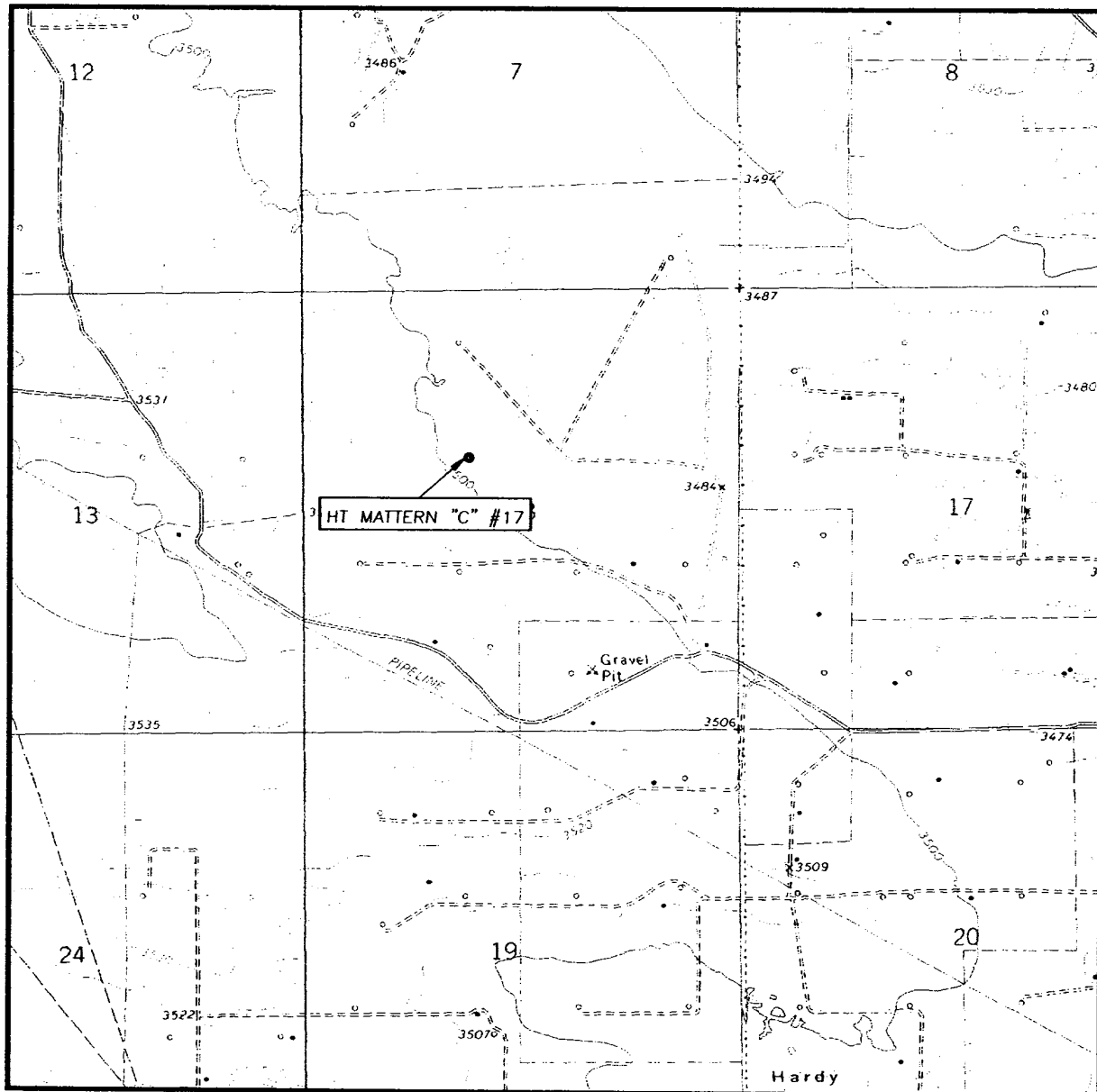

SCALE: 1" = 2000'

CONTOUR INTERVAL:  
EUNICE, N.M. - 10'

SEC. 18 TWP. 21-S RGE. 37-E

SURVEY N.M.P.M.

COUNTY LEA

DESCRIPTION 1980' FNL & 1980' FWL

ELEVATION 3498'

OPERATOR CHEVRON U.S.A., INC.

LEASE HT MATTERN "C"

U.S.G.S. TOPOGRAPHIC MAP  
EUNICE, N.M.

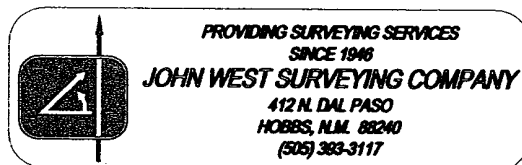

## DISTRICT I

1625 N. FRENCH DR., HOBBS, NM 88240

## DISTRICT II

1301 W. GRAND AVENUE, ARTESIA, NM 88210

## DISTRICT III

1000 Rio Brazos Rd., Aztec, NM 87410

## DISTRICT IV

1220 S. ST. FRANCIS DR., SANTA FE, NM 87505

## State of New Mexico

Energy, Minerals and Natural Resources Department

## OIL CONSERVATION DIVISION

1220 SOUTH ST. FRANCIS DR.

Santa Fe, New Mexico 87505

Form C-102

Revised JUNE 10, 2003

Submit to Appropriate District Office

State Lease - 4 Copies

Fee Lease - 3 Copies

## WELL LOCATION AND ACREAGE DEDICATION PLAT

☐ AMENDED REPORT

API Number <b>30-025-37108</b>	Pool Code <b>50350</b>	Pool Name <b>Penrose Skelly Grayburg</b>
Property Code <b>2683</b>	Property Name <b>HT MATTERN "C"</b>	Well Number <b>17</b>
OGRI No. <b>4323</b>	Operator Name <b>CHEVRON U.S.A., INC.</b>	Elevation <b>3498'</b>

## Surface Location

UL or lot No.	Section	Township	Range	Lot Idn	Feet from the	North/South line	Feet from the	East/West line	County
F	18	21-S	37-E		1980	NORTH	1980	WEST	LEA

## Bottom Hole Location If Different From Surface

UL or lot No.	Section	Township	Range	Lot Idn	Feet from the	North/South line	Feet from the	East/West line	County

Dedicated Acres <b>40</b>	Joint or Infill	Consolidation Code	Order No.
------------------------------	-----------------	--------------------	-----------

NO ALLOWABLE WILL BE ASSIGNED TO THIS COMPLETION UNTIL ALL INTERESTS HAVE BEEN CONSOLIDATED  
OR A NON-STANDARD UNIT HAS BEEN APPROVED BY THE DIVISION

<p>LOT 1</p> <p>36.71 AC LOT 2</p> <p>36.74 AC LOT 3</p> <p>36.76 AC LOT 4</p> <p>36.79 AC</p> <p>1980'</p> <p>1980'</p> <p>GEODETIC COORDINATES NAD 27 NME</p> <p>Y=540415.2 N X=848390.1 E</p> <p>LAT.=32°28'50.31" N LONG.=103°12'12.86" W</p>	<p><b>OPERATOR CERTIFICATION</b></p> <p>I hereby certify the the information contained herein is true and complete to the best of my knowledge and belief.</p> <p><i>Denise Pinkerton</i> Signature <b>Denise Pinkerton</b> Printed Name <b>Regulatory Specialist</b> Title <b>2-28-05</b> Date</p> <p><b>SURVEYOR CERTIFICATION</b></p> <p>I hereby certify that the well location shown on this plat was plotted from field notes of actual surveys made by me or under my supervision, and that the same is true and correct to the best of my belief.</p> <p>JANUARY 12, 2005</p> <p>Date Surveyed JR</p> <p>Signature &amp; Seal of Professional Surveyor <i>GARY G. EIDSON</i> 1/17/05</p> <p>Certificate No. <b>GARY EIDSON</b> 12641</p>
---	--

District I  
1625 N. French Dr., Hobbs, NM 88240  
District II  
1301 W. Grand Avenue, Artesia, NM 88210  
District III  
1000 Rio Brazos Road, Aztec, NM 87410  
District IV  
1220 S. St. Francis Dr., Santa Fe, NM 87505

State of New Mexico  
Energy Minerals and Natural Resources

Form C-144  
June 1, 2004

Oil Conservation Division  
1220 South St. Francis Dr.  
Santa Fe, NM 87505

For drilling and production facilities, submit to appropriate NMOCD District Office.  
For downstream facilities, submit to Santa Fe office

**Pit or Below-Grade Tank Registration or Closure**

Is pit or below-grade tank covered by a "general plan"? Yes ☐ No ☒

Type of action: Registration of a pit or below-grade tank ☒ Closure of a pit or below-grade tank ☐

Operator: CHEVRON U.S.A. INC Telephone: 432-687-7375 e-mail address: LEAKEJD@CHEVRONTXACO.COM

Address: 15 SMITH ROAD, MIDLAND, TEXAS 79705 30.025-37108

Facility or well name: H. T. MATTERN "C" #17 API #: NEW U/L or Qtr/Qtr F Sec 18 T 21-S R 37-E

County: LEA Latitude 32 28'50.31" N Longitude 103 12'12.86" W NAD: 1927 ☐ 1983 ☐

Surface Owner: Private

**Pit**

Type: Drilling

Lined

Liner type: Synthetic ☒ Thickness 20 mil

Pit Volume 4106 bbl

**Below-grade tank**

Volume: \_\_\_\_\_ bbl Type of fluid: \_\_\_\_\_

Construction material: \_\_\_\_\_

Double-walled, with leak detection? Yes ☐ If not, explain why not. \_\_\_\_\_

Depth to ground water (vertical distance from bottom of pit to seasonal high water elevation of ground water.)	Less than 50 feet	(20 points)
	50 feet or more, but less than 100 feet	(10 points)
	100 feet or more	( 0 points)
Wellhead protection area: (Less than 200 feet from a private domestic water source, or less than 1000 feet from all other water sources.)	Yes	(20 points)
	No	( 0 points)
Distance to surface water: (horizontal distance to all wetlands, playas, irrigation canals, ditches, and perennial and ephemeral watercourses.)	Less than 200 feet	(20 points)
	200 feet or more, but less than 1000 feet	(10 points)
	1000 feet or more	( 0 points)
Ranking Score (Total Points)		10

**If this is a pit closure:** (1) Attach a diagram of the facility showing the pit's relationship to other equipment and tanks. (2) Indicate disposal location: (check the onsite box if you are burying in place) onsite ☐ offsite ☐ If offsite, name of facility \_\_\_\_\_. (3) Attach a general description of remedial action taken including remediation start date and end date. (4) Groundwater encountered: No ☐ Yes ☐ If yes, show depth below ground surface \_\_\_\_\_ ft. and attach sample results.

(5) Attach soil sample results and a diagram of sample locations and excavations.

Additional Comments:

I hereby certify that the information above is true and complete to the best of my knowledge and belief. I further certify that the above-described pit or below-grade tank has been/will be constructed or closed according to NMOCD guidelines ☒, a general permit ☐, or an (attached) alternative OCD-approved plan ☐.

Date: 2-28-2005

Printed Name/Title MARK GARZA

Signature

Drilling Engineer

Your certification and NMOCD approval of this application/closure does not relieve the operator of liability should the contents of the pit or tank contaminate ground water or otherwise endanger public health or the environment. Nor does it relieve the operator of its responsibility for compliance with any other federal, state, or local laws and/or regulations.

Approval:

Printed Name/Title

Signature

Date:

PETROLEUM ENGINEER

MAR 02 2005

# CapStar #16 Pit Design

