

District I
1625 N. French Dr., Hobbs, NM 88240
District II
1301 W. Grand Avenue, Artesia, NM 88210
District III
1000 Rio Brazos Road, Aztec, NM 87410
District IV
1220 S. St. Francis Dr., Santa Fe, NM 87505

State of New Mexico
Energy Minerals and Natural Resources

Oil Conservation Division
1220 South St. Francis Dr.
Santa Fe, NM 87505

Form C-144
June 1, 2004

For drilling and production facilities, submit to appropriate NMOCD District Office.
For downstream facilities, submit to Santa Fe office

Pit or Below-Grade Tank Registration or Closure

Is pit or below-grade tank covered by a "general plan"? Yes ☒ No ☐

Type of action: Registration of a pit or below-grade tank ☐ Closure of a pit or below-grade tank ☒

Operator: Yates Petroleum Company Telephone: 505-748-4500 e-mail address: mikes@ypc.com
Address: 105 South 4th Street, Artesia, N.M. 88210
Facility or well name: Royal BAC #1 API #: 30-025-01817 U/L or Qtr/Qtr: I Sec: 24 T: 10S R: 34E
County: Lea Latitude: 33.43075 Longitude: 103.41031 NAD: 1927 ☐ 1983 ☒
Surface Owner: Federal ☐ State ☒ Private ☐ Indian ☐

Pit	Below-grade tank
Type: Drilling <input checked="" type="checkbox"/> Production <input type="checkbox"/> Disposal <input type="checkbox"/> Work over <input type="checkbox"/> Emergency <input type="checkbox"/> Lined <input checked="" type="checkbox"/> Unlined <input type="checkbox"/> Liner type: Synthetic <input checked="" type="checkbox"/> Thickness: <u>12</u> mil Clay <input type="checkbox"/> Pit Volume: <u>12,000</u> bbl	Volume: _____ bbl Type of fluid: _____ Construction material: _____ Double-walled, with leak detection? Yes <input type="checkbox"/> If not, explain why not: _____
Depth to ground water (vertical distance from bottom of pit to seasonal high water elevation of ground water.)	Less than 50 feet (20 points) 50 feet or more, but less than 100 feet (10 points) XXXX 100 feet or more (0 points)
Wellhead protection area: (Less than 200 feet from a private domestic water source, or less than 1000 feet from all other water sources.)	Yes (20 points) No (0 points) XXXX
Distance to surface water: (horizontal distance to all wetlands, playas, irrigation canals, ditches, and perennial and ephemeral watercourses.)	Less than 200 feet (20 points) 200 feet or more, but less than 1000 feet (10 points) 1000 feet or more (0 points) XXXX
	Ranking Score (Total Points) 10 POINTS

If this is a pit closure: (1) Attach a diagram of the facility showing the pit's relationship to other equipment and tanks. (2) Indicate disposal location: (check the onsite box if you are burying in place) onsite ☒ offsite ☐ If offsite, name of facility: NA (3) Attach a general description of remedial action taken including remediation start date and end date.
(4) Groundwater encountered: No ☐ Yes ☐ If yes, show depth below ground surface _____ ft. and attach sample results VED
(5) Attach soil sample results and a diagram of sample locations and excavations.

Additional Comments: Registration for encapsulation trench. The drilling pit contents will be mixed to stiffen the pit contents. Encapsulation trench will be excavated and lined with a 12 mil. Synthetic liner on former drilling pit site. Drilling pit contents will then be emplaced into the encapsulation trench. A 20 mil. Synthetic liner will then be placed over the pit contents with a min. of a 3' over lap of the underlying trench areas. The encapsulation trenches will then be backfilled back to grade using a min. of 3' of clean soil and like material. A one call & 48 hour notice will be provided to the Oil Conservation Division before pit closure actions begin.

Pit Closure actions to begin by NA. Ending date NA

X Pre April 15th 2004 drilling pit

I hereby certify that the information above is true and complete to the best of my knowledge and belief. I further certify that the above-described pit or below-grade tank has been/will be constructed or closed according to NMOCD guidelines ☐, a general permit ☒, or an (attached) alternative OCD-approved plan ☐.

Date: 03/09/2005

Printed Name/Title: DAVID L. REGAN Signature: [Signature]

Your certification and NMOCD approval of this application/closure does not relieve the operator of responsibility should the contents of the pit or tank contaminate ground water or otherwise endanger public health or the environment. Nor does it relieve the operator of its responsibility for compliance with any other federal, state, or local laws and/or regulations.

Approval:

Printed Name/Title: GARY W. WINK/STAFF MGR Signature: [Signature] Date: 3/21/05

UNITED STATES
DEPARTMENT OF THE INTERIOR
GEOLOGICAL SURVEY

JOHNSON RANCH QUADRANGLE
NEW MEXICO-LEA CO.
7.5 MINUTE SERIES (TOPOGRAPHIC)

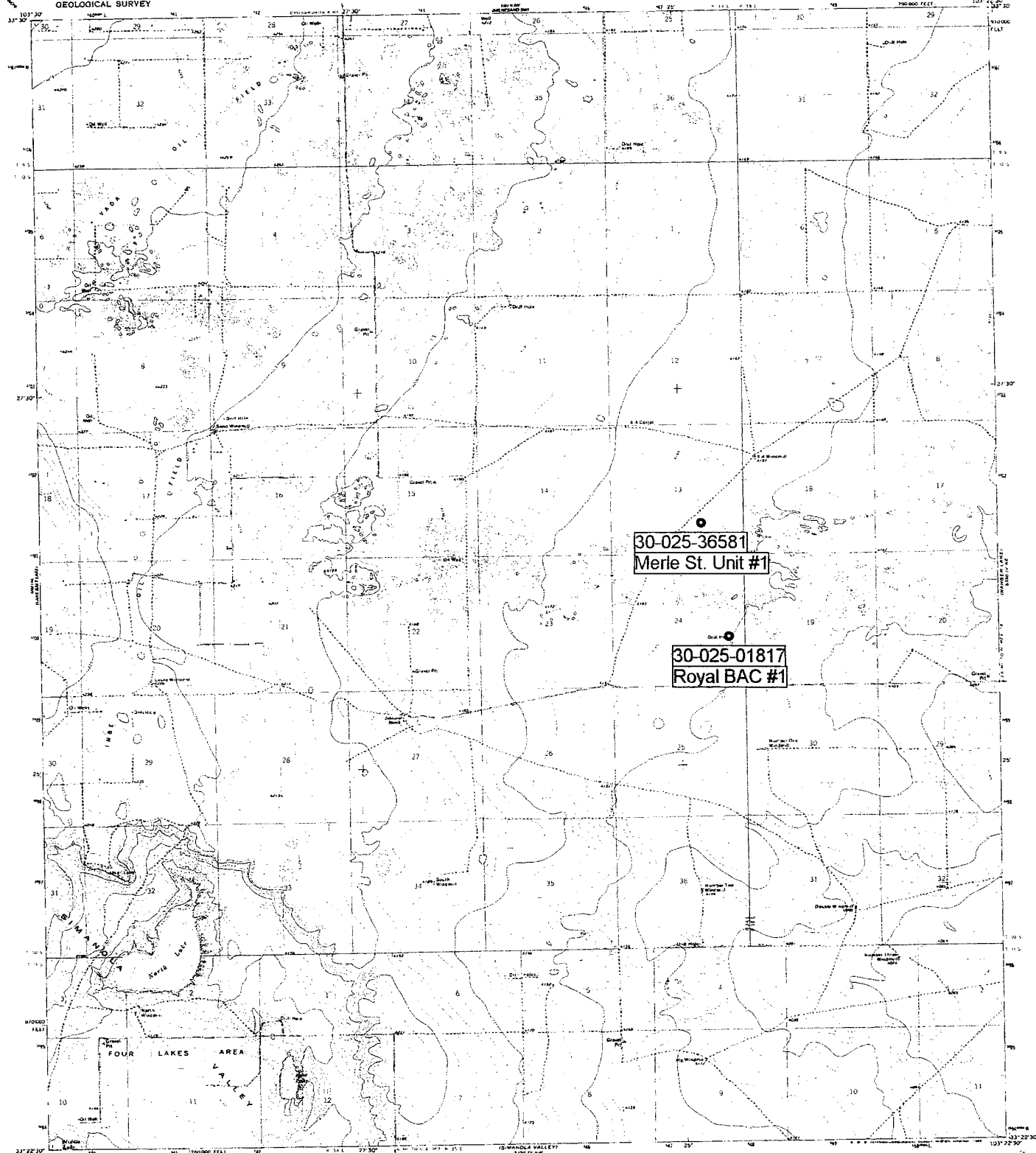

Mapped, edited, and published by the Geological Survey
Control by USGS and NOS/NOAA

Photomaps by photogrammetric methods from aerial photographs
taken 1954. Topography by aneroid surveys 1970.
Polyconic projection. 10,000-foot grid ticks based on New Mexico
coordinate system, east zone
1927 North American Datum
To place on the projected North American Datum 1983
raise the projection lines 7 meters south and
48 meters east as shown by dashed corner ticks.
Five red dashed lines indicate selected fence lines.

Revisions shown in parentheses and in italics. They are shown as
photomaps (1954) and as topographic maps (1970). The information
shown in parentheses is not shown on the map.

SCALE: 24,000
CONTOUR INTERVAL: 5 FEET
NATIONAL GEODETIC VERTICAL DATUM OF 1929

FOR SALE BY U.S. GEOLOGICAL SURVEY, DENVER, COLORADO 80225, OR RESTON, VIRGINIA 22092
A FOLDER DESCRIBING TOPOGRAPHIC MAPS AND SYMBOLS IS AVAILABLE ON REQUEST

ROAD CLASSIFICATION
Light duty road, all weather: ———
Improved road, dry or dry weather: ———
Improved road, wet weather: ———

JOHNSON RANCH, N. MEX.
33-05-04-TE-024

1970
PHOTOGRAPHICALLY CORRECTED
DATA 1980 BY NW-34000-1981

USGS SEO TWN 09S-15S CHAVES LEA GW

30-025-01817 Royal BAC #1

COUNTY	SOURCE	USGS SITE NUM.	QTY	SITE LOCATION	DATE	LEVEL
LEA	SEO		1	10S.34E.27.14210	1976-05-04	54.92
LEA	SEO		1	10S.34E.27.14222	1991-01-25	50.78