

District I
1625 N. French Dr., Hobbs, NM 88240
District II
1301 W. Grand Avenue, Artesia, NM 88210
District III
1000 Rio Brazos Road, Aztec, NM 87410
District IV
1220 S. St. Francis Dr., Santa Fe, NM 87505

State of New Mexico
Energy Minerals and Natural
Resources

Oil Conservation Division
1220 South St. Francis Dr.
Santa Fe, NM 87505

Form C-144
June 1, 2004

For drilling and production facilities, submit
to appropriate NMOCD District Office.
For downstream facilities, submit to Santa Fe
office

Pit or Below-Grade Tank Registration or Closure

Is pit or below-grade tank covered by a "general plan"? Yes X No ☐

Type of action: Registration of a pit or below-grade tank ☐ Closure of a pit or below-grade tank X

Operator: Yates Petroleum Company Telephone: 505-748-4500 e-mail address: mikes@ypc.com

Address: 105 South 4th Street, Artesia, NM 88210

Facility or well name: Dempster BBP #1 API #: 30-025-36077 U/L or Qtr/Qtr N Sec 30 T 11S R 36E

County: Lea Latitude 33.33125 Longitude 103.34517 NAD: 1927 ☐ 1983 X

Surface Owner: Federal State X Private Indian ☐

Pit

Type: Drilling X Production ☐ Disposal ☐

Work over ☐ Emergency ☐

Lined X Unlined ☐

Liner type: Synthetic ☐ Thickness 12 mil Clay ☐

Pit Volume 12,000 bbl

Below-grade tank

Volume: _____ bbl Type of fluid: _____

Construction material: _____

Double-walled, with leak detection? Yes ☐ If not, explain why not.

Depth to ground water (vertical distance from bottom of pit to seasonal high water elevation of ground water.)

Less than 50 feet

50 feet or more, but less than 100 feet

100 feet or more

(20 points) XXXX

(10 points)

(0 points)

Wellhead protection area: (Less than 200 feet from a private domestic water source, or less than 1000 feet from all other water sources.)

Yes

No

(20 points)

(0 points) XXXX

Distance to surface water: (horizontal distance to all wetlands, playas, irrigation canals, ditches, and perennial and ephemeral watercourses.)

Less than 200 feet

200 feet or more, but less than 1000 feet

1000 feet or more

(20 points)

(10 points)

(0 points) XXXX

Ranking Score (Total Points)

20 Points

If this is a pit closure: (1) Attach a diagram of the facility showing the pit's relationship to other equipment and tanks. (2) Indicate disposal location: (check the onsite box if you are burying in place) onsite ☐ offsite X If offsite, name of facility: N/A (3) Attach a general description of remedial action taken including remediation start date and end date. (4) Groundwater encountered: No ☐ Yes ☐ If yes, show depth below ground surface _____ ft. and attach sample results. (5) Attach soil sample results and a diagram of sample locations and excavations.

Additional Comments: Closure work plan for drilling pit. The drilling pit contents will be excavated and hauled to an OCD approved soil waste facility.

The excavated area will then be backfilled to grade using a minimum of 3' of clean soil and like material. A one call and a 48 hour notice will be provided to the Oil Conservation Division.

Pit Closure start date: N/A. Final closure date: N/A.

Pre April 15th 2004 Drilling Pit

I hereby certify that the information above is true and complete to the best of my knowledge and belief. I further certify that the above-described pit or below-grade tank has been/will be constructed or closed according to NMOCD guidelines ☐, a general permit X, or an (attached) alternative OCD approved plan ☐.

Date: 03/10/2005

Printed Name/Title DON DOLAN REP AGENT

Signature [Signature]

Your certification and NMOCD approval of this application/closure does not relieve the operator of liability should the contents of the pit or tank contaminate ground water or otherwise endanger public health or the environment. Nor does it relieve the operator of its responsibility for compliance with any other federal, state, or local laws and/or regulations.

Approval:

Printed Name/Title GARY W. WINK / STAFF MGR

Signature [Signature]

Date: 3/21/05

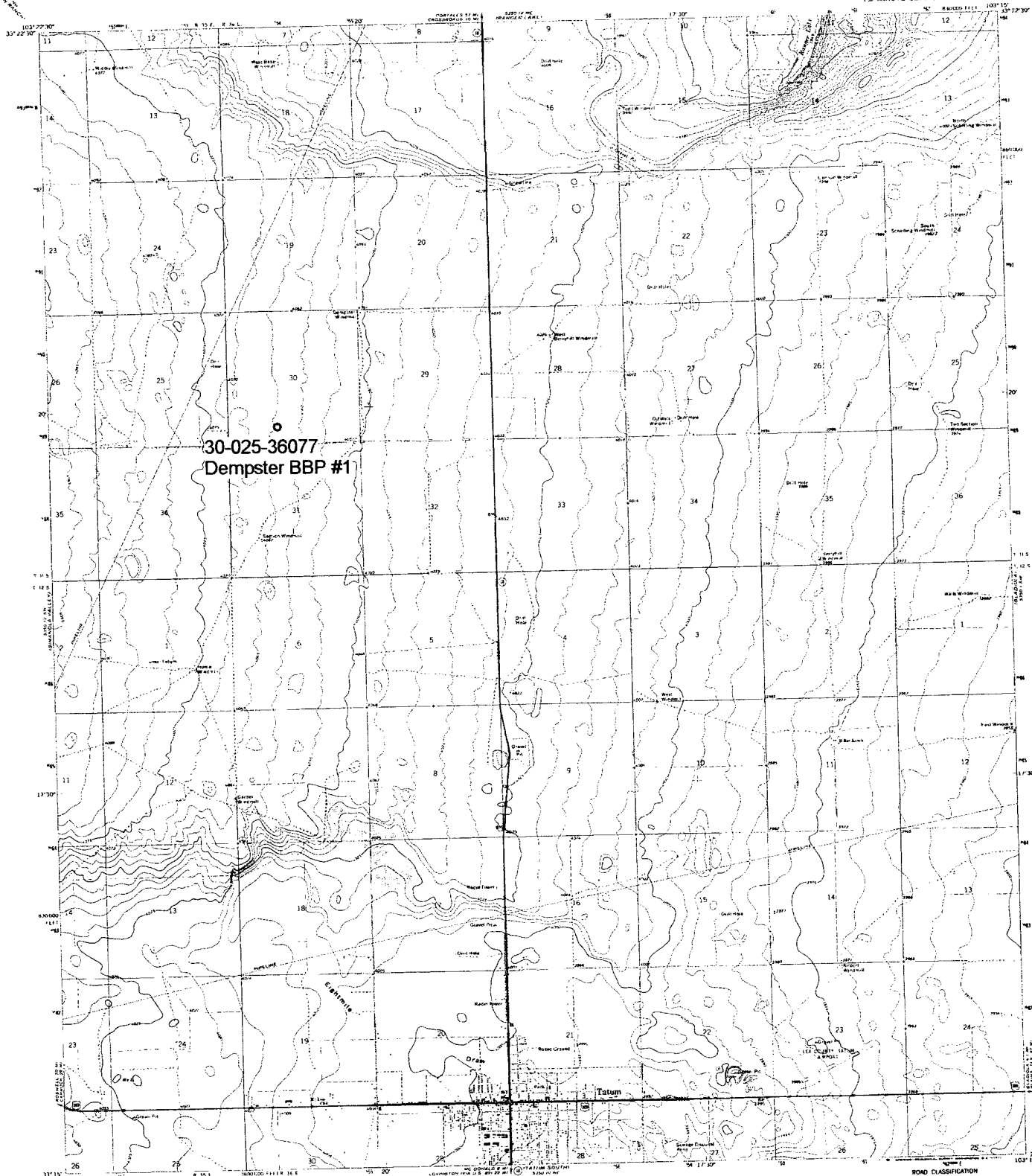

30-025-36077
Dempster BBP #1

Mapped, edited, and published by the Geological Survey
Control by USGS and USACE
Plan views by photogrammetric methods from aerial photography
taken 1960. Topographic surveys 1970
Projected projections. 1977. In use since then.
10,000 feet or less based on New Mexico coordinate system,
and some 10,000 feet. Use of aerial photography and maps.
and some 10,000 feet. Use of aerial photography and maps.
and some 10,000 feet. Use of aerial photography and maps.

SCALE 1:7000
CONTOUR INTERVAL 5 FEET
OR 10 FEET WHERE SHOWN

ROAD CLASSIFICATION
Primary highway, all weather. Light duty road, all weather.
hard surface. Improved surface.
Unimproved road, fair or dry
weather.
U.S. Route State Route

TATUM NORTH, N. MEX.
N. 21° 10' W. 10° 15' N.

FOR SALE BY U.S. GEOLOGICAL SURVEY, DENVER, COLORADO 80219 OR WASHINGTON, D.C. 20542
A POLYMER-ON-GLASS, TOPOGRAPHIC MAP, AND SYMBOLS IS AVAILABLE ON REQUEST

1970
ATRS 1000 BY GE. 1000000-1000

USGS SEO TWN 09S-15S CHAVES LEA GW

30-025-36077 Dempster BBP #1

COUNTY	SOURCE	USGS SITE NUM.	QTY	SITE LOCATION	DATE	LEVEL
LEA	SEO		1	11S.36E.28.12441	1996-02-08	21.15
LEA	SEO		1	11S.36E.28.33342	1996-02-07	15.20
LEA	SEO		1	11S.36E.29.111111	1991-02-22	17.65
LEA	SEO		1	11S.36E.33.331432	1996-02-08	12.55