

1625 N. French Dr., Hobbs, NM 88240  
District II  
1301 W. Grand Avenue, Artesia, NM 88210  
District III  
1000 Rio Brazos Road, Aztec, NM 87410  
District IV  
1220 S. St. Francis Dr., Santa Fe, NM 87505

State of New Mexico  
Energy Minerals and Natural  
Resources

Oil Conservation Division  
1220 South St. Francis Dr.  
Santa Fe, NM 87505

Form C-144  
June 1, 2004

For drilling and production facilities, submit  
to appropriate NMOCD District Office.  
For downstream facilities, submit to Santa Fe  
office

Pit or Below-Grade Tank Registration or Closure

Is pit or below-grade tank covered by a "general plan"? Yes X No ☐

Type of action: Registration of a pit or below-grade tank ☐ Closure of a pit or below-grade tank X

Operator: Yates Petroleum Company Telephone: 505-748-4500 e-mail address: mikes@ypc.com  
Address: 105 South 4<sup>th</sup> Street, Artesia, NM 88210  
Facility or well name: Twain BCW St. #1 API #: 30-025-36258 U/L or Qtr/Qtr D Sec 12 T 11S R 34E  
County: Lea Latitude 33.38523 Longitude 103.47016 NAD: 1927 ☐ 1983 X  
Surface Owner: Federal State X Private Indian ☐

Pit	Below-grade tank
Type: Drilling X Production <input type="checkbox"/> Disposal <input type="checkbox"/> Work over <input type="checkbox"/> Emergency <input type="checkbox"/> Lined X Unlined <input type="checkbox"/> Liner type: Synthetic <input type="checkbox"/> Thickness <u>12</u> mil Clay <input type="checkbox"/> Pit Volume <u>12,000</u> bbl	Volume: _____ bbl Type of fluid: _____ Construction material: _____ Double-walled, with leak detection? Yes <input type="checkbox"/> If not, explain why not. _____
Depth to ground water (vertical distance from bottom of pit to seasonal high water elevation of ground water.)	Less than 50 feet (20 points) XXXX 50 feet or more, but less than 100 feet (10 points) 100 feet or more (0 points)
Wellhead protection area: (Less than 200 feet from a private domestic water source, or less than 1000 feet from all other water sources.)	Yes (20 points) No (0 points) XXXX
Distance to surface water: (horizontal distance to all wetlands, playas, irrigation canals, ditches, and perennial and ephemeral watercourses.)	Less than 200 feet (20 points) 200 feet or more, but less than 1000 feet (10 points) XXXX 1000 feet or more (0 points)
Ranking Score (Total Points) 30 Points	

**If this is a pit closure:** (1) Attach a diagram of the facility showing the pit's relationship to other equipment and tanks. (2) Indicate disposal location: (check the onsite box if you are burying in place) onsite offsite X If offsite, name of facility: N/A (3) Attach a general description of remedial action taken including remediation start date and end date. (4) Groundwater encountered: No ☐ Yes ☐ If yes, show depth below ground surface \_\_\_\_\_ ft. and attach sample results. (5) Attach soil sample results and a diagram of sample locations and excavations.

Additional Comments: Closure work plan for drilling pit. The drilling pit contents will be excavated and hauled to an OCD approved soil waste facility. The excavated area will then be backfilled to grade using a minimum of 3' of clean soil and like material. A one call and a 48 hour notice will be provided to the Oil Conservation Division.

Pit Closure start date: N/A Final closure date: N/A

I hereby certify that the information above is true and complete to the best of my knowledge and belief. I further certify that the above-described pit or below-grade tank has been/will be constructed or closed according to NMOCD guidelines ☐, a general permit X, or an (attached) alternative OCD-approved plan ☐.

Date: 03/10/2005

Printed Name/Title DAN DULAN JR. AGENT Signature [Signature]

Your certification and NMOCD approval of this application/closure does not relieve the operator of liability should the contents of the pit or tank contaminate ground water or otherwise endanger public health or the environment. Nor does it relieve the operator of its responsibility for compliance with any other federal, state, or local laws and/or regulations.

Approval: Printed Name/Title GARY W. WINK / STAFF MGR Signature [Signature] Date: 3/21/05

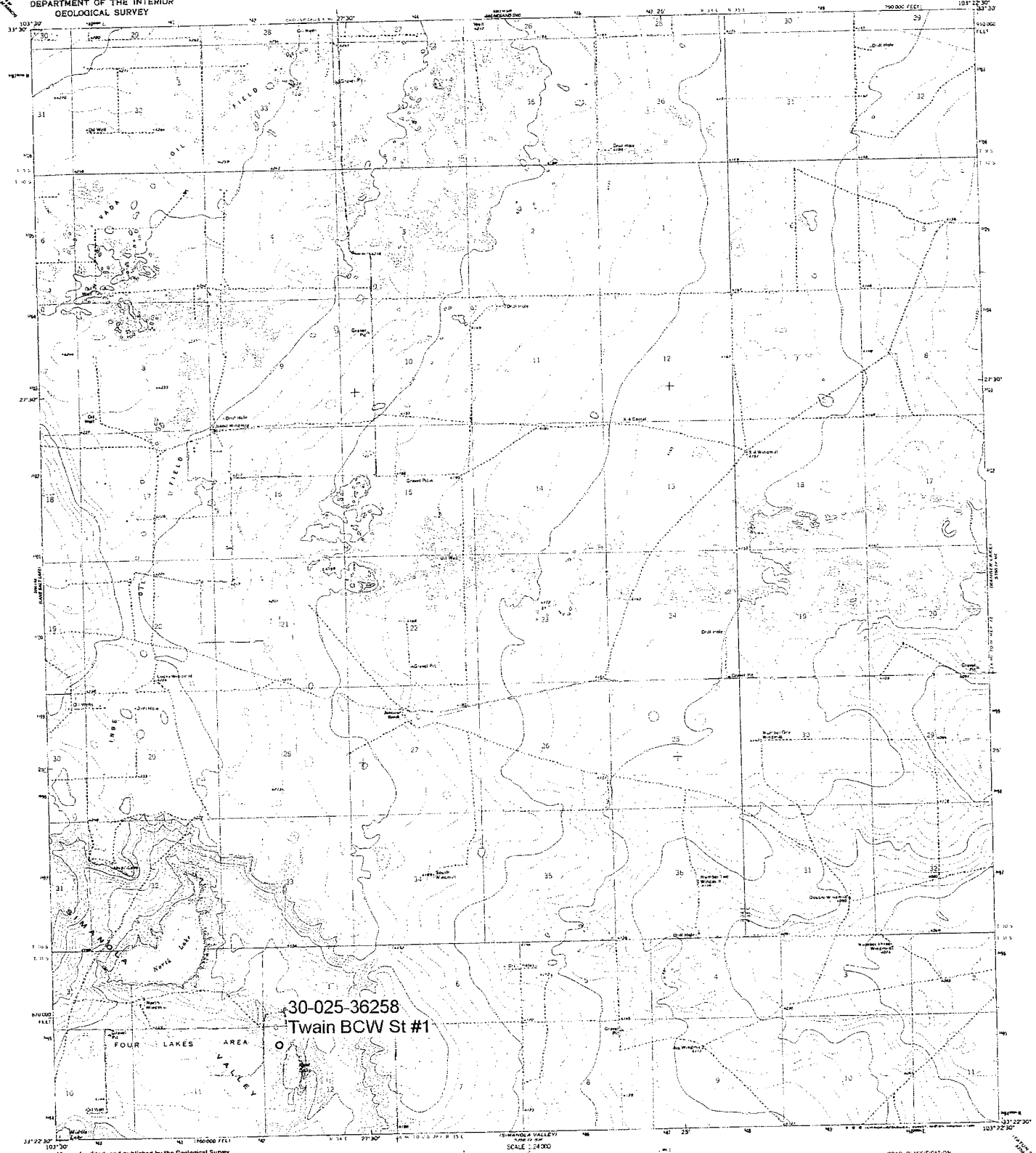

30-025-36258  
Twain BCW St #1

Maped, edited, and published by the Geological Survey  
Control by USGS and NGS/NOAA  
Photometry by photogrammetric methods from aerial photographs  
taken 1966. Topography by stereoscopic survey 1970  
Polyconic projection. 10,000-foot grid based on New Mexico  
coordinate system, east zone  
1000-meter Universal Transverse Mercator grid scale,  
zone 13, shown in blue  
1927 North American Datum  
To place on the published North American Datum 1983  
move the projection lines 7 meters south and  
46 meters east as shown by dashed center lines  
Fine red dashed lines indicate selected 'wedge' lines  
Microfilm, albumen prints, and maps of this series are available  
from the National Technical Information Service, Springfield, VA 22161  
or from the National Archives and Records Administration, College Park, MD 20740

SCALE 1:24,000  
CONTOUR INTERVAL 5 FEET  
NATIONAL GEODETIC VERTICAL DATUM OF 1929

ROAD CLASSIFICATION  
Light duty road, all weather. Disimproved road, fair or dry  
weather



JOHNSON RANCH, N. MEX.  
33 (03-04)-77-024  
1970  
44-03114-1/15 (1:0.1) 1000  
DMA 5330 BY DM-5000S (88)

THIS MAP COPIES WITH NATIONAL MAP AGENCY STANDARDS  
FOR SALE BY U.S. GEOLOGICAL SURVEY, DENVER, COLORADO 80202, OR RESTON, VIRGINIA 22092  
A FOLDER DESCRIBING TOPOGRAPHIC MAPS AND SYMBOLS IS AVAILABLE ON REQUEST

USGS SEO TWN 09S-15S CHAVES LEA GW

30-025-36258 TWAIN BCW ST. #1

COUNTY	SOURCE	USGS SITE NUM.	QTY	SITE LOCATION	DATE	LEVEL
LEA	SEO		1	11S.34E.12.341343	1990-11-30	22.91