

Submit 3 Copies To Appropriate District
Office
District I
1625 N. French Dr., Hobbs, NM 88240
District II
1301 W. Grand Ave., Artesia, NM 88210
District III
1000 Rio Brazos Rd., Aztec, NM 87410
District IV
1220 S. St. Francis Dr., Santa Fe, NM
87505

State of New Mexico
Energy, Minerals and Natural Resources

Form C-103
May 27, 2004

OIL CONSERVATION DIVISION
1220 South St. Francis Dr.
Santa Fe, NM 87505

WELL API NO.
30-025-37164

5. Indicate Type of Lease
STATE ☐ FEE ☒

6. State Oil & Gas Lease No.

7. Lease Name or Unit Agreement Name

Greenwood

8. Well Number

9. OGRID Number
227588

10. Pool name or Wildcat

Eunice San Andres Southwest

SUNDRY NOTICES AND REPORTS ON WELLS
(DO NOT USE THIS FORM FOR PROPOSALS TO DRILL OR TO DEEPEN OR PLUG BACK TO A
DIFFERENT RESERVOIR. USE "APPLICATION FOR PERMIT" (FORM C-101) FOR SUCH
PROPOSALS.)

1. Type of Well: Oil Well ☒ Gas Well ☐ Other ☐

2. Name of Operator
Range Operating New Mexico, Inc.

3. Address of Operator
777 Main St., Ste. 800, Fort Worth, TX 76102

4. Well Location

Unit Letter I : 2285 feet from the south line and 405 feet from the east line
Section 9 Township 22S Range 37E NMPM County Lea

11. Elevation (Show whether DR, RKB, RT, GR, etc.)
3419'

Pit or Below-grade Tank Application ☐ or Closure ☐

Pit type _____ Depth to Groundwater _____ Distance from nearest fresh water well _____ Distance from nearest surface water _____

Pit Liner Thickness: _____ mil Below-Grade Tank: Volume _____ bbls; Construction Material _____

12. Check Appropriate Box to Indicate Nature of Notice, Report or Other Data

NOTICE OF INTENTION TO:

PERFORM REMEDIAL WORK ☐ PLUG AND ABANDON ☐
TEMPORARILY ABANDON ☐ CHANGE PLANS ☐
PULL OR ALTER CASING ☐ MULTIPLE COMPL ☐

OTHER: ☐

SUBSEQUENT REPORT OF:

REMEDIAL WORK ☐ ALTERING CASING ☐
COMMENCE DRILLING OPNS. ☐ P AND A ☐
CASING/CEMENT JOB ☐

OTHER: Change of location: ☒

13. Describe proposed or completed operations. (Clearly state all pertinent details, and give pertinent dates, including estimated date of starting any proposed work). SEE RULE 1103. For Multiple Completions: Attach wellbore diagram of proposed completion or recompletion.

Changing location.

From: 2285' FSL & 330' FEL
To: 2285' FSL & 405' FEL

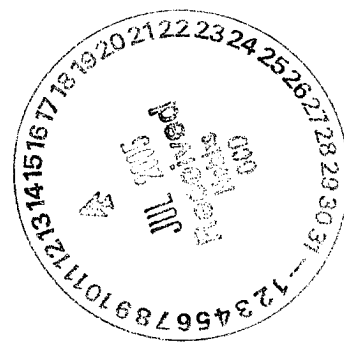

I hereby certify that the information above is true and complete to the best of my knowledge and belief. I further certify that any pit or below-grade tank has been/will be constructed or closed according to NMOCD guidelines ☐, a general permit ☐ or an (attached) alternative OCD-approved plan ☐.

SIGNATURE Paula Hale TITLE Sr. Reg. Sp. DATE 7/12/05

Type or print name Paula Hale
For State Use Only

E-mail address: phale@rangeresources.com Telephone No. 817/810-1916

APPROVED BY: [Signature]
Conditions of Approval (if any):

TITLE _____ DATE _____

PETROLEUM ENGINEER

JUL 14 2005

State of New Mexico

DISTRICT I

1626 N. FRENCH DR., HOBBS, NM 88240

Energy, Minerals and Natural Resources Department

DISTRICT II

1301 W. GRAND AVENUE, ARTESIA, NM 88210

DISTRICT III

1000 Rio Brazos Rd., Aztec, NM 87410

DISTRICT IV

1220 S. ST. FRANCIS DR., SANTA FE, NM 87505

OIL CONSERVATION DIVISION
1220 SOUTH ST. FRANCIS DR.
Santa Fe, New Mexico 87505

Form C-102

Revised JUNE 10, 2003

Submit to Appropriate District Office

State Lease - 4 Copies

Fee Lease - 3 Copies

WELL LOCATION AND ACREAGE DEDICATION PLAT

XX AMENDED REPORT

API Number 30-025-37164	Pool Code 24180	Pool Name Eunice San Andres Southwest
Property Code 34085 301563	Property Name GREENWOOD	Well Number 25
OGRID No. 227588	Operator Name RANGE OPERATING NEW MEXICO, INC.	Elevation 3419'

Surface Location

UL or lot No.	Section	Township	Range	Lot Idn	Feet from the	North/South line	Feet from the	East/West line	County
1	9	22-S	37-E		2285	SOUTH	405	EAST	LEA

Bottom Hole Location If Different From Surface

UL or lot No.	Section	Township	Range	Lot Idn	Feet from the	North/South line	Feet from the	East/West line	County
Dedicated Acres 40	Joint or Infill	Consolidation Code	Order No.						

NO ALLOWABLE WILL BE ASSIGNED TO THIS COMPLETION UNTIL ALL INTERESTS HAVE BEEN CONSOLIDATED
OR A NON-STANDARD UNIT HAS BEEN APPROVED BY THE DIVISION

<p>GEODETIC COORDINATES NAD 27 NME</p> <p>Y=513138.2 N X=862027.1 E</p> <p>LAT.=32°24'18.97" N LONG.=103°09'37.19" W</p>	<p>OPERATOR CERTIFICATION</p> <p>I hereby certify the the information contained herein is true and complete to the best of my knowledge and belief.</p> <p><i>Paula Hale</i></p> <p>Signature</p> <p>Printed Name</p> <p>Sr. Reg. Sp.</p> <p>Title</p> <p>7/12/05</p> <p>Date</p>	
	<p>SURVEYOR CERTIFICATION</p> <p>I hereby certify that the well location shown on this plat was plotted from field notes of actual surveys made by me or under my supervision and that the same is true and correct to the best of my belief.</p> <p>JUNE 15, 2005</p> <p>Date Surveyed</p> <p>Signature & Seal Professional Surveyor</p> <p>GARY A. EIDSON NEW MEXICO 05.11.0956</p> <p>Certificate No. GARY EIDSON 12641</p>	
	<p>405'</p> <p>2285'</p>	
	<p>DEL</p>	

SECTION 9, TOWNSHIP 22 SOUTH, RANGE 37 EAST, N.M.P.M.,
 LEA COUNTY, NEW MEXICO

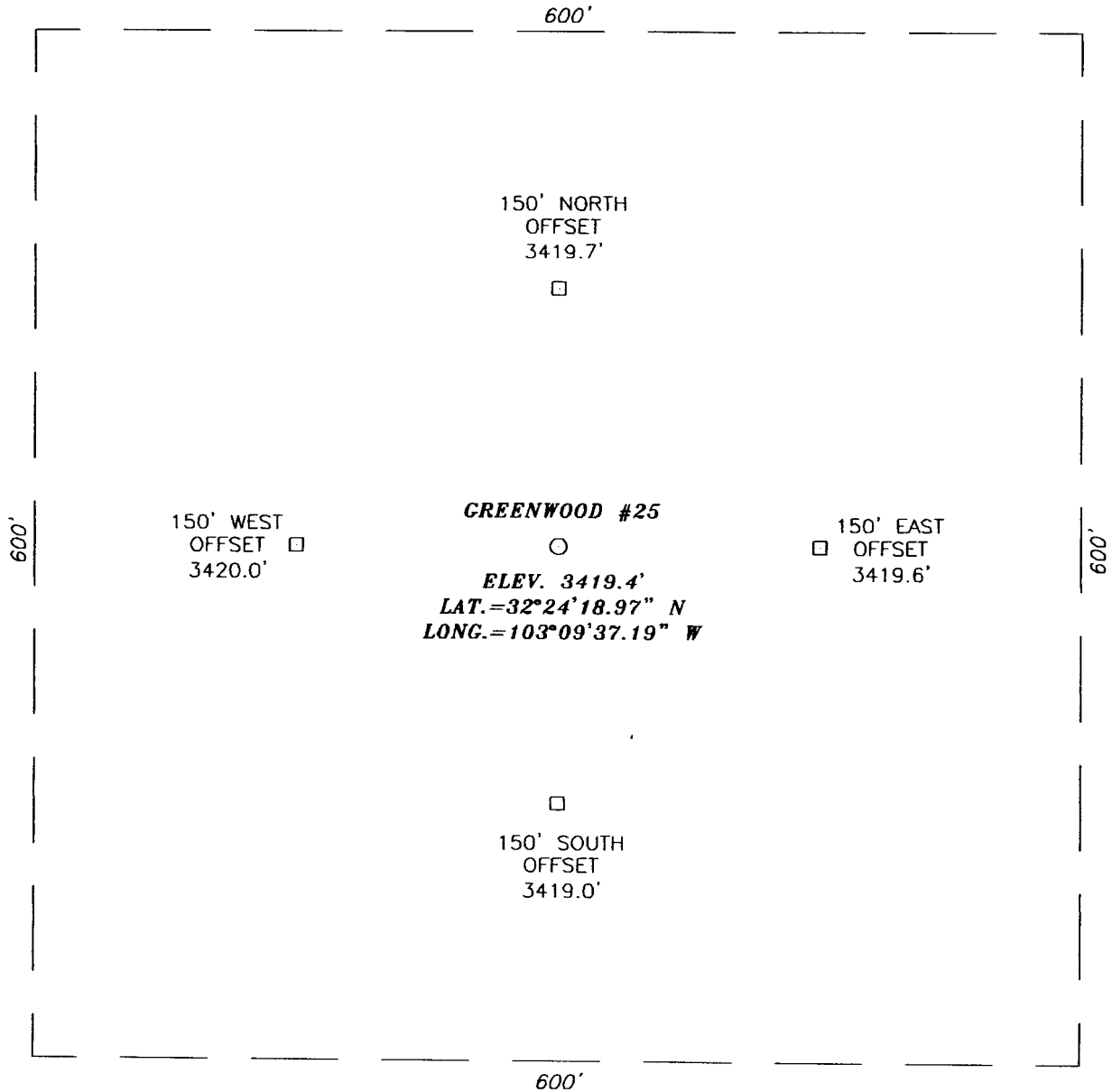

DIRECTIONS TO LOCATION

FROM THE INTERSECTION OF DELAWARE BASIN RD.
 (CO. RD. #21) AND HWY. #207 (SOUTH OF
 EUNICE). GO NORTH ON HWY. #207 APPROX. 0.4
 MILES. TURN LEFT (WEST) AND GO APPROX. 400'.
 THIS LOCATION IS APPROX. 250' NORTH.

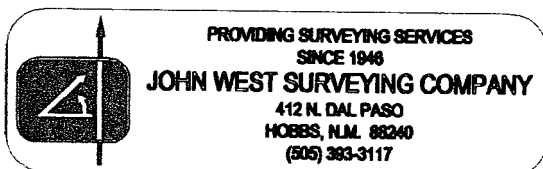
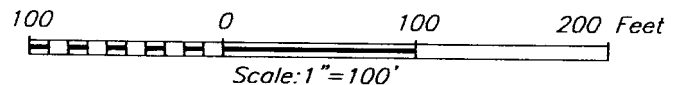

RANGE OPERATING NEW MEXICO, INC.			
GREENWOOD #25 WELL LOCATED 2285 FEET FROM THE SOUTH LINE AND 405 FEET FROM THE EAST LINE OF SECTION 9, TOWNSHIP 22 SOUTH, RANGE 37 EAST, N.M.P.M., LEA COUNTY, NEW MEXICO.			
Survey Date: 06/15/05	Sheet 1 of 1 Sheets		
W.O. Number: 05.11.0956	Dr By: DEL	Rev 1:N/A	
Date: 06/21/05	Disk: CD#4	05110956	Scale: 1"=100'

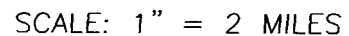

PROVIDING SURVEYING SERVICES
SINCE 1946
JOHN WEST SURVEYING COMPANY
412 N. DAL PASO
HOBBS, N.M. 88240
(505) 393-3117

LOCATION VERIFICATION MAP

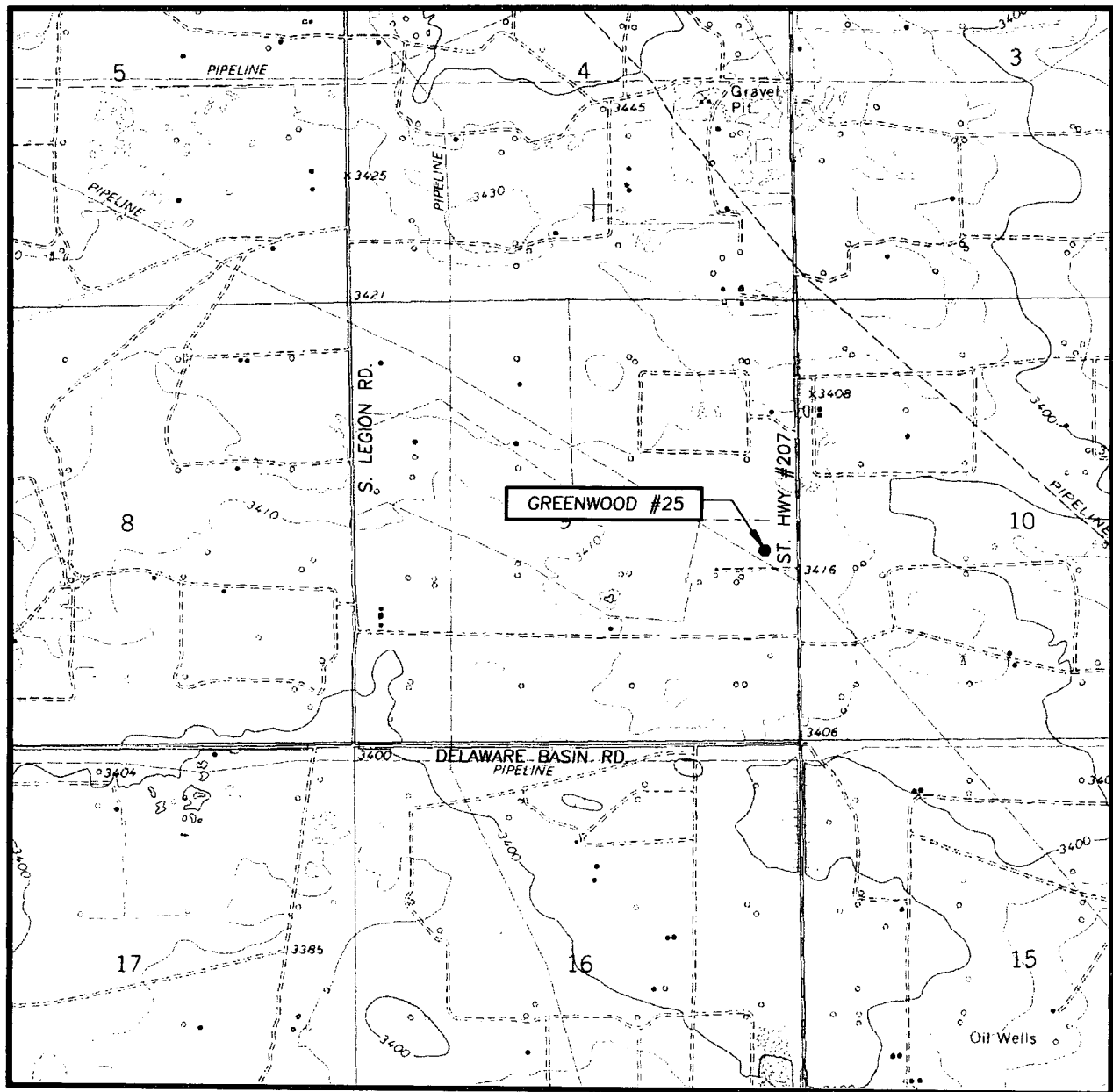

SCALE: 1" = 2000'

CONTOUR INTERVAL:
EUNICE, N.M. - 10'

SEC. 9 TWP. 22-S RGE. 37-E

SURVEY N.M.P.M.

COUNTY LEA

DESCRIPTION 2285' FSL & 405' FEL

ELEVATION 3419'

OPERATOR RANGE OPERATING
NEW MEXICO, INC.

LEASE GREENWOOD

U.S.G.S. TOPOGRAPHIC MAP
EUNICE, N.M.

