

HOBBS OCD

AUG 10 2011

OCD Hobbs

UNITED STATES
DEPARTMENT OF THE INTERIOR
BUREAU OF LAND MANAGEMENTFORM APPROVED
OMB No 1004-0137
Expires July 31, 2010

RECEIVED

SUNDRY NOTICES AND REPORTS ON WELLS

Do not use this form for proposals to drill or to re-enter an abandoned well. Use Form 3160-3 (APD) for such proposals.

SUBMIT IN TRIPLICATE - Other Instructions on page 2.

1 Type of Well <input checked="" type="checkbox"/> Oil Well <input type="checkbox"/> Gas Well <input type="checkbox"/> Other	5 Lease Serial No NMNM118720
2 Name of Operator COG Operating LLC	6 If Indian, Allottee, or Tribe Name
3a Address 2208 W Main Street Artesia, NM 88210	7 If Unit or CA Agreement Name and/or No
3b Phone No (include area code) 575-748-6940	8 Well Name and No Patterson B-52 Federal #2H
4 Location of Well (Footage, Sec, T, R, M, or Survey Description) 330' FNL & 330' FEL, Unit A (NENE) Sec5-T19S-R32E 380' FNL & 330' FWL, Unit D (NWNW) Sec5-T19S-R32E	9 API Well No 30-025-38969
Lat. Long.	10 Field and Pool, or Exploratory Area Lusk; Bone Spring, North
	11 County or Parish, State Lea County NM

12 CHECK APPROPRIATE BOX(S) TO INDICATE NATURE OF NOTICE, REPORT, OR OTHER DATA

TYPE OF SUBMISSION	TYPE OF ACTION			
<input checked="" type="checkbox"/> Notice of Intent	<input type="checkbox"/> Acidize	<input type="checkbox"/> Deepen	<input type="checkbox"/> Production (Start/ Resume)	<input type="checkbox"/> Water Shut-off
<input type="checkbox"/> Subsequent Report	<input type="checkbox"/> Altering Casing	<input type="checkbox"/> Fracture Treat	<input type="checkbox"/> Reclamation	<input type="checkbox"/> Well Integrity
<input type="checkbox"/> Final Abandonment Notice	<input type="checkbox"/> Casing Repair	<input type="checkbox"/> New Construction	<input type="checkbox"/> Recomplete	<input checked="" type="checkbox"/> Other
	<input type="checkbox"/> Change Plans	<input type="checkbox"/> Plug and abandon	<input type="checkbox"/> Temporarily Abandon	SHL Change
	<input type="checkbox"/> Convert to Injection	<input type="checkbox"/> Plug back	<input type="checkbox"/> Water Disposal	

13 Describe Proposed or Completed Operation (clearly state all pertinent details including estimated starting date of any proposed work and approximate duration thereof. If the proposal is to deepen directionally or recompleat horizontally, give subsurface locations and measured and true vertical depths or pertinent markers and sands. Attach the Bond under which the work will performed or provide the Bond No on file with the BLM/ BIA Required subsequent reports shall be filed within 30 days following completion of the involved operations. If the operation results in a multiple completion or recompleat in a new interval, a Form 3160-4 shall be filed once testing has been completed. Final Abandonment Notice shall be filed only after all requirements, including reclamanation, have been completed, and the operator has determined that the site is ready for final inspection)

COG Operating LLC respectfully request the SHL changes for the original approved APD.

From: 330' FNL & 660' FEL
To: 330' FNL & 330' FEL

Surface OK J Fast 7-29-11

Drill 7-7/8" hole to 9750'. Run logs & plug back to 8700'. Kick off, build curve and drill lateral to 13,778'
MD (9360' TVD) see attached directional plan. Run 5-1/2" 17# P110 LTC csg to 13,778'. Cmt in 1 stage
to 2800' with below cmt design.
PH Plug: 8700' - 9750'
350 sx Class C + CFR-3 + HR601 @ 16.8 ppg / 1.02 yield
Production Cmt:
Lead: 600 sx 35:65:6 H + Salt + CFR-3 + Gilsonite + HR601 @ 12.7 ppg / 1.89 yield
Tail: 1200 sx 50:50:2 H + Salt + CFR-3 + GasStop + HR601 @ 14.4 ppg / 1.25 yield
TOC @ 2800' with 9-5/8" @ 3300'

14 I hereby certify that the foregoing is true and correct

Name (Printed/ Typed)

Mayte Reyes

Title

Regulatory Analyst

Signature

Date

7/21/11

THIS SPACE FOR FEDERAL OR STATE OFFICE USE

Approved by: /s/ Don Peterson

Title

AFM

Date

8/1/11

Conditions of approval, if any are attached Approval of this notice does not warrant or certify that the applicant holds legal or equitable title to those rights in the subject lease which would entitle the applicant to conduct operations thereon

Office

CARLSBAD FIELD OFFICE

Title 18 U.S.C. Section 1001 AND Title 43 U.S.C. Section 1212, make it a crime for any person knowingly and willfully to make any department or agency of the United States any false, fictitious or fraudulent statements or representations as to any matter within its jurisdiction

(Instructions on page 2)

AUG 11 2011

AUG 10 2011

RECEIVED



Form C-102
Revised July 16, 2010
Submit to Appropriate
District Office

☐ AMENDED REPORT

API Number 30-025-38969	Pool Code 41440	Pool Name Lusk Bone Spring
Property Code 308645	Property Name PATTERSON B-52 FEDERAL	Well Number 2H
OGRID No. 229137	Operator Name COG OPERATING, LLC	Elevation 3874'

UL or lot No.	Section	Township	Range	Lot Idn	Feet from the	North/South line	Feet from the	East/West line	County
A	5	19-S	32-E		330	NORTH	330	EAST	LEA

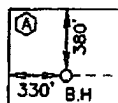
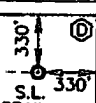
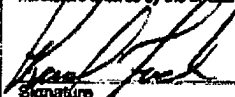
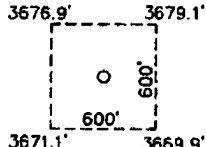
U/L or lot No. D	Section 5	Township 19-S	Range 32-E	Lot Idn	Feet from the	North/South line NORTH	Feet from the	East/West line WEST	County LEA
Dedicated Acres		Joint or Infill		Consolidation Code		Order No.			

<p>(A)</p> 	<p>(C)</p> <p>GRID A.Z. = 269°13'00"</p> <p>HORIZ. DIST. = 4623.8'</p>	<p>(D)</p> 	<p>OPERATOR CERTIFICATION</p> <p>I hereby certify that the information herein is true and complete to the best of my knowledge and belief, and that this organization either owns a working interest or unleased mineral interest in the land including the proposed bottom hole location or has a right to drill this well at this location pursuant to a contract with an owner of such mineral or working interest, or to a voluntary pooling agreement or a compulsory pooling order hereinafter entered by the division.</p> <p>  6/30/11 </p> <p>Signature _____ Date _____</p> <p><u>Rand French</u></p> <p>Printed Name _____</p> <p>_____ E-mail Address</p>
<p>(B)</p>	<p>GEODETIC COORDINATES NAD 27 NME</p> <p>SURFACE LOCATION</p> <p>Y=617258.0 N X=670083.9 E</p> <p>LAT. = 32.695722° N LONG. = 103.780455° W</p> <p>BOTTOM HOLE LOCATION</p> <p>Y=617194.9 N X=665461.6 E</p>	<p>(E)</p> 	<p>SURVEYOR CERTIFICATION</p> <p>I hereby certify that the well location shown on this plat was plotted from field notes of actual surveys made by me or under my supervision, and that the same is true and correct to the best of my belief.</p> <p style="text-align: center;">JUNE 24, 2011</p> <p>Date of Survey _____</p> <p>Signature <u>Rand French</u> _____</p> <p>_____ Professional Surveyor</p> <div style="text-align: center;">  </div> <p> Certified by _____ 6/28/2011 Rand French, New Mexico, No. 3239 </p> <p style="text-align: right;">JWSC WO: 11 11.1384</p>
<p>SECTION, QUARTER & SIXTEENTH CORNER COORDINATES</p> <p>(A) - Y=617573.9, X=665129.2</p> <p>(B) - Y=616253.1, X=665137.9</p> <p>(C) - Y=617581.1, X=667764.5</p> <p>(D) - Y=617589.0, X=670411.6</p> <p>(E) - Y=616269.0, X=670420.9</p>			

AUG 11 2011

SECTION 5, TOWNSHIP 19 SOUTH, RANGE 32 EAST, N.M.P.M.
LEA COUNTY NEW MEXICO

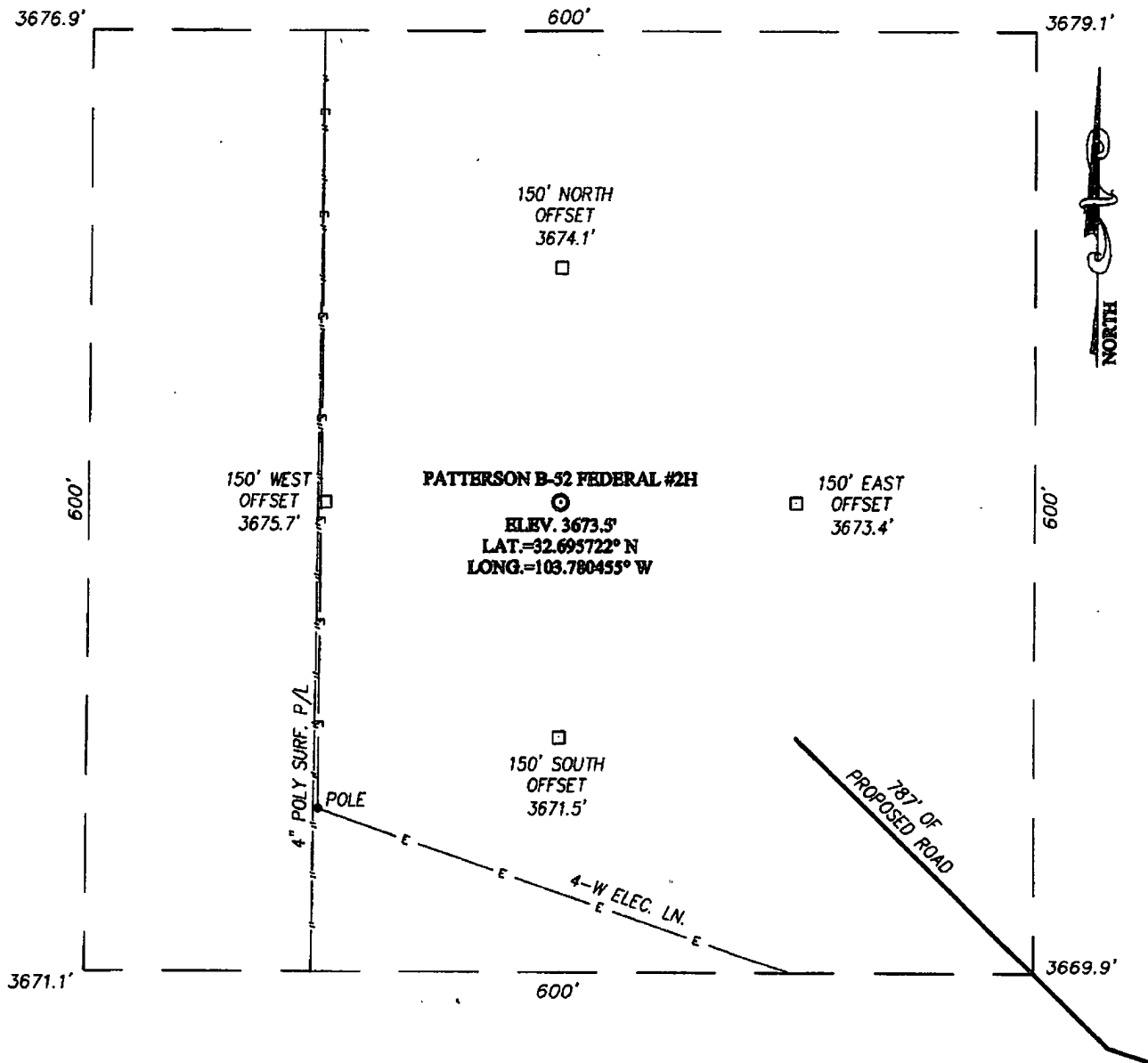

DIRECTIONS TO LOCATION

FROM THE INTERSECTION OF ST. HWY. #243 AND CO. RD. #126 (MALJAMAR) GO NORTH ON CO. RD. #126 APPROX. 7.9 MILES. GO EAST-NORTHEAST APPROX. 0.8 MILES. GO NORTH APPROX. 0.35 MILES. GO EAST APPROX. 0.2 MILES. GO NORTH APPROX. 0.3 MILES TO THE SOUTHWEST CORNER OF THE VALHALLA "4" FEDERAL COM #1 WELL PAD. FOLLOW ROAD SURVEY NORTHWEST APPROX. 1000 FEET TO THIS LOCATION STAKE.

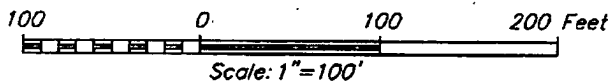

COG OPERATING, LLC

PATTERSON B-52 FEDERAL #2H WELL
LOCATED 330 FEET FROM THE NORTH LINE
AND 330 FEET FROM THE EAST LINE OF SECTION 5,
TOWNSHIP 19 SOUTH, RANGE 32 EAST, N.M.P.M.,
LEA COUNTY, NEW MEXICO

Survey Date: 6/24/11	Sheet 1 of 1 Sheets
W.O. Number: 11.11.1394	Dr. By: LA
Date: 6/27/11	Rel. W.O.: 11111394
	Scale: 1"=100'

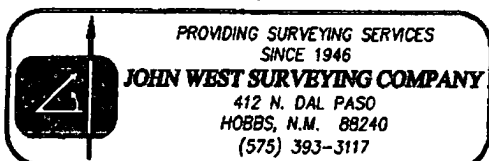

VICINITY MAP

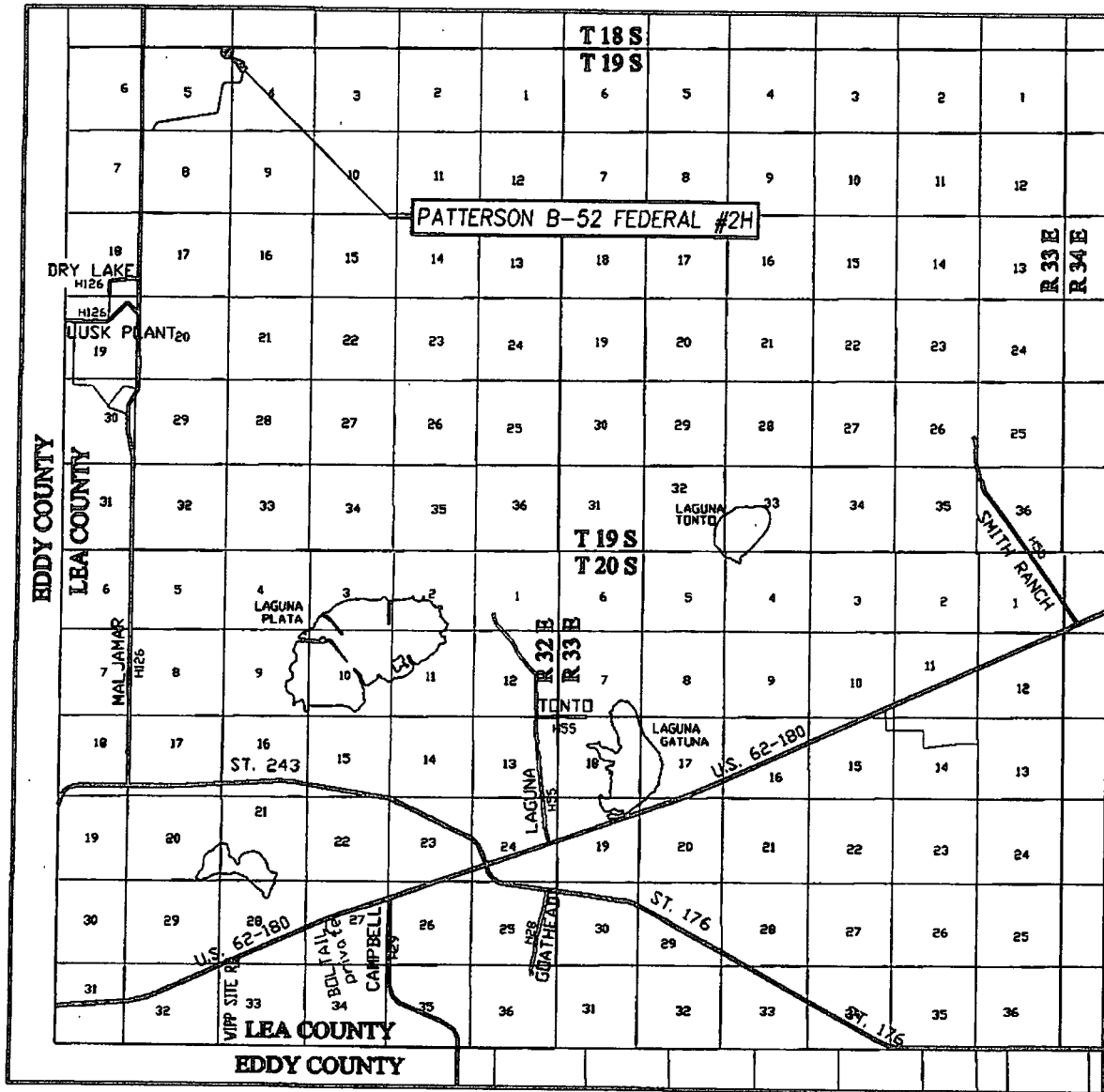

SCALE: 1" = 2 MILES

SEC. 5 TWP. 19-S RGE. 32-E
 SURVEY N.M.P.M.
 COUNTY LEA STATE NEW MEXICO
 DESCRIPTION 330' FNL & 330' FEL
 ELEVATION 3674'
 OPERATOR COG OPERATING, LLC
 LEASE PATTERSON B-52 FEDERAL

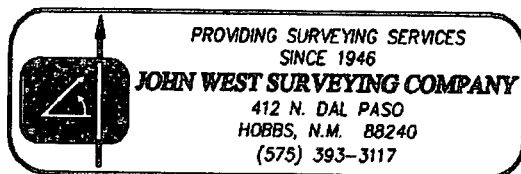

NORTH

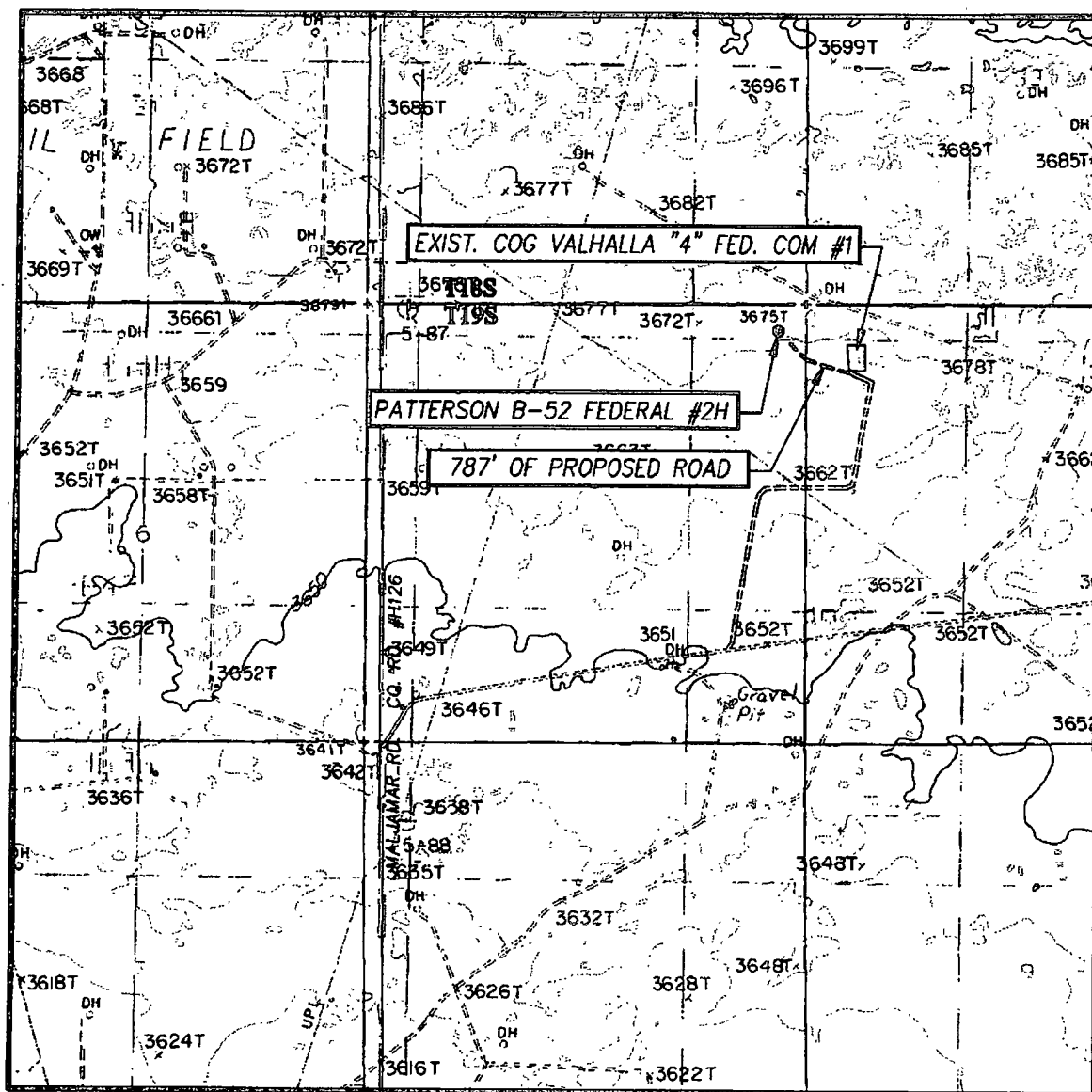

CONTOUR INTERVAL:
GREENWOOD LAKE, N.M. - 10'

SURVEY_____ N.M.P.M.

COUNTY LEA STATE NEW MEXICO

DESCRIPTION 330' FNL & 330' FEL

ELEVATION 3674'

OPERATOR COG OPERATING, LLC

LEASE PATTERSON B-52 FEDERAL

U.S.G.S. TOPOGRAPHIC MAP
GREENWOOD LAKE, N.M.

