

UNITED STATES  
DEPARTMENT OF THE INTERIOR  
BUREAU OF LAND MANAGEMENT~~660-A-10-10~~OCD Hobbs  
HOBBS OCDFORM APPROVED  
OMB NO 1004-0135  
Expires: July 31, 2010**SUNDRY NOTICES AND REPORTS ON WELLS**  
*Do not use this form for proposals to drill or to re-enter an  
abandoned well. Use form 3160-3 (APD) for such proposals.*

OCT 05 2011

**SUBMIT IN TRIPLICATE - Other instructions on reverse side.**

RECEIVED

1. Type of Well <input checked="" type="checkbox"/> Oil Well <input type="checkbox"/> Gas Well <input type="checkbox"/> Other		5. Lease Serial No. NMLC061863A
2. Name of Operator DEVON ENERGY PRODUCTION CO LP Contact: MELANIE A CRAWFORD Email: MELANIE.CRAWFORD@DVN.COM		6. If Indian, Allottee or Tribe Name
3a. Address 20 NORTH BROADWAY SUITE 1500 OKLAHOMA CITY, OK 73102	3b. Phone No. (include area code) Ph: 405-552-4524	7. If Unit or CA/Agreement, Name and/or No.
4. Location of Well (Footage, Sec., T., R., M., or Survey Description) Multiple--See Attached		8. Well Name and No. Multiple--See Attached
		9. API Well No. Multiple--See Attached
		10. Field and Pool, or Exploratory UNDESIGNATED WILDCAT
		11. County or Parish, and State LEA COUNTY, NM

**12. CHECK APPROPRIATE BOX(ES) TO INDICATE NATURE OF NOTICE, REPORT, OR OTHER DATA**

TYPE OF SUBMISSION	TYPE OF ACTION			
<input checked="" type="checkbox"/> Notice of Intent	<input type="checkbox"/> Acidize	<input type="checkbox"/> Deepen	<input type="checkbox"/> Production (Start/Resume)	<input type="checkbox"/> Water Shut-Off
<input type="checkbox"/> Subsequent Report	<input type="checkbox"/> Alter Casing	<input type="checkbox"/> Fracture Treat	<input type="checkbox"/> Reclamation	<input type="checkbox"/> Well Integrity
<input type="checkbox"/> Final Abandonment Notice	<input type="checkbox"/> Casing Repair	<input type="checkbox"/> New Construction	<input type="checkbox"/> Recomplete	<input checked="" type="checkbox"/> Other
	<input type="checkbox"/> Change Plans	<input type="checkbox"/> Plug and Abandon	<input type="checkbox"/> Temporarily Abandon	Off-Lease Measuremen t
	<input type="checkbox"/> Convert to Injection	<input type="checkbox"/> Plug Back	<input type="checkbox"/> Water Disposal	

13. Describe Proposed or Completed Operation (clearly state all pertinent details, including estimated starting date of any proposed work and approximate duration thereof. If the proposal is to deepen directionally or recompleat horizontally, give subsurface locations and measured and true vertical depths of all pertinent markers and zones. Attach the Bond under which the work will be performed or provide the Bond No. on file with BLM/BIA. Required subsequent reports shall be filed within 30 days following completion of the involved operations. If the operation results in a multiple completion or recompleat in a new interval, a Form 3160-4 shall be filed once testing has been completed. Final Abandonment Notices shall be filed only after all requirements, including reclamation, have been completed, and the operator has determined that the site is ready for final inspection.)

Devon Energy Production Co, LP respectfully requests approval for Off-Lease Gas measurement, Sales,  
& Storage for the following wells:

Trionyx 6 Federal 1H  
API: 30-025-39948

Trionyx 6 Federal 2H  
API: 30-025-39949

Trionyx 6 Federal 3HY  
API: 30-025-39984

**SEE ATTACHED FOR  
CONDITIONS OF APPROVAL**

40105

14. I hereby certify that the foregoing is true and correct. <b>Electronic Submission #118525 verified by the BLM Well Information System For DEVON ENERGY PRODUCTION CO LP, sent to the Hobbs Committed to AFMSS for processing by KURT SIMMONS on 09/28/2011 (11KMS1094SE)</b>	
Name (Printed/Typed) MELANIE A CRAWFORD	Title REGULATORY ANALYST
Signature (Electronic Submission)	Date 09/27/2011

**THIS SPACE FOR FEDERAL OR STATE OFFICE USE**

Approved By DUNCAN WHITLOCK	Title LEAD PET	Date 10/03/2011
Conditions of approval, if any, are attached. Approval of this notice does not warrant or certify that the applicant holds legal or equitable title to those rights in the subject lease which would entitle the applicant to conduct operations thereon.		Office Hobbs

Title 18 U.S.C. Section 1001 and Title 43 U.S.C. Section 1212, make it a crime for any person knowingly and willfully to make to any department or agency of the United States any false, fictitious or fraudulent statements or representations as to any matter within its jurisdiction.

**\*\* BLM REVISED \*\* BLM REVISED \*\* BLM REVISED \*\* BLM REVISED \*\* BLM REVISED \*\***

OCT 11 2011

**Additional data for EC transaction #118525 that would not fit on the form**

**Wells/Facilities, continued**

Agreement	Lease	Well/Fac Name, Number	API Number	Location
NMLC061863A	NMLC061863A	TRIONYX 6 FEDERAL 1H	30-025-39948-00-X1	Sec 6 T25S R32E SWSW 200FSL 940FWL
NMLC061863A	NMLC061863A	TRIONYX 6 FEDERAL 2H	30-025-39949-00-X1	Sec 6 T25S R32E SWSW 200FSL 990FWL
NMLC061863A	NMLC061863A	TRIONYX 6 FEDERAL 3HY	30-025-40105-00-X1	Sec 6 T25S R32E SWSW Lot M 200FSL 1015FWL

**32. Additional remarks, continued**

This is a three well pad and the tank battery is located on the well pad location: All three wells will utilize this tank battery and will be the only wells at this time. The CDP ~~CDP~~ Gas Sales Meter 727856-00 is located in Sec 11, T25S, R31E in Lea County, NM. All three wells will flow to the CDP and will be the only wells at this time utilizing the DCP CDP Gas Sales Meter 727856-00. There will be allocation gas, oil, and p/w meter for every well at the well and there will also be a gas check meter to check against the DCP CDP 727856-00 and it will be located at the Trionyx tank battery.

\*Will submit production and meter number once available.

ROW will or has already been obtained.

The working interest, royalty interest and overriding royalty interest onwers in the lease are uninformd; no additional notification is required.

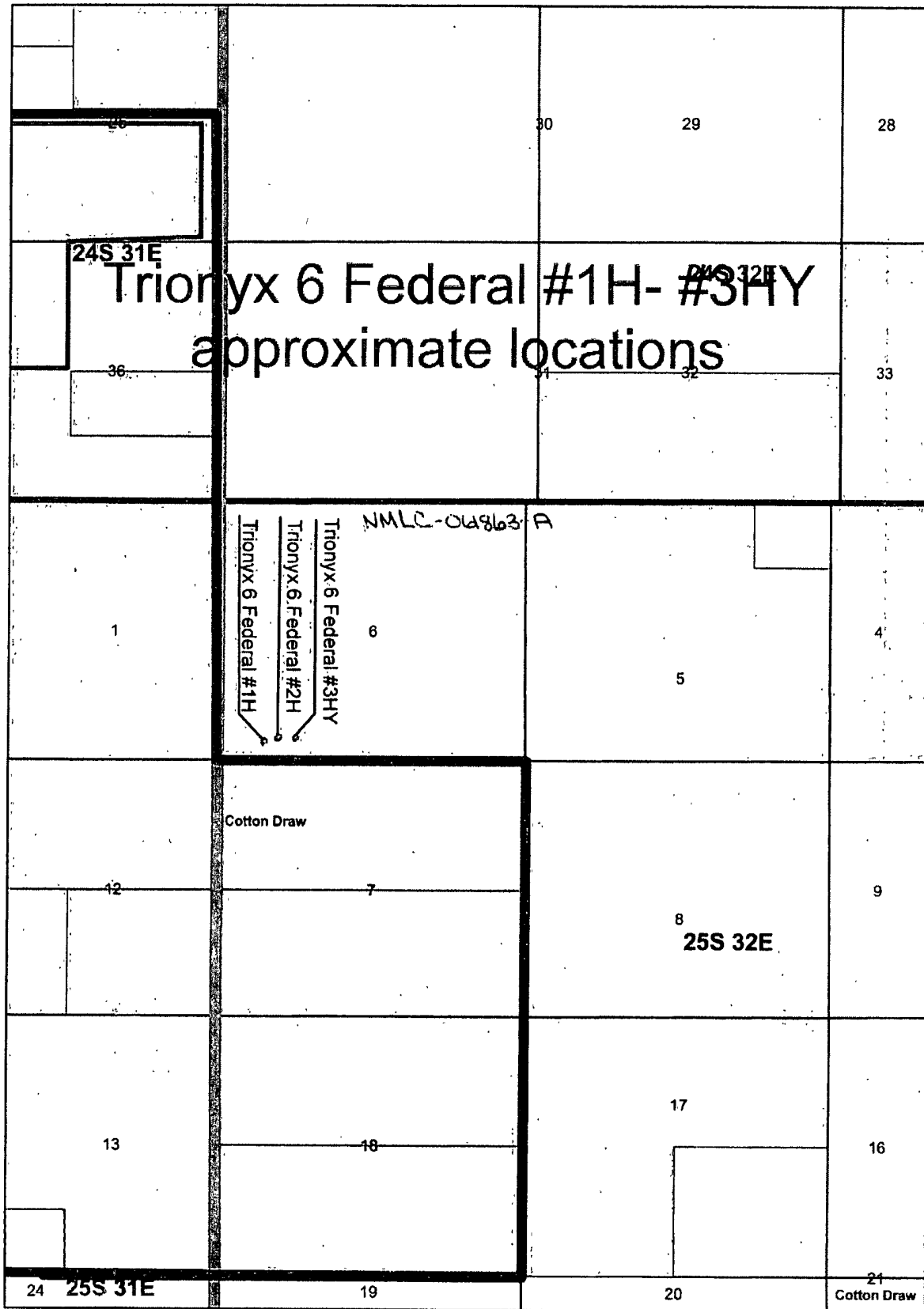

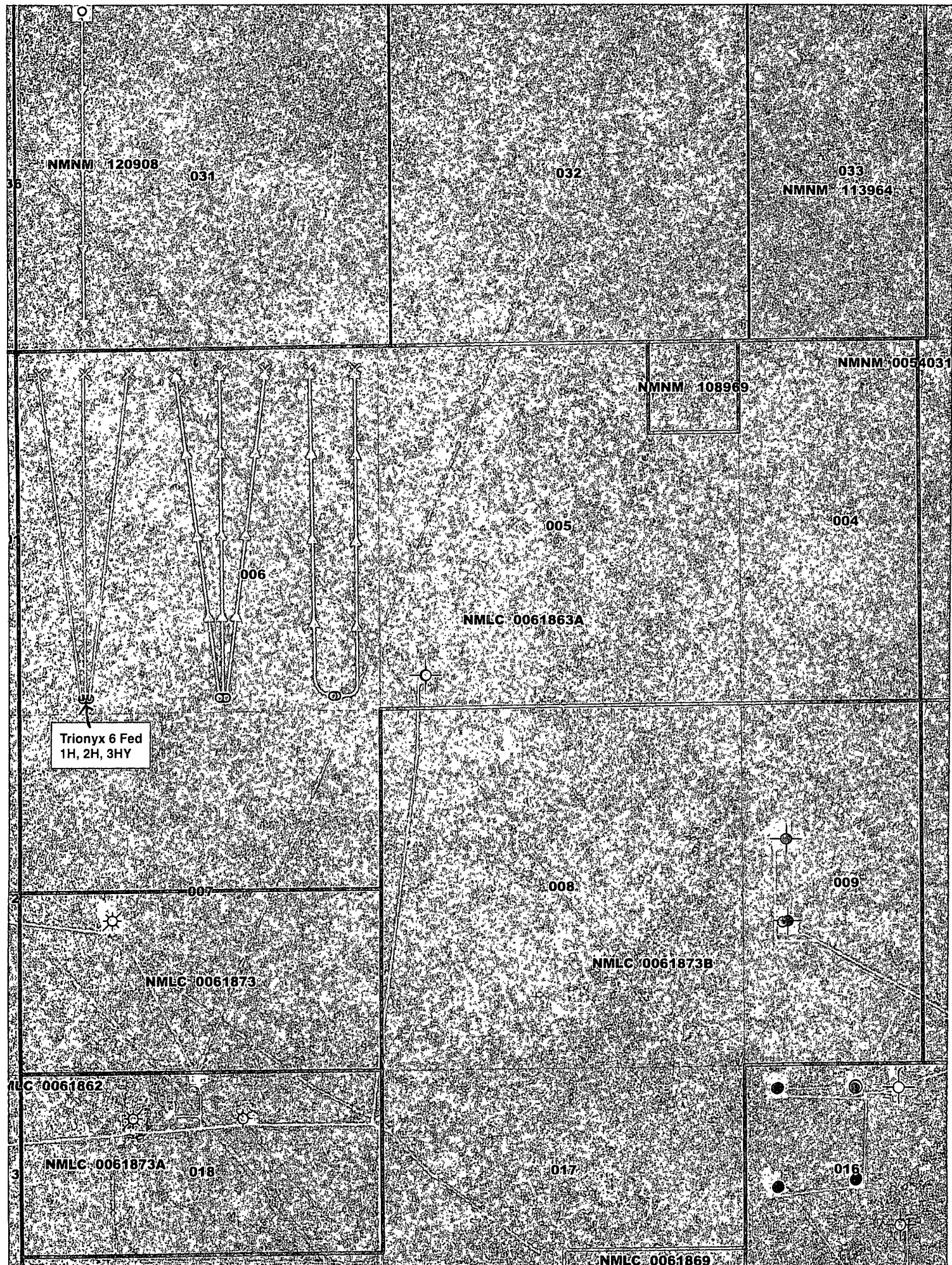

Trionyx 6 Federal 1 Battery  
 Section 6,T25S,R32E  
 200°FNL&940FEL  
 Lea County, N.M  
 AP# 30-025-39948

Production System: Open

- 1) Oil sales by tank gauge to tank truck.
- 2) Seal requirements:

A. Production Phase: On all Tanks.

(1) All valves 5 sealed closed.

Sales Phase: On Tank being hauled.

(1) Valve 1 sealed closed. 

(2) Valve 3 sealed closed. 

(3) Valve 4 sealed closed. 

(4) Valve 5 sealed closed. 

(5) Misc. Valves. Plugged or otherwise inaccessible. 

NOTE: Valve 2 is either a test or roll line if there is a valve 2 it will be sealed closed. 

#### Ledger for Site Diagram

Valve #1: Production Line 

Valve #2: Test or Roll line 

Valve #3: Equilizer Line 

Valve #4: Circ./Drain Line 

Valve #5: Sles Line 

Valve #6: BS&W Load Line 

Buried Lines: 

Firewall: 

Wellhead: 

Stak-pak: 

Production line: 

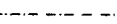
Water line: 

Gas Meter   

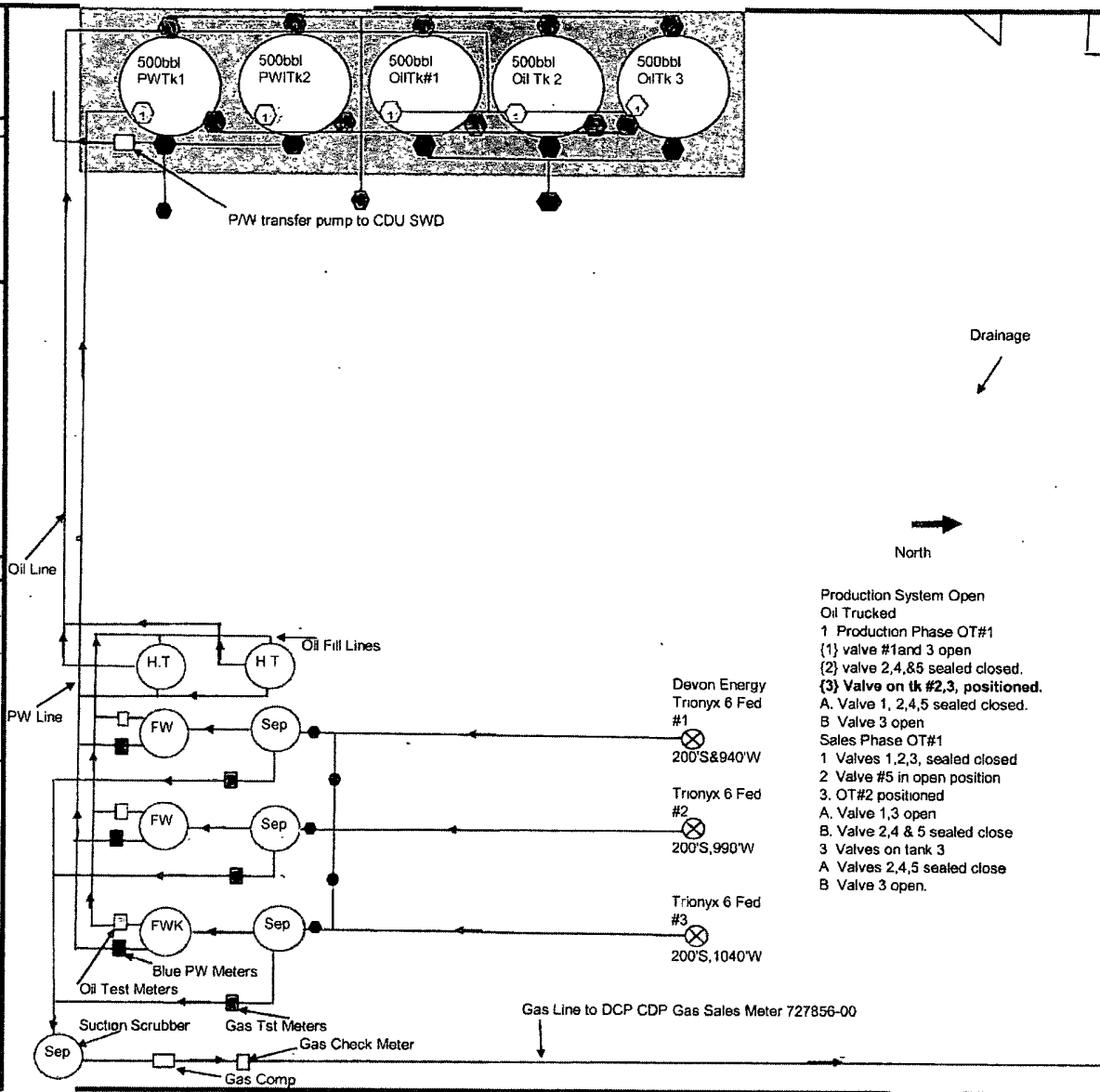

Production System Open  
 Oil Trucked  
 1 Production Phase OT#1  
 {1} valve #1 and 3 open  
 {2} valve 2,4, & 5 sealed closed.  
 {3} Valve on tk #2,3, positioned.  
 A. Valve 1, 2,4,5 sealed closed.  
 B Valve 3 open  
 Sales Phase OT#1  
 1 Valves 1,2,3, sealed closed  
 2 Valve #5 in open position  
 3. OT#2 positioned  
 A. Valve 1,3 open  
 B. Valve 2,4 & 5 sealed close  
 3 Valves on tank 3  
 A Valves 2,4,5 sealed close  
 B Valve 3 open.

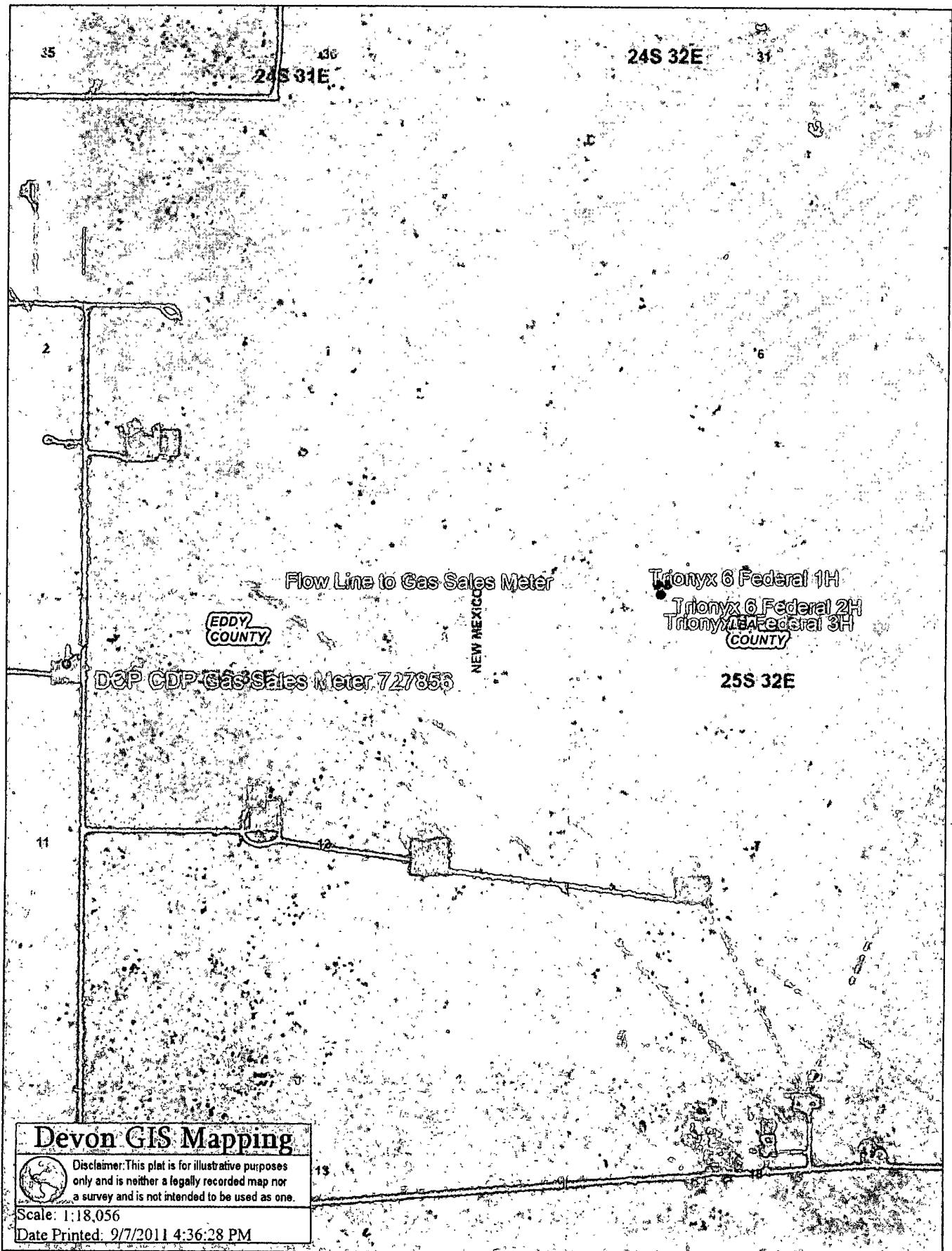

### Devon GIS Mapping



Disclaimer: This plot is for illustrative purposes only and is neither a legally recorded map nor a survey and is not intended to be used as one.

Scale: 1:18,056

Date Printed: 9/7/2011 4:36:28 PM



Sam McCurdy  
Landman

Devon Energy Corporation  
20 North Broadway  
Oklahoma City, Oklahoma 73102-8260  
Office: (405) 228-2406  
Fax: (405) 552-8113

August 22, 2011

New Mexico Oil Conservation Division  
1220 South St. Francis Drive  
Santa Fe, NM 87505

Re: Off Lease Measurement and Sales  
Section 6-T25S-R32E  
Lea Counties, NM

Gentlemen:

Devon Energy Production Company, L.P. ("Devon") recently reviewed its files covering United States Oil and Gas Lease LC-061863-A and has determined that the ownership of the working interest, royalty interest and overriding royalty interest in the following wells is uniform:

Trionyx 6 Federal 1H	API: 30-025-39948
Trionyx 6 Federal 2H	API: 30-025-39949
Trionyx 6 Federal 3H	API: 30-025- <del>39984</del>

40105

Please feel free to give me a call at (405) 228-2406 if you have any questions.

Yours very truly,

DEVON ENERGY PRODUCTION COMPANY, L.P

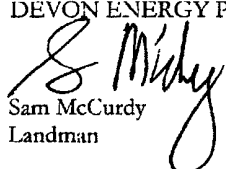
  
Sam McCurdy  
Landman



Devon Energy Production Company  
20 North Broadway – CT 3.058  
Oklahoma City, Oklahoma 73102-8260  
Phone (405)-552-5424  
Fax (405)-552-1358  
[Melanie.Crawford@dev.com](mailto:Melanie.Crawford@dev.com)

September 20, 2011

Mr. Richard Ezeanyim  
State of New Mexico  
Oil Conservation Division  
1220 S. St. Francis Drive  
Santa Fe, New Mexico 87505

**Re: Off Lease Gas Measurement, Sales, & Storage**  
**Trionyx 6 Federal 1H, Trionyx 6 Federal 2H, & Trionyx 6 Federal 3HY**  
**Sec 6-T25S-R32E**  
**NMLC-061863-A**  
**API # 30-025-39948, 30-025-39949, & 30-025-39984**  
**Wildcat; Bone Spring Pool Code: 96403 40105**  
**Lea County, New Mexico**

Dear Mr. Ezeanyim:

Please find attached the OCD Form C-103 and BLM Form 3160-5 Sundry Notice of Intent to Off Lease Gas Measurement, Sales, & Storage for the aforementioned wells.

The working interest, royalty interest and overriding royalty interest owners in both leases are uniform; no further notification is required.

Should you require any additional information or assistance, please do not hesitate to contact me at (405)-552-4524.

Very truly yours,

**DEVON ENERGY PRODUCTION COMPANY, L.P.**

A handwritten signature in black ink that reads "Melanie Crawford". The signature is written in a cursive, flowing style.

Melanie Crawford  
Regulatory Analyst

Enclosures



DATE IN	SUSPENSE	ENGINEER	LOGGED IN	TYPE	APP NO
---------	----------	----------	-----------	------	--------

ABOVE THIS LINE FOR DIVISION USE ONLY

## NEW MEXICO OIL CONSERVATION DIVISION

- Engineering Bureau -

1220 South St. Francis Drive, Santa Fe, NM 87505



### ADMINISTRATIVE APPLICATION CHECKLIST

THIS CHECKLIST IS MANDATORY FOR ALL ADMINISTRATIVE APPLICATIONS FOR EXCEPTIONS TO DIVISION RULES AND REGULATIONS WHICH REQUIRE PROCESSING AT THE DIVISION LEVEL IN SANTA FE

#### Application Acronyms:

[NSL-Non-Standard Location] [NSP-Non-Standard Proration Unit] [SD-Simultaneous Dedication]  
 [DHC-Downhole Commingling] [CTB-Lease Commingling] [PLC-Pool/Lease Commingling]  
 [PC-Pool Commingling] [OLS - Off-Lease Storage] [OLM-Off-Lease Measurement]  
 [WFX-Waterflood Expansion] [PMX-Pressure Maintenance Expansion]  
 [SWD-Salt Water Disposal] [IPI-Injection Pressure Increase]  
 [EOR-Qualified Enhanced Oil Recovery Certification] [PPR-Positive Production Response]

#### [1] TYPE OF APPLICATION - Check Those Which Apply for [A]

[A] Location - Spacing Unit - Simultaneous Dedication  
☐ NSL ☐ NSP ☐ SD

Check One Only for [B] or [C]

[B] Commingling - Storage - Measurement  
☐ DHC ☐ CTB ☐ PLC ☐ PC ☐ OLS ☒ OLM

[C] Injection - Disposal - Pressure Increase - Enhanced Oil Recovery  
☐ WFX ☐ PMX ☐ SWD ☐ IPI ☐ EOR ☐ PPR

[D] Other: Specify \_\_\_\_\_

#### [2] NOTIFICATION REQUIRED TO: - Check Those Which Apply, or ☐ Does Not Apply

[A] ☐ Working, Royalty or Overriding Royalty Interest Owners

[B] ☐ Offset Operators, Leaseholders or Surface Owner

[C] ☐ Application is One Which Requires Published Legal Notice

[D] ☒ Notification and/or Concurrent Approval by BLM or SLO  
 U S Bureau of Land Management - Commissioner of Public Lands, State Land Office

[E] ☐ For all of the above, Proof of Notification or Publication is Attached, and/or,

[F] ☐ Waivers are Attached

#### [3] SUBMIT ACCURATE AND COMPLETE INFORMATION REQUIRED TO PROCESS THE TYPE OF APPLICATION INDICATED ABOVE.

[4] **CERTIFICATION:** I hereby certify that the information submitted with this application for administrative approval is **accurate** and **complete** to the best of my knowledge. I also understand that **no action** will be taken on this application until the required information and notifications are submitted to the Division.

Note: Statement must be completed by an individual with managerial and/or supervisory capacity.

Melanie Crawford  
 Print or Type Name

*Melanie Crawford*  
 Signature

Regulatory Analyst  
 Title

9/20/11  
 Date

Melanie.Crawford@dvn.com  
 E-mail Address

Submit 3 Copies To Appropriate District  
Office  
District I  
1625 N. French Dr., Hobbs, NM 88240  
District II  
1301 W. Grand Ave., Artesia, NM 88210  
District III  
1000 Rio Brazos Rd., Aztec, NM 87410  
District IV  
1220 S. St. Francis Dr., Santa Fe, NM  
87505

State of New Mexico  
Energy, Minerals and Natural Resources

Form C-103  
May 27, 2004

OIL CONSERVATION DIVISION  
1220 South St. Francis Dr.  
Santa Fe, NM 87505

<b>SUNDRY NOTICES AND REPORTS ON WELLS</b> (DO NOT USE THIS FORM FOR PROPOSALS TO DRILL OR TO DEEPEN OR PLUG BACK TO A DIFFERENT RESERVOIR USE "APPLICATION FOR PERMIT" (FORM C-101) FOR SUCH PROPOSALS)		WELL API NO. See Below
1. Type of Well: Oil Well <input checked="" type="checkbox"/> Gas Well <input type="checkbox"/> Other <input type="checkbox"/>		5. Indicate Type of Lease FED <input checked="" type="checkbox"/> STATE <input type="checkbox"/> FEE <input type="checkbox"/>
2. Name of Operator Devon Energy Production Company, LP		6. State Oil & Gas Lease No. NMLC-061863-A
3. Address of Operator 20 North Broadway Oklahoma City, Oklahoma 73102-8260 (405) 552-4524		7. Lease Name or Unit Agreement Name See Below
4. Well Location Unit Letter _____ : _____ feet from the _____ line and _____ feet from the _____ line Section 6 Township 25S Range 32E NMPM Lea County New Mexico		8. Well Number See Below
11. Elevation (Show whether DR, RKB, RT, GR, etc ) n/a		9. OGRID Number 6137
Pit or Below-grade Tank Application <input type="checkbox"/> or Closure <input type="checkbox"/>		
Pit type _____ Depth to Groundwater _____ Distance from nearest fresh water well _____ Distance from nearest surface water _____		
Pit Liner Thickness: _____ mil Below-Grade Tank: Volume _____ bbls; Construction Material _____		

12. Check Appropriate Box to Indicate Nature of Notice, Report or Other Data

**NOTICE OF INTENTION TO:**  
PERFORM REMEDIAL WORK ☐ PLUG AND ABANDON ☐  
TEMPORARILY ABANDON ☐ CHANGE PLANS ☐  
PULL OR ALTER CASING ☐ MULTIPLE COMPL ☐  
OTHER: Off Lease Gas Measurement, Sales & Storage ☒

**SUBSEQUENT REPORT OF:**  
REMEDIAL WORK ☐ ALTERING CASING ☐  
COMMENCE DRILLING OPNS ☐ P AND A ☐  
CASING/CEMENT JOB ☐  
OTHER: ☐

13. Describe proposed or completed operations. (Clearly state all pertinent details, and give pertinent dates, including estimated date of starting any proposed work). SEE RULE 1103 For Multiple Completions: Attach wellbore diagram of proposed completion or recompletion.

Devon Energy Production Co., LLP respectfully requests for the Off Lease Gas Measurement, Sales, & Storage for the following wells:

Trionyx 6 Federal 1H, API: 30-025-39948  
Trionyx 6 Federal 2H, API: 30-025-39949  
Trionyx 6 Federal 3H, API: 30-025-39984

40105

This is a three well pad and the tank battery is located on the well pad location. All three wells will utilize this tank battery and will be the only wells at this time. The DCP CDP Gas Sales Meter 727856-00 is located in Sec 11, T25S, R31E, in Lea County, NM. All three wells will flow to the CDP and will be the only wells at this time utilizing the DCP CDP Gas Sales Meter 727856-00. There will be allocation gas, oil, and p/w meter for every well at the well and there will also be a gas check meter to check against the DCP CDP 727856-00 and it will be located at the Trionyx tank battery. **\*Will submit production and meter numbers once available**

The working interest, royalty interest and overriding royalty interest owners are uniformed; no additional notification is required.

ROW will or has already been obtained

I hereby certify that the information above is true and complete to the best of my knowledge and belief. I further certify that any pit or below-grade tank has been/will be constructed or closed according to NMOCD guidelines ☐, a general permit ☐ or an (attached) alternative OCD-approved plan ☐.

SIGNATURE: Melanie Crawford TITLE: Regulatory Analyst DATE: 9/20/11

Type or print name Melanie Crawford E-mail address: Melanie.Crawford@dmn.com Telephone No. (405) 552-4524  
For State Use Only

APPROVED BY: \_\_\_\_\_ TITLE \_\_\_\_\_ DATE \_\_\_\_\_

Conditions of Approval (if any):

**Bureau of Land Management  
Carlsbad Field Office  
620 East Greene Street  
Carlsbad, New Mexico 88220  
575-234-5972**

**Off-Lease Measurement**

**Conditions of Approval: Devon Energy Production Co.  
Trionyx 6 Federal 1H, 2H & 3HY**

Approval of off-lease measurement is subject to the following conditions of approval:

1. This agency shall be notified of any change in sales method or location of the Sales point.
2. This agency shall be notified of any spill or discharge as required by NTL-3A. No gas may be vented without proper measurement and prior approval. Any gas vented must be flared.
3. This agency reserves the right to modify or rescind approval whenever it determines continued use of the approved method may adversely affect the surface or subsurface environments.
4. This approval is subject to like approval by the New Mexico Oil Conservation Division.
5. Additional wells and/or leases require additional approvals.
6. This approval does not constitute right-of-way approval for any off-lease activities. Within 30 days, an application for right-of-way approval must be submitted to the Realty Section if not already done.
7. Approval for off-lease measurement from various sources is a privilege which is granted to lessees for the purpose of aiding conservation and extending the economic life of leases. Applicants should be cognizant that failure to operate in accordance with the provisions outlined in the Authorized Officer's conditions of approval and/or subsequent stipulations or modifications will subject such approval to revocation.
8. All above-ground structures not subject to safety requirements shall be painted by the holder to blend with the natural color of the landscape. The paint used shall be color which simulates "standard Environmental Colors" – Shale Green, Munsell Soil Color No. 5Y 4/2.