

DISTRICT II
1301 W. Grand Avenue, Artesia, NM 88210

OIL CONSERVATION DIVISION
1220 South St. Frances Dr. HOBBS OCD
Santa Fe, NM 87505

OCT 24 2011

DISTRICT III
1000 Rio Brazos Rd., Aztec, NM 87410

DISTRICT IV
1220 S. St. Francis Dr., Santa Fe, NM 87505

☐ **AMENDED REPORT**

WELL LOCATION AND ACREAGE DEDICATION

API Number 30-025-40140	Pool Code 44560	Pool Name Maljamar; Yeso West
Property Code 38238	Property Name TOURMALINE STATE	Well Number 4
OGRID No. 217817	Operator Name CONOCOPHILLIPS	Elevation 4034'

Surface Location

UL or lot No.	Section	Township	Range	Lot Idn	Feet from the	North/South line	Feet from the	East/West line	County
0	16	17 S	32 E		990	SOUTH	1800	EAST	LEA

Bottom Hole Location If Different From Surface

UL or lot No. 0	Section	Township	Range	Lot Idn	Feet from the	North/South line	Feet from the	East/West line	County
Dedicated Acres 40	Joint or Infill	Consolidation Code		Order No.					

NO ALLOWABLE WILL BE ASSIGNED TO THIS COMPLETION UNTIL ALL INTERESTS HAVE BEEN CONSOLIDATED OR A NON-STANDARD UNIT HAS BEEN APPROVED BY THE DIVISION

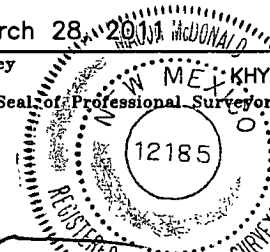
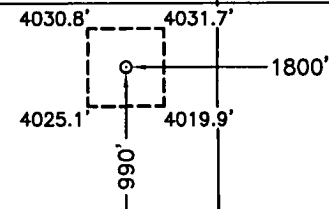
				<p align="center">OPERATOR CERTIFICATION</p> <p><i>I hereby certify the the information contained herein to true and complete to the best of my knowledge and belief, and that this organization either owns a working interest or unleased mineral interest in the land including the proposed bottom hole location or has a right to drill this well at this location pursuant to a contract with an owner of such a mineral or working interest, or to a voluntary pooling agreement or a compulsory pooling order heretofore entered by the division.</i></p> <p align="right"><i>Shonda Rogers</i> 10-20-11</p> <p>Signature _____ Date _____</p> <p><i>Shonda Rogers</i></p> <p>Printed Name _____</p>
				<p align="center">SURVEYOR CERTIFICATION</p> <p><i>I hereby certify that the well location shown on this plat was plotted from field notes of actual surveys made by me or under my supervision and that the same is true and correct to the best of my belief.</i></p> <p align="right">March 28, 2011</p> <p>Date of Survey _____</p>
		<p align="center"><u>Plane Coordinate</u> X = 673,589.1 Y = 666,122.3</p>		<p align="center">Signature & Seal of Professional Surveyor</p> <p align="center"><i>MacDonald</i></p> <p align="center">  </p>
<p>NOTE:</p> <p>1) Plane Coordinates shown hereon are Transverse Mercator Grid and Conform to the "New Mexico Coordinate System", New Mexico East Zone, North American Datum of 1927. Distances shown hereon are mean horizontal surface values.</p>				<p align="center">W.O. Num. 2011-0536</p> <p align="center">Certificate No. MACON McDONALD 12185</p>

OCT 25 2017

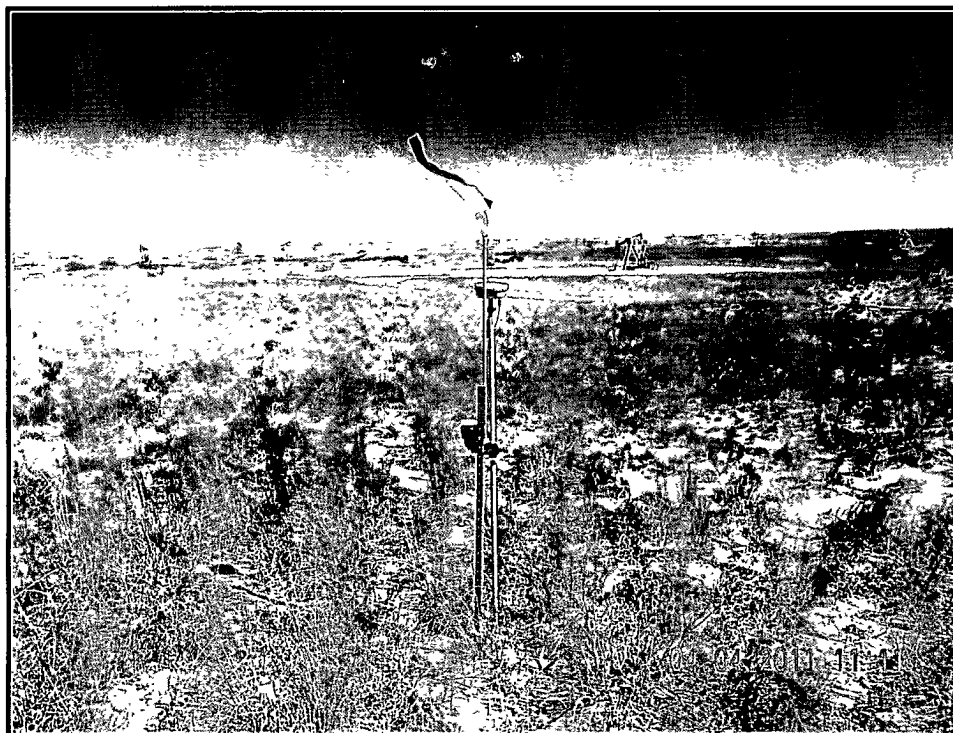

NORTHERLY VIEW TO LOCATION STAKE

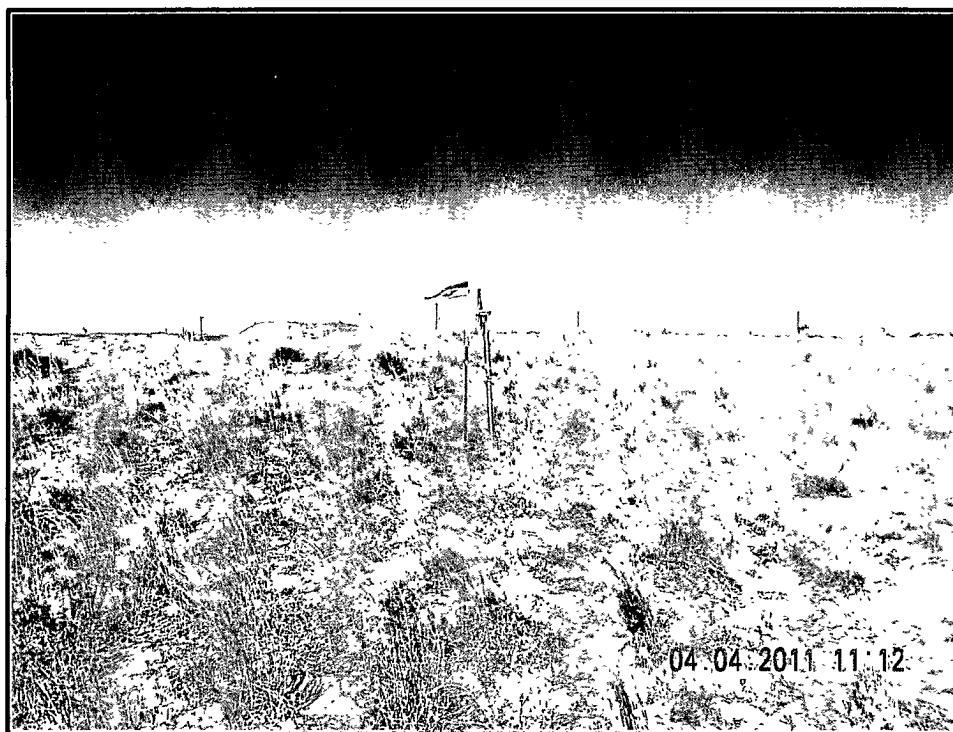

WESTERLY VIEW TO LOCATION STAKE

ConocoPhillips

TOURMALINE STATE #4

Located 990' FSL & 1800' FEL, Section 18
Township 17 South, Range 32 East, N.M.P.M.
Lea County, New Mexico

**WEST
COMPANY**
of Midland, Inc.

110 W. LOUISIANA, STE. 110
MIDLAND TEXAS, 79701
(432) 687-0865 - (432) 687-0868 FAX

Drawn By: KHY

Date: April 28, 2011

SECTION 16, TOWNSHIP 17 SOUTH, RANGE 32 EAST, N.M.P.M.

LEA COUNTY

NEW MEXICO

THIS IS NOT A BOUNDARY SURVEY
Apparent property corners and property lines, if shown,
are for information only.

L-2011-0536-A

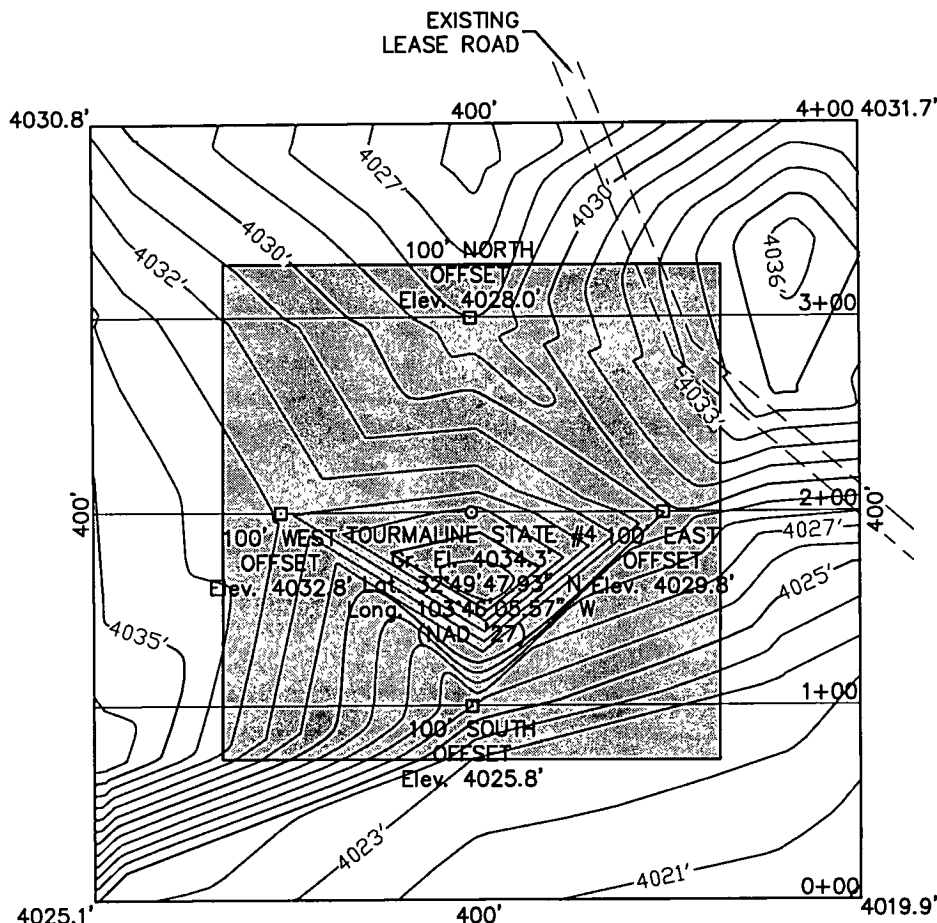

DRIVING DIRECTIONS

FROM THE INTERSECTION OF HIGHWAY 82 AND MALJAMAR ROAD. GO SOUTH ON MALJAMAR ROAD FOR 2.0 MILES. TURN WEST FOR 0.1 MILES. TURN NORTHWEST AND GO 0.3 MILES. LOCATION IS APPROXIMATELY 200 FEET TO THE WEST.

I HEREBY CERTIFY THAT THIS PLAT WAS MADE FROM AN ACTUAL SURVEY MADE BY ME OR UNDER MY DIRECT SUPERVISION AND THAT THE SAME IS TRUE AND CORRECT TO THE BEST OF MY KNOWLEDGE AND BELIEF.

MACON McDONALD

MACON McDONALD

PLS NO. 12185

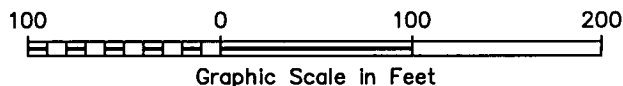

ConocoPhillips

Topographic Map

TOURMALINE STATE #4

Located 990' FSL & 1800' FEL, Section 16
Township 17 South, Range 32 East, N.M.P.M.
Lea County, New Mexico

Drawn By: KHY	Date: April 28, 2011
Scale: 1" = 100'	Field Book: 508 / 37-38
Sheet 1 of 3	Quadrangle: Maljamar
W.O. No: 2011-0536	Dwg. No.: L-2011-0536-A

**WEST
COMPANY**
of Midland, Inc.

110 W. LOUISIANA, STE. 110
MIDLAND TEXAS, 79701
(432) 687-0865 - (432) 687-0868 FAX

SECTION 16, TOWNSHIP 17 SOUTH, RANGE 32 EAST, N.M.P.M.

LEA COUNTY

NEW MEXICO

THIS IS NOT A BOUNDARY SURVEY
Apparent property corners and property lines, if shown,
are for information only.

L-2011-0536-B

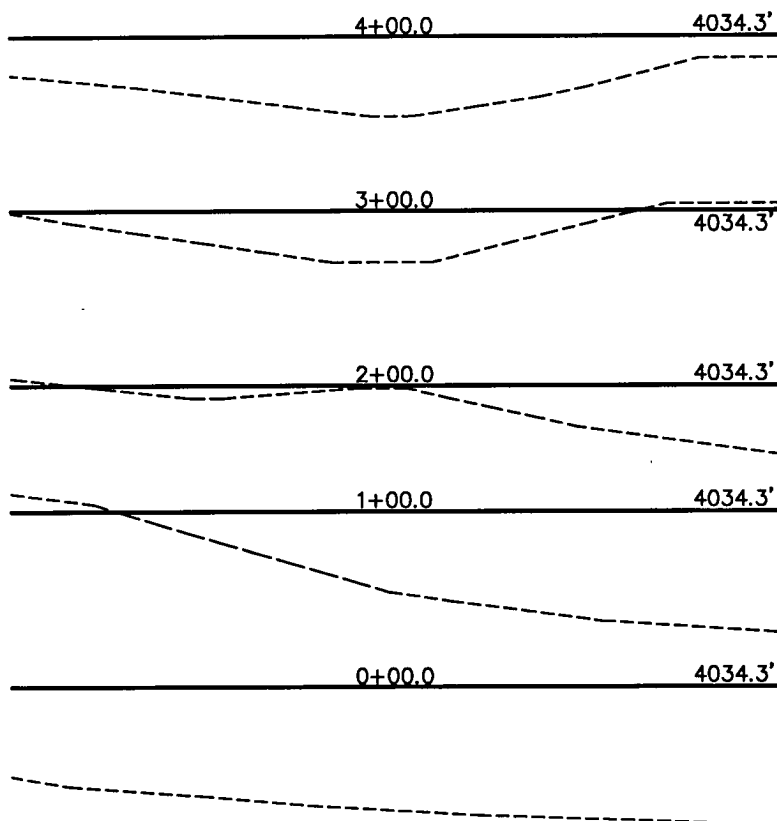

I HEREBY CERTIFY THAT THIS PLAT WAS MADE FROM AN ACTUAL SURVEY MADE BY ME OR UNDER MY DIRECT SUPERVISION AND THAT THE SAME IS TRUE AND CORRECT TO THE BEST OF MY KNOWLEDGE AND BELIEF.

Macon McDonald

MACON McDONALD

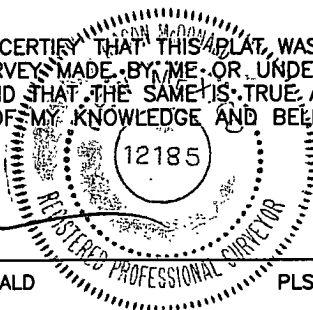

PLS NO. 12185



110 W. LOUISIANA, STE. 110
MIDLAND TEXAS, 79701
(432) 687-0865 - (432) 687-0868 FAX

ConocoPhillips

Topographic Map

TOURMALINE STATE #4

Located 990' FSL & 1800' FEL, Section 16
Township 17 South, Range 32 East, N.M.P.M.
Lea County, New Mexico

Drawn By: KHY	Date: April 28, 2011
Scale: 1" = 100'	Field Book: 508 / 37-38
Sheet 2 of 3	Quadrangle: Maljamar
W.O. No: 2011-0536	Dwg. No.: L-2011-0536-B

SECTION 16, TOWNSHIP 17 SOUTH, RANGE 32 EAST, N.M.P.M.

LEA COUNTY

THIS IS NOT A BOUNDARY SURVEY
Apparent property corners and property lines, if shown,
are for information only.

NEW MEXICO

L-2011-0536-C

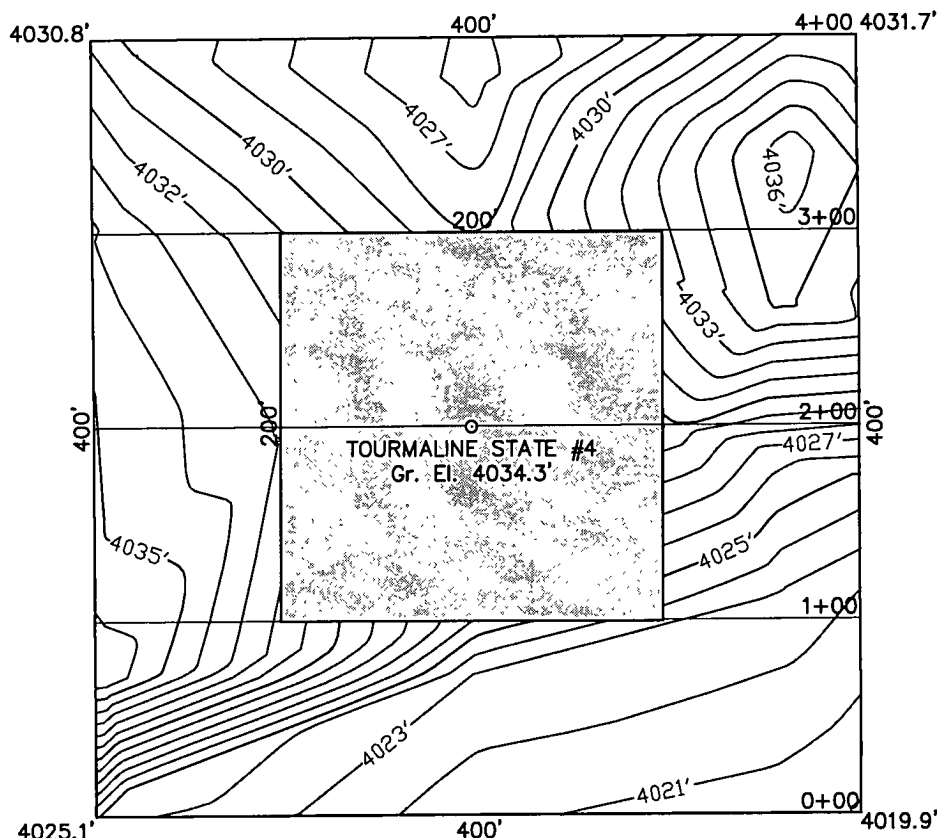

INTERIM RECLAMATION

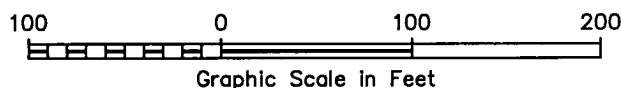

I HEREBY CERTIFY THAT THIS PLAT WAS MADE FROM
AN ACTUAL SURVEY MADE BY ME OR UNDER MY DIRECT
SUPERVISION AND THAT THE SAME IS TRUE AND CORRECT
TO THE BEST OF MY KNOWLEDGE AND BELIEF.

[Signature]

MACON McDONALD

PLS NO. 12185

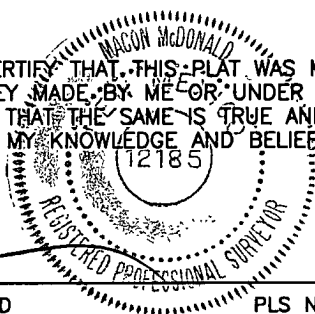

ConocoPhillips

Topographic Map

TOURMALINE STATE #4

Located 990' FSL & 1800' FEL, Section 16
Township 17 South, Range 32 East, N.M.P.M.
Lea County, New Mexico

Drawn By: KHY	Date: April 28, 2011
Scale: 1" = 100'	Field Book: 508 / 37-38
Sheet 3 of 3	Quadrangle: Maljamar
W.O. No: 2011-0536	Dwg. No.: L-2011-0536-C



110 W. LOUISIANA, STE. 110
MIDLAND TEXAS, 79701
(432) 687-0865 - (432) 687-0868 FAX

LOCATION VERIFICATION MAP

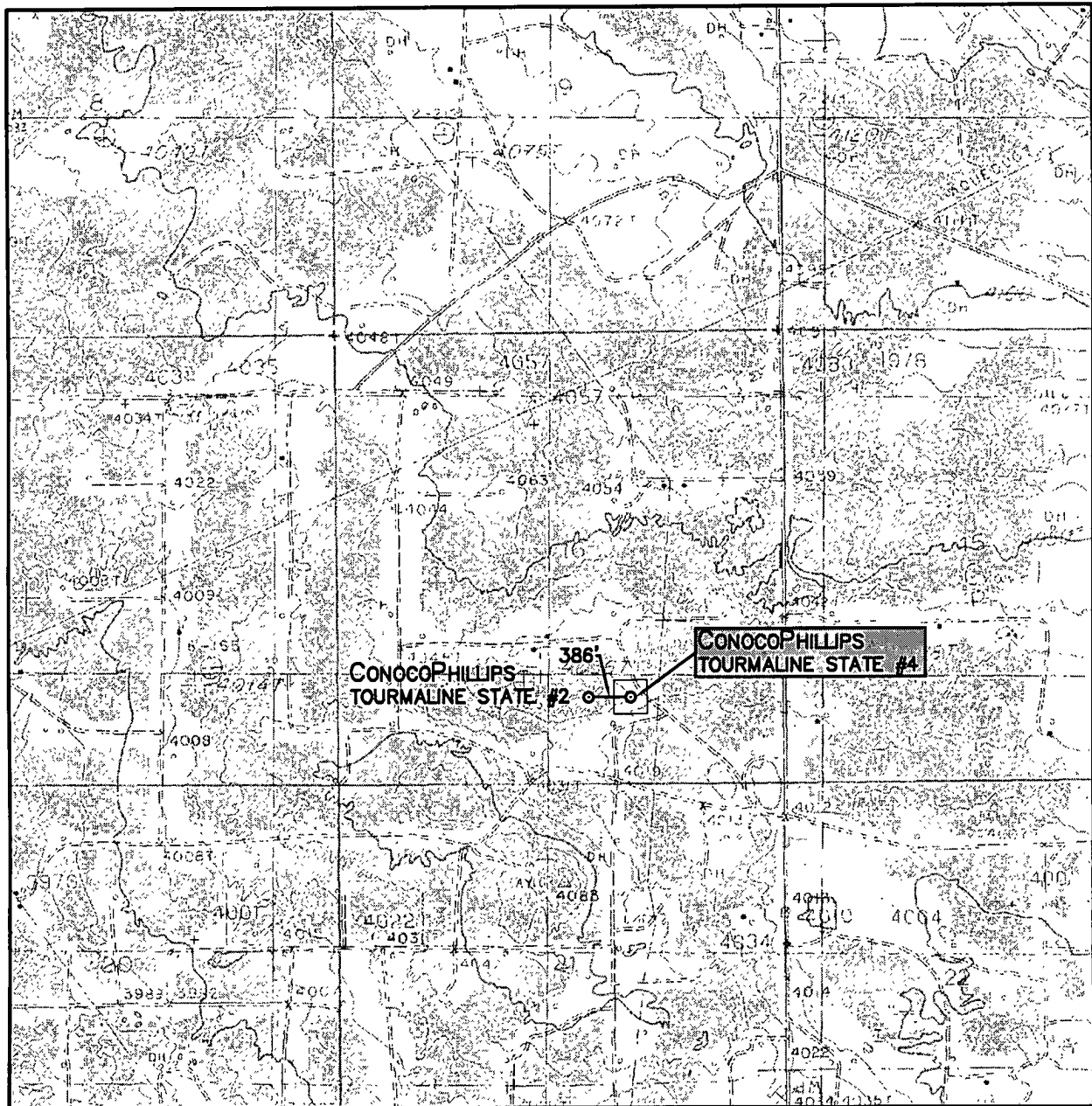

SCALE: 1" = 2000'

CONTOUR INTERVAL:
MALJAMAR - 5'

SEC. 16 TWP. 17-S RGE. 32-E

SURVEY N.M.P.M.

COUNTY LEA

DESCRIPTION 990' FSL & 1800' FEL

ELEVATION 4034'

OPERATOR CONOCOPHILLIPS

LEASE TOURMALINE STATE

U.S.G.S. TOPOGRAPHIC MAP
MALJAMAR



**WEST
COMPANY**
of Midland, Inc.

110 W. LOUISIANA, STE. 110
MIDLAND TEXAS, 79701
(432) 687-0865 - (432) 687-0868 FAX

VICINITY MAP

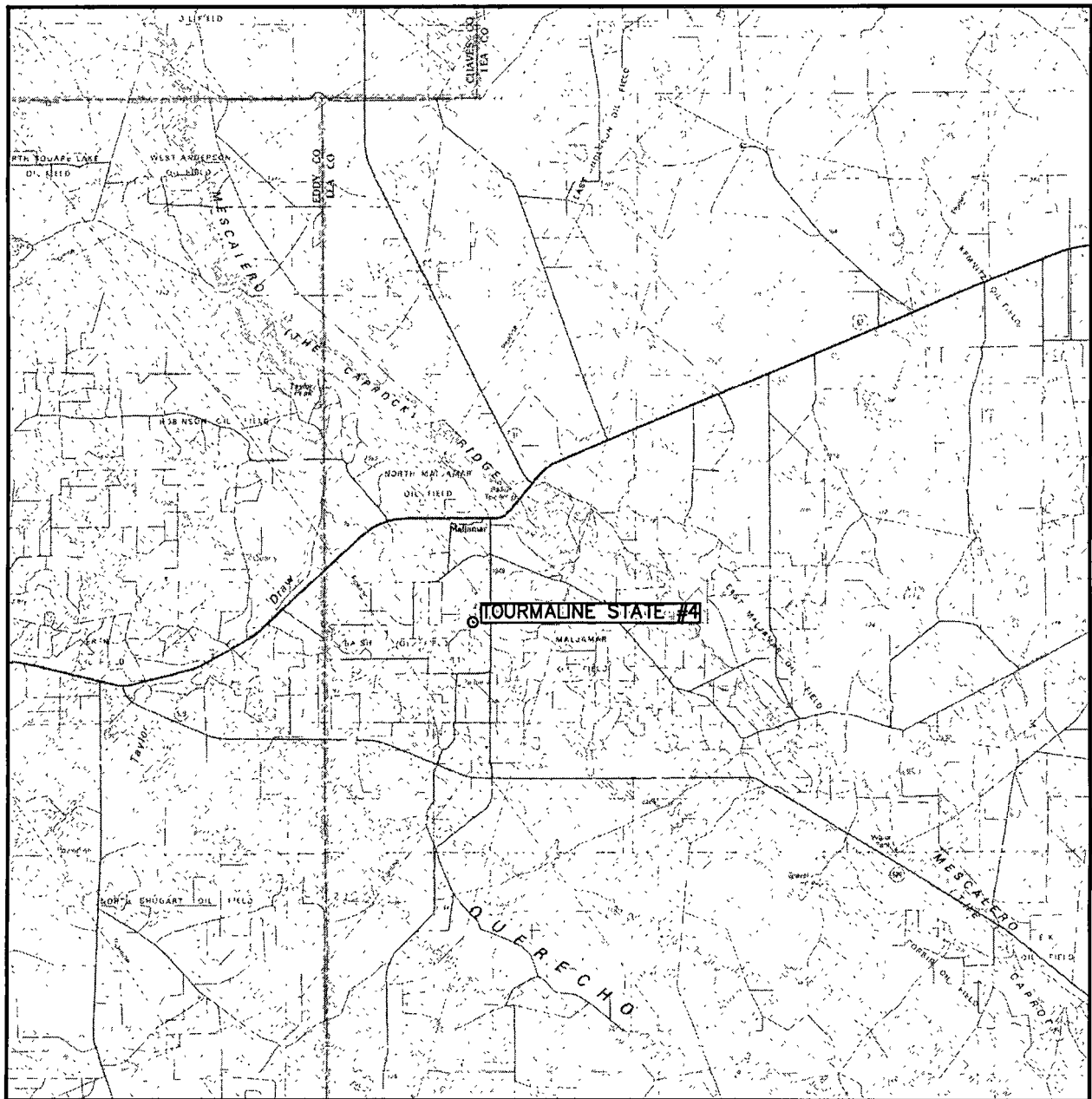

SCALE: 1" = 3 MILES

SEC. 16 TWP. 17-S RGE. 32-E

SURVEY N.M.P.M.

COUNTY LEA

DESCRIPTION 990' FSL & 1800' FEL

ELEVATION 4034'

OPERATOR CONOCOPHILLIPS

LEASE TOURMALINE STATE



110 W. LOUISIANA, STE. 110
MIDLAND TEXAS, 79701
(432) 687-0865 - (432) 687-0868 FAX