

District I
1625 N. French Dr., Hobbs, NM 88240
District II
1301 W. Grand Avenue, Artesia, NM 88210
District III
1000 Rio Brazos Road, Aztec, NM 87410
District IV
1220 S. St. Francis Dr., Santa Fe, NM 87505

State of New Mexico
Energy Minerals and Natural Resources

Form C-101
May 27, 2004

Oil Conservation Division
1220 South St. Francis Dr.
Santa Fe, NM 87505

Submit to appropriate District Office

☐ AMENDED REPORT

APPLICATION FOR PERMIT TO DRILL, RE-ENTER, DEEPEN, PLUGBACK, OR ADD A ZONE

¹ Operator Name and Address CHEVRON U.S.A. INC. 15 SMITH ROAD, MIDLAND, TEXAS 79705		² OGRID Number 4323 ✓
		³ API Number 30-025-37181
⁴ Property Code 30020 ✓	⁵ Property Name V. M. HENDERSON	⁶ Well No. 19 ✓
⁹ Proposed Pool 1 PENROSE SKELLY GRAYBURG 50350		¹⁰ Proposed Pool 2

7 Surface Location

UL or lot no. C	Section 30	Township 21-S	Range 37-E	Lot Idn	Feet from the 1300'	North/South line NORTH	Feet from the 2280'	East/West line WEST	County LEA
--------------------	---------------	------------------	---------------	---------	------------------------	---------------------------	------------------------	------------------------	---------------

8 Proposed Bottom Hole Location If Different From Surface

UL or lot no.	Section	Township	Range	Lot Idn	Feet from the	North/South line	Feet from the	East/West line	County
---------------	---------	----------	-------	---------	---------------	------------------	---------------	----------------	--------

Additional Well Information

¹¹ Work Type Code N	¹² Well Type Code O	¹³ Cable/Rotary ROTARY	¹⁴ Lease Type Code P ✓	Ground Level Elevation 3493'
¹⁶ Multiple N	¹⁷ Proposed Depth 4350'	¹⁸ Formation GRAYBURG	¹⁹ Contractor	²⁰ Spud Date 5-30-2005
Depth to Groundwater		Distance from nearest fresh water well		Distance from nearest surface water
Pit: Liner: Synthetic <input type="checkbox"/> _____mils thick Clay <input type="checkbox"/> Pit Volume: _____bbls Drilling Method:				
Closed-Loop System <input type="checkbox"/> SEE C-144 Fresh Water <input type="checkbox"/> Brine <input type="checkbox"/> Diesel/Oil-based <input type="checkbox"/>				

21 Proposed Casing and Cement Program

Hole Size	Casing Size	Casing weight/foot	Setting Depth	Sacks of Cement	Estimated TOC
11"	8 5/8"	24#	400'	250 SX	CIRCULATE
7 7/8"	5 1/2"	15.5#	4350'	1000 SX	CIRCULATE

²² Describe the proposed program. If this application is to DEEPEN or PLUG BACK, give the data on the present productive zone and proposed new productive zone.

Describe the blowout prevention program, if any. Use additional sheets if necessary.

SURFACE CASING: 250 SX CL C CMT W/2% CACL + 0.25 PPS CELLOFLAKE (J-55 ST&C)

SLURRY PROPERTIES: 14.8 PPG, 1.34 FT3/SK, 6.29 GPS MIX WATER

PRODUCTION CASING: LEAD IN W/600 SX (35:65) POZ (FLY ASH) CLASS C CMT W/6% BENTONITE + 5% SODIUM CHLORIDE + 0.25 PPS CELLOFLAKE

CELLOFLAKE + 0.4% FLUID LOSS ADDITIVE (J-55 LT&C)

TAIL IN W/400 SX (50:50) POZ (FLY ASH) CLASS C CMT W/5% SODIUM CHLORIDE + 2% BENTONITE + 0.25 PPS CELLOFLAKE

SLURRY PROPERTIES: 12.4 PPG, 2.15 FT3/SK, 11.97 GPS MIX WATER & 14.2 PPG, 1.35 FT3/SX, 6.33 GPS MIX WATER

BOP PROGRAM: SEE ATTACHED DIAGRAM

REFERENCE ORDER NUMBER: NSL-5185 (attached)

**Permit Expires 1 Year From Approval
Date Unless Drilling Underway**

NSL-5185

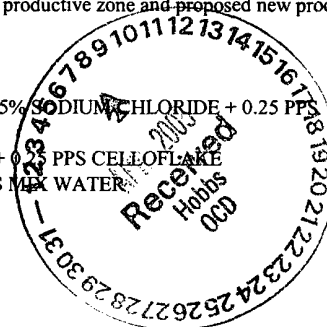

²³ I hereby certify that the information given above is true and complete to the best of my knowledge and belief. I further certify that the drilling pit will be constructed according to NMOCD guidelines ☒ a general permit ☐ or an (attached) alternative OCD-approved plan ☐.

Printed name: DENISE PINKERTON

Title: REGULATORY SPECIALIST

E-mail Address: LEAKEJD@CHEVRONTXACO.COM

Date: 4-05-2005

Phone: 432-687-7375

OIL CONSERVATION DIVISION

Approved by:

Title: PETROLEUM ENGINEER

Approval Date:

Expiration Date:

APR 11 2005

Conditions of Approval Attached ☐

BOP

CAPSTAR #12

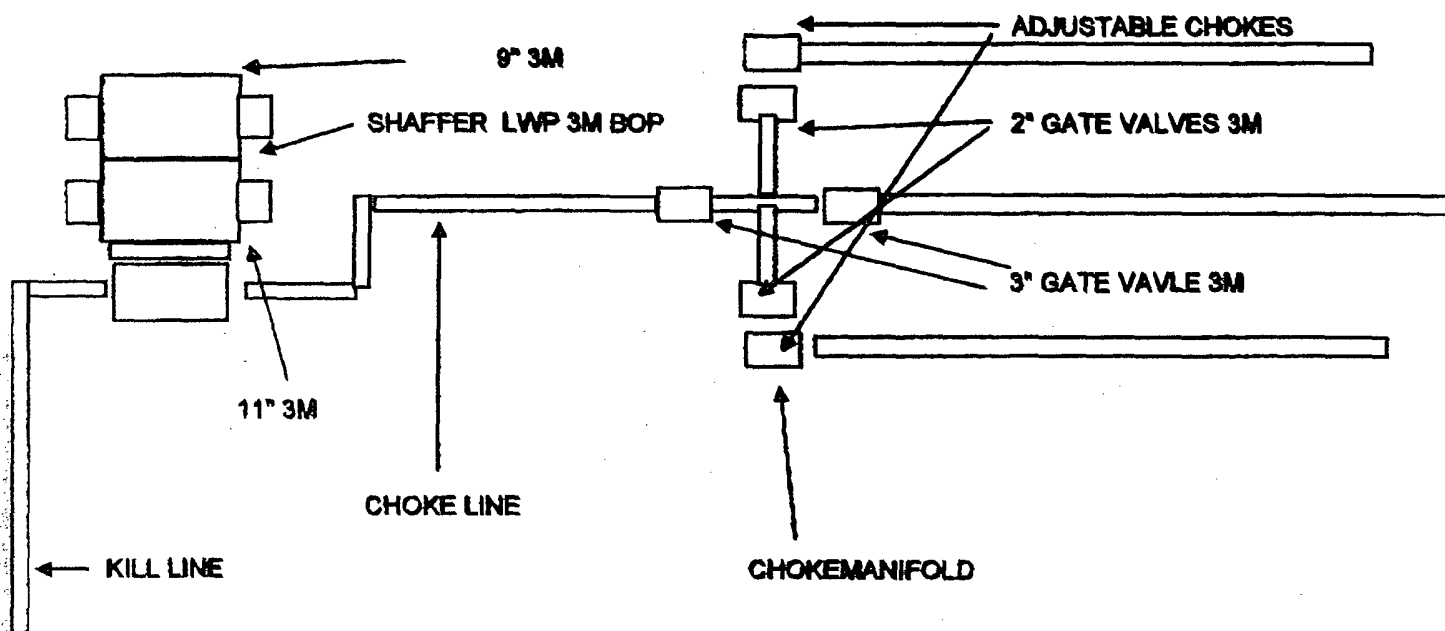

SECTION 30, TOWNSHIP 21 SOUTH, RANGE 37 EAST, N.M.P.M.,
 LEA COUNTY, NEW MEXICO

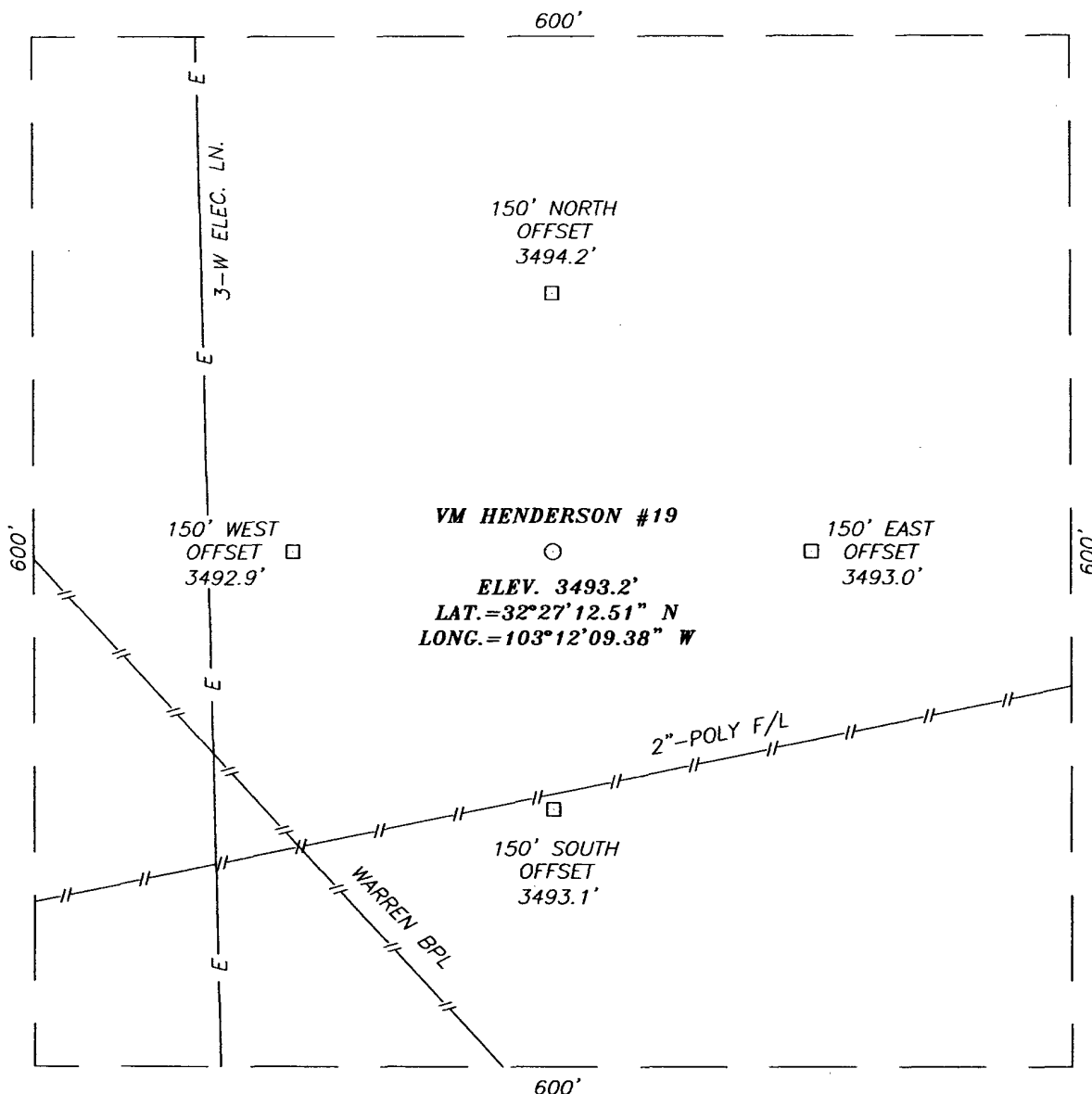

DIRECTIONS TO LOCATION

TURN RIGHT (NORTH) AT MILEPOST #2 ON ST. HWY. #8 AND GO APPROX. 0.6 MILES. TURN LEFT (NW) AND GO APPROX. 0.1 MILES. TURN LEFT (WEST) AND GO APPROX. 0.5 MILES. PROPOSED LOCATION IS APPROX. 800' NORTH.

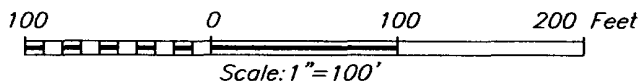

CHEVRON U.S.A., INC.

VM HENDERSON #19 WELL
 LOCATED 1300 FEET FROM THE NORTH LINE
 AND 2280 FEET FROM THE WEST LINE OF SECTION 30,
 TOWNSHIP 21 SOUTH, RANGE 37 EAST, N.M.P.M.,
 LEA COUNTY, NEW MEXICO.

Survey Date: 1/11/05	Sheet 1 of 1 Sheets
W.O. Number: 04.11.1716	Dr By: J.R.
Date: 1/13/05	Disk: CD#5
04111716	Scale: 1"=100'

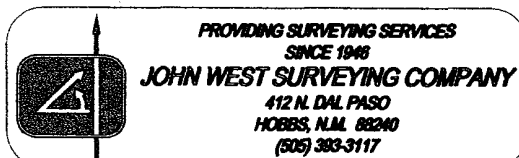

LOCATION VERIFICATION MAP

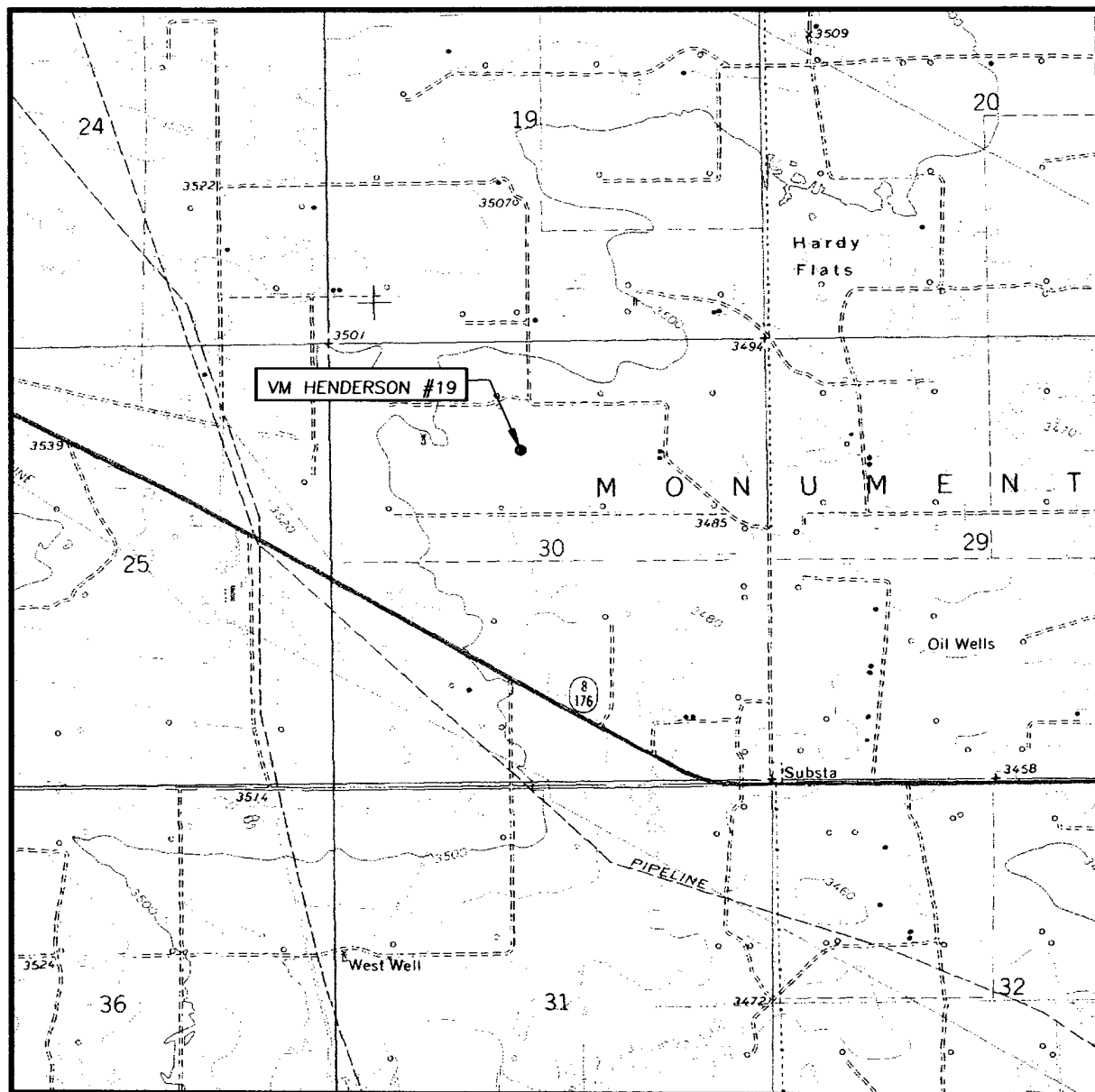

SCALE: 1" = 2000'

CONTOUR INTERVAL:
EUNICE, N.M. - 10'

SEC. 30 TWP. 21-S RGE. 37-E

SURVEY N.M.P.M.

COUNTY LEA

DESCRIPTION 1300' FNL & 2280' FWL

ELEVATION 3493'

OPERATOR CHEVRON U.S.A., INC.

LEASE VM HENDERSON

U.S.G.S. TOPOGRAPHIC MAP
EUNICE, N.M.

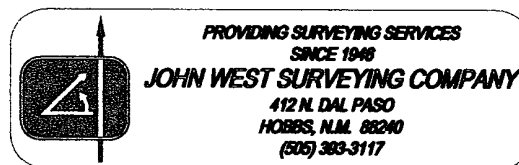

VICINITY MAP

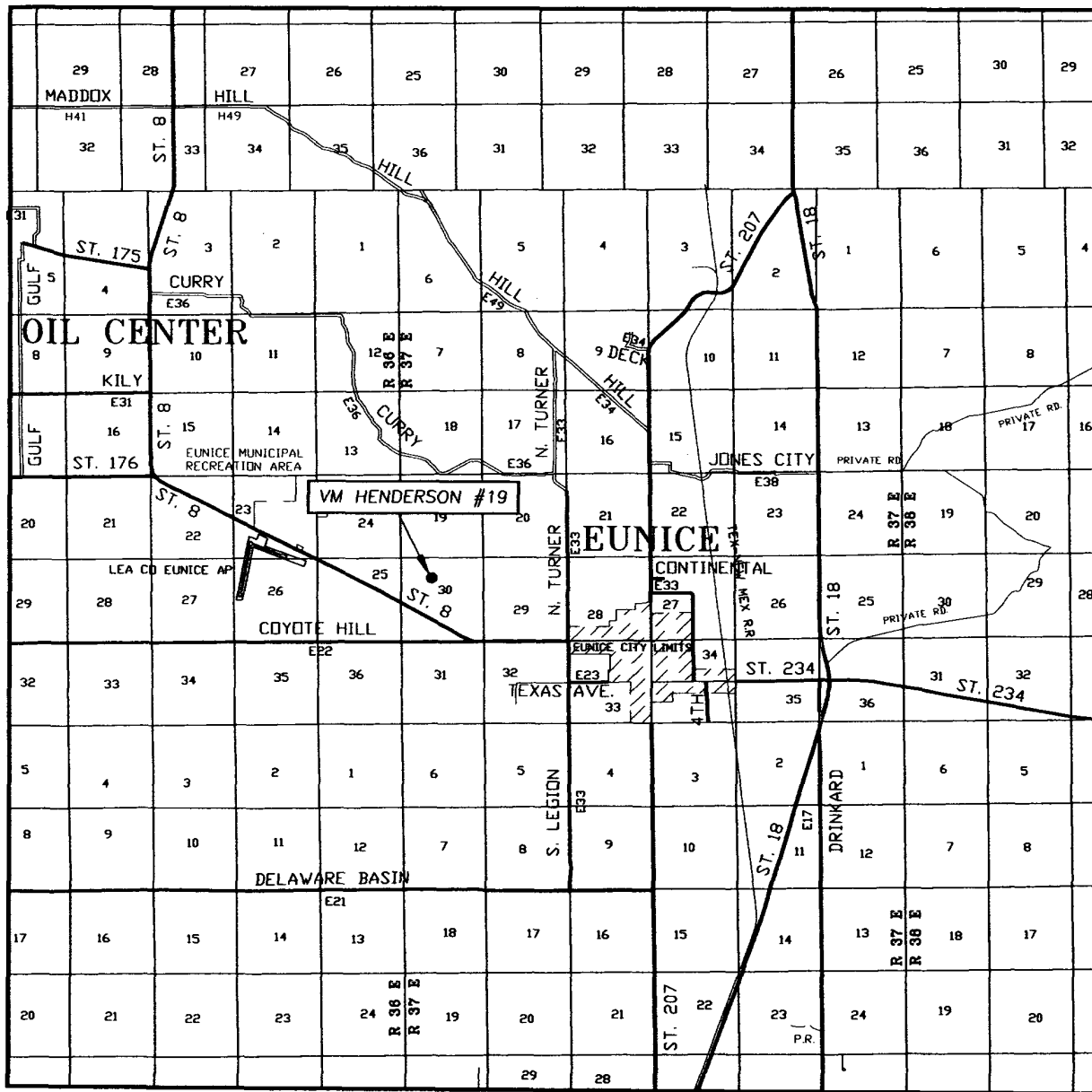

SCALE: 1" = 2 MILES

SEC. 30 TWP. 21-S RGE. 37-E
 SURVEY N.M.P.M.
 COUNTY LEA
 DESCRIPTION 1300' FNL & 2280' FWL
 ELEVATION 3493'
 OPERATOR CHEVRON U.S.A., INC.
 LEASE VM HENDERSON

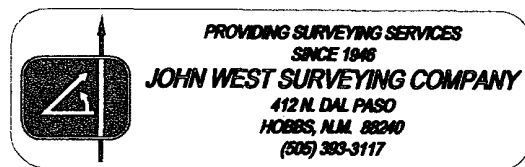

District I
1625 N. French Dr., Hobbs, NM 88240
District II
1301 W. Grand Avenue, Artesia, NM 88210
District III
1000 Rio Brazos Road, Aztec, NM 87410
District IV
1220 S. St. Francis Dr., Santa Fe, NM 87505

State of New Mexico
Energy Minerals and Natural Resources

Form C-144
June 1, 2004

Oil Conservation Division
1220 South St. Francis Dr.
Santa Fe, NM 87505

For drilling and production facilities, submit to appropriate NMOCD District Office.
For downstream facilities, submit to Santa Fe office

Pit or Below-Grade Tank Registration or Closure

Is pit or below-grade tank covered by a "general plan"? Yes ☐ No ☐

Type of action: Registration of a pit or below-grade tank ☒ Closure of a pit or below-grade tank ☐

Operator: CHEVRON U.S.A. INC. Telephone: 432-687-7375 e-mail address: LEAKEJD@CHEVRONTXACO.COM

Address: 15 SMITH ROAD, MIDLAND, TEXAS 79705

Facility or well name: V. M. HENDERSON #19 API #: 30-025-37181 U/L or Qtr/Qtr C Sec 30 T 21-S R 37-E

County: LEA Latitude 32 27' 12.51" N Longitude 103 12' 09.38" W NAD: 1927

Surface Owner: Private

Pit Type: Drilling Lined <input type="checkbox"/> Liner type: Synthetic <input type="checkbox"/> Thickness 20 mil Pit Volume 4106 bbl ✓	Below-grade tank Volume: _____ bbl Type of fluid: _____ Construction material: _____ Double-walled, with leak detection? Yes <input type="checkbox"/> If not, explain why not. _____
Depth to ground water (vertical distance from bottom of pit to seasonal high water elevation of ground water.)	Less than 50 feet (20 points) 50 feet or more, but less than 100 feet (10 points) 100 feet or more (0 points)
Wellhead protection area: (Less than 200 feet from a private domestic water source, or less than 1000 feet from all other water sources.)	Yes (20 points) No (0 points)
Distance to surface water: (horizontal distance to all wetlands, playas, irrigation canals, ditches, and perennial and ephemeral watercourses.)	Less than 200 feet (20 points) 200 feet or more, but less than 1000 feet (10 points) 1000 feet or more (0 points)
Ranking Score (Total Points) 10	

If this is a pit closure: (1) Attach a diagram of the facility showing the pit's relationship to other equipment and tanks. (2) Indicate disposal location: (check the onsite box if you are burying in place) onsite ☐ offsite ☐ If offsite, name of facility _____. (3) Attach a general description of remedial action taken including remediation start date and end date. (4) Groundwater encountered: No ☐ Yes ☐ If yes, show depth below ground surface _____ ft. and attach sample results.

(5) Attach soil sample results and a diagram of sample locations and excavations.

Additional Comments:

I hereby certify that the information above is true and complete to the best of my knowledge and belief. I further certify that the above-described pit or below-grade tank has been/will be constructed or closed according to NMOCD guidelines ☒, a general permit ☐, or an (attached) alternative OCD-approved plan ☐.

Date: 4-05-2005

Printed Name/Title MARK GARZA DRILLING ENGINEER

Signature

Your certification and NMOCD approval of this application/closure does not relieve the operator of liability should the contents of the pit or tank contaminate ground water or otherwise endanger public health or the environment. Nor does it relieve the operator of its responsibility for compliance with any other federal, state, or local laws and/or regulations.

Approval:

Printed Name/Title

Signature

ORIGINAL SIGNED BY
PAUL F. KAUTZ
PETROLEUM ENGINEER

Date:

APR 11 2005

CapStar #16 Pit Design

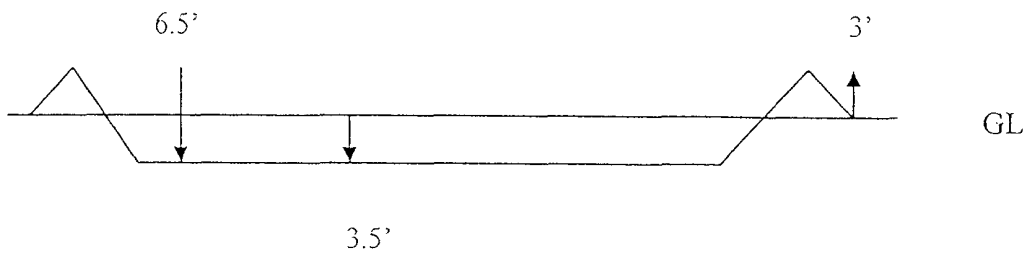
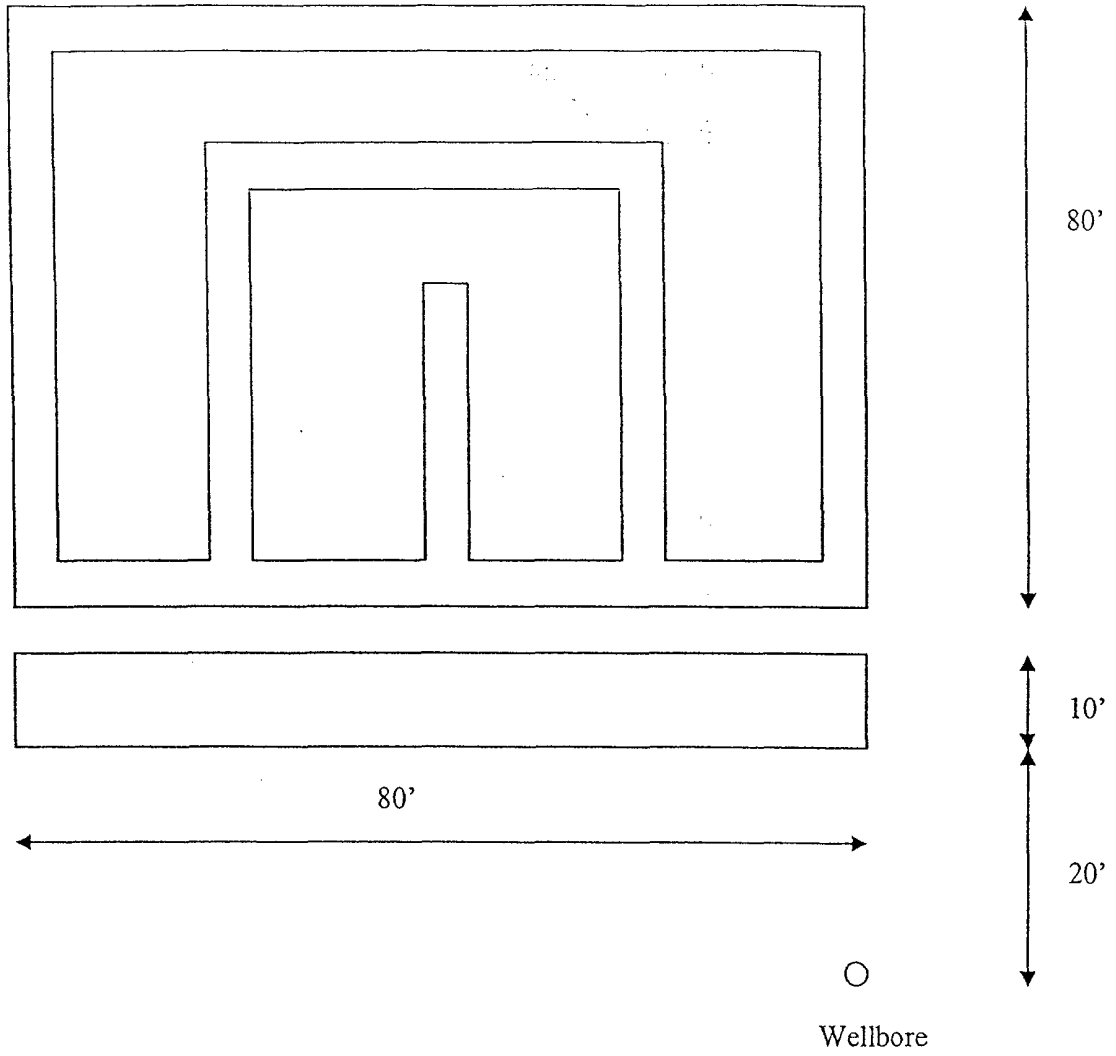

State of New Mexico

Energy, Minerals and Natural Resources Department

DISTRICT I

1625 N. FRENCH DR., HOBBS, NM 88240

DISTRICT II

1301 W. GRAND AVENUE, ARTESIA, NM 88210

DISTRICT III

1000 Rio Brazos Rd., Aztec, NM 87410

DISTRICT IV

1220 S. ST. FRANCIS DR., SANTA FE, NM 87505

OIL CONSERVATION DIVISION

1220 SOUTH ST. FRANCIS DR.
Santa Fe, New Mexico 87505

Form C-102

Revised JUNE 10, 2003

Submit to Appropriate District Office

State Lease - 4 Copies

Fee Lease - 3 Copies

WELL LOCATION AND ACREAGE DEDICATION PLAT

☐ AMENDED REPORT

API Number 30.025.37181	Pool Code 50350	Pool Name Penrose S Kelly Grayburg
Property Code 30020	Property Name VM HENDERSON	Well Number 19
OGRID No. 4323	Operator Name CHEVRON U.S.A., INC.	Elevation 3493'

Surface Location

UL or lot No.	Section	Township	Range	Lot Idn	Feet from the	North/South line	Feet from the	East/West line	County
C	30	21-S	37-E		1300	NORTH	2280	WEST	LEA

Bottom Hole Location If Different From Surface

UL or lot No.	Section	Township	Range	Lot Idn	Feet from the	North/South line	Feet from the	East/West line	County
Dedicated Acres 40	Joint or Infill	Consolidation Code	Order No. NSL-5185						

NO ALLOWABLE WILL BE ASSIGNED TO THIS COMPLETION UNTIL ALL INTERESTS HAVE BEEN CONSOLIDATED
OR A NON-STANDARD UNIT HAS BEEN APPROVED BY THE DIVISION

	<h3>OPERATOR CERTIFICATION</h3> <p>I hereby certify the the information contained herein is true and complete to the best of my knowledge and belief.</p> <p><i>Denise Pinkerton</i> Signature Denise Pinkerton Printed Name Regulatory Specialist Title 4-05-2005 Date</p> <h3>SURVEYOR CERTIFICATION</h3> <p>I hereby certify that the well location shown on this plat was plotted from field notes of actual surveys made by me or under my supervision, and that the same is true and correct to the best of my belief.</p> <p>JANUARY 11, 2005</p> <p>Date Surveyed JR</p> <p>Signature & Seal of Professional Surveyor GARY G. EIDSON 0426411716 REGISTERED PROFESSIONAL SURVEYOR Certificate No. GARY EIDSON 12641</p>
--	--