

District I  
1625 N. French Dr., Hobbs, NM 88240  
District II  
1301 W. Grand Avenue, Artesia, NM 88210  
District III  
1000 Rio Brazos Road, Aztec, NM 87410  
District IV  
1220 S. St. Francis Dr., Santa Fe, NM 87505

State of New Mexico  
Energy Minerals and Natural Resources

Form C-101  
May 27, 2004

Oil Conservation Division  
1220 South St. Francis Dr.  
Santa Fe, NM 87505

Submit to appropriate District Office

☐ AMENDED REPORT

**APPLICATION FOR PERMIT TO DRILL, RE-ENTER, DEEPEN, PLUGBACK, OR ADD A ZONE**

<sup>1</sup> Operator Name and Address CHEVRON U.S.A. INC. 15 SMITH ROAD, MIDLAND, TEXAS 79705		<sup>2</sup> OGRID Number 4323
<sup>3</sup> Property Code 29965	<sup>4</sup> Property Name MITTIE WEATHERLY	<sup>5</sup> API Number 30-025-37188
<sup>9</sup> Proposed Pool 1 PENROSE SKELLY GRAYBURG 50350		<sup>10</sup> Proposed Pool 2

**7 Surface Location**

UL or lot no. C	Section 17	Township 21-S	Range 37-E	Lot Idn	Feet from the 1140'	North/South line NORTH	Feet from the 1690'	East/West line WEST	County LEA
--------------------	---------------	------------------	---------------	---------	------------------------	---------------------------	------------------------	------------------------	---------------

**8 Proposed Bottom Hole Location If Different From Surface**

UL or lot no.	Section	Township	Range	Lot Idn	Feet from the	North/South line	Feet from the	East/West line	County
---------------	---------	----------	-------	---------	---------------	------------------	---------------	----------------	--------

**Additional Well Information**

<sup>11</sup> Work Type Code N	<sup>12</sup> Well Type Code O	<sup>13</sup> Cable/Rotary ROTARY	<sup>14</sup> Lease Type Code P	<sup>15</sup> Ground Level Elevation 3477'
<sup>16</sup> Multiple N	<sup>17</sup> Proposed Depth 4350'	<sup>18</sup> Formation GRAYBURG	<sup>19</sup> Contractor	<sup>20</sup> Spud Date 7-17-2005
Depth to Groundwater		Distance from nearest fresh water well		Distance from nearest surface water
Pit: Liner: Synthetic <input type="checkbox"/> _____mils thick Clay <input type="checkbox"/> Pit Volume: _____bbls Drilling Method:				
Closed-Loop System <input type="checkbox"/> SEE C-144 Fresh Water <input type="checkbox"/> Brine <input type="checkbox"/> Diesel/Oil-based <input type="checkbox"/>				

**21 Proposed Casing and Cement Program**

Hole Size	Casing Size	Casing weight/foot	Setting Depth	Sacks of Cement	Estimated TOC
11"	8 5/8"	24#	400'	250 SX	CIRCULATE
7 7/8"	5 1/2"	15.5#	4350'	1000 SX	CIRCULATE

<sup>22</sup> Describe the proposed program. If this application is to DEEPEN or PLUG BACK, give the data on the present productive zone and proposed new productive zone.

Describe the blowout prevention program, if any. Use additional sheets if necessary.  
SURFACE CASING: 250 SX CL C CMT W/2% CACL + 0.25 PPS CELLOFLAKE (J-55 ST&C)

SLURRY PROPERTIES: 14.8 PPG, 1.34 FT3/SK, 6.29 GPS MIX WATER

PRODUCTION CASING: LEAD IN W/600 SX (35:65) POZ (FLY ASH) CLASS C CMT W/6% BENTONITE + 5% SODIUM CHLORIDE + 0.25 PPS CELLOFLAKE + 0.4% FLUID LOSS ADDITIVE (J-55 LT&C)

SLURRY PROPERTIES: 12.4 PPG, 2.15 FT3/SK, 11.97 GPS MIX WATER & 14.2 PPG, 1.35 FT3/SK, 6.33 GPS MIX WATER

BOP PROGRAM: SEE ATTACHED DIAGRAM

REFERENCE ORDER NO. NSL-5189 (SD)

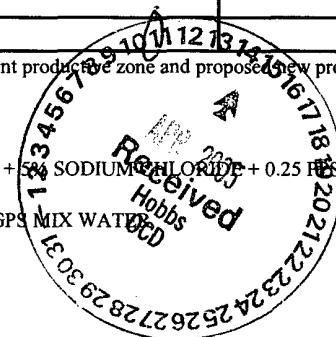

**OIL CONSERVATION DIVISION**

Approved by:

*PETROLEUM ENGINEER*

Title:

*PETROLEUM ENGINEER*

Approval Date: **APR 11 2005**

Expiration Date:

Printed name: DENISE PINKERTON

*Denise Pinkerton*

Title: REGULATORY SPECIALIST

E-mail Address: LEAKEJD@CHEVRONTXACO.COM

Date: 4-07-2005

Phone: 432 - 687-7375

Conditions of Approval Attached ☐

BOP

CRAPSTAR #12

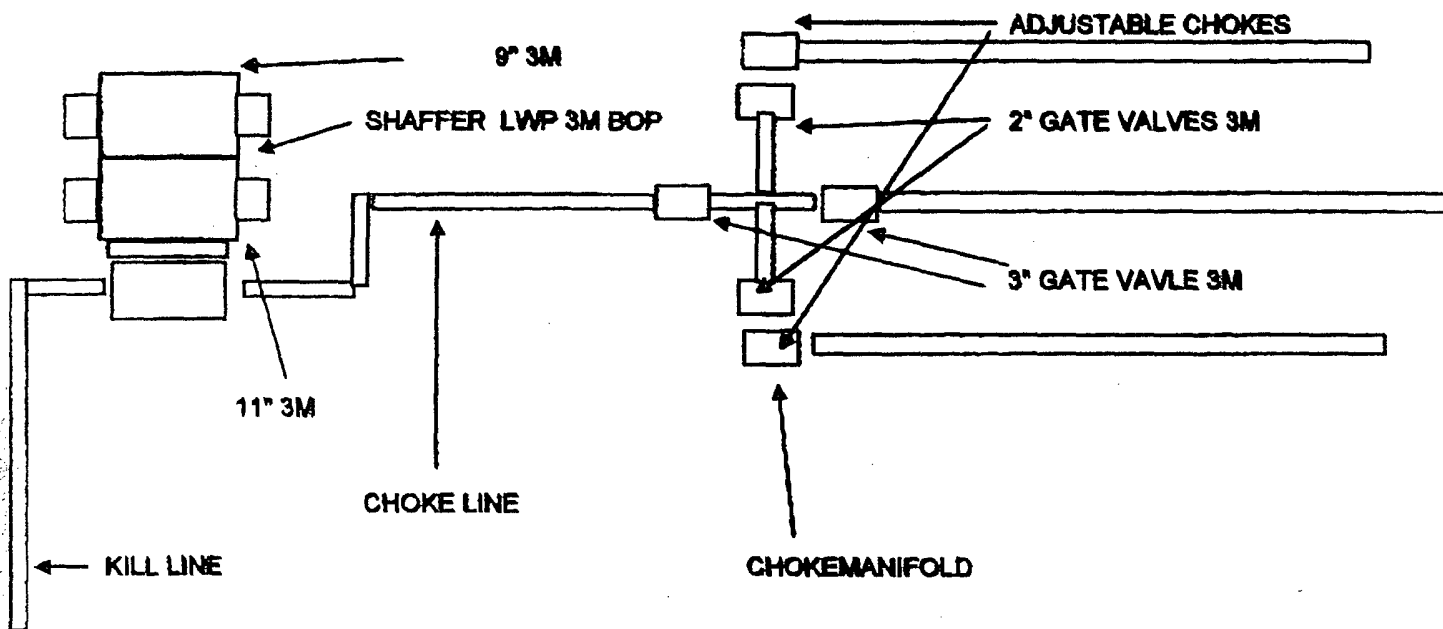

**SECTION 17, TOWNSHIP 21 SOUTH, RANGE 37 EAST, N.M.P.M.,**  
 LEA COUNTY, NEW MEXICO

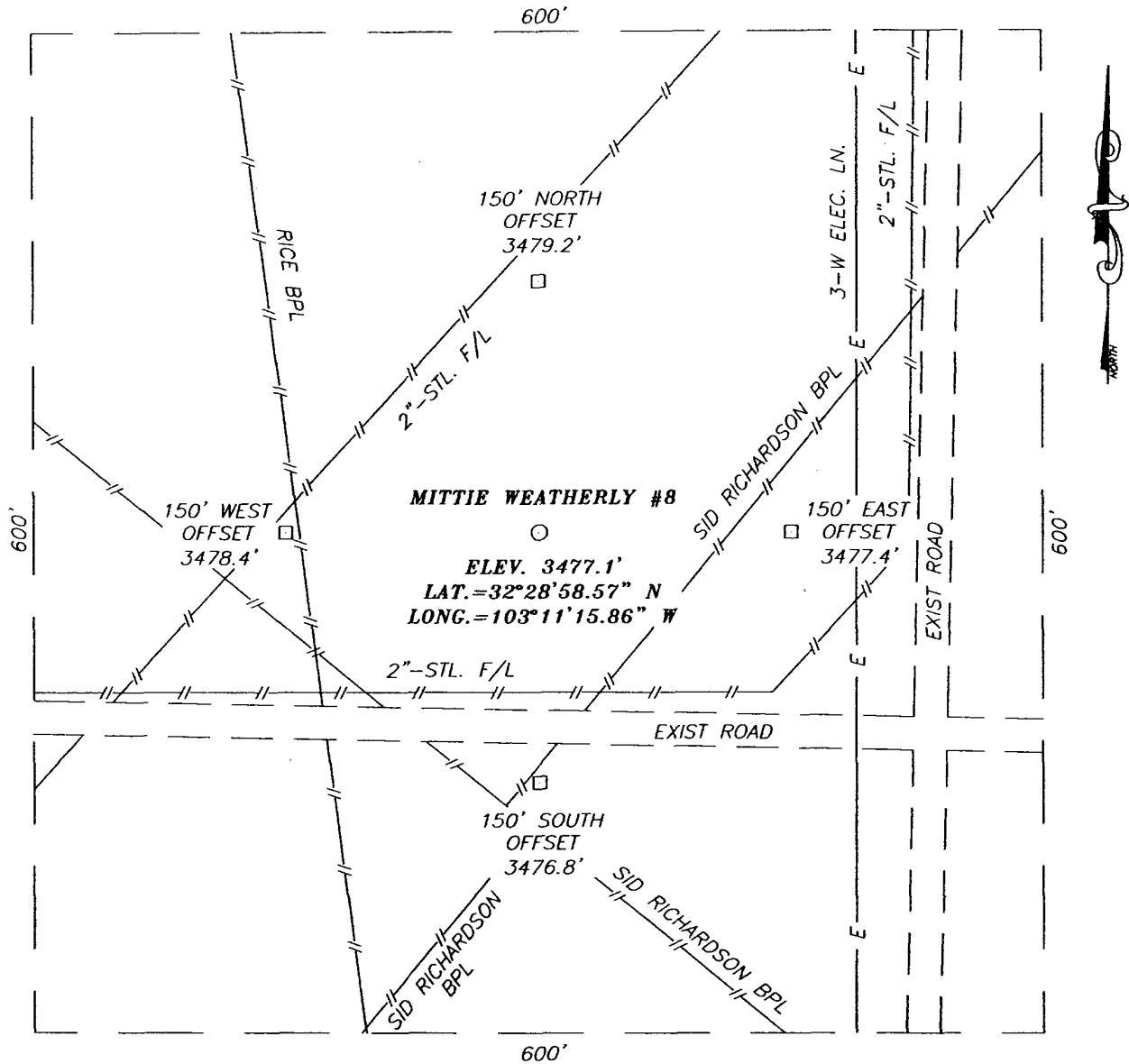

**DIRECTIONS TO LOCATION**

FROM THE INTERSECTION OF ST. HWY. #8 AND CO. RD. #33 (N. TURNER RD.) GO NORTH ON CO. RD. #33 FOR APPROX. 2.0 MILES. TURN LEFT (WEST) AND GO APPROX. 0.2 MILES. TURN RIGHT (NORTH) AND GO APPROX. 0.2 MILES. TURN LEFT (WEST) AND GO APPROX. 0.3 MILES. TURN RIGHT (NORTH) AND GO APPROX. 0.1 MILES. TURN LEFT (WEST) AND GO APPROX. 0.4 MILES. PROPOSED LOCATION IS APPROX. 100' NORTH.

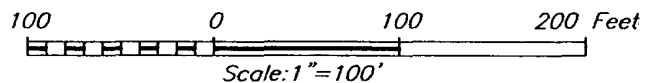

**CHEVRON U.S.A., INC.**

MITTIE WEATHERLY #8 WELL  
 LOCATED 1140 FEET FROM THE NORTH LINE  
 AND 1690 FEET FROM THE WEST LINE OF SECTION 17,  
 TOWNSHIP 21 SOUTH, RANGE 37 EAST, N.M.P.M.,  
 LEA COUNTY, NEW MEXICO.

Survey Date: 1/11/05	Sheet 1 of 1 Sheets
W.O. Number: 04.11.1718	Dr By: J.R.
Date: 1/13/05	Disk: CD#5
04111718	Scale: 1"=100'

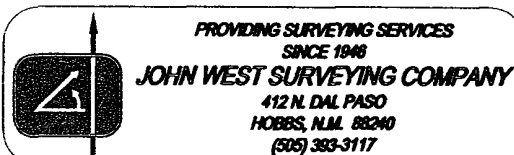

# VICINITY MAP

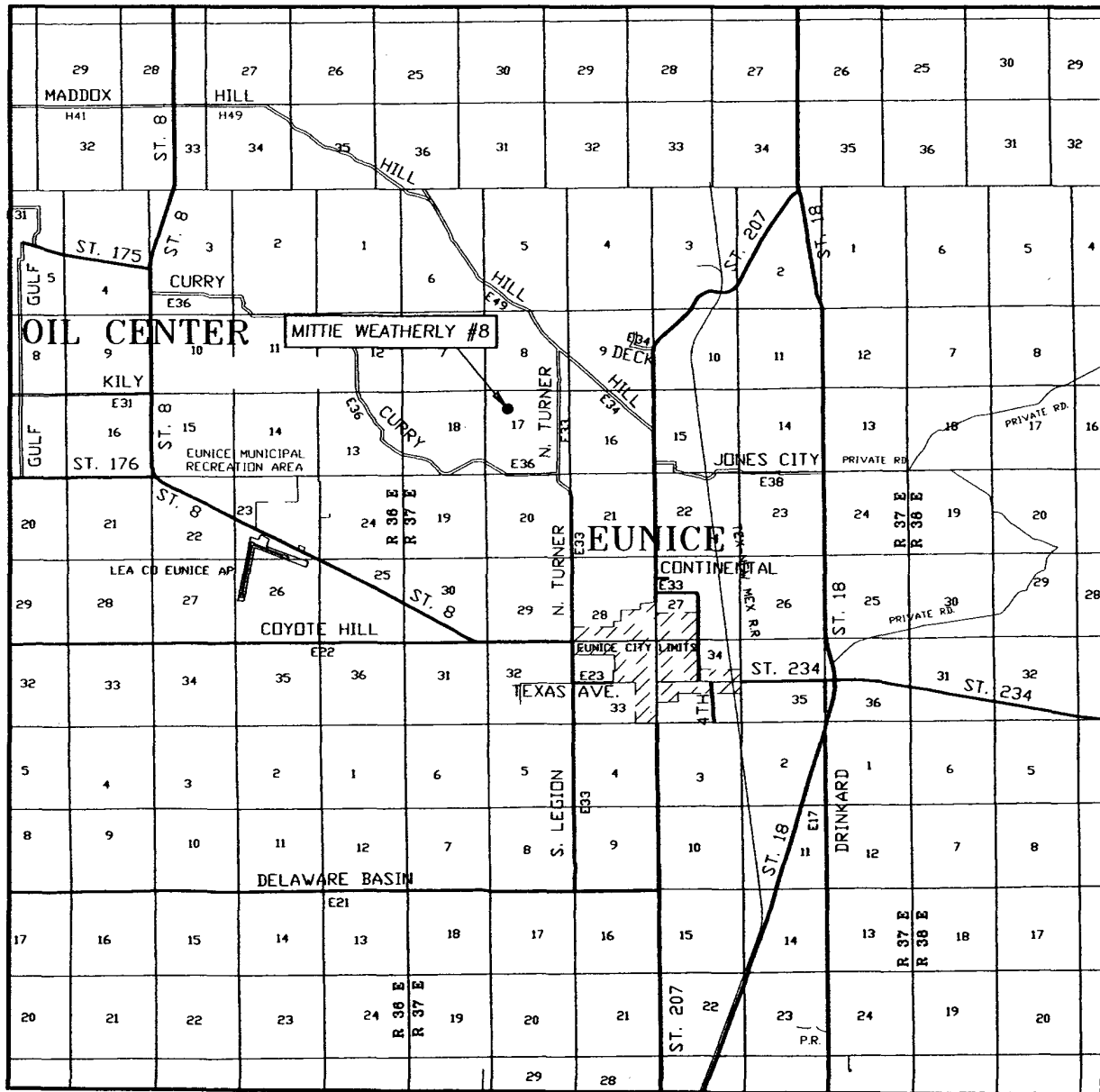

SCALE: 1" = 2 MILES

SEC. 17 TWP. 21-S. RGE. 37-E

SURVEY N.M.P.M.

COUNTY LEA

DESCRIPTION 1140' FNL & 1690' FWL

ELEVATION 3477'

OPERATOR CHEVRON U.S.A., INC.

LEASE MITTIE WEATHERLY

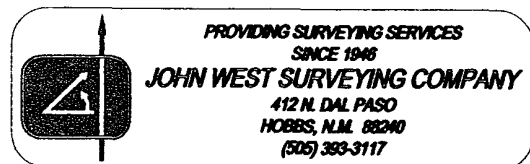

# LOCATION VERIFICATION MAP

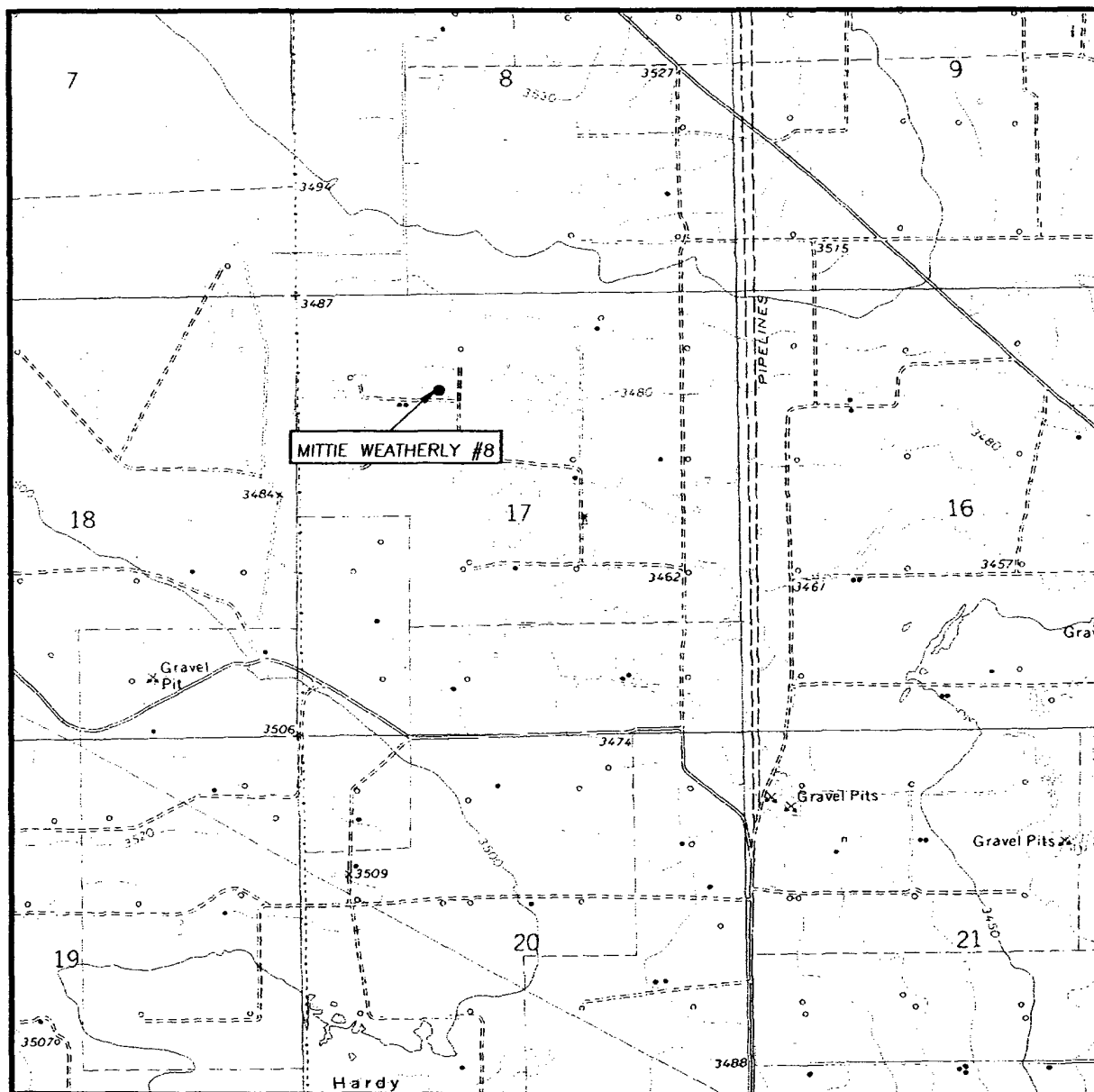

SCALE: 1" = 2000'

CONTOUR INTERVAL:  
EUNICE, N.M. - 10'

SEC. 17 TWP. 21-S RGE. 37-E

SURVEY N.M.P.M.

COUNTY LEA

DESCRIPTION 1140' FNL & 1690' FWL

ELEVATION 3477'

OPERATOR CHEVRON U.S.A., INC.

LEASE MITTIE WEATHERLY

U.S.G.S. TOPOGRAPHIC MAP  
EUNICE, N.M.

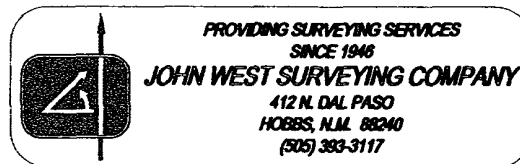

District I  
1625 N. French Dr., Hobbs, NM 88240  
District II  
1301 W. Grand Avenue, Artesia, NM 88210  
District III  
1000 Rio Brazos Road, Aztec, NM 87410  
District IV  
1220 S. St. Francis Dr., Santa Fe, NM 87505

State of New Mexico  
Energy Minerals and Natural Resources

Form C-144  
June 1, 2004

Oil Conservation Division  
1220 South St. Francis Dr.  
Santa Fe, NM 87505

For drilling and production facilities, submit to appropriate NMOC District Office.  
For downstream facilities, submit to Santa Fe office

**Pit or Below-Grade Tank Registration or Closure**

Is pit or below-grade tank covered by a "general plan"? Yes ☐ No ☐

Type of action: Registration of a pit or below-grade tank ☒ Closure of a pit or below-grade tank ☐

Operator: CHEVRON U.S.A. INC. Telephone: 432-687-7375 e-mail address: LEAKEJD@CHEVRONTXACO.COM

Address: 15 SMITH ROAD, MIDLAND, TEXAS 79705

Facility or well name: MITTIE WEATHERLY #8 API #: 30-05-37188 U/L or Qtr/Qtr C Sec 17 T 21-S R 37-E

County: LEA Latitude 32 28' 58.57" N Longitude 103 11' 15.86" W NAD: 1927

Surface Owner: Private

<b>Pit</b> Type: Drilling  Lined <input type="checkbox"/> Liner type: Synthetic <input type="checkbox"/> Thickness 20 mil Pit Volume 4106 bbl	<b>Below-grade tank</b> Volume: _____ bbl Type of fluid: _____ Construction material: _____ Double-walled, with leak detection? Yes <input type="checkbox"/> If not, explain why not. _____
Depth to ground water (vertical distance from bottom of pit to seasonal high water elevation of ground water.)	Less than 50 feet (20 points) 50 feet or more, but less than 100 feet (10 points) 100 feet or more (0 points)
Wellhead protection area: (Less than 200 feet from a private domestic water source, or less than 1000 feet from all other water sources.)	Yes (20 points) No (0 points)
Distance to surface water: (horizontal distance to all wetlands, playas, irrigation canals, ditches, and perennial and ephemeral watercourses.)	Less than 200 feet (20 points) 200 feet or more, but less than 1000 feet (10 points) 1000 feet or more (0 points)
<b>Ranking Score (Total Points)</b> 10	

**If this is a pit closure:** (1) Attach a diagram of the facility showing the pit's relationship to other equipment and tanks. (2) Indicate disposal location: (check the onsite box if you are burying in place) onsite ☐ offsite ☐ If offsite, name of facility \_\_\_\_\_. (3) Attach a general description of remedial action taken including remediation start date and end date. (4) Groundwater encountered: No ☐ Yes ☐ If yes, show depth below ground surface \_\_\_\_\_ ft. and attach sample results.

(5) Attach soil sample results and a diagram of sample locations and excavations.

Additional Comments:

I hereby certify that the information above is true and complete to the best of my knowledge and belief. I further certify that the above-described pit or below-grade tank has been/will be constructed or closed according to NMOC District guidelines ☒ a general permit ☐ or an (attached) alternative OCD-approved plan ☐.

Date: 4-07-2005

Printed Name/Title MARK GARZA DRILLING ENGINEER

Signature

*Mark Garza*

Your certification and NMOC District approval of this application/closure does not relieve the operator of liability should the contents of the pit or tank contaminate ground water or otherwise endanger public health or the environment. Nor does it relieve the operator of its responsibility for compliance with any other federal, state, or local laws and/or regulations.

Approval:

Printed Name/Title

Signature

ORIGINAL SIGNED BY  
PAUL F. KAUTZ  
PETROLEUM ENGINEER

APR 11 2005

## CapStar #16 Pit Design

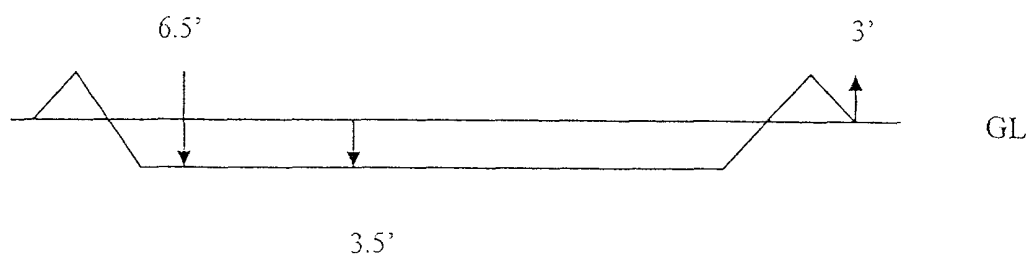
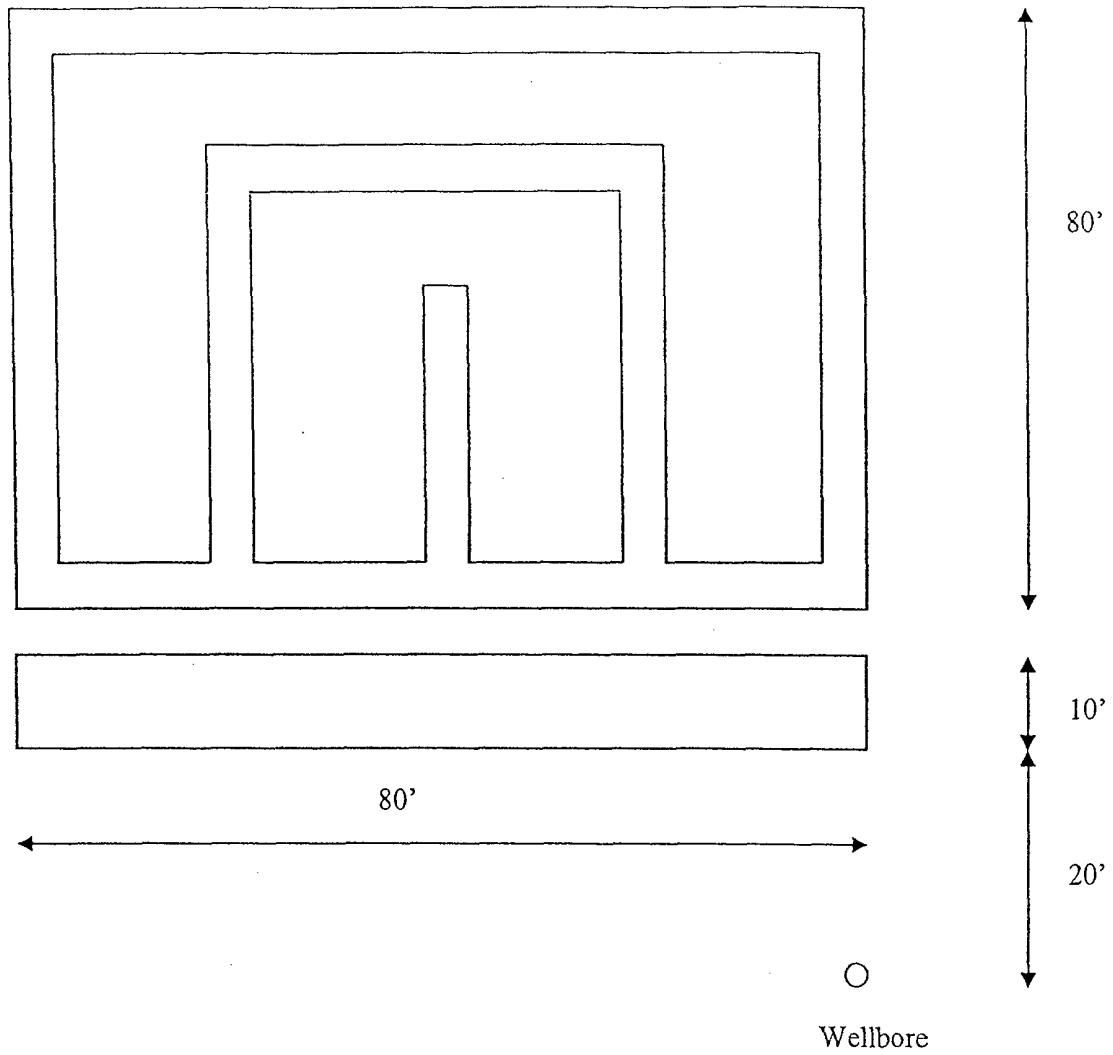

# State of New Mexico

Energy, Minerals and Natural Resources Department

## DISTRICT I

1625 N. FRENCH DR., HOBBS, NM 88240

## DISTRICT II

1301 W. GRAND AVENUE, ARTESIA, NM 88210

## DISTRICT III

1000 Rio Brazos Rd., Aztec, NM 87410

## DISTRICT IV

1220 S. ST. FRANCIS DR., SANTA FE, NM 87505

## OIL CONSERVATION DIVISION

1220 SOUTH ST. FRANCIS DR.  
Santa Fe, New Mexico 87505

Form C-102

Revised JUNE 10, 2003

Submit to Appropriate District Office

State Lease - 4 Copies

Fee Lease - 3 Copies

## WELL LOCATION AND ACREAGE DEDICATION PLAT

☐ AMENDED REPORT

API Number <b>30-025-37188</b>	Pool Code <b>50350</b>	Pool Name <b>Pemrose Skelly Brayburg</b>
Property Code <b>29965</b>	Property Name <b>MITTIE WEATHERLY</b>	Well Number <b>8</b>
OGRID No. <b>4323</b>	Operator Name <b>CHEVRON U.S.A., INC.</b>	Elevation <b>3477'</b>

### Surface Location

UL or lot No.	Section	Township	Range	Lot Idn	Feet from the	North/South line	Feet from the	East/West line	County
C	17	21-S	37-E		1140	NORTH	1690	WEST	LEA

### Bottom Hole Location If Different From Surface

UL or lot No.	Section	Township	Range	Lot Idn	Feet from the	North/South line	Feet from the	East/West line	County

Dedicated Acres	Joint or Infill	Consolidation Code	Order No.
<b>40</b>			<b>NSL 5189</b>

NO ALLOWABLE WILL BE ASSIGNED TO THIS COMPLETION UNTIL ALL INTERESTS HAVE BEEN CONSOLIDATED  
OR A NON-STANDARD UNIT HAS BEEN APPROVED BY THE DIVISION

	<p><b>OPERATOR CERTIFICATION</b></p> <p>I hereby certify the the information contained herein is true and complete to the best of my knowledge and belief.</p> <p><i>Denise Pinkerton</i> Signature <b>Denise Pinkerton</b> Printed Name <b>Regulatory Specialist</b> Title</p> <p>Date</p>
	<p><b>SURVEYOR CERTIFICATION</b></p> <p>I hereby certify that the well location shown on this plat was plotted from field notes of actual surveys made by me or under my supervision, and that the same is true and correct to the best of my belief.</p> <p>JANUARY 12, 2005</p> <p>Date Surveyed <span style="float: right;">JR</span></p> <p>Signature &amp; Seal of Professional Surveyor</p> <p><b>GARY G. EIDSON</b> 1/17/05 04.11.1918 12641</p> <p>Certificate No. <b>GARY EIDSON</b> 12641</p>
	<p>GEODETIC COORDINATES NAD 27 NME</p> <p>Y=541302.0 N X=853263.9 E</p> <p>LAT.=32°28'58.57" N LONG.=103°11'15.86" W</p>