

District I  
1625 N French Dr, Hobbs, NM 88240  
District II  
1301 W. Grand Avenue, Artesia, NM 88210  
District III  
1000 Rio Brazos Road, Aztec, NM 87410  
District IV  
1220 S St. Francis Dr., Santa Fe, NM 87505

State of New Mexico  
Energy Minerals and Natural Resources **HOBBS OGD**

Form C-101  
June 16, 2008

Oil Conservation Division  
1220 South St. Francis Dr.  
Santa Fe, NM 87505

Submit to appropriate District Office

☐ AMENDED REPORT

**RECEIVED**

**APPLICATION FOR PERMIT TO DRILL, RE-ENTER, DEEPEN, PLUGBACK, OR ADD A ZONE**

<sup>1</sup> Operator Name and Address Apache Corp 303 Veterans Airpark Ste 3000 Midland TX 79705		<sup>2</sup> OGRID Number 873
		<sup>3</sup> API Number 30 - 025-34341
<sup>4</sup> Property Code 006421	<sup>5</sup> Property Name W H LAUGHLIN	<sup>6</sup> Well No. 008
<sup>9</sup> Proposed Pool 1 SKAGGS; GLORIETA, NW (97203)		<sup>10</sup> Proposed Pool 2 SKAGGS; DRINKARD (57000)

<sup>7</sup> Surface Location

UL or lot no	Section	Township	Range	Lot Idn	Feet from the	North/South line	Feet from the	East/West line	County
F	9	20S	37E		1760	N	1750	W	LEA

<sup>8</sup> Proposed Bottom Hole Location If Different From Surface

UL or lot no	Section	Township	Range	Lot Idn	Feet from the	North/South line	Feet from the	East/West line	County

Additional Well Information

<sup>11</sup> Work Type Code ADDING	<sup>12</sup> Well Type Code OIL	<sup>13</sup> Cable/Rotary	<sup>14</sup> Lease Type Code PRIVATE	<sup>15</sup> Ground Level Elevation 3545
<sup>16</sup> Multiple N	<sup>17</sup> Proposed Depth	<sup>18</sup> Formation GLORIETA & DRINKARD	<sup>19</sup> Contractor	<sup>20</sup> Spud Date

<sup>21</sup> Proposed Casing and Cement Program

Hole Size	Casing Size	Casing weight/foot	Setting Depth	Sacks of Cement	Estimated TOC
12.5	8-5/8	24	1175	600	0
7.78	7	17	4050	500	0
6-1/4	4-1/2	15.5	7800	635	0

<sup>22</sup> Describe the proposed program. If this application is to DEEPEN or PLUG BACK, give the data on the present productive zone and proposed new productive zone. Describe the blowout prevention program, if any. Use additional sheets if necessary.  
WELL IS CURRENTLY PERMITTED FOR THE MONUMENT; ABO, SE - ~~WEIR; DRINKARD~~ - MONUMENT; TUBB - MONUMENT; BLINEBERY - MONUMENT; PADDOCK. THIS PERMIT IS TO ADD THE SKAGGS; GLORIETA, NW AND THE SKAGGS; DRINKARD.

**Permit Expires 2 Years From Approval  
Date Unless Drilling Underway**

*Adding*

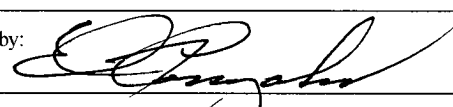
<sup>23</sup> I hereby certify that the information given above is true and complete to the best of my knowledge and belief		OIL CONSERVATION DIVISION	
Signature: 		Approved by: 	
Printed name: BEV HATFIELD		Title: <i>Sarah Wark</i>	
Title: Sr. Staff Engineering Tech		Approval Date: <i>11-21-2011</i>	Expiration Date: <i>11-21-2013</i>
E-mail Address: Beverly.Hatfield@apachecorp.com			
Date: 10/26/2011	Phone: 432/818-1906		

**Oil Conservation Division**

Conditions of approval : Approval for drilling/workover  
ONLY--- CANNOT produce Downhole Commingled until  
DHC is approved in Santa Fe.

NOV 21 2011

DISTRICT I  
P.O. Box 1980, Hobbs, NM 88241-1980

DISTRICT II  
P.O. Drawer DD, Artesia, NM 88211-0719

DISTRICT III  
1000 Rio Brazos Rd., Aztec, NM 87410

DISTRICT IV  
P.O. Box 2088, Santa Fe, N.M. 87504-2088

State of New Mexico

Energy, Minerals and Natural Resources Department

Form C-102

Revised February 10, 1994

Submit to Appropriate District Office

State Lease - 4 Copies

Fee Lease - 3 Copies

HOBBS OCD

NOV 02 2011

RECEIVED

OIL CONSERVATION DIVISION

P.O. Box 2088

Santa Fe, New Mexico 87504-2088

☐ AMENDED REPORT

WELL LOCATION AND ACREAGE DEDICATION PLAT

API Number 30-025-34341	Pool Code 57000	Pool Name Skaggs; Drinkard
Property Code 22992	Property Name W. H. Laughlin	Well Number 8
OGRID No. 873	Operator Name Apache Corporation	Elevation 3545

UL or lot No.	Section	Township	Range	Lot Idn	Feet from the	North/South line	Feet from the	East/West line	County
F	9	20. S	37 E		1760	NORTH	1750	WEST	LEA

Bottom Hole Location If Different From Surface

UL or lot No.	Section	Township	Range	Lot Idn	Feet from the	North/South line	Feet from the	East/West line	County
Dedicated Acres 40		Joint or Infill		Consolidation Code		Order No.			

NO ALLOWABLE WILL BE ASSIGNED TO THIS COMPLETION UNTIL ALL INTERESTS HAVE BEEN CONSOLIDATED  
OR A NON-STANDARD UNIT HAS BEEN APPROVED BY THE DIVISION

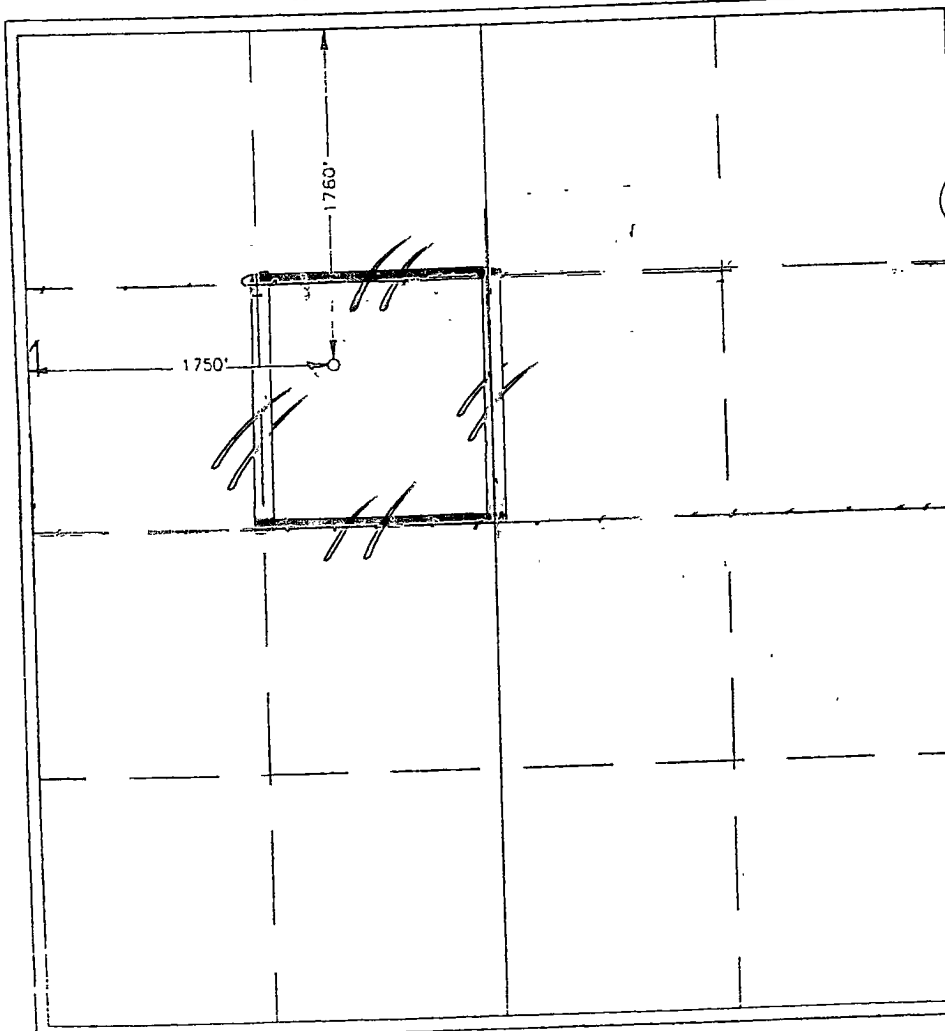

OPERATOR CERTIFICATION

I hereby certify the the information  
contained herein is true and complete to the  
best of my knowledge and belief.

Signature

Bev Hatfield

Printed Name

Sr Eng. Tech

Title

10-26-2011

Date

SURVEYOR CERTIFICATION

I hereby certify that the well location shown  
on this plat was plotted from field notes of  
actual surveys made by me or under my  
supervision, and that the same is true and  
correct to the best of my belief.

FEBRUARY 13, 1998

Date Surveyed

DMCC

Signature & Seal of  
Professional Surveyor

2-19-98  
98-11-0284

Certificate No. JOHN D. WEST  
RONALD F. EIDSON  
EIDSON

676  
J239  
2641

DISTRICT I  
P.O. Box 1980, Hobbs, NM 88241-1980

DISTRICT II  
P.O. Drawer DD, Artesia, NM 88211-0719

DISTRICT III  
1000 Rio Brazos Rd., Aztec, NM 87410

DISTRICT IV  
P.O. BOX 2088, SANTA FE, N.M. 87504-2088

HOBBS OCD

NOV 02 2011

RECEIVED

State of New Mexico  
Energy, Minerals and Natural Resources Department

Form C-102  
Revised February 10, 1994  
Submit to Appropriate District Office  
State Lease - 4 Copies  
Fee Lease - 3 Copies

OIL CONSERVATION DIVISION  
P.O. Box 2088

Santa Fe, New Mexico 87504-2088

☐ AMENDED REPORT

WELL LOCATION AND ACREAGE DEDICATION PLAT

API Number 30-025-34341	Pool Code 97203	Pool Name Skaggs; Glorieta, NW
Property Code 22992	Property Name W. H. Laughlin	Well Number 8
OGRID No. 873	Operator Name Apache Corporation	Elevation 3545

Surface Location

UL or lot No.	Section	Township	Range	Lot Idn	Feet from the	North/South line	Feet from the	East/West line	County
F	9	20. S	37 E		1760	NORTH	1750	WEST	LEA

Bottom Hole Location If Different From Surface

UL or lot No.	Section	Township	Range	Lot Idn	Feet from the	North/South line	Feet from the	East/West line	County
Dedicated Acres 40		Joint or Infill		Consolidation Code		Order No.			

NO ALLOWABLE WILL BE ASSIGNED TO THIS COMPLETION UNTIL ALL INTERESTS HAVE BEEN CONSOLIDATED  
OR A NON-STANDARD UNIT HAS BEEN APPROVED BY THE DIVISION

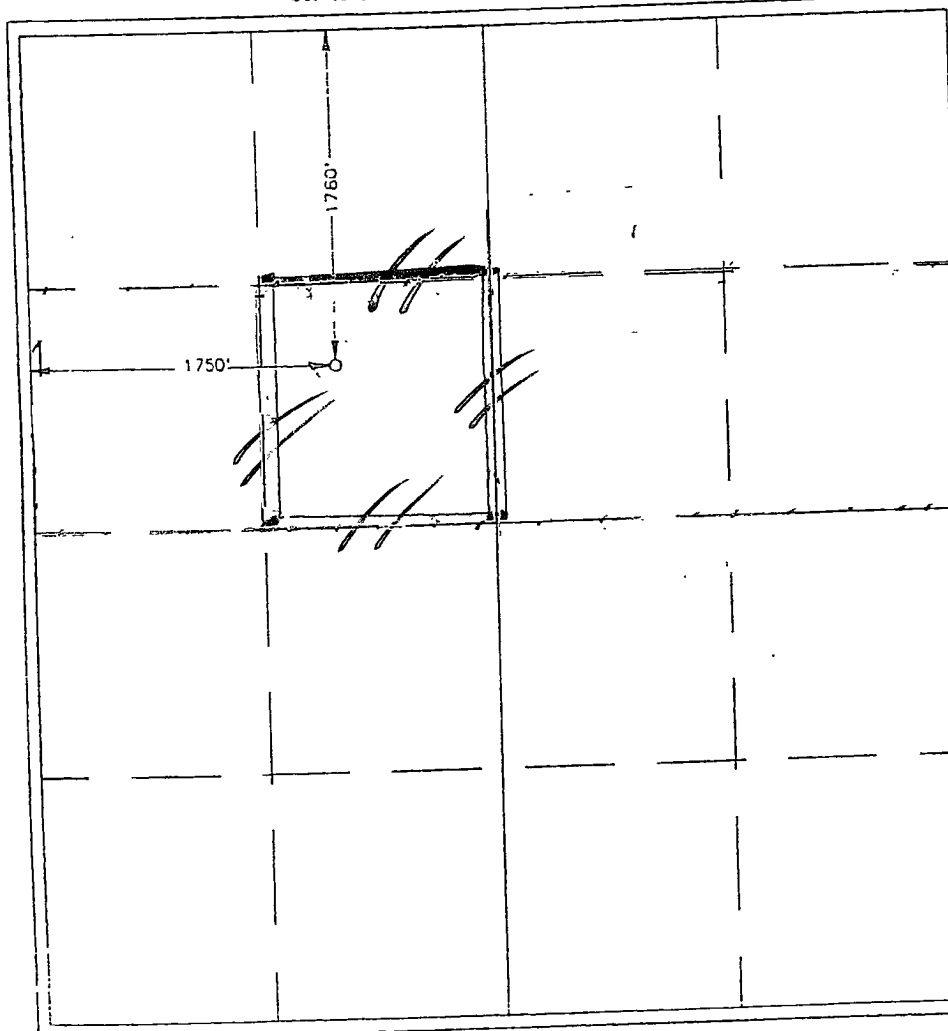

OPERATOR CERTIFICATION

I hereby certify the the information  
contained herein is true and complete to the  
best of my knowledge and belief.

Signature

Bev Hatfield

Printed Name

Sr Eng. Tech

Title

10-26-2011

Date

SURVEYOR CERTIFICATION

I hereby certify that the well location shown  
on this plat was plotted from field notes of  
actual surveys made by me or under my  
supervision, and that the same is true and  
correct to the best of my belief.

FEBRUARY 13, 1998

Date Surveyed

DMCC

Signature & Seal of  
Professional Surveyor

Surveyor's Seal  
98-11-0284

Certificate No. JOHN W. WEST  
RONALD F. EIDSON

676  
J239  
2641

DISTRICT I  
P.O. Box 1980, Hobbs, NM 88241-1980

DISTRICT II  
P.O. Drawer DD, Artesia, NM 88211-0719

DISTRICT III  
1000 Rio Brazos Rd., Aztec, NM 87410

DISTRICT IV  
P.O. BOX 2088, SANTA FE, N.M. 87504-2088

State of New Mexico

Energy, Minerals and Natural Resources Department

Form C-102

Revised February 10, 1994

Submit to Appropriate District Office

State Lease - 4 Copies

Fee Lease - 3 Copies

HOBBS OCD

HOBBS OCD

NOV 02

OIL CONSERVATION DIVISION

P.O. Box 2088

Santa Fe, New Mexico 87504-2088

RECEIVED

RECEIVED

☐ AMENDED REPORT

WELL LOCATION AND ACREAGE DEDICATION PLAT

API Number 30-025-34341	Pool Code 637.80	Well Name Weir; Blinbry	Well Number 8
Property Code 22992	Property Name W. H. Laughlin		Elevation 3545
OGRID No. 873	Operator Name Apache Corporation		

Surface Location

UL or lot No.	Section	Township	Range	Lot Idn	Feet from the	North/South line	Feet from the	East/West line	County
F	9	20. S	37 E		1760	NORTH	1750	WEST	LEA

Bottom Hole Location If Different From Surface

UL or lot No.	Section	Township	Range	Lot Idn	Feet from the	North/South line	Feet from the	East/West line	County
Dedicated Acres 40		Joint or Infill		Consolidation Code		Order No.			

NO ALLOWABLE WILL BE ASSIGNED TO THIS COMPLETION UNTIL ALL INTERESTS HAVE BEEN CONSOLIDATED  
OR A NON-STANDARD UNIT HAS BEEN APPROVED BY THE DIVISION

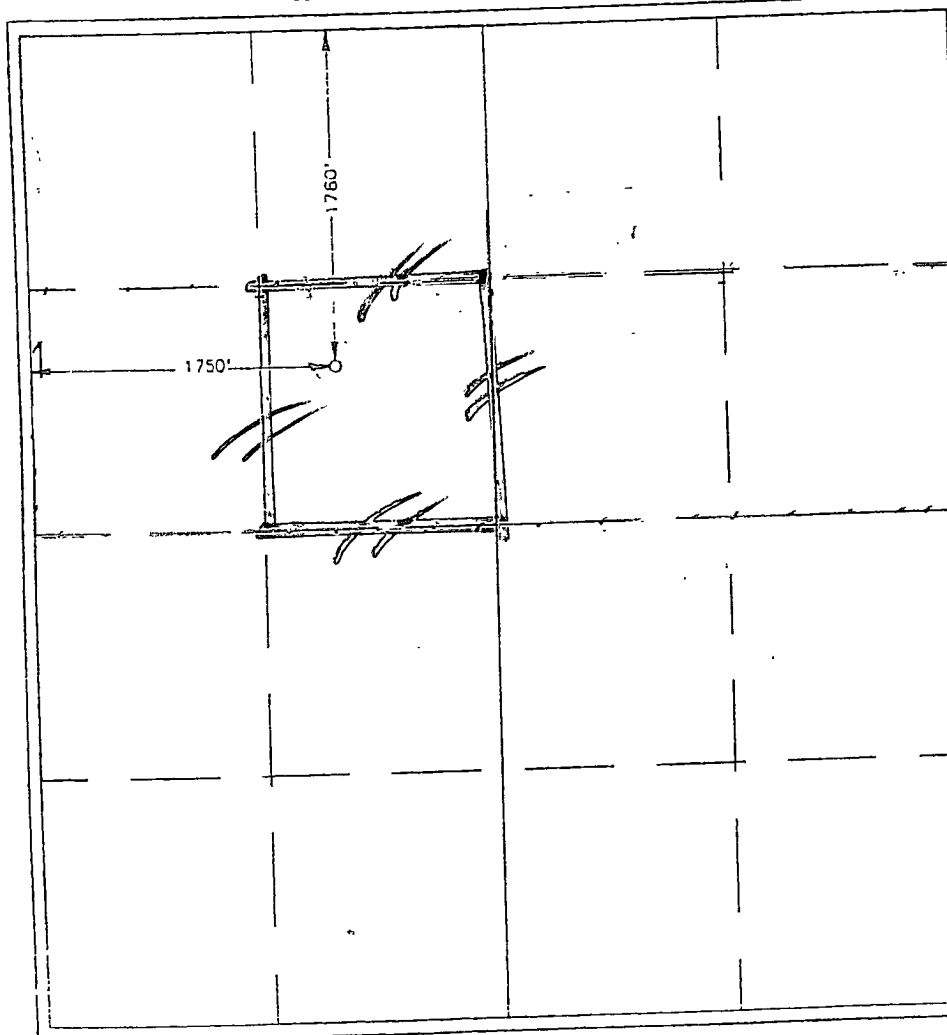

OPERATOR CERTIFICATION

I hereby certify that the information contained herein is true and complete to the best of my knowledge and belief.

Signature

Bev Hatfield

Printed Name

Sr Eng. Tech

Title

10-26-2011

Date

SURVEYOR CERTIFICATION

I hereby certify that the well location shown on this plat was plotted from field notes of actual surveys made by me or under my supervision, and that the same is true and correct to the best of my belief.

FEBRUARY 13, 1998

Date Surveyed

DMCC

Signature & Seal of Professional Surveyor

Surveyor's Seal:

Certificate No. JOHN D. WEST  
RONALD F. EIDSON  
RAY EIDSON

676  
J239  
2641

DISTRICT I  
P.O. Box 1950, Hobbs, NM 88241-1950

DISTRICT II  
P.O. Drawer DD, Artesia, NM 88211-0719

DISTRICT III  
1000 Rio Brazos Rd., Aztec, NM 87410

DISTRICT IV  
P.O. Box 2088, Santa Fe, N.M. 87504-2088

State of New Mexico  
Energy, Minerals and Natural Resources Department

Form C-102  
Revised February 10, 1984  
Submit to Appropriate District Office  
State Lease - 4 Copies  
Fee Lease - 3 Copies

HOBBS OGD

OIL CONSERVATION DIVISION  
P.O. Box 2088  
Santa Fe, New Mexico 87504-2088

NOV 02 2011

☐ AMENDED REPORT

RECEIVED

WELL LOCATION AND ACREAGE DEDICATION PLAT

API Number 30-025-34341	Pool Code 47080	Pool Name Monument, Paddock
Property Code 22992	Property Name W. H. Laughlin	Well Number 8
OGRID No. 873	Operator Name Apache Corporation	Elevation 3545

UL or lot No.	Section	Township	Range	Lot Idn	Feet from the	North/South line	Feet from the	East/West line	County
F	9	20 S	37 E		1760	NORTH	1750	WEST	LEA

Bottom Hole Location If Different From Surface

UL or lot No.	Section	Township	Range	Lot Idn	Feet from the	North/South line	Feet from the	East/West line	County
Dedicated Acres 40		Joint or Infill		Consolidation Code		Order No.			

NO ALLOWABLE WILL BE ASSIGNED TO THIS COMPLETION UNTIL ALL INTERESTS HAVE BEEN CONSOLIDATED  
OR A NON-STANDARD UNIT HAS BEEN APPROVED BY THE DIVISION

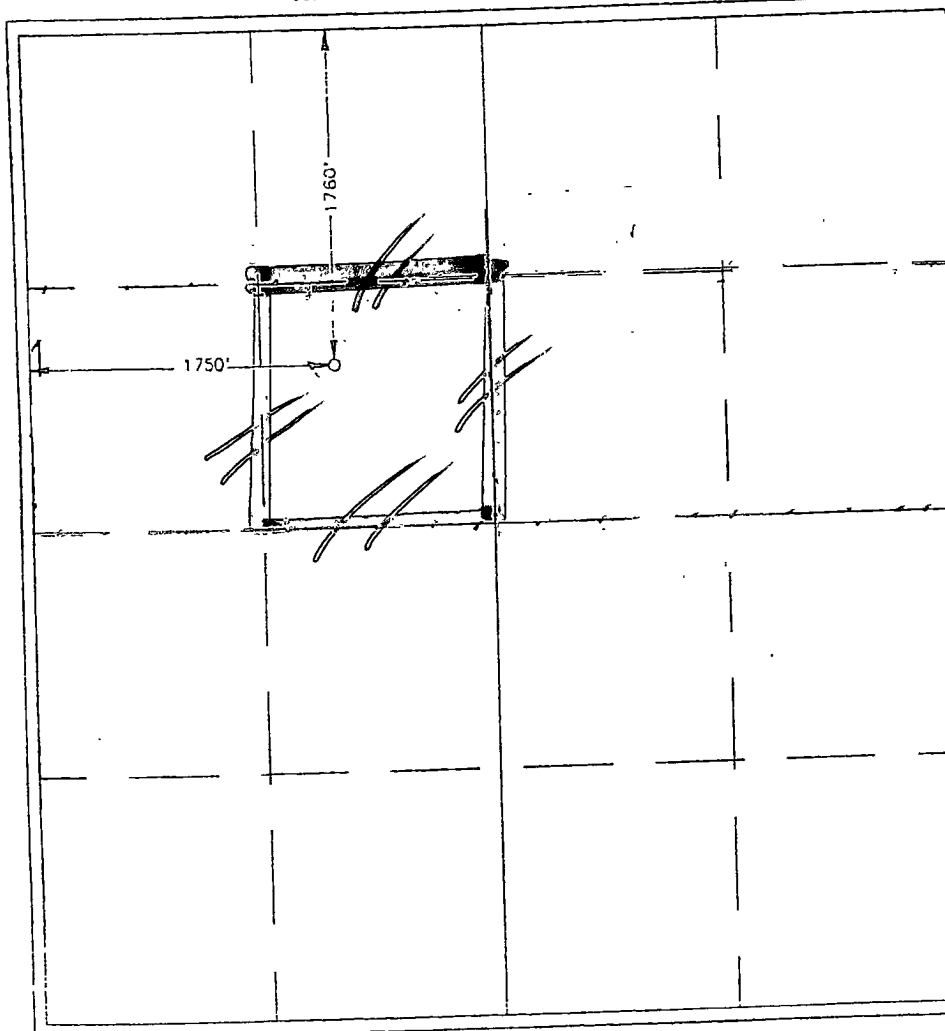

OPERATOR CERTIFICATION

I hereby certify that the information contained herein is true and complete to the best of my knowledge and belief.

*Bev Hatfield*  
Signature

Bev Hatfield  
Printed Name

Sr Eng. Tech  
Title

10-26-2011  
Date

SURVEYOR CERTIFICATION

I hereby certify that the well location shown on this plat was plotted from field notes of actual surveys made by me or under my supervision and that the same is true and correct to the best of my belief.

FEBRUARY 13, 1998

Date Surveyed..... DMCC

Signature & Seal of Professional Surveyor

*Sam Dillon* 2-19-98  
98-11-0284

Certificate No. JOHN W. WEST 676  
RONALD F. EIDSON 3239  
RAY EIDSON 2641

DISTRICT I  
P.O. Box 1980, Hobbs, NM 88241-1980

DISTRICT II  
P.O. Drawer DD, Artesia, NM 88211-0719

DISTRICT III  
1000 Rio Brazos Rd., Aztec, NM 87410

DISTRICT IV  
P.O. BOX 2088, SANTA FE, N.M. 87504-2088

State of New Mexico  
Energy, Minerals and Natural Resources Department

Form C-102  
Revised February 10, 1984  
Submit to Appropriate District Office  
State Lease - 4 Copies  
Fee Lease - 3 Copies

OIL CONSERVATION DIVISION

P.O. Box 2088  
Santa Fe, New Mexico 87504-2088

HOBBS OGD

NOV 02 2011

☐ AMENDED REPORT

WELL LOCATION AND ACREAGE DEDICATION PLAT

API Number 30-025-34341	Pool Code 47090	Pool Name Monument; Tubb
Property Code 22992	Property Name W. H. Laughlin	Well Number 8
OGRID No. 873	Operator Name Apache Corporation	Elevation 3545

UL or lot No. F	Section 9	Township 20 S	Range 37 E	Lot Idn	Feet from the 1760	North/South line NORTH	Feet from the 1750	East/West line WEST	County LEA
--------------------	--------------	------------------	---------------	---------	-----------------------	---------------------------	-----------------------	------------------------	---------------

Bottom Hole Location If Different From Surface

UL or lot No.	Section	Township	Range	Lot Idn	Feet from the	North/South line	Feet from the	East/West line	County
Dedicated Acres 40	Joint or Infill	Consolidation Code	Order No.						

NO ALLOWABLE WILL BE ASSIGNED TO THIS COMPLETION UNTIL ALL INTERESTS HAVE BEEN CONSOLIDATED  
OR A NON-STANDARD UNIT HAS BEEN APPROVED BY THE DIVISION



OPERATOR CERTIFICATION

I hereby certify that the information contained herein is true and complete to the best of my knowledge and belief.

Signature

Bev Hatfield

Printed Name

Sr Eng. Tech

Title

10-26-2011

Date

SURVEYOR CERTIFICATION

I hereby certify that the well location shown on this plat was plotted from field notes of actual surveys made by me or under my supervision, and that the same is true and correct to the best of my belief.

FEBRUARY 13, 1998

Date Surveyed

DMCC

Signature & Seal of Professional Surveyor

Surveyor's Seal  
98-11-0284

Certificate No. JOHN D. WEST  
RONALD F. EIDSON  
CLAY EIDSON

676  
3239  
2641

DISTRICT I  
P.O. Box 1980, Hobbs, NM 88241-1980

DISTRICT II  
P.O. Drawer DD, Artesia, NM 88211-0719

DISTRICT III  
1000 Rio Brazos Rd., Aztec, NM 87410

DISTRICT IV  
P.O. BOX 2088, SANTA FE, N.M. 87504-2088

State of New Mexico  
Energy, Minerals and Natural Resources Department

Form C-102  
Revised February 10, 1984  
Submit to Appropriate District Office  
State Lease - 4 Copies  
Fee Lease - 3 Copies

OIL CONSERVATION DIVISION  
P.O. Box 2088  
Santa Fe, New Mexico 87504-2088

HOBBS OCD

NOV 02 2011

☐ AMENDED REPORT

WELL LOCATION AND ACREAGE DEDICATION

RECEIVED

API Number 30-025-34341	Pool Code 46970	Pool Name Monument; Abo
Property Code 22992	Property Name W. H. Laughlin	Well Number 8
OGRID No. 873	Operator Name Apache Corporation	Elevation 3545

UL or lot No. F	Section 9	Township 20. S	Range 37 E	Lot Idn	Feet from the 1760	North/South line NORTH	Feet from the 1750	East/West line WEST	County LEA
--------------------	--------------	-------------------	---------------	---------	-----------------------	---------------------------	-----------------------	------------------------	---------------

Bottom Hole Location If Different From Surface

UL or lot No.	Section	Township	Range	Lot Idn	Feet from the	North/South line	Feet from the	East/West line	County
Dedicated Acres 40					Joint or Infill	Consolidation Code	Order No.		

NO ALLOWABLE WILL BE ASSIGNED TO THIS COMPLETION UNTIL ALL INTERESTS HAVE BEEN CONSOLIDATED  
OR A NON-STANDARD UNIT HAS BEEN APPROVED BY THE DIVISION

--