

District I
1625 N French Dr , Hobbs, NM 88240
Phone (575) 393-6161 Fax (575) 393-0720
District II
811 S First St , Artesia, NM 88210
Phone (575) 748-1283 Fax (575) 748-9720
District III
1000 Rio Brazos Road, Aztec, NM 87410
Phone (505) 334-6178 Fax (505) 334-6170
District IV
1220 S St Francis Dr , Santa Fe, NM 87505
Phone (505) 476-3460 Fax (505) 476-3462

State of New Mexico
Energy Minerals and Natural Resources
Oil Conservation Division
1220 South St. Francis Dr.
Santa Fe, NM 87505

Form C-101
Revised August 1, 2011

Permit

HOBBS OCD

FEB 13 2012

RECEIVED

APPLICATION FOR PERMIT TO DRILL, RE-ENTER, DEEPEN, PLUGBACK, OR ADD A ZONE

¹ Operator Name and Address LINN OPERATING, INC. 600 TRAVIS, SUITE 5100 HOUSTON, TEXAS 77002		² OGRID Number 269324
		³ API Number 30-025-40433
⁴ Property Code 309540	⁵ Property Name EAST HOBBS SAN ANDRES UNIT	⁶ Well No. 312

⁷ Surface Location

UL - Lot	Section	Township	Range	Lot Idn	Feet from	N/S Line	Feet From	E/W Line	County
L	29	18S	39E		2499'	SOUTH	746'	WEST	LEA

⁸ Pool Information

HOBBS, SAN ANDRES, EAST	32300
-------------------------	-------

Additional Well Information

⁹ Work Type N	¹⁰ Well Type OIL	¹¹ Cable/Rotary ROTARY	¹² Lease Type PRIVATE	¹³ Ground Level Elevation 3596'
¹⁴ Multiple NO	¹⁵ Proposed Depth 4800'	¹⁶ Formation SAN ANDRES P4	¹⁷ Contractor CAVALOS RIG #3	¹⁸ Spud Date RIG IS ON LOCATION
Depth to Ground water		Distance from nearest fresh water well		Distance to nearest surface water

¹⁹ Proposed Casing and Cement Program

Type	Hole Size	Casing Size	Casing Weight/ft	Setting Depth	Sacks of Cement	Estimated TOC
I55 LTC	12-1/4	8-5/8	24#/32#	1900'	960	SURFACE
I558RLT	7-7/8	5-1/2	15.5#	4700'	650	SURFACE

Casing/Cement Program: Additional Comments

MIRU ROTARY DRILLING RIG DRILL 12-1/4" HOLE TO TOP OF ANHYDRITE @ 1900' USING FRESHWATER/SPUD MUD RUN 8-5/8" CASING AND CEMENT TO SURFACE DRILL 7-7/8" HOLE TO 4800' USING 10# BRINE OBTAIN OPEN HOLE LOGS RUN 5-1/2" 15.5# CASING TO 4700' AND CEMENT TO SURFACE

Proposed Blowout Prevention Program

Type	Working Pressure	Test Pressure	Manufacturer
DOUBLE	2000 PSI	3000 PSI	CAMERON

I hereby certify that the information given above is true and complete to the best of my knowledge and belief.

I further certify that the drilling pit will be constructed according to NMOCD guidelines ☒, a general permit ☐, or an (attached) alternative OCD-approved plan ☐.

Printed name: NANCY FITZWATER

Title: REGULATORY COMPLIANCE ADVISOR

E-mail Address: nfitzwat@linnenergy.com

Date: 02/09/2012

Phone: 281/840-4266

OIL CONSERVATION DIVISION

Approved By.

Title:

Approved Date:

Expiration Date:

Conditions of Approval Attached

1525 N. French Dr. Hobbs NM 88240
 Phone (505) 393-6161 Fax (505) 393-0720
 District II
 811 S. First St., Artesa, NM 88210
 Phone (505) 748-1285 Fax (505) 748-9720
 District III
 1000 Rio Brazos Road, Aztec, NM 87410
 Phone (505) 334-6178 Fax (505) 334-6170
 District IV
 1220 S. St. Francis Dr., Santa Fe, NM 87505
 Phone (505) 476-3460 Fax (505) 476-3462

State of New Mexico

Form C-102

Energy Minerals & Natural Resources Department
HOBBS OGD
 OIL CONSERVATION DIVISION

Revised August 1, 2011
 Submit one copy to appropriate
 District Office

FEB 13 2012

1220 South St. Francis Dr.
 Santa Fe, NM 87505

☐ AMENDED REPORT

RECEIVED
 WELL LOCATION AND ACREAGE DEDICATION PLAT

¹ API Number 30-025-40433	² Pool Code 32300	³ Pool Name Hobbs San Andres East
⁴ Property Code 309540	⁵ Property Name East Hobbs San Andres Unit	
⁷ OGRID No. 269324	⁸ Operator Name LINN OPERATING INC.	⁶ Well Number 312
		⁹ Elevation 3596'

¹⁰ Surface Location

TL or lot no.	Section	Township	Range	Lot Idn	Feet from the	North/South line	Feet from the	East/West line	County
L	29	18-S	39-E		2499'	SOUTH	746'	WEST	LEA

¹¹ Bottom Hole Location If Different From Surface

TL or lot no.	Section	Township	Range	Lot Idn	Feet from the	North/South line	Feet from the	East/West line	County

¹² Dedicated Acres 40	¹³ Joint or Infill	¹⁴ Consolidation Code	¹⁵ Order No.
--	-------------------------------	----------------------------------	-------------------------

No allowable will be assigned to this completion until all interests have been consolidated or a non-standard unit has been approved by the division.

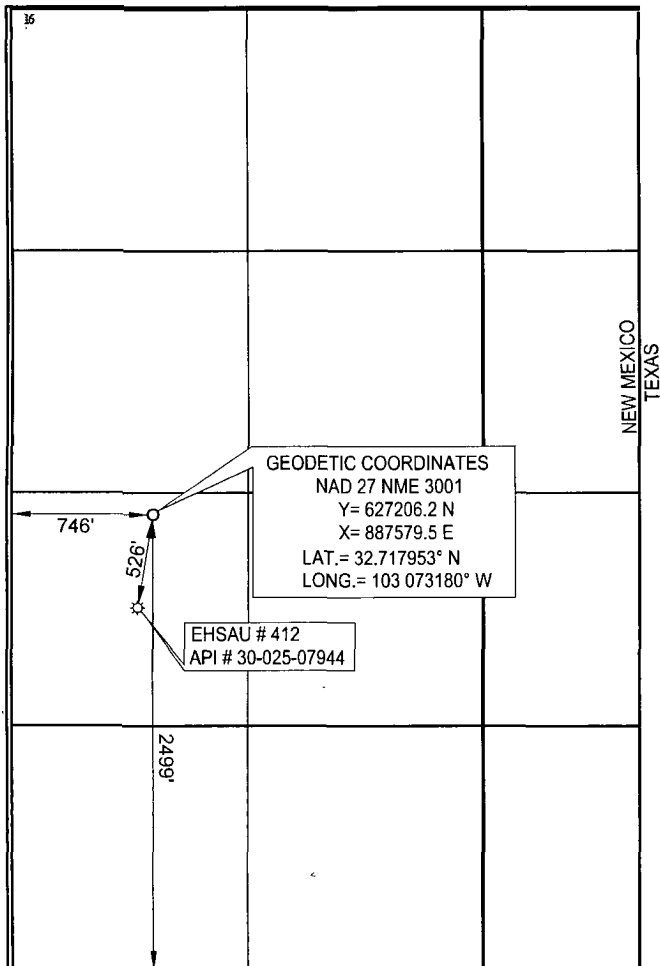

¹⁷ OPERATOR CERTIFICATION	
I hereby certify that the information contained herein is true and complete to the best of my knowledge and belief, and that this organization either owns a working interest or releases mineral interest in the land including the proposed bottom hole location or has a right to drill this well at this location pursuant to a contract with an owner of such an interest or working interest or to a voluntary pooling agreement or a compulsory pooling order heretofore entered by the division.	
<i>Nancy Fitzwater</i> Signature	<i>2-9-12</i> Date
Nancy Fitzwater Printed Name	
nfitzwater@linnenergy.com E-mail Address	
¹⁸ SURVEYOR CERTIFICATION	
I hereby certify that the well location shown on this plat was plotted from field notes of actual surveys made by me or under my supervision, and that the same is true and correct to the best of my belief.	
OCTOBER 6, 2011 Date of Survey	
Signature and Seal of Professional Surveyor	
Certificate Number: JEFFREY E. HUDSON, State of New Mexico, License Number 20559	