

District I
1625 N French Dr, Hobbs, NM 88240
District II
1301 W Grand Avenue, Artesia, NM 88210
District III
1000 Rio Brazos Road, Aztec, NM 87410
District IV
1220 S St Francis Dr, Santa Fe, NM 87505

HOBBS OCD State of New Mexico
Energy Minerals and Natural Resources

Form C-101
May 27, 2004

MAR 9 2012

Oil Conservation Division

1220 South St. Francis Dr
Santa Fe, NM 87505

Submit to appropriate District Office

☐ AMENDED REPORT

RECEIVED

APPLICATION FOR PERMIT TO DRILL, RE-ENTER, DEEPEN, PLUG BACK, OR ADD A ZONE

¹ Operator Name and Address V-F Petroleum Inc., P.O. Box 1889, Midland, Texas 79702		² OGRID Number 24010
³ Property Code 21102303597		⁴ API Number 30-025-34068
⁵ Property Name Eidson 23		⁶ Well No I
⁹ Proposed Pool 1 Shoebar; Wolfcamp		¹⁰ Proposed Pool 2 Townsend Abo

⁷ Surface Location									
UL or lot no L	Section 23	Township 16-S	Range 35-E	Lot Idn	Feet from the 1,980'	North/South line South	Feet from the 660'	East/West line West	County Lea

⁸ Proposed Bottom Hole Location If Different From Surface

UL or lot no	Section	Township	Range	Lot Idn	Feet from the	North/South line	Feet from the	East/West line	County
--------------	---------	----------	-------	---------	---------------	------------------	---------------	----------------	--------

Additional Well Information

¹¹ Work Type Code A	¹² Well Type Code O	¹³ Cable/Rotary NA	¹⁴ Lease Type Code P	¹⁵ Ground Level Elevation 3,973'
¹⁶ Multiple	¹⁷ Proposed Depth	¹⁸ Formation	¹⁹ Contractor	²⁰ Spud Date
Depth to Groundwater		Distance from nearest fresh water well		Distance from nearest surface water
Pit Liner Synthetic <input type="checkbox"/> ___mils thick Clay <input type="checkbox"/> Pit Volume ___ bbls Drilling ___				
Closed-Loop System <input type="checkbox"/> No Pits Fresh Water <input type="checkbox"/> Brine <input type="checkbox"/> Diesel/Oil-based <input type="checkbox"/> Gas/Air <input type="checkbox"/>				

²¹ Proposed Casing and Cement Program

Hole Size	*Casing Size	Casing weight/foot	Setting Depth	Sacks of Cement	Estimated TOC
17 1/2"	13 3/8"	54.5#	396'	524	Surface
11"	8 5/8"	32#	4,480'	1,585	Surface
7 7/8"	5 1/2"	17#	13,368'	200	10,000

²² Describe the proposed program. If this application is to DEEPEN or PLUG BACK, give the data on the present productive zone and proposed new productive zone. Describe the blowout prevention program, if any. Use additional sheets if necessary.

Perforations at 10,206' - 10,214'. Pumping 4 bbls oil, 10 bbls water and 10 MCFD.

Proposal: Pull all production equipment.

Add perforations 8,754' - 8,764'. Stimulate and test.

Return to production from all perforations.

Permit Expires 2 Years From Approval
Date Unless Drilling Underway
Adding

²³ I hereby certify that the information given above is true and complete to the best of my knowledge and belief. I further certify that the drilling pit will be constructed according to NMOCD guidelines ☒, a general permit ☐, or an (attached) alternative OCD-approved plan ☐.

Signature *M. Wayne Luna*

Printed name. M. Wayne Luna

Title Production Superintendent

E-mail Address:

Date 3/7/12

Phone (432) 683-3344

OIL CONSERVATION DIVISION

Approved by

Title

Approval Date

Expiration Date

Oil Conservation Division

Conditions of approval: Approval for drilling/workover ONLY--- CANNOT produce Downhole Commingled until DHC is approved in Santa Fe.

MAR 15 2012

DISTRICT I
P.O. Box 1820, Hobbs, NM 88241-1820

DISTRICT II
P.O. Drawer 80, Artesia, NM 88211-0719

DISTRICT III
1000 Rio Brazos Rd., Artec, NM 87410

DISTRICT IV
P.O. Box 2088, Santa Fe, NM 87504-2088

State of New Mexico
Energy, Minerals and Natural Resources Department

Form C-10:
Revised February 10, 1994
Submit to Appropriate District Office
State Lease - 4 Copies
Fee Lease - 3 Copies

OIL CONSERVATION DIVISION

P.O. Box 2088
Santa Fe, New Mexico 87504-2088

☐ AMENDED REPORT

WELL LOCATION AND ACREAGE DEDICATION PLAT

API Number 30-025-34068	Pool Code 55860	Pool Name Wildcat Shoebar Deviation 4
Property Code 21102	Property Name EIDSON "23"	Well Number 1
OGRID No. 036554	Operator Name TMBR/SHARP DRILLING, INC.	Elevation 3973

Surface Location

UL or lot No.	Section	Township	Range	Lot Idn	Feet from the	North/South line	Feet from the	East/West line	County
L	23	16 S	35 E		1980	SOUTH	660	WEST	LEA

Bottom Hole Location If Different From Surface

UL or lot No.	Section	Township	Range	Lot Idn	Feet from the	North/South line	Feet from the	East/West line	County
Dedicated Acres 40	Joint or Infill	Consolidation Code	Order No.						

NO ALLOWABLE WILL BE ASSIGNED TO THIS COMPLETION UNTIL ALL INTERESTS HAVE BEEN CONSOLIDATED
OR A NON-STANDARD UNIT HAS BEEN APPROVED BY THE DIVISION

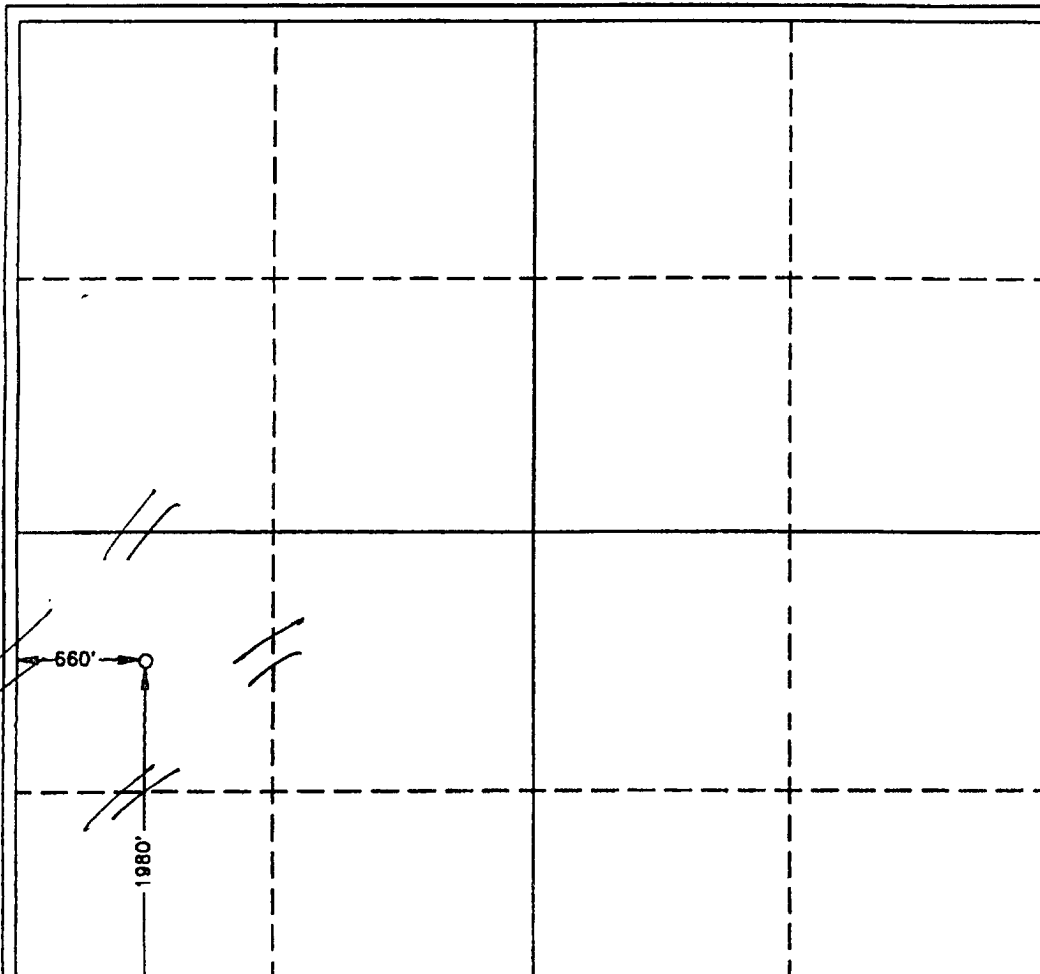

OPERATOR CERTIFICATION

I hereby certify the information contained herein is true and complete to the best of my knowledge and belief.

Signature
Jeff Phillips
Printed Name
Engineering Manager
Title
7/17/97
Date

SURVEYOR CERTIFICATION

I hereby certify that the well location shown on this plat was plotted from field notes of actual surveys made by me or under my supervision, and that the same is true and correct to the best of my belief.

JULY 10, 1997

Date Surveyed
Signature
Professional Surveyor
J. EIDSON
7-11-97
7-11-97
7-11-97