

## DISTRICT I

1825 N. French Dr., Hobbs, NM 88240

Phone (575) 393-6161 Fax: (575) 393-0720

## DISTRICT II

1301 W. Grand Avenue, Artesia, NM 88210

Phone (575) 748-1283 Fax: (575) 748-9720

## DISTRICT III

1000 Rio Brazos Rd., Aztec, NM 87410

Phone (505) 334-6178 Fax: (505) 334-6170

## DISTRICT IV

1220 S. St. Francis Dr., Santa Fe, NM 87505

Phone (505) 478-3480 Fax: (505) 478-3462

HOBBS OCD

APR 05 2012

RECEIVED

State of New Mexico  
Energy, Minerals and Natural Resources Department

## OIL CONSERVATION DIVISION

1220 South St. Francis Dr.  
Santa Fe, New Mexico 87505

Form C-102

Revised August 1, 2011

Submit one copy to appropriate  
District Office

## WELL LOCATION AND ACREAGE DEDICATION PLAT

☐ AMENDED REPORT

API Number 30-025-40514	Pool Code 5535	Pool Name Berry Bone	Well Number 1H
Property Code 39146	Property Name GUAVA "BRU" STATE		Elevation 3698'
OGRID No. 025575	Operator Name YATES PETROLEUM CORP.		

## Surface Location

UL or lot No.	Section	Township	Range	Lot Idn	Feet from the	North/South line	Feet from the	East/West line	County
D	32	20 S	35 E		175	NORTH	660	WEST	LEA

## Bottom Hole Location If Different From Surface

UL or lot No.	Section	Township	Range	Lot Idn	Feet from the	North/South line	Feet from the	East/West line	County
E	32	20 S	35 E		2310	NORTH	660	WEST	LEA

Dedicated Acres	Joint or Infill	Consolidation Code	Order No.
80			

NO ALLOWABLE WILL BE ASSIGNED TO THIS COMPLETION UNTIL ALL INTERESTS HAVE BEEN CONSOLIDATED  
OR A NON-STANDARD UNIT HAS BEEN APPROVED BY THE DIVISION

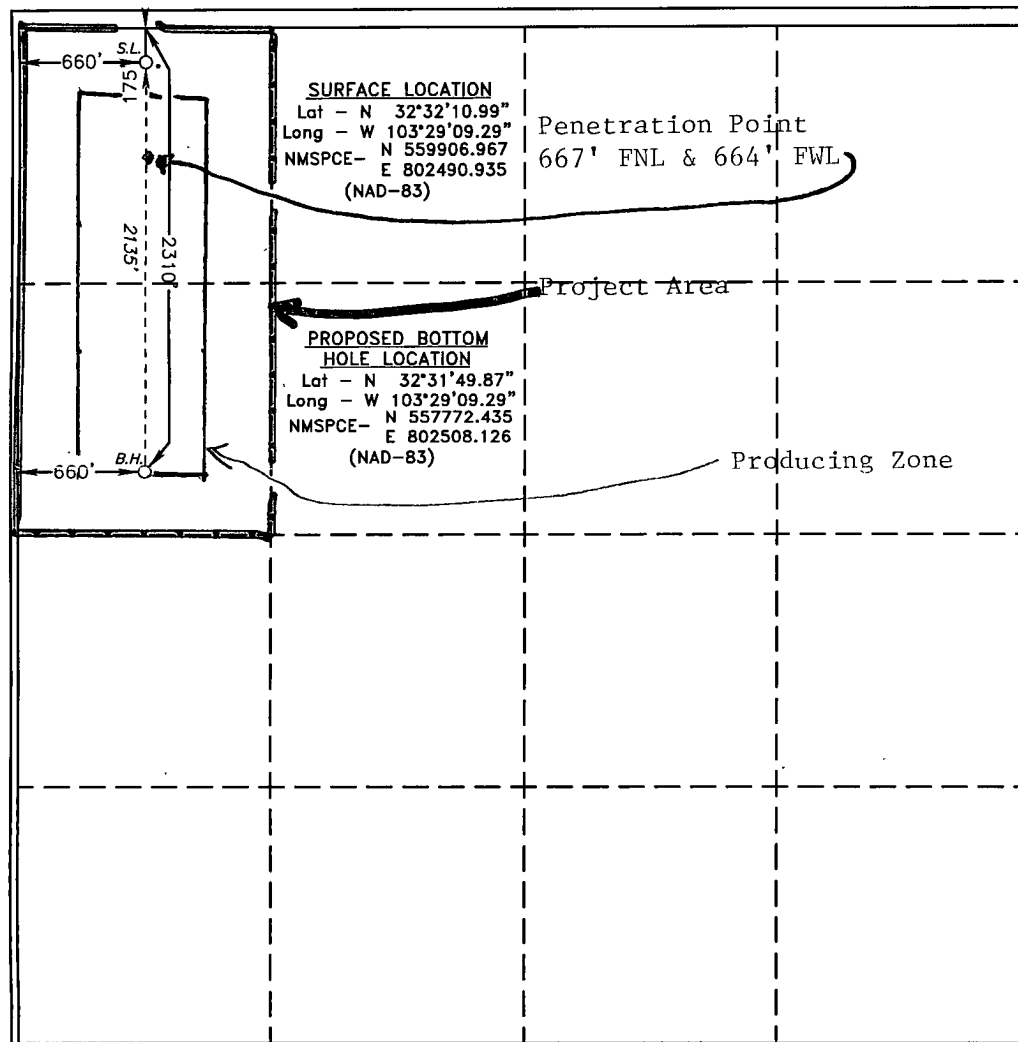

## OPERATOR CERTIFICATION

I hereby certify that the information contained herein is true and complete to the best of my knowledge and belief, and that this organization either owns a working interest or unleased mineral interest in the land including the proposed bottom hole location or has a right to drill this well at this location pursuant to a contract with an owner of such a mineral or working interest, or to a voluntary pooling agreement or a compulsory pooling order heretofore entered by the division.

Signature: Clifton May Date: 4/3/12

Printed Name: Clifton May  
Email Address: cliff@yatespetroleum.com

## SURVEYOR CERTIFICATION

I hereby certify that the well location shown on this plat was plotted from field notes of actual surveys made by me or under my supervision, and that the same is true and correct to the best of my belief.

Date Surveyed: APR 10 2012

Signature: [Signature] Seal of Professional Surveyor: 7977

Certificate No. Gary L. Jones 7977

BASIN SURVEYS 25400

APR 10 2012