

UNITED STATES
DEPARTMENT OF THE INTERIOR
BUREAU OF LAND MANAGEMENT
BSCD-HOBBSFORM APPROVED
OMB NO. 1004-0135
Expires: November 30, 2000**SUNDRY NOTICES AND REPORTS ON WELLS**
*Do not use this form for proposals to drill or to re-enter an abandoned well. Use form 3160-3 (APD) for such proposals.***SUBMIT IN TRIPLICATE - Other instructions on reverse side.**

1. Type of Well

☒ Oil Well ☐ Gas Well ☐ Other

2. Name of Operator

YATES PETROLEUM CORPORATION

Contact:

ROBERT ASHER

E-Mail: basher@ypcnm.com

3a. Address

105 SOUTH 4TH STREET
ARTESIA, NM 88210

3b. Phone No. (include area code)

Ph: 505.748.4364

Fx: 505.748.4572

4. Location of Well (Footage, Sec., T., R., M., or Survey Description)

Sec 28 T23S R32E NWSW 1980FSL 660FWL

8. Well Name and No.

CONTINENTAL APJ FEDERAL 6

9. API Well No.

30-025-36111-00-X1

10. Field and Pool, or Exploratory

DIAMONDTAIL DELAWARE

11. County or Parish, and State

LEA COUNTY, NM

12. CHECK APPROPRIATE BOX(ES) TO INDICATE NATURE OF NOTICE, REPORT, OR OTHER DATA

TYPE OF SUBMISSION	TYPE OF ACTION			
<input checked="" type="checkbox"/> Notice of Intent	<input type="checkbox"/> Acidize	<input type="checkbox"/> Deepen	<input type="checkbox"/> Production (Start/Resume)	<input type="checkbox"/> Water Shut-Off
<input type="checkbox"/> Subsequent Report	<input type="checkbox"/> Alter Casing	<input type="checkbox"/> Fracture Treat	<input type="checkbox"/> Reclamation	<input type="checkbox"/> Well Integrity
<input type="checkbox"/> Final Abandonment Notice	<input type="checkbox"/> Casing Repair	<input type="checkbox"/> New Construction	<input type="checkbox"/> Recomplete	<input checked="" type="checkbox"/> Other
	<input type="checkbox"/> Change Plans	<input type="checkbox"/> Plug and Abandon	<input type="checkbox"/> Temporarily Abandon	
	<input type="checkbox"/> Convert to Injection	<input type="checkbox"/> Plug Back	<input type="checkbox"/> Water Disposal	

13. Describe Proposed or Completed Operation (clearly state all pertinent details, including estimated starting date of any proposed work and approximate duration thereof. If the proposal is to deepen directionally or recomplete horizontally, give subsurface locations and measured and true vertical depths of all pertinent markers and zones. Attach the Bond under which the work will be performed or provide the Bond No. on file with BLM/BIA. Required subsequent reports shall be filed within 30 days following completion of the involved operations. If the operation results in a multiple completion or recompletion in a new interval, a Form 3160-4 shall be filed once testing has been completed. Final Abandonment Notices shall be filed only after all requirements, including reclamation, have been completed, and the operator has determined that the site is ready for final inspection.)

Yates Petroleum Corporation wishes to amend the surface use plan to include a 3" SDR poly flowline on the surface to follow the road to the #1 well located in the NENW of Section 28-T23S-R32E.

SEE ATTACHED MAP.

Thank you.

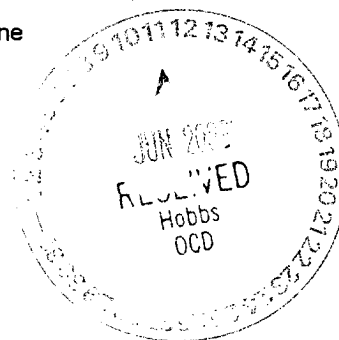

14. I hereby certify that the foregoing is true and correct.

Electronic Submission #20795 verified by the BLM Well Information System

For YATES PETROLEUM CORPORATION, sent to the Hobbs

Committed to AFMSS for processing by Linda Askwig on 04/22/2003 (03LA0158SE)

Name (Printed/Typed) CLIFTON R. MAY

Title REGULATORY AGENT

Signature (Electronic Submission)

Date 04/18/2003

THIS SPACE FOR FEDERAL OR STATE OFFICE USE

Approved By

/S/ JOE G. LARA

Acting

FIELD MANAGER

JUN 09 2003

Conditions of approval, if any, are attached. Approval of this notice does not warrant or certify that the applicant holds legal or equitable title to those rights in the subject lease which would entitle the applicant to conduct operations thereon.

Office CARLSBAD FIELD OFFICE

Title 18 U.S.C. Section 1001 and Title 43 U.S.C. Section 1212, make it a crime for any person knowingly and willfully to make to any department or agency of the United States any false, fictitious or fraudulent statements or representations as to any matter within its jurisdiction.

**** REVISED ** REVISED ** REVISED ** REVISED ** REVISED ** REVISED ** REVISED ****

GWW

SECTION 28, TOWNSHIP 23 SOUTH, RANGE 32 EAST, NMPM, LEA COUNTY, NEW MEXICO.

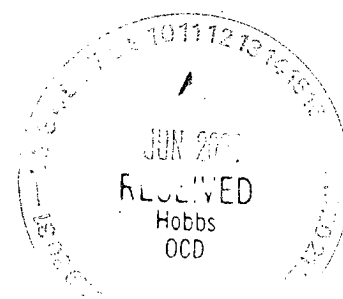
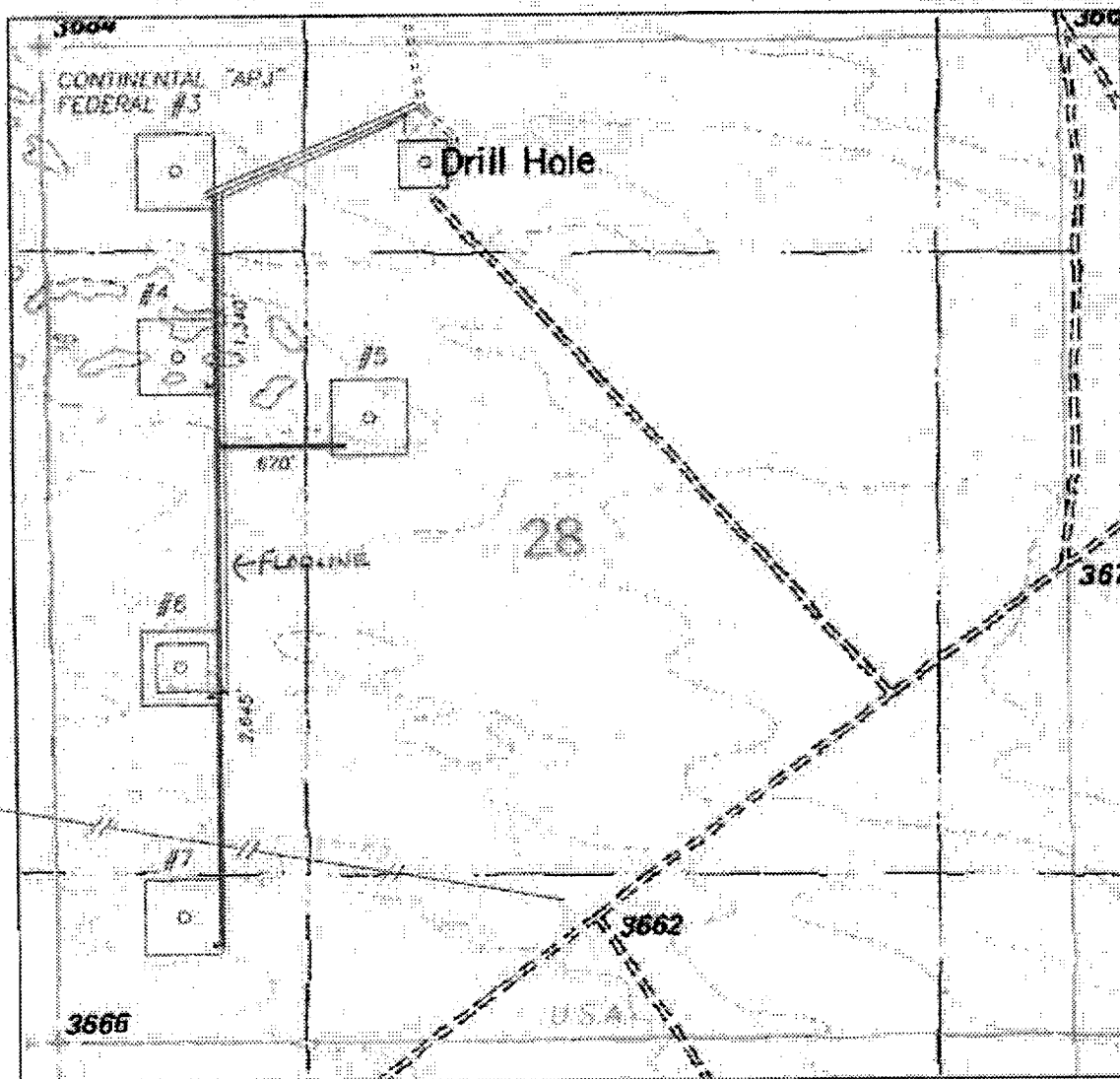

1000' 0 1000' 2000'
Scale 1" = 1000'

THE PREPARATION OF THIS PLAT AND THE PERFORMANCE OF THE SURVEY UPON WHICH IT IS BASED WERE DONE UNDER MY DIRECTION AND THE PLAT ACCURATELY DEPICTS THE RESULTS OF SAID SURVEY AND MEET THE REQUIREMENTS OF THE STATUTES FOR LAND SURVEYS IN NEW MEXICO AS ADOPTED BY THE NEW MEXICO STATE BOARD OF REGISTRATION FOR PROFESSIONAL ENGINEERS AND LAND SURVEYORS.



HERSCHEL L. JONES R.L.S. No. 3640

GENERAL SURVEYING COMPANY P.O. BOX 1928
LOVINGTON, NEW MEXICO 88260

YATES PETROLEUM CORP.

LEASE ROAD TO ACCESS THE YATES CONTINENTAL "APJ"
FEDERAL #4, 5, 6, & 7 WELLS, LOCATED IN SECTION 28,
TOWNSHIP 23 SOUTH, RANGE 32 EAST, NMPM, LEA COUNTY,
NEW MEXICO.

Survey Date: 12/09/2002	Sheet 1 of 1 Sheets
Drawn By: Ed Blevins	W.O. Number
Date: 12/09/02	Scale 1" = 1000' CONTINENTAL