

UNITED STATES  
DEPARTMENT OF THE INTERIOR  
BUREAU OF LAND MANAGEMENT

OCD-HOBBS

HOBBS OCD

SEP 08 2012

FORM APPROVED  
OMB No. 1004-0137  
Expires: March 31, 2007

SUNDRY NOTICES AND REPORTS ON WELLS

Do not use this form for proposals to drill or to re-enter an  
abandoned well Use Form 3160-3 (APD) for such proposals  
SUBMIT IN TRIPLICATE - Other instructions on reverse side.

1. Type of Well <input checked="" type="checkbox"/> Oil Well <input type="checkbox"/> Gas Well <input type="checkbox"/> Other		5. Lease Serial No. <b>NMNM-90161</b>
2. Name of Operator Apache Corporation		6. If Indian, Allottee or Tribe Name <b>NA</b>
3a. Address <b>PO Box 1849 Eunice, NM 88231</b>		7. If Unit of CA / Agreement, Name and/or No. <b>NA</b>
3b. Phone No. (include area code) <b>575-390-4186</b>		8. Well Name and No. <b>WBDU #51</b>
4. Location of (Footage, Sec., T., R., or Survey Description) <b>185'FSL 2460'FEL Unit O, 9-21S-37E</b>		9. API Well No. <b>30-025-38197</b>
		10. Field and Pool, or Exploratory Area <b>Eunice Blinbry Tubb Drinkard North 22900</b>
		11. County or Parish, State <b>Lea, NM</b>

12. CHECK APPROPRIATE BOX(ES) TO INDICATE NATURE OF NOTICE, REPORT, OR OTHER DATA

TYPE OF SUBMISSION	TYPE OF ACTION			
<input checked="" type="checkbox"/> Notice of Intent	<input type="checkbox"/> Acidize	<input type="checkbox"/> Deepen	<input type="checkbox"/> Production (Start/Resume)	<input type="checkbox"/> Water Shut-off
<input type="checkbox"/> Subsequent Report	<input type="checkbox"/> Alter Casing	<input type="checkbox"/> Fracture Treat	<input checked="" type="checkbox"/> Reclamation	<input type="checkbox"/> Well Integrity
<input type="checkbox"/> Final Abandonment Notice	<input type="checkbox"/> Casing Repair	<input type="checkbox"/> New Construction	<input type="checkbox"/> Recomplete	<input checked="" type="checkbox"/> Other Downsize
	<input type="checkbox"/> Change Plans	<input type="checkbox"/> Plug and Abandon	<input type="checkbox"/> Temporarily Abandon	<b>Reseeding</b>
	<input type="checkbox"/> Convert to Injection	<input type="checkbox"/> Plug Back	<input type="checkbox"/> Water Disposal	

13. Describe Proposed or Completed Operation (clearly state all pertinent details, including estimated starting date of any proposed work and approximate duration thereof. If the proposal is to deepen directionally or recompleat horizontally, give subsurface locations and measured and true vertical depths of all pertinent markers and zones following completion of the involved operations. If the operation results in multiple completion or recompleat in a new interval, a Form 3160-4 shall be filed once testing has been completed. Final Abandonment Notices shall be filed only after all requirements, including reclamation, have been completed, and the operator has determined that the site is ready for final inspection )

This well was drilled in 2007, site was downsized on 9/22/2011 and was reseeded on 09/27/2011. BLM Seed #2 was added per the APD. This site was watered for total of five days. Location drawing attached.

ACCEPTED FOR RECORD

SEP 4 2012

/s/ James A. Amos

BUREAU OF LAND MANAGEMENT  
CARLSBAD FIELD OFFICE

14. I hereby certify that the following is true and correct  
Name

**Natalie Gladden**

Title

**EHS Environmental Tech**

Signature

Date

**2/8/12**

THIS SPACE FOR FEDERAL OR STATE OFFICE USE

Approved by

Title

Date

Conditions of approval, if any, are attached. Approval of this notice does not warrant or certify that the applicant holds legal or equitable title to those rights in the subject lease which would entitle the applicant to conduct operations thereon.

Office

Title 18 U.S.C., Section 1001 and Title 43 U.S.C., Section 1212, make it a crime for any person knowingly and willfully to make to any department or agency of the United States any false, fictitious or fraudulent statements or representations as to any matter within its jurisdiction.

(Instructions on page 2)

MW/OCD 09-07-2012

SEP 10 2012

# ( Down size, location pad. )

Date / /

Lease name WBDU Well # 51

## Notes:

- #1, Before &, after location size.
- #2, Where the electric cable pole is located.
- #3, Date and year of down size.
- #4, Draw road direction coming in, and direction of pump jack.
- #5, Leave more space towards front of P/Jack head, or side away flow line.
- #6, Don't remove entrance road coming into location.

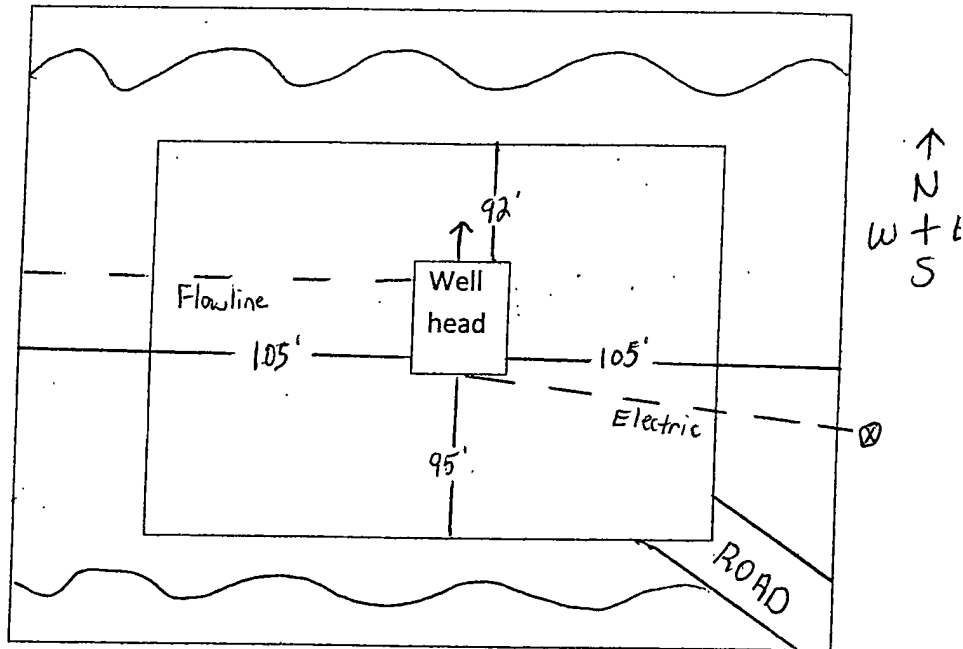

( A ) Before down size.	260 x 210
( B ) After down size.	187 x 210
( C ) Caliche dirt Destiny.	

Description. Downsize Location

( Operator Name ) \_\_\_\_\_ Date / /