

UNITED STATES  
DEPARTMENT OF THE INTERIOR  
BUREAU OF LAND MANAGEMENT

OCD-HOBBS

FORM APPROVED  
OMB No. 1004-0137  
Expires: March 31, 2007

HOBBS OCD

SUNDRY NOTICES AND REPORTS ON WELLS

Do not use this form for proposals to drill or to re-enter an  
abandoned well Use Form 3160-3 (APD) for such proposals

SUBMIT IN TRIPLICATE - Other instructions on reverse side.

SEP 06 2012

RECEIVED

1. Type of Well <input checked="" type="checkbox"/> Oil Well <input type="checkbox"/> Gas Well <input type="checkbox"/> Other		5. Lease Serial No. <b>NM90161</b>
2. Name of Operator Apache Corporation		6. If Indian, Allottee or Tribe Name <b>NA</b>
3a. Address <b>PO Box 1849 Eunice, NM 88231</b>		7. If Unit of CA / Agreement, Name and/or No. <b>WBDU 37346</b>
3b. Phone No. (include area code) <b>575-390-4186</b>		8. Well Name and No. <b>WBDU Unit 106</b>
4. Location of (Footage, Sec., T., R., or Survey Description) <b>2310' FSL and 2310' FEL S8, T21S, R37E Unit J Split Estate</b>		9. API Well No. <b>30-025-39407</b>
		10. Field and Pool, or Exploratory Area <b>Eunice Blinb, TU, Drink N</b>
		11. County or Parish, State <b>Lea, NM</b>

12. CHECK APPROPRIATE BOX(ES) TO INDICATE NATURE OF NOTICE, REPORT, OR OTHER DATA

TYPE OF SUBMISSION	TYPE OF ACTION			
<input checked="" type="checkbox"/> Notice of Intent	<input type="checkbox"/> Acidize	<input type="checkbox"/> Deepen	<input type="checkbox"/> Production (Start/Resume)	<input type="checkbox"/> Water Shut-off
<input type="checkbox"/> Subsequent Report	<input type="checkbox"/> Alter Casing	<input type="checkbox"/> Fracture Treat	<input checked="" type="checkbox"/> Reclamation	<input type="checkbox"/> Well Integrity
<input type="checkbox"/> Final Abandonment Notice	<input type="checkbox"/> Casing Repair	<input type="checkbox"/> New Construction	<input type="checkbox"/> Recomplete	<input checked="" type="checkbox"/> Other Downsize
	<input type="checkbox"/> Change Plans	<input type="checkbox"/> Plug and Abandon	<input type="checkbox"/> Temporarily Abandon	<b>Reseeding</b>
	<input type="checkbox"/> Convert to Injection	<input type="checkbox"/> Plug Back	<input type="checkbox"/> Water Disposal	

13. Describe Proposed or Completed Operation (clearly state all pertinent details, including estimated starting date of any proposed work and approximate duration thereof. If the proposal is to deepen directionally or recompleat horizontally, give subsurface locations and measured and true vertical depths of all pertinent markers and zones. Attach the Bond under which the work will be performed or provide the bond No. on file with the BLM / BIA. Required subsequent reports shall be filed within 30 days following completion of the involved operations. If the operation results in multiple completion or recompleat in a new interval, a Form 3160-4 shall be filed once testing has been completed. Final Abandonment Notices shall be filed only after all requirements, including reclamation, have been completed, and the operator has determined that the site is ready for final inspection.)

This well was drilled in early 2010, site was downsized on 7/29/2011 and was reseeded on 7/29/2011. BLM Seed #2 was added per the APD. This site was watered for total of five days. Location drawing attached.

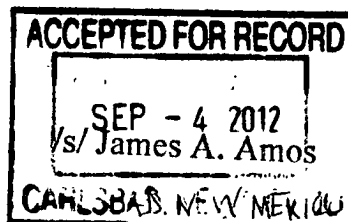

14. I hereby certify that the following is true and correct	
Name <b>Natalie Gladden</b>	Title <b>EHS Environmental Tech</b>
Signature <i>Natalie Gladden</i>	Date <b>2/8/12</b>

THIS SPACE FOR FEDERAL OR STATE OFFICE USE

Approved by	Title	Date
Conditions of approval, if any, are attached. Approval of this notice does not warrant or certify that the applicant holds legal or equitable title to those rights in the subject lease which would entitle the applicant to conduct operations thereon.	Office	

Title 18 U.S.C., Section 1001 and Title 43 U.S.C., Section 1212, make it a crime for any person knowingly and willfully to make to any department or agency of the United States any false, fictitious or fraudulent statements or representations as to any matter within its jurisdiction

(Instructions on page 2)

MW/OCD 09-07-2012

SEP 10 2012

( Down size, location pad. )

Date / /

Lease name WBOU Well # 106

Notes:

#1, Before &, after location size.

#2, Where the electric cable pole is located.

#3, Date and year of down size.

#4, Draw road direction coming in, and direction of pump jack.

#5, Leave more space towards front of P/Jack head, or side away flow line.

#6, Don't remove entrance road coming into location.

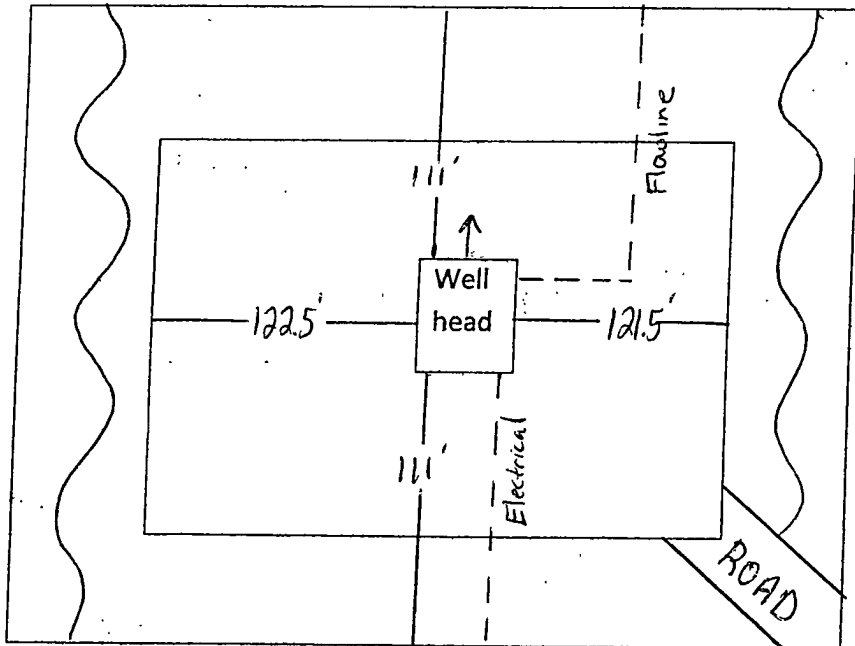

( A ) Before down size.	283 x 222
( B ) After down size.	244 x 222
( C ) Caliche dirt Destiny.	

Description. Downsized Location

( Operator Name ) \_\_\_\_\_ Date / /