

District I
PO Box 1980, Hobbs, NM 88241-1980
District II
PO Drawer DD, Artesia, NM 88211-0719
District III
1000 Rio Brazos Rd., Aztec, NM 87410
District IV
PO Box 2088, Santa Fe, NM 87504-2088

State of New Mexico
Energy, Minerals & Natural Resources Department

OIL CONSERVATION DIVISION
PO Box 2088
Santa Fe, NM 87504-2088

Form C-101
Revised February 10, 1994
Instructions on back
Submit to Appropriate District Office
State Lease - 6 Copies
Fee Lease - 5 Copies

☒ AMENDED REPORT

APPLICATION FOR PERMIT TO DRILL, RE-ENTER, DEEPEN, PLUGBACK, OR ADD A ZONE

Operator Name and Address: Chesapeake Operating, Inc. P. O. Box 18496 Oklahoma City, OK 73154-0496		OGRID Number 147179
		API Number 30 - 025-34670
Property Code 24773	Property Name MEAGAN 12	Well No. 1

7 Surface Location

UL or lot no.	Section	Township	Range	Lot Idn	Feet from the	North/South line	Feet from the	East/West line	County
J	12	16S	35E		2148	S	2222	E	LEA

8 Proposed Bottom Hole Location If Different From Surface

UL or lot no.	Section	Township	Range	Lot Idn	Feet from the	North/South line	Feet from the	East/West line	County
Proposed Pool 1 Townsend Morrow					Proposed Pool 2				

Work Type Code N	Well Type Code G	Cable/Rotary R	Lease Type Code P/S	Ground Level Elevation 3965'
Multiple No	Proposed Depth 12,750'	Formation Morrow	Contractor Patterson	Spud Date Well Spud

21 Proposed Casing and Cement Program

Hole Size	Casing Size	Casing weight/foot	Setting Depth	Sacks of Cement	Estimated TOC
17-1/2"	13-3/8"	48#	490'	495	Surface
12-1/4"	9-5/8"	40#	4210'	1587	Surface
7-7/8"	5-1/2"	17#	12,750'	1500	± 4000'

Describe the proposed program. If this application is to DEEPEN or PLUG BACK give the data on the present productive zone and proposed new productive zone. Describe the blowout prevention program, if any. Use additional sheets if necessary.

Chesapeake Operating, Inc. proposes to drill to 12,750' TD in the Morrow formation with Patterson as the drilling contractor.

Patterson's BOP stack consists of 11" 5M# blind & pipe rams & 11" 5M# Annular.

Permit Expires 1 Year From Approval
Date Unless Drilling Underway
Deepen

I hereby certify that the information given above is true and complete to the best of my knowledge and belief.

Signature: *Barbara J. Bale*

Printed name: Barbara J. Bale

Title: Regulatory Analyst

Date: 08/31/99

Phone: (405)848-8000

OIL CONSERVATION DIVISION

Approved by: *Paul Kautz*

Title: *REGULATORY ANALYST*

Approval Date: SEP 07 1999

Expiration Date:

Conditions of Approval:
Attached ☐

DISTRICT I
P.O. Box 1988, Hobbs, NM 88241-1988

DISTRICT II
P.O. Drawer 80, Artesia, NM 88211-0719

DISTRICT III
1000 Rio Brazos Rd., Artec, NM 87410

DISTRICT IV
P.O. BOX 2088, SANTA FE, N.M. 87504-2088

State of New Mexico
Energy, Minerals and Natural Resources Department

Form C-102
Revised February 10, 1994
Submit to Appropriate District Office
State Lease - 4 Copies
Fee Lease - 3 Copies

OIL CONSERVATION DIVISION

P.O. Box 2088
Santa Fe, New Mexico 87504-2088

☐ AMENDED REPORT

WELL LOCATION AND ACREAGE DEDICATION PLAT

API Number <u>30-025-34670</u>	Pool Code <u>86400</u>	Pool Name <u>Townsend; Morrow</u>
Property Code <u>24773</u>	Property Name <u>MEAGAN 12</u>	Well Number <u>1</u>
OGRID No. <u>147179</u>	Operator Name <u>CHESAPEAKE OPERATING, INC.</u>	Elevation <u>3965</u>

Surface Location

UL or lot No. <u>J</u>	Section <u>12</u>	Township <u>16 S</u>	Range <u>35 E</u>	Lot Idn	Feet from the <u>2148</u>	North/South line <u>SOUTH</u>	Feet from the <u>2222</u>	East/West line <u>EAST</u>	County <u>LEA</u>
---------------------------	----------------------	-------------------------	----------------------	---------	------------------------------	----------------------------------	------------------------------	-------------------------------	----------------------

Bottom Hole Location If Different From Surface

UL or lot No.	Section	Township	Range	Lot Idn	Feet from the	North/South line	Feet from the	East/West line	County
Dedicated Acres <u>320</u>		Joint or Infill	Consolidation Code	Order No.					

NO ALLOWABLE WILL BE ASSIGNED TO THIS COMPLETION UNTIL ALL INTERESTS HAVE BEEN CONSOLIDATED
OR A NON-STANDARD UNIT HAS BEEN APPROVED BY THE DIVISION

		NME NAD 27 Y-705122 X-783525 LAT. 32°56'06.14" LONG. 103°24'33.25"			
		2148'		2222'	
		320 ac.			

OPERATOR CERTIFICATION

I hereby certify the the information contained herein is true and complete to the best of my knowledge and belief.

Linda F. Townsend
Signature
Linda F. Townsend
Printed Name
Landman
Title
8-31-99
Date

SURVEYOR CERTIFICATION

I hereby certify that the well location shown on this plat was plotted from field notes of actual surveys made by me or under my supervision, and that the same is true and correct to the best of my belief.

JULY 27, 1999

Date Surveyed
Signature
Professional Surveyor
NEW MEXICO
3239
7-28-99
REGISTERED PROFESSIONAL SURVEYOR
Cert. No. RONALD G. McDONALD 3239
12641
12185

LOCATION VERIFICATION MAP

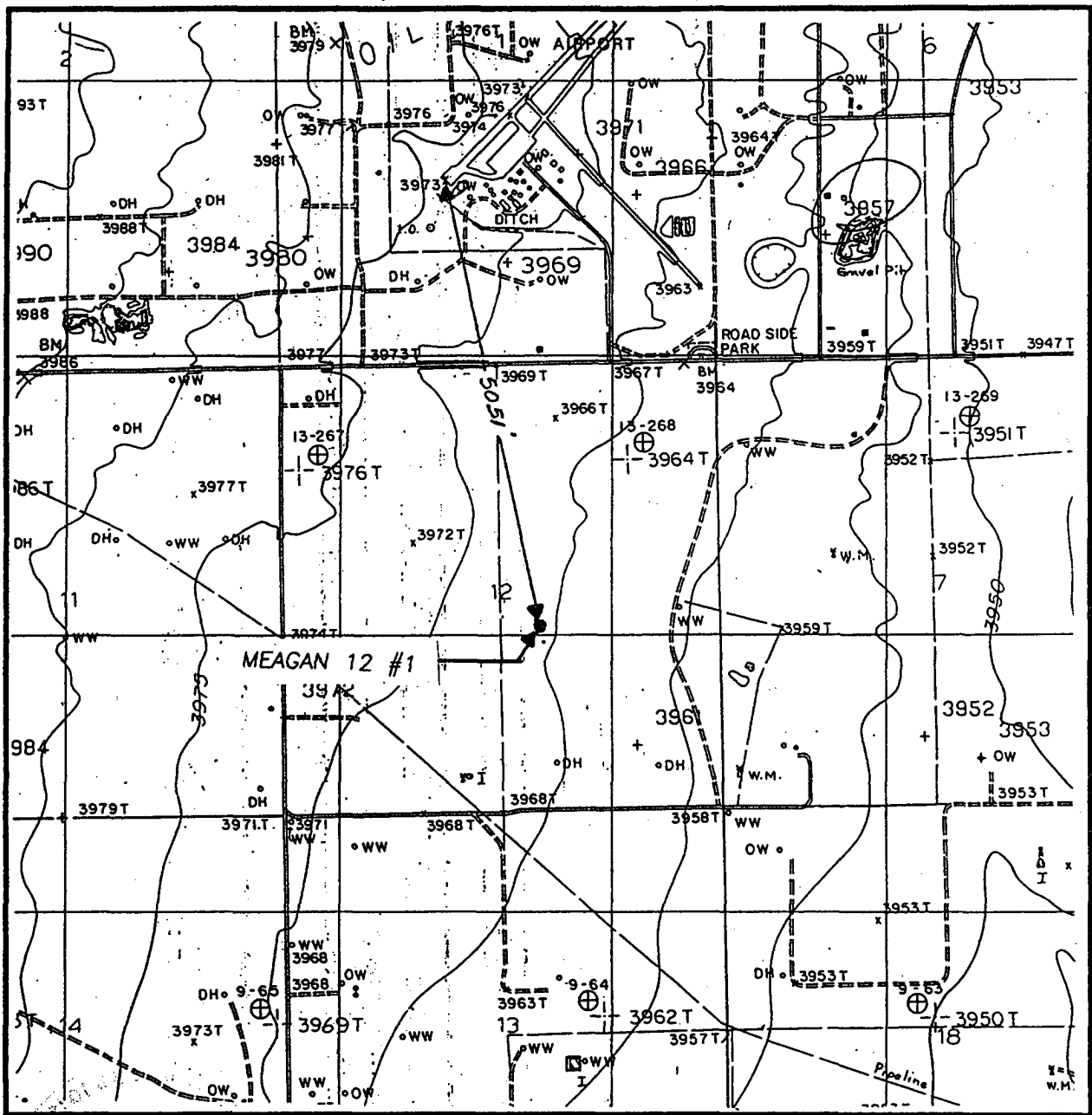

SCALE: 1" = 2000'

CONTOUR INTERVAL:
LOVINGTON NW - 5'

SEC. 12 TWP. 16-S RGE. 35-E

SURVEY N.M.P.M.

COUNTY LEA

DESCRIPTION 2148 FSL & 2222' FEL

ELEVATION 3965

OPERATOR CHESAPEAKE OPERATING, INC.

LEASE MEAGAN 12

U.S.G.S. TOPOGRAPHIC MAP

LOVINGTON NW, N.M.

JOHN WEST SURVEYING
HOBBS, NEW MEXICO
(505) 393-3117

VICINITY MAP

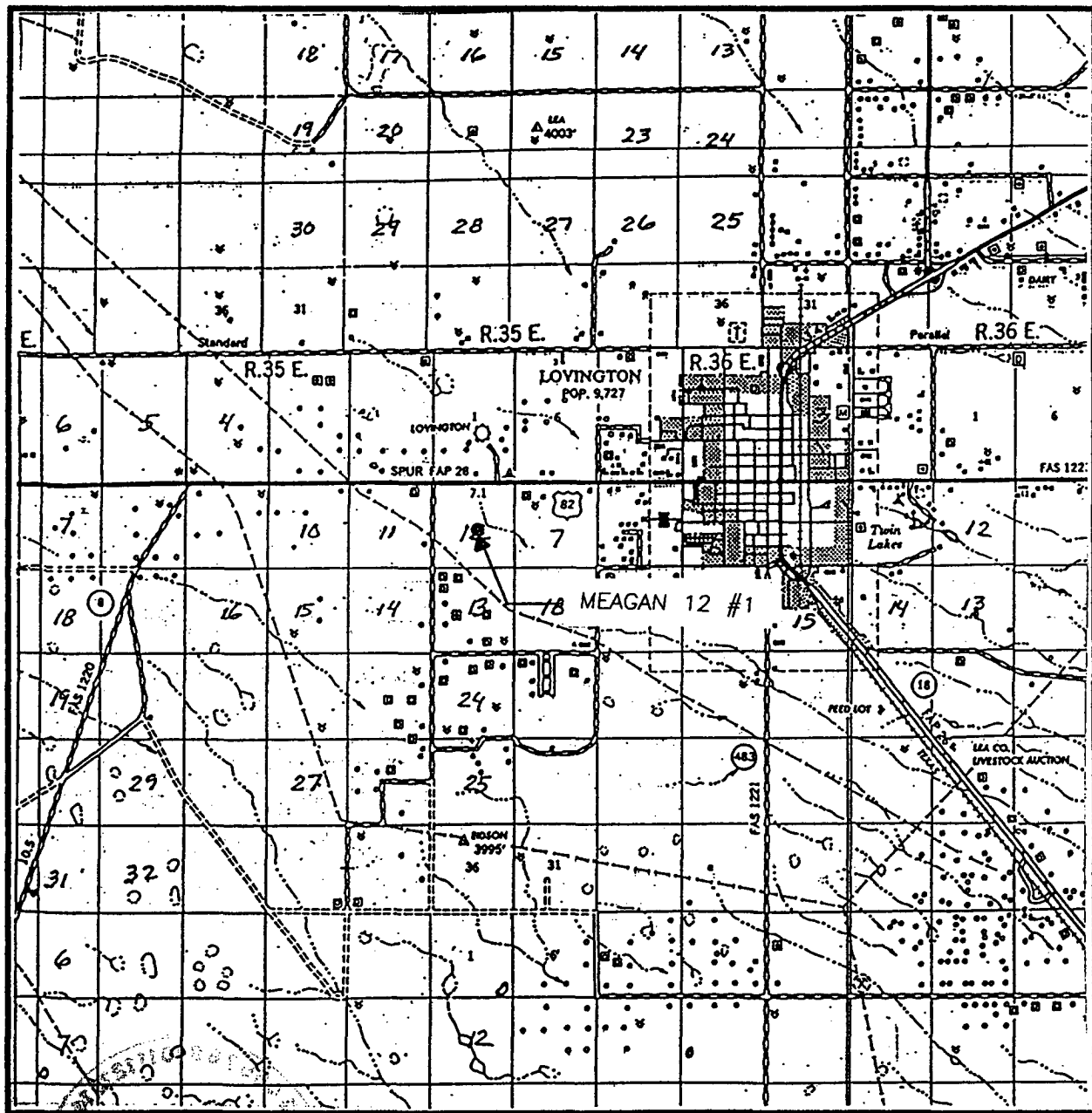

SCALE: 1" = 2 MILES

SEC. 12 TWP. 16-S RGE. 35-E

SURVEY N.M.P.M.

COUNTY LEA

DESCRIPTION 2148 FSL & 2222' FEL

ELEVATION 3965

OPERATOR CHESAPEAKE OPERATING, INC.

LEASE MEAGAN 12

JOHN WEST SURVEYING
HOBBS, NEW MEXICO
(505) 393-3117

