

District I
1625 N. French Dr., Hobbs, NM 88240
District II
1301 W. Grand Ave., Artesia, NM 88210
District III
1000 Rio Brazos Rd., Aztec, NM 87410
District IV
1220 S. St. Francis Dr., Santa Fe, NM 87505

OIL CONSERVATION DIVISION
1220 South St. Francis Dr.
Santa Fe, NM 87505

WELL API NO. 30-045-32836
5. Indicate Type of Lease STATE <input type="checkbox"/> FEE <input type="checkbox"/>
6. State Oil & Gas Lease No.
7. Lease Name or Unit Agreement Name Atlantic LS (BLM NM 013688)
8. Well Number 2 C
9. OGRID Number 000778
10. Pool name or Wildcat Blanco Mesaverde

SUNDRY NOTICES AND REPORTS ON WELLS
(DO NOT USE THIS FORM FOR PROPOSALS TO DRILL OR TO DEEPEN OR PLUG BACK TO A DIFFERENT RESERVOIR. USE "APPLICATION FOR PERMIT" (FORM C-101) FOR SUCH PROPOSALS.)

1. Type of Well: Oil Well ☐ Gas Well ☒ Other

2. Name of Operator
BP AMERICA PRODUCTION COMPANY

3. Address of Operator
P.O. BOX 3092 HOUSTON, TX 77079-2064

4. Well Location
Unit Letter **J** : **2105** feet from the **South** line and **1500** feet from the **East** line
Section **24** Township **31N** Range **109W** **NMPM SAN JUAN** County

11. Elevation (Show whether DR, RKB, RT, GR, etc.)
6610'

Pit or Below-grade Tank Application ☒ or Closure ☐

Pit type **DRILLING** Depth to Groundwater **>100'** Distance from nearest fresh water well **>1000'** Distance from nearest surface water **>1000'**

Pit Liner Thickness: **12** mil Below-Grade Tank: Volume **_____** bbls; Construction Material **_____**

12. Check Appropriate Box to Indicate Nature of Notice, Report or Other Data

NOTICE OF INTENTION TO:

PERFORM REMEDIAL WORK ☐ PLUG AND ABANDON ☐
TEMPORARILY ABANDON ☐ CHANGE PLANS ☐
PULL OR ALTER CASING ☐ MULTIPLE COMPL ☐

SUBSEQUENT REPORT OF:

REMEDIAL WORK ☐ ALTERING CASING ☐
COMMENCE DRILLING OPNS. ☐ P AND A ☐
CASING/CEMENT JOB ☐

OTHER: **LINED DRILLING PIT** ☒

OTHER: ☐

13. Describe proposed or completed operations. (Clearly state all pertinent details, and give pertinent dates, including estimated date of starting any proposed work). SEE RULE 1103. For Multiple Completions: Attach wellbore diagram of proposed completion or recompletion.

Construct a lined drilling pit per BP America – San Juan Basin Drilling/ Workover Pit Construction Plan issued date of 11/17/2004. Pit will be closed according to closure plan on file.

I hereby certify that the information above is true and complete to the best of my knowledge and belief. I further certify that any pit or below-grade tank has been/will be constructed or closed according to NMOCD guidelines ☒, a general permit ☐ or an (attached) alternative OCD-approved plan ☐.

SIGNATURE Cherry Hlava TITLE Regulatory Analyst DATE 05/10/2005

Type or print name Cherry Hlava E-mail address: hlavac1@bp.com Telephone No. 281-366-4081

For State Use Only

APPROVED BY: Denny Fent TITLE DEPUTY OIL & GAS INSPECTOR, DIST #2 DATE MAY 16 2005

Conditions of Approval (if any):

PAD LAYOUT PLAN & PROFILE
 BP AMERICA PRODUCTION COMPANY
 Atlantic LS #2C
 2105' F/SL 1500' F/EL
 SEC. 24, T31N, R10W, N.M.P.M.
 SAN JUAN COUNTY, NEW MEXICO

Lat: 36.8825°
 Long: 107.8325°

Lat: 36°52'57"
 Long: 107°49'57"

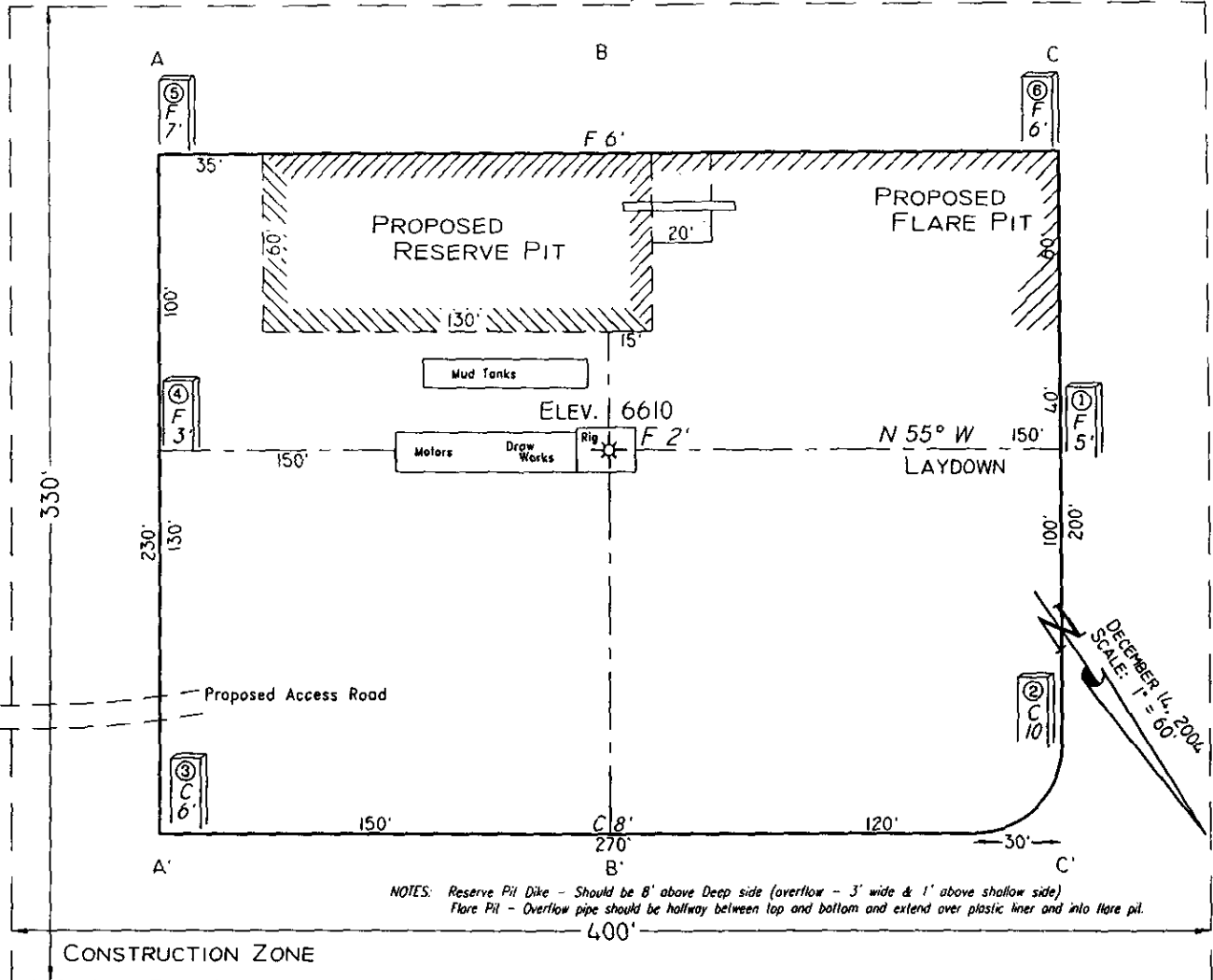

Area of Construction Zone - 330'x400' or 3.03 acres, more or less

SCALE: 1"=60'-HORIZ.
 1"=40'-VERT.

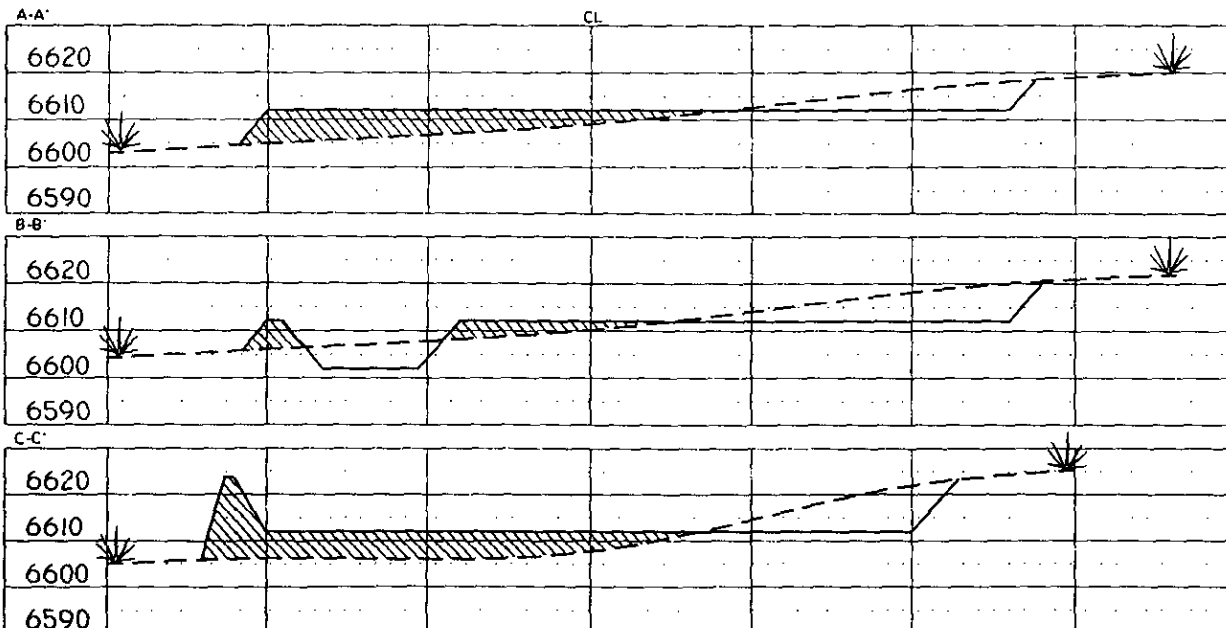

NOTE: Contractor should call One-Call for location of any marked or unmarked buried pipelines or cables on well pad and/or access road at least two (2) working days prior to construction.

Cuts and fills shown are approximate - final finished elevation is to be adjusted so earthwork will balance. Corner stakes are approximate and do not include additional areas needed for sideslopes and drainages. Final Pad Dimensions are to be verified by Contractor.

VANN SURVEYS
 P. O. Box 1306
 Farmington, NM