

DISTRICT I  
1625 N.Fmeh Dr., Hobbs, NM 88240  
DISTRICT II  
1301 W. Grand Avenue, Atesia, NM 88210  
DISTRICT III  
1000 Rio Brazos Road, Aztec, NM 87410  
DISTRICT IV  
2040 South Pacheco, Santa Fe, NM 87505

STATE OF NEW MEXICO  
Energy, Minerals and Natural Resources Department

Form C-101  
May 27, 2004

Submit to Appropriate District Office

OIL CONSERVATION DIVISION  
1220 South St. Francis Dr.  
Santa Fe, NM 87505

AMENDED REPORT

APPLICATION FOR PERMIT TO DRILL, RE-ENTER, DEEPEN, PLUGBACK, OR ADD A ZONE

1 Operator Name and Address PALADIN ENERGY CORP. 10290 Monroe Drive, Suite 301 Dallas, Texas 75229		2 OGRID Number 164070
4 Property Code 22557	5 Property Name South Vacuum Unit	3 API Number 30-025-37299
9 Proposed Pool 1 Vacuum Mckee, South 97368		6 Well No. 275
10 Proposed Pool 2		

7 Surface Location

UL or lot No.	Section	Township	Range	Lot. Ind	Feet from the	North/South Line	Feet from the	East/West Line	County
H	27	18-S	35-E		1700	North	760	East	Lea

8 Proposed Bottom Hole Location If Different From Surface

UL or lot No.	Section	Township	Range	Lot. Ind	Feet from the	North/South Line	Feet from the	East/West Line	County
G	27	18-S	35-E		1400	North	1980	East	Lea

Additional Well Information

11 Work Type Code N	12 Well Type Code G	13 Cable/Rotary Rotary	14 Lease Type Code S	15 Ground Level Elevation 3887'
16 Multiple No	17 Proposed depth 15,000	18 Formation Granite Wash	19 Contractor Patterson	20 Spud Date 6/24/2005
Depth to Groundwater: approx 68'		Distance from nearest fresh water well 1/2 mile plus		
Distance from nearest surface water: Playa - 1100 feet				
Pit: Liner: Synthetic <input checked="" type="checkbox"/>	12 mils thick Clay <input type="checkbox"/>	Pit Volume: 14,366 bbls	Drilling Method: Fresh Water <input type="checkbox"/>	
Closed-Loop System <input type="checkbox"/>		Brine <input checked="" type="checkbox"/>	Disel/Oil-Based <input type="checkbox"/>	Gas/Air <input type="checkbox"/>

21 Proposed Casing and Cement Program

Hole Size	Casing Size	Casing weight/foot	Setting Depth	Sacks Cement	Estimated TOC
17-1/2"	13-3/8"	48#	420'	450	Sur
12-1/4"	9-5/8"	40#	3,900'	1300	
8-3/4"	7"	26# & 29#	12,500	700	7500'
6-1/4"	5"	18#	15,000	250	12,000'

22 Describe the proposed program. If this application is to DEEPEN or PLUG BACK give the data on the present productive zone and proposed new productive zone. Describe the blowout prevention program, if any. Use additional sheets if necessary.

Drill 17-1/2" hole and set 13-3/8" conductor, drill out to 3800' (+,-) and set 9-5/8" surface casing - cement to surface.  
Drill 8-3/4" hole to 12,500' (+,-), set 7" casing and cement with TOC at approx. 7500'.  
Drill 6-1/4" hole from 12,500' to 15,000' (+,-), run open hole logs & cores, set 5" casing liner from 12,300' to 15,000', cement liner.  
Perforate Mckee Sand, perform proppant fracture treatment job w/ approximately 180,000 gallons water, acid & additives and 170,000 pounds of proppant. Complete and test well.

BOP - 11" Hydraulic Dual Ram (10M), Blind & Pipe

Permit Expires 1 Year From Approval  
Date Unless Drilling Underway

47 I hereby certify that the rules of the Oil Conservation Division have been complied with and that the information given above is true and complete to the best of my knowledge and belief. I further certify that the drill pit will be constructed according NMOCD guideline X, a general permit     , Or an (attached) alternative  
OCD-approved plan     

Printed name: David Plaisance

Title: V.P. Exploration & Production

E-mail Address: dplaisance@paladinenergy.com

Date: 6/15/2005

Phone: 214-654-0132

OIL CONSERVATION DIVISION

Approved by:

Title: PETROLEUM ENGINEER

Approval Date: JUN 17 2005 Expiration Date:

Conditions of Approval:  
Attached ☐

DISTRICT I  
1625 N. FRANCE DR., HOBBES, NM 88240

State of New Mexico  
Energy, Minerals and Natural Resources Department

DISTRICT II  
1301 W. GRAND AVENUE, ARTESIA, NM 88210

OIL CONSERVATION DIVISION  
1220 SOUTH ST. FRANCIS DR.  
Santa Fe, New Mexico 87505

Form C-102  
Revised JUNE 10, 2003  
Submit to Appropriate District Office  
State Lease - 4 Copies  
Fee Lease - 3 Copies

DISTRICT III  
1000 Rio Brazos Rd., Aztec, NM 87410

DISTRICT IV  
1220 S. ST. FRANCIS DR., SANTA FE, NM 87505

WELL LOCATION AND ACREAGE DEDICATION PLAT

☐ AMENDED REPORT

API Number 30-025-37299	Pool Code 97368	Pool Name vacuum McKee South
Property Code 22557	Property Name SOUTH VACUUM 27 Unit	Well Number 5 275
OGRID No. 164070	Operator Name PALADIN ENERGY CORPORATION	Elevation 3887'

Surface Location

UL or lot No.	Section	Township	Range	Lot Idn	Feet from the	North/South line	Feet from the	East/West line	County
H	27	18-S	35-E		1700	NORTH	760	EAST	LEA

Bottom Hole Location If Different From Surface

UL or lot No.	Section	Township	Range	Lot Idn	Feet from the	North/South line	Feet from the	East/West line	County
G	27	18-S	35-E		1400	NORTH	1980	EAST	LEA

Dedicated Acres 320	Joint or Infill	Consolidation Code	Order No.
------------------------	-----------------	--------------------	-----------

NO ALLOWABLE WILL BE ASSIGNED TO THIS COMPLETION UNTIL ALL INTERESTS HAVE BEEN CONSOLIDATED  
OR A NON-STANDARD UNIT HAS BEEN APPROVED BY THE DIVISION

<p>GEODETIC COORDINATES NAD 27 NME BOTTOM HOLE Y=627483.6 N X=773955.1 E</p>	<p>1400'</p> <p>BOTTOM HOLE</p> <p>1980'</p> <p>HD. = 1254'</p> <p>GR. AZ. = 283°34'46"</p> <p>760'</p> <p>SURFACE</p>	<p>GEODETIC COORDINATES NAD 27 NME SURFACE Y=627189.3 N X=775173.9 E</p> <p>LAT. = 32°43'15.77" N LONG. = 103°26'18.97" W</p>	<p>OPERATOR CERTIFICATION</p> <p>I hereby certify the the information contained herein is true and complete to the best of my knowledge and belief.</p> <p><i>Michael Horn</i> Signature MICHAEL HORN Printed Name Op. Manager Title 6-16-05 Date</p> <p>SURVEYOR CERTIFICATION</p> <p>I hereby certify that the well location shown on this plat was plotted from field notes of actual surveys made by me or under my supervision, and that the same is true and correct to the best of my belief.</p> <p>JUNE 2, 2005</p> <p>Date Surveyed DEL</p> <p>Signature and Seal of Professional Surveyor GARY EIDSON 6/9/05 05.11.0852</p> <p>Certificate No. GARY EIDSON 12641</p>
--	--	---	---

Per mH

**SECTION 27, TOWNSHIP 18 SOUTH, RANGE 35 EAST, N.M.P.M.,**  
 LEA COUNTY, NEW MEXICO

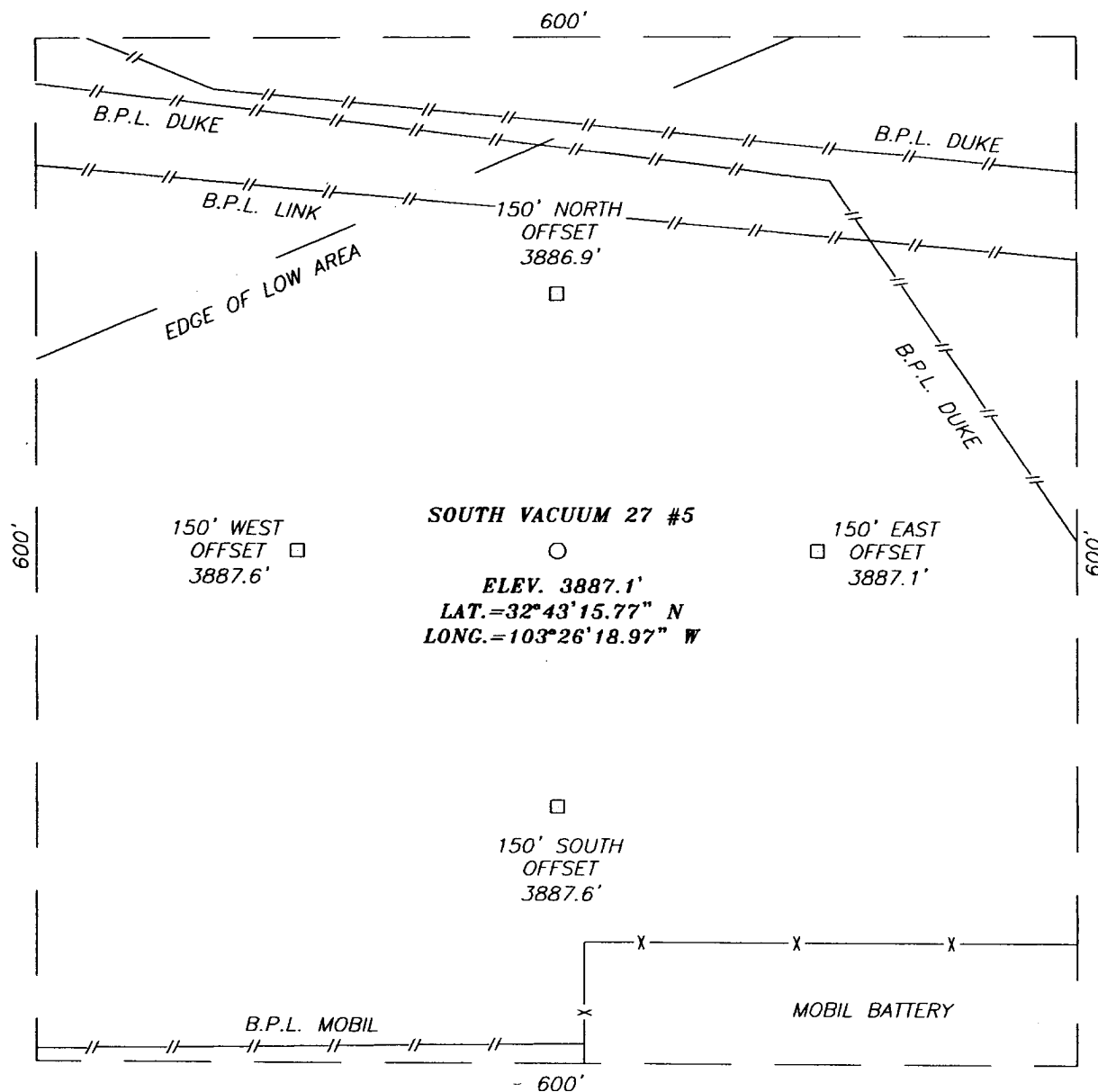

**DIRECTIONS TO LOCATION**

FROM THE INTERSECTION OF HWY #529 AND HWY. #238. GO NW ON HWY. #8 APPROX. 1.1 MILES AND TURN RIGHT (NORTH). GO APPROX. 0.8 MILES AND TURN LEFT (WEST). GO APPROX. 0.2 MILES TO EXISTING MOBIL LOCATION. THIS LOCATION IS APPROX. 360' NW.

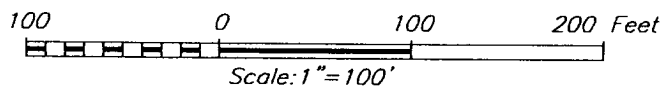

**PALADIN ENERGY CORPORATION**

SOUTH VACUUM 27 #5 WELL  
 LOCATED 1700 FEET FROM THE NORTH LINE  
 AND 760 FEET FROM THE EAST LINE OF SECTION 27,  
 TOWNSHIP 18 SOUTH, RANGE 35 EAST, N.M.P.M.,  
 LEA COUNTY, NEW MEXICO.

Survey Date: 06/02/05	Sheet 1 of 1 Sheets
W.O. Number: 05.11.0852	Dr By: DEL
Date: 06/08/05	Disk: CD#4
05110852	Scale: 1"=100'

PROVIDING SURVEYING SERVICES  
 SINCE 1946  
**JOHN WEST SURVEYING COMPANY**  
 412 N. DAL PASO  
 HOBBS, N.M. 88240  
 (505) 383-3117

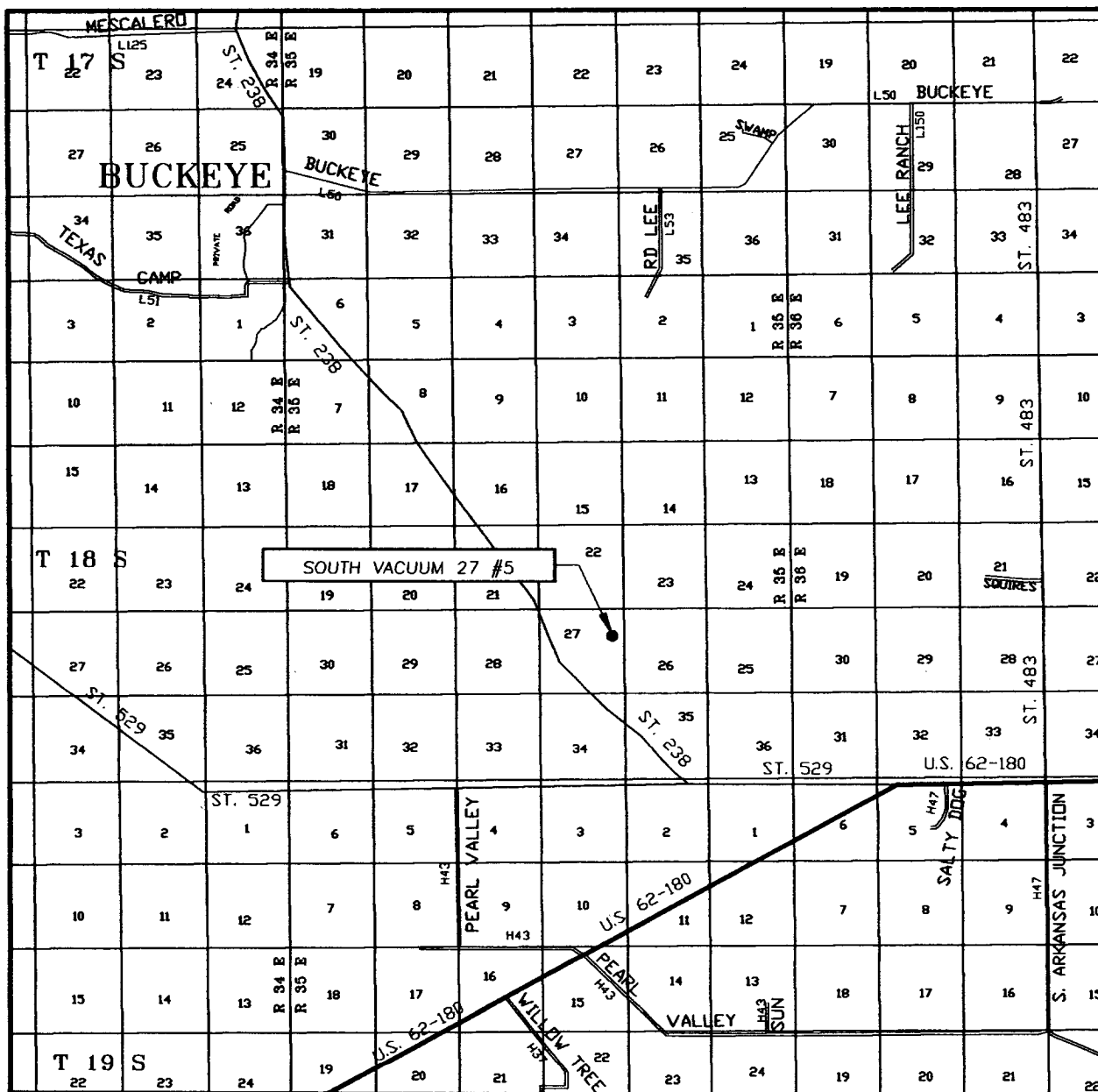

SEC. 27 TWP. 18-S RGE. 35-E  
SURVEY N.M.P.M.  
COUNTY LEA  
DESCRIPTION 1700' FNL & 760' FEL  
ELEVATION 3887'  
PALADIN  
OPERATOR ENERGY CORPORATION  
LEASE SOUTH VACUUM 27

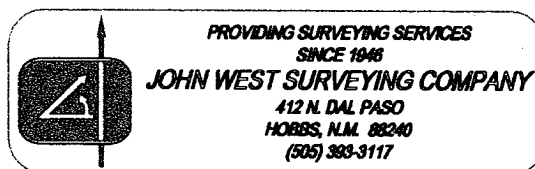

REGION



CONTOUR INTERVAL:  
IRONHOUSE DRAW, N.M. - 10'  
SUPPLEMENTAL - 5'

U.S.G.S. TOPOGRAPHIC MAP  
IRONHOUSE DRAW, N.M.

