

Submit 3 Copies To Appropriate District  
Office  
District I  
1625 N. French Dr., Hobbs, NM 88240  
District II  
1301 W. Grand Ave., Artesia, NM 88210  
District III  
1000 Rio Brazos Rd., Aztec, NM 87410  
District IV  
1220 S. St. Francis Dr., Santa Fe, NM  
87505

State of New Mexico  
Energy, Minerals and Natural Resources

Form C-103  
March 4, 2004

OIL CONSERVATION DIVISION  
1220 South St. Francis Dr.  
Santa Fe, NM 87505

WELL API NO. 30-025-36795	
5. Indicate Type of Lease STATE <input checked="" type="checkbox"/> FEE <input type="checkbox"/>	
6. State Oil & Gas Lease No.	
7. Lease Name or Unit Agreement Name HESTER 12	
8. Well Number 6	
9. OGRID Number 873	
10. Pool name or Wildcat	

SUNDRY NOTICES AND REPORTS ON WELLS (DO NOT USE THIS FORM FOR PROPOSALS TO DRILL OR TO DEEPEN OR PLUG BACK TO A DIFFERENT RESERVOIR. USE "APPLICATION FOR PERMIT" (FORM C-101) FOR SUCH PROPOSALS.)	
1. Type of Well: Oil Well <input checked="" type="checkbox"/> Gas Well <input type="checkbox"/> Other	
2. Name of Operator APACHE CORPORATION	
3. Address of Operator 6120 S. YALE, STE. 1500	
4. Well Location Unit Letter <u>N</u> : <u>467</u> feet from the <u>S</u> line and <u>1650</u> feet from the <u>W</u> line Section <u>12</u> Township <u>20S</u> Range <u>38E</u> NMPM County <u>LEA</u>	
11. Elevation (Show whether DR, RKB, RT, GR, etc.) 3556	

**Pit or Below-grade Tank Application (For pit or below-grade tank closures, a form C-144 must be attached)**

Pit Location: UL      Sect      Twp      Rng      Pit type      Depth to Groundwater      Distance from nearest fresh water well       
Distance from nearest surface water      Below-grade Tank Location UL      Sect      Twp      Rng      ;  
feet from the      line and      feet from the      line

12. Check Appropriate Box to Indicate Nature of Notice, Report or Other Data

NOTICE OF INTENTION TO:		SUBSEQUENT REPORT OF:	
PERFORM REMEDIAL WORK <input type="checkbox"/>	PLUG AND ABANDON <input type="checkbox"/>	REMEDIAL WORK <input type="checkbox"/>	ALTERING CASING <input type="checkbox"/>
TEMPORARILY ABANDON <input type="checkbox"/>	CHANGE PLANS <input checked="" type="checkbox"/>	COMMENCE DRILLING OPNS. <input type="checkbox"/>	PLUG AND ABANDONMENT <input type="checkbox"/>
PULL OR ALTER CASING <input type="checkbox"/>	MULTIPLE COMPLETION <input type="checkbox"/>	CASING TEST AND CEMENT JOB <input type="checkbox"/>	
OTHER: <input type="checkbox"/>		OTHER: <input type="checkbox"/>	

13. Describe proposed or completed operations. (Clearly state all pertinent details, and give pertinent dates, including estimated date of starting any proposed work). SEE RULE 1103. For Multiple Completions: Attach wellbore diagram of proposed completion or recompletion.

CHANGE IN LOCATION

THE CORRECT LOCATION IS 467 FSL & 1650 FWL

THE INCORRECT LOCATION IS 330 FSL & 1650 FWL



I hereby certify that the information above is true and complete to the best of my knowledge and belief. I further certify that any pit or below-grade tank has been/will be constructed or closed according to NMOCD guidelines ☐, a general permit ☐ or an (attached) alternative OCD-approved plan ☐.

SIGNATURE Lana Williams TITLE DRILLING CLERK II DATE 6/9/05

Type or print name LANA WILLIAMS

E-mail address: lana.williams@apachecorp.com

Telephone No. 918-491-4980

(This space for State use)

APPROVED BY [Signature] TITLE PETROLEUM ENGINEER DATE JUN 22 2005  
Conditions of approval, if any:

# State of New Mexico

Energy, Minerals and Natural Resources Department

## DISTRICT I

1626 N. FRENCH DR., HOBBES, NM 88240

## DISTRICT II

1301 W. GRAND AVENUE, ARTESIA, NM 88210

## DISTRICT III

1000 Rio Brazos Rd., Aztec, NM 87410

## DISTRICT IV

1220 S. ST. FRANCIS DR., SANTA FE, NM 87505

## OIL CONSERVATION DIVISION

1220 SOUTH ST. FRANCIS DR.  
Santa Fe, New Mexico 87505

Form C-102

Revised JUNE 10, 2003

Submit to Appropriate District Office

State Lease - 4 Copies

Fee Lease - 3 Copies

## WELL LOCATION AND ACREAGE DEDICATION PLAT

☐ AMENDED REPORT

API Number <b>30-025-36795</b>		Pool Code	Pool Name
Property Code <b>34153</b>	Property Name <b>HESTER 12</b>		Well Number <b>6</b>
OGRID No. <b>873</b>	Operator Name <b>APACHE CORPORATION</b>		Elevation <b>3558'</b>

### Surface Location

UL or lot No.	Section	Township	Range	Lot Idn	Feet from the	North/South line	Feet from the	East/West line	County
N	12	20-S	38-E		467	SOUTH	1650	WEST	LEA

### Bottom Hole Location If Different From Surface

UL or lot No.	Section	Township	Range	Lot Idn	Feet from the	North/South line	Feet from the	East/West line	County
Dedicated Acres <b>40</b>	Joint or Infill	Consolidation Code	Order No.						

NO ALLOWABLE WILL BE ASSIGNED TO THIS COMPLETION UNTIL ALL INTERESTS HAVE BEEN CONSOLIDATED  
OR A NON-STANDARD UNIT HAS BEEN APPROVED BY THE DIVISION

	<b>OPERATOR CERTIFICATION</b>  I hereby certify the the information contained herein is true and complete to the best of my knowledge and belief.  <i>Lana Williams</i> Signature Lana Williams Printed Name Drilling Clerk II Title 6/9/05 Date
	<b>SURVEYOR CERTIFICATION</b>  I hereby certify that the well location shown on this plat was plotted from field notes of actual surveys made by me or under my supervision, and that the same is true and correct to the best of my belief.  JULY 31, 2004 Date Surveyed REV:05/23/05 JR <i>Gary A. Eidsen</i> Signature & Seal of Professional Surveyor GARY A. EIDSEN 16841 08035 Certificate No. GARY EIDSEN 12641

# VICINITY MAP

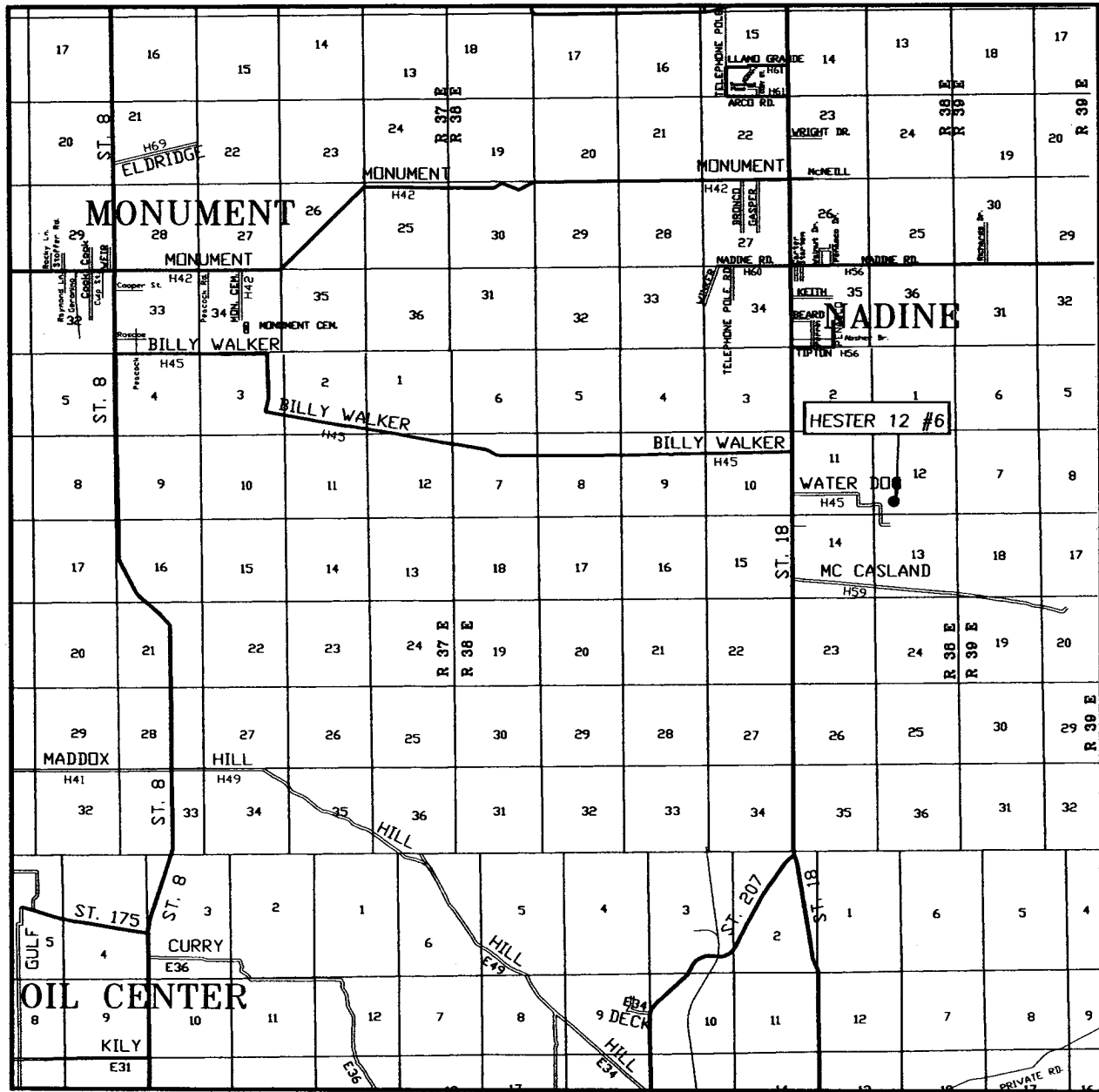

SCALE: 1" = 2 MILES

SEC. 12 TWP. 20-S RGE. 38-E

SURVEY N.M.P.M.

COUNTY LEA

DESCRIPTION 467' FSL & 1650' FWL

ELEVATION 3558'

OPERATOR APACHE CORPORATION

LEASE HESTER 12

PROVIDING SURVEYING SERVICES  
SINCE 1946  
**JOHN WEST SURVEYING COMPANY**  
412 N. DAL PASO  
HOBBS, N.M. 88240  
(505) 393-3117

This topographic map depicts the Hester 12 #6 well area, characterized by dense contour lines indicating elevation. Key features include:

- Starlight Rd.:** A horizontal road crossing the upper portion of the map.
- Monument:** A shaded rectangular area in the upper left corner.
- Gravel Pits:** Several locations marked with 'x' symbols and labeled 'Gravel Pit'.
- Oil Wells:** Multiple locations marked with circles and labeled 'Oil Wells'.
- Section Numbers:** The map is divided into sections numbered 1, 2, 6, 7, 11, 12, 13, 14, and 18.
- Contour Lines:** Labeled with elevations such as 3550, 3559, 3560, 3562, 3563, 3564, 3569, 3571, 3575, 3576, 3577, 3578, and 3592.
- HESTER 12 #6:** A specific well location is highlighted with a black dot and a label box.
- Other Labels:** 'Gravel Pit' and 'Oil Wells' are repeated in different areas, and a '+' symbol is visible in the lower right.

CONTOUR INTERVAL:  
HOBBS SE, N.M. - 5'

U.S.G.S. TOPOGRAPHIC MAP  
HOBBS SE N.M.

