

District I
1625 N. French Dr., Hobbs, NM 88240
District II
1301 W. Grand Avenue, Artesia, NM 88210
District III
1000 Rio Brazos Road, Aztec, NM 87410
District IV
1220 S. St. Francis Dr., Santa Fe, NM 87505

State of New Mexico
Energy Minerals and Natural
Resources
Oil Conservation Division
1220 South St. Francis Dr.
Santa Fe, NM 87505

Form C-144
June 1, 2004

For drilling and production facilities, submit
to appropriate NMOCD District Office.
For downstream facilities, submit to Santa Fe
office

Pit or Below-Grade Tank Registration or Closure

Is pit or below-grade tank covered by a "general plan"? Yes ☒ No ☐

Type of action: Registration of a pit or below-grade tank ☐ Closure of a pit or below-grade tank ☒

Operator: Yates Petroleum Corporation Telephone: 505-748-4500 e-mail address: mikes@ypc.com
Address: 105 South 4th Street, Artesia, N.M. 88210
Facility or well name: Sweeney Federal 1 API #: 30-025-00871 U/L or Qtr/Qtr C Sec 25 T 18S R 32E
County: Lea Latitude 32.72388 Longitude 103.72145 NAD: 1927 ☐ 1983 ☒
Surface Owner: Federal ☒ State ☐ Private ☐ Indian ☐

Pit Type: Drilling <input type="checkbox"/> Production <input type="checkbox"/> Disposal <input type="checkbox"/> Work over <input checked="" type="checkbox"/> Emergency <input type="checkbox"/> Lined <input type="checkbox"/> Unlined <input checked="" type="checkbox"/> Liner type: Synthetic <input type="checkbox"/> Thickness <input type="checkbox"/> mil Clay <input type="checkbox"/> Pit Volume <input type="checkbox"/> bbl	Below-grade tank Volume: <input type="checkbox"/> bbl Type of fluid: <input type="checkbox"/> Construction material: <input type="checkbox"/> Double-walled, with leak detection? Yes <input type="checkbox"/> If not, explain why not. <input type="checkbox"/>
Depth to ground water (vertical distance from bottom of pit to seasonal high water elevation of ground water.)	Less than 50 feet (20 points) 50 feet or more, but less than 100 feet (10 points) 100 feet or more (0 points) XXXX
Wellhead protection area: (Less than 200 feet from a private domestic water source, or less than 1000 feet from all other water sources.)	Yes (20 points) No (0 points) XXXX
Distance to surface water: (horizontal distance to all wetlands, playas, irrigation canals, ditches, and perennial and ephemeral watercourses.)	Less than 200 feet (20 points) 200 feet or more, but less than 1000 feet (10 points) 1000 feet or more (0 points) XXXX
Ranking Score (Total Points) 0 Points	

If this is a pit closure: (1) Attach a diagram of the facility showing the pit's relationship to other equipment and tanks. (2) Indicate disposal location: (check the onsite box if you are burying in place) on-site ☒ off-site ☐ If off-site, name of facility: ☐ (3) Attach a general description of remedial action taken including remediation start date and end date. (4) Groundwater encountered: No ☐ Yes ☐ If yes, show depth below ground surface ☐ ft. and attach sample results. (5) Attach soil sample results and a diagram of sample locations and excavations.

Additional Comments: Work plan for the Closure of Workover Pit. A 20 mil synthetic liner will be placed 3' below grade with a min. 3' over lap of the underlying pit. The workover pit will be backfilled to grade using a minimum of 3' of clean soil or like material capable of supporting native plant growth. This area will be seeded with proper seed mixture appropriate to area.

Note: This is a Plug and Abandon location

I hereby certify that the information above is true and complete to the best of my knowledge and belief. I further certify that the above-described pit or below-grade tank has been/will be constructed or closed according to NMOCD guidelines ☐, a general permit ☒, or an (attached) alternative OGD-approved plan ☐.

Date: 07/07/05

Printed Name/Title Dan Dolan / Regulatory Agent

Signature 

Your certification and NMOCD approval of this application/closure does not relieve the operator of liability should the contents of the pit or tank contaminate ground water or otherwise endanger public health or the environment. Nor does it relieve the operator of its responsibility for compliance with any other federal, state, or local laws and/or regulations.

Approval:

Printed Name/Title GARY W. WINK / STAFF MGR.

Signature 

Date: 7/11/05

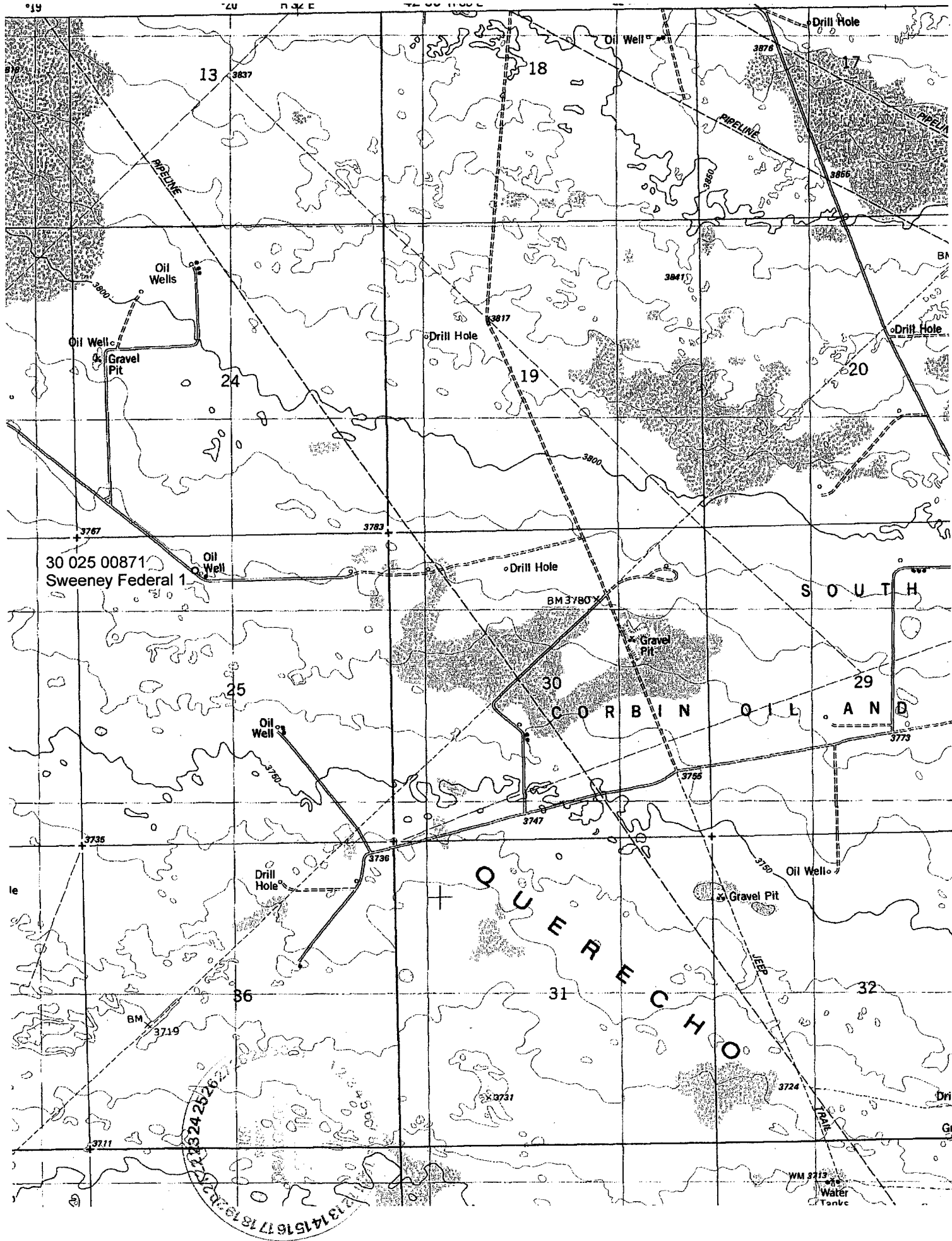

USGS SEO TWN 16S-18S CHAVES LEA GW

Sweeney Federal 1

	F	G	H	I	J	K	L
3	COUNTY	SOURCE	USGS SITE NUM.	QTY	SITE LOCATION	DATE	LEVEL
3430	LEA	SEO		1	18S.32E.22.32322	1986-03-25	429.49
3431	LEA	SEO		1	18S.32E.34.22200	1981-03-12	117.28

