

1625 N. French Dr., Hobbs, NM 88240

State of New Mexico
Energy, Minerals and Natural Resources Department

Form C-101

Revised March 17, 1999

Instructions on back

Submit to appropriate District Office

State Lease - 6 Copies

Fee Lease - 5 Copies

DISTRICT II

811 South First, Artesia, NM 88210

DISTRICT III

1000 Rio Brazos Rd., Aztec, NM 87410

DISTRICT IV

2040 South Pacheco, Santa Re, NM 8750:

OIL CONSERVATION DIVISION

PO BOX 2088

Santa Fe, NM 87504-2088

☐ AMENDED REPORT

APPLICATION FOR PERMIT TO DRILL, RE-ENTER, DEEPEN, PLUGBACK, OR ADD A ZONE

¹ Operator Name and Address Yates Petroleum Corporation 105 South Fourth Street Artesia, New Mexico 88210		² OGRID Number 025575
		³ API Number 30- 025-29457
⁴ Property Code 28042	⁵ Property Name Adobe Scott "AYE"	⁶ Well No. 1

⁷ Surface Location

UL or lot no. J	Section 11	Township 15S	Range 34E	Lot Idn	Feet from the 1980	North/South Line South	Feet from the 1730	East/West Line East	County Lea
--------------------	---------------	-----------------	--------------	---------	-----------------------	---------------------------	-----------------------	------------------------	---------------

⁸ Proposed Bottom Hole Location If Different From Surface

UL or lot no.	Section	Township	Range	Lot Idn	Feet from the	North/South Line	Feet from the	East/West Line	County
⁹ Proposed Pool 1 Wildcat Mississippian						¹⁰ Proposed Pool 2			

¹¹ Work Type Code E	¹² Well Type Code G	¹³ Cable/Rotary R	¹⁴ Lease Type Code P	¹⁵ Ground Level Elevation 4071'
¹⁶ Multiple No	¹⁷ Proposed Depth 13510'	¹⁸ Formation Mississippian	¹⁹ Contractor Not Determined	²⁰ Spud Date ASAP

²¹ **Proposed Casing and Cement Program**

Hole Size	Casing Size	Casing weight/feet	Setting Depth	Sacks of Cement	Estimated TOC
17 1/2"	13 3/8	54.5#	372'-in place	400 sx	Circulate
12 1/4"	9 5/8"	47# & 53.5#	4520'-in place	1800 sx	Circulate
7 7/8"	5 1/2"	17# & 20#	0-13,510'	1250 sx	TOC-4000'

22 Describe the proposed program. If this application is to DEEPEN or PLUG BACK give the data on the present productive zone and proposed new productive zone. Describe the blowout prevention program, if any. Use additional sheets if necessary.

See Attached Sheet

Permit Expires 1 Year From Approval
Date Unless ~~Drilling~~ Underway
Re-Entry

23 I hereby certify that the information given above is true and complete to the best of my knowledge and belief. Signature: <u>Clifton R. May</u>		OIL CONSERVATION DIVISION Approved by: <u>[Signature]</u>	
Printed name: <u>Clifton R. May</u>		Title: <u>APR 07 2003</u> <u>PETROLEUM ENGINEER</u>	
Title: <u>Regulatory Agent</u>		Approval Date: _____ Expiration Date: _____	
Date: <u>04/01/03</u>	Phone: <u>(505) 748-1471</u>	Conditions of Approval Attached <input type="checkbox"/>	

District II
811 South First, Artesia, NM 88210

OIL CONSERVATION DIVISION
1220 South St. Francis Dr.
Santa Fe, NM 87505

Submit to Appropriate District Office
State Lease - 4 Copies
Fee Lease - 3 Copies

District III
1000 Rio Brazos Rd., Aztec, NM 87410

District IV
1220 S. St. Francis Dr., Santa Fe, NM 87505

☐ AMENDED REPORT

WELL LOCATION AND ACREAGE DEDICATION PLAT

¹ API Number 30-025-29457		² Pool Code ✓	³ Pool Name Wildcat Mississippian
⁴ Property Code 28042	⁵ Property Name ADOBE SCOTT AYE		⁶ Well Number 1
⁷ OGRID No. 025575	⁸ Operator Name Yates Petroleum Corporation		⁹ Elevation 4071'

¹⁰ Surface Location

UL or lot no.	Section	Township	Range	Lot Idn	Feet from the	North/South line	Feet from the	East/West line	County
J	11	15S	34E		1980	South	1730	East	Lea

¹¹ Bottom Hole Location If Different From Surface

UL or lot no.	Section	Township	Range	Lot Idn	Feet from the	North/South line	Feet from the	East/West line	County
¹² Dedicated Acres 320	¹³ Joint or Infill	¹⁴ Consolidation Code			¹⁵ Order No.				

NO ALLOWABLE WILL BE ASSIGNED TO THIS COMPLETION UNTIL ALL INTERESTS HAVE BEEN CONSOLIDATED OR A NON-STANDARD UNIT HAS BEEN APPROVED BY THE DIVISION

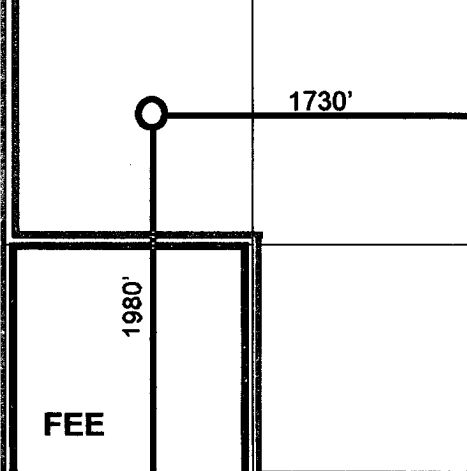
16			<div data-bbox="1105 951 1515 1144"><p>17</p><p>OPERATOR CERTIFICATION</p><p><i>I hereby certify that the information contained herein is true and complete to the best of my knowledge and belief.</i></p><p>Signature</p><p>Clifton R. May</p><p>Printed Name</p><p>Regulatory Agent</p><p>Title</p><p>4/1/2003</p><p>Date</p></div>
		<p>FEE</p>	<div data-bbox="1105 1205 1515 1451"><p>27282930</p><p>18</p><p>SURVEYOR CERTIFICATION</p><p><i>I hereby certify that the well location shown on this plat was plotted from field notes of actual surveys made by me or under my supervision, and that the same is true and correct to the best of my belief.</i></p><p>REFER TO ORIGINAL PLAT</p><p>Date of Survey</p><p>Signature and Seal of Professional Surveyor</p></div>
		 <p>1730'</p> <p>1980'</p> <p>FEE</p>	<div data-bbox="1105 1461 1515 1942"><p>Certificate Number</p></div>

YATES PETROLEUM CORPORATION

Adobe Scott "AYE" #1 Re-entry

1980' FSL and 1730' FEL

Section 11-T15S-R34E

Lea County, New Mexico

Drilling Information: Yates Petroleum Corporation plans to re-enter this well that was originally drilled as the Adobe Oil & Gas Corporation's Scott 1-Y well and plugged December 1985. Yates plans to re-enter using a drilling rig. A 5000# BOP system will be installed on the 9 5/8" casing. Plugs will be drilled out of the 9 5/8" casing which is set at 4520' and cemented to surface with 1800 sacks of cement. Casing shoe will be tested and open hole plugs will be drilled out to the original TD of 13510' using a 7 7/8" bit. No open hole logs will be ran. Production string of 5 1/2" casing will be ran to TD and cemented with 1250 sacks cement which should be sufficient to bring the cement top up into the 9 5/8" casing with TOC being approximately 4000'. The Mississippian and Morrow will be the main completion targets. Mud system will be 9.4-10.2 ppg salt gel system with 34-40 vis and approximately 12 water loss.



DISTRICT IV
2040 South Pacheco, Santa Fe, NM 87505

Form C-102
Revised March 17, 1999
Instruction on back
Submit to Appropriate District Office
State Lease - 4 Copies
Fee Lease - 3 Copies

P.O. Box 2088
Santa Fe, New Mexico 87504-2088

☐ **AMENDED REPORT**

API Number	Pool Code	Pool Name
30-025-29457		Wildcat Mississippian
Property Code	Property Name	Well Number
28D42	Adobe Scott "AYE"	#1
OGHD No.	Operator Name	Elevation
025575	Yates Petroleum Corporation	4071' GR

UL or lot No.	Section	Township	Range	Lot Idn	Feet from the	North/South line	Feet from the	East/West line	County
J	11	15S	34E		1980'	South	1730'	East	Lea

UL or lot No.	Section	Township	Range	Lot Idn	Feet from the	North/South line	Feet from the	East/West line	County
Dedicated Acres 320.00	Joint or Infill	Consolidation Code			Order No.				

		Fee	
		1730'	
		1980' Fee	

OPERATOR CERTIFICATION	
I hereby certify the information contained herein is true and complete to the best of my knowledge and belief.	
	<u> </u> Signature
<u>Clifton R. May</u> Printed Name	
<u>Regulatory Agent</u> Title	
<u>5-8-01</u> Date	
SURVEYOR CERTIFICATION <small>EX-100</small>	
I hereby certify that the well location shown on this plat was plotted from field notes of actual surveys made by me or under my supervision, and that the same is true and correct to the best of my belief.	
Refer to Original Plat	
<u> </u> Date Surveyed	
<u> </u> Signature & Seal of Professional Surveyor	
Certificate No. Herschel L. Jones RLS 3640	
GENERAL SURVEYING COMPANY	

NEW MEXICO OIL CONSERVATION COMMISSION
WE. LOCATION AND ACREAGE DEDICATION LAT

Form C-102
 Supersedes C-12
 Effective 1-1-85

All distances must be from the outer boundaries of the Section.

Operator ADOBE OIL & GAS CORPORATION			Lease SCOTT		Well No. 1-Y
Unit Letter "J"	Section 11	Township 15-S	Range 34-E	County LEA	
Actual Footage Location of Well:					
1980		feet from the SOUTH	line and 1730	feet from the EAST	line
Ground Level Elev. 4071	Producing Formation DEVONIAN		Pool WILDCAT		Dedicated Acreage: 40 Acres

1. Outline the acreage dedicated to the subject well by colored pencil or hachure marks on the plat below.
2. If more than one lease is dedicated to the well, outline each and identify the ownership thereof (both as to working interest and royalty).
3. If more than one lease of different ownership is dedicated to the well, have the interests of all owners been consolidated by communitization, unitization, force-pooling, etc?
☐ Yes ☐ No If answer is "yes," type of consolidation _____

If answer is "no," list the owners and tract descriptions which have actually been consolidated. (Use reverse side of this form if necessary.) _____

No allowable will be assigned to the well until all interests have been consolidated (by communitization, unitization, forced-pooling, or otherwise) or until a non-standard unit, eliminating such interests, has been approved by the Commission.

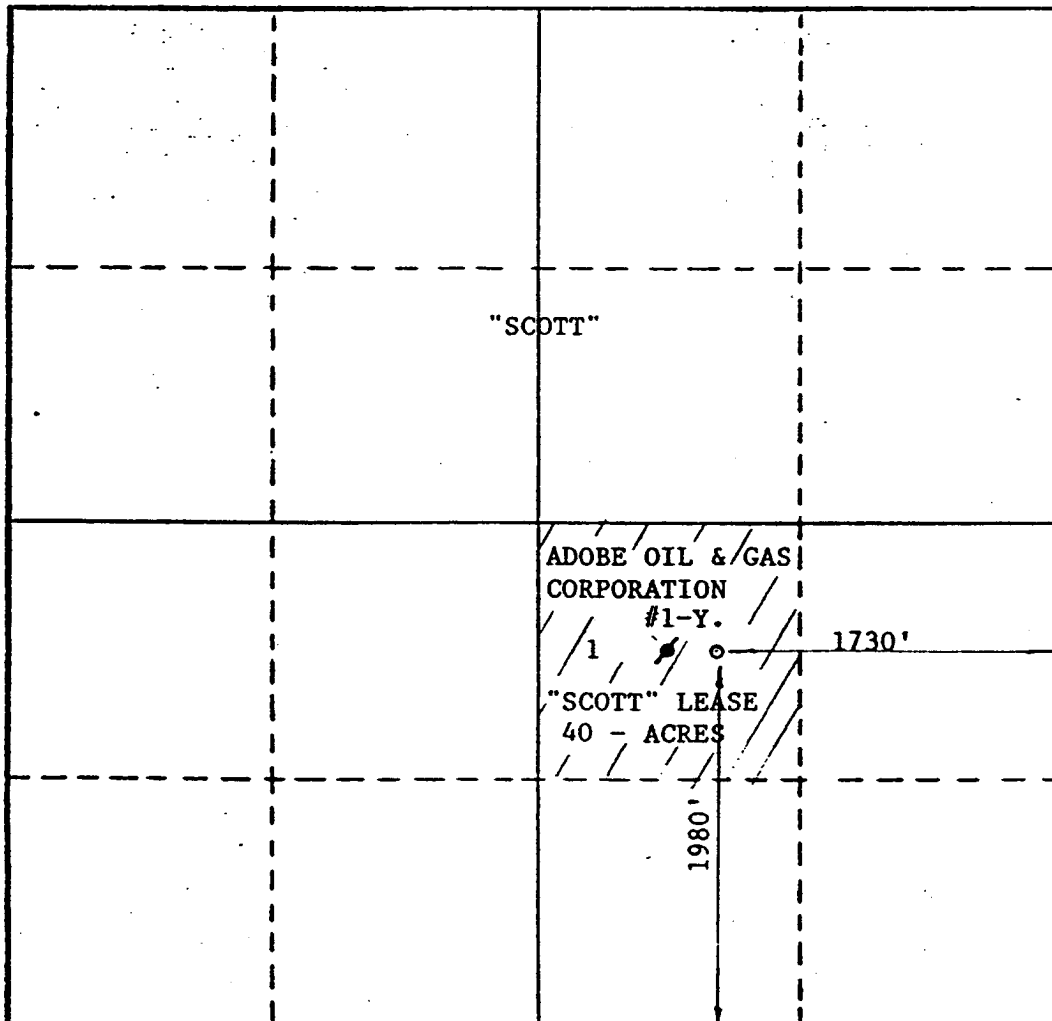

CERTIFICATION

I hereby certify that the information contained herein is true and complete to the best of my knowledge and belief.

Bill Owens

Name
bill Owens

Position
Vice President

Company
Adobe Oil & Gas Corp.

Date
October 14, 1985

I hereby certify that the well location shown on this plat was plotted from field notes of actual surveys made by me or under my supervision, and that the same is true and correct to the best of my knowledge and belief.

Date Surveyed
OCTOBER 14, 1985

Registered Professional Engineer and/or Land Surveyor

Max A Schumann Jr
MAX A SCHUMANN JR

Certificate No.:

1510

