

District I
1625 N. French Dr., Hobbs, NM 88240
District II
1301 W. Grand Avenue, Artesia, NM 88210
District III
1000 Rio Brazos Road, Aztec, NM 87410
District IV
1220 S. St. Francis Dr., Santa Fe, NM 87505

State of New Mexico
Energy Minerals and Natural Resources

C-103
Form E-101
May 27, 2004

Oil Conservation Division
1220 South St. Francis Dr.
Santa Fe, NM 87505

Submit to appropriate District Office

☐ AMENDED REPORT

APPLICATION FOR PERMIT TO DRILL, RE-ENTER, DEEPEN, PLUGBACK, OR ADD A ZONE

¹ Operator Name and Address Devon Louisiana Corporation 20 North Broadway Oklahoma city, OK 73102-8620		² OGRID Number 169355
³ Property Code 27844		⁴ API Number 30 - 025-35497
⁵ Property Name Texaco State 5		⁶ Well No. 1
⁹ Proposed Pool 1 Vacuum; Atoka-Morrow, N.		¹⁰ Proposed Pool 2

7 Surface Location

UL or lot no. P	Section 5	Township 17S	Range 35E	Lot Idn	Feet from the 660	North/South line S	Feet from the 660	East/West line E	County Lea
--------------------	--------------	-----------------	--------------	---------	----------------------	-----------------------	----------------------	---------------------	---------------

8 Proposed Bottom Hole Location If Different From Surface

UL or lot no.	Section	Township	Range	Lot Idn	Feet from the	North/South line	Feet from the	East/West line	County
---------------	---------	----------	-------	---------	---------------	------------------	---------------	----------------	--------

Additional Well Information

¹¹ Work Type Code P	¹² Well Type Code G	¹³ Cable/Rotary	¹⁴ Lease Type Code S	¹⁵ Ground Level Elevation 3992'
¹⁶ Multiple No	¹⁷ Proposed Depth 12,807'	¹⁸ Formation Atoka	¹⁹ Contractor	²⁰ Spud Date 05/18/01
Depth to Groundwater		Distance from nearest fresh water well		Distance from nearest surface water
Pit: Liner: Synthetic <input type="checkbox"/> _____mils thick Clay <input type="checkbox"/> Pit Volume: _____bbls Drilling Method: _____ Closed-Loop System <input type="checkbox"/> Fresh Water <input type="checkbox"/> Brine <input type="checkbox"/> Diesel/Oil-based <input type="checkbox"/> Gas/Air <input type="checkbox"/>				

21 Proposed Casing and Cement Program

Hole Size	Casing Size	Casing weight/foot	Setting Depth	Sacks of Cement	Estimated TOC
17-1/2"	13-3/8"	48#	490'	543 sx	Surf
11"	8-5/8"	32#	4714'	1800 sx	Surf
7-7/8"	5-1/2"	17#	12,807'	850 sx	7000' (CRL)

²² Describe the proposed program. If this application is to DEEPEN or PLUG BACK, give the data on the present productive zone and proposed new productive zone. Describe the blowout prevention program, if any. Use additional sheets if necessary.

Devon Energy Production Company, LP respectfully requests approval to recomplete in the Atoka as Outlined in the attached procedure:

Please see attached.

Adding perfs

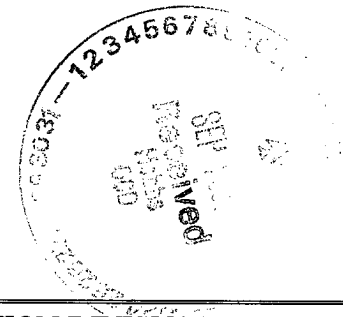

²³ I hereby certify that the information given above is true and complete to the best of my knowledge and belief. I further certify that the drilling pit will be constructed according to NMOCD guidelines <input type="checkbox"/> , a general permit <input type="checkbox"/> , or an (attached) alternative OCD-approved plan <input type="checkbox"/> .		OIL CONSERVATION DIVISION	
Printed name: Seyi Harris		Approved by:	
Title: Engineer		Title: PETROLEUM ENGINEER	
E-mail Address: seyi.harris@dvnm.com		Approval Date: SEP 20 2005	
Date: 09/12/05		Expiration Date:	
Phone: (505)748-7180		Conditions of Approval Attached <input type="checkbox"/>	



Texaco State 5 #1

T17S, R35E, Sec. 5

660' FSL, 660' FEL

Lea County, NM

Elevation- 3987' GL, 4003' KB

Casing- 13-3/8" 48# H-40 STC @ 490', circ

8-5/8" 32# K-55 LTC @ 4714', circ

5-1/2" 17# L80 & P110/S95 LTC @ 12,807', TOC @ 7000' (CBL)

Existing Morrow Perfs- 12,662' – 76' (6 spf)

Existing Atoka perfs- 12,295' – 302' (6 spf)

Proposed Atoka perfs- 12,168' – 12,178' (6 spf, 60° phasing)

Procedure to Open Atoka

1. MIRUPU. ND WH. NU BOP. Load tubing with 2% KCL water. Unset Arrowset IX packer @ 12,130'. POOH with tubing and packer.
2. RIH with CIBP on wireline and set @ 12,265'. Blow down casing to test plug integrity. Dump bail 35' of cement on top of CIBP.
3. RIH with 3-3/8" casing gun loaded 6 spf, 60° phasing and perforate Atoka @ 12,168' – 12,178'. POOH with gun and monitor surface pressure response.
4. PU Arrowset packer and RIH on 2-3/8" tubing. Set packer at +/-12,100' and swab down tubing.
5. MIRU BJ services and acidize Atoka according to BJ recommendations dated 08/18/05. Swab back acid load.
6. Kill well with 2% KCl water. Unset packer and POOH with tubing and packer.
7. Frac Atoka down casing according to BJ recommendations. Swab back frac load.
8. RDMO BJ services. Continue swabbing back frac load.
9. RIH with 2-3/8" tubing. ND BOP. NU WH. Put well on line.

DISTRICT I
1625 N. French Dr., Hobbs, NM 88240
DISTRICT II
611 South First, Artesia, NM 88210

DISTRICT III
1000 Rio Brazos Rd., Artesia, NM 87410

DISTRICT IV
2040 South Pacheco, Santa Fe, NM 87505

State of New Mexico
Energy, Minerals and Natural Resources Department

Form C-102
Revised March 17, 1999

Submit to Appropriate District Office
State Lease - 4 Copies
Fee Lease - 3 Copies

OIL CONSERVATION DIVISION

2040 South Pacheco
Santa Fe, New Mexico 87504-2088

☐ AMENDED REPORT

WELL LOCATION AND ACREAGE DEDICATION PLAT

API Number 30-025-35497		Pool Code 86800 VACUUM 85212	Pool Name MORROW, N. SHOE BAR; ATOKA, SOUTH
Property Code 27844	Property Name TEXACO 'S' STATE		Well Number 1
OGRID No. 169355	Operator Name Devon Louisiana Corporation		Elevation 3992'

Surface Location

UL or lot No.	Section	Township	Range	Lot Idn	Feet from the	North/South line	Feet from the	East/West line	County
P	5	17 S	35 E		660	SOUTH	660	EAST	LEA

Bottom Hole Location If Different From Surface

UL or lot No.	Section	Township	Range	Lot Idn	Feet from the	North/South line	Feet from the	East/West line	County
Dedicated Acres 80 320		Joint or Infill	Consolidation Code	Order No.					

NO ALLOWABLE WILL BE ASSIGNED TO THIS COMPLETION UNTIL ALL INTERESTS HAVE BEEN CONSOLIDATED
OR A NON-STANDARD UNIT HAS BEEN APPROVED BY THE DIVISION

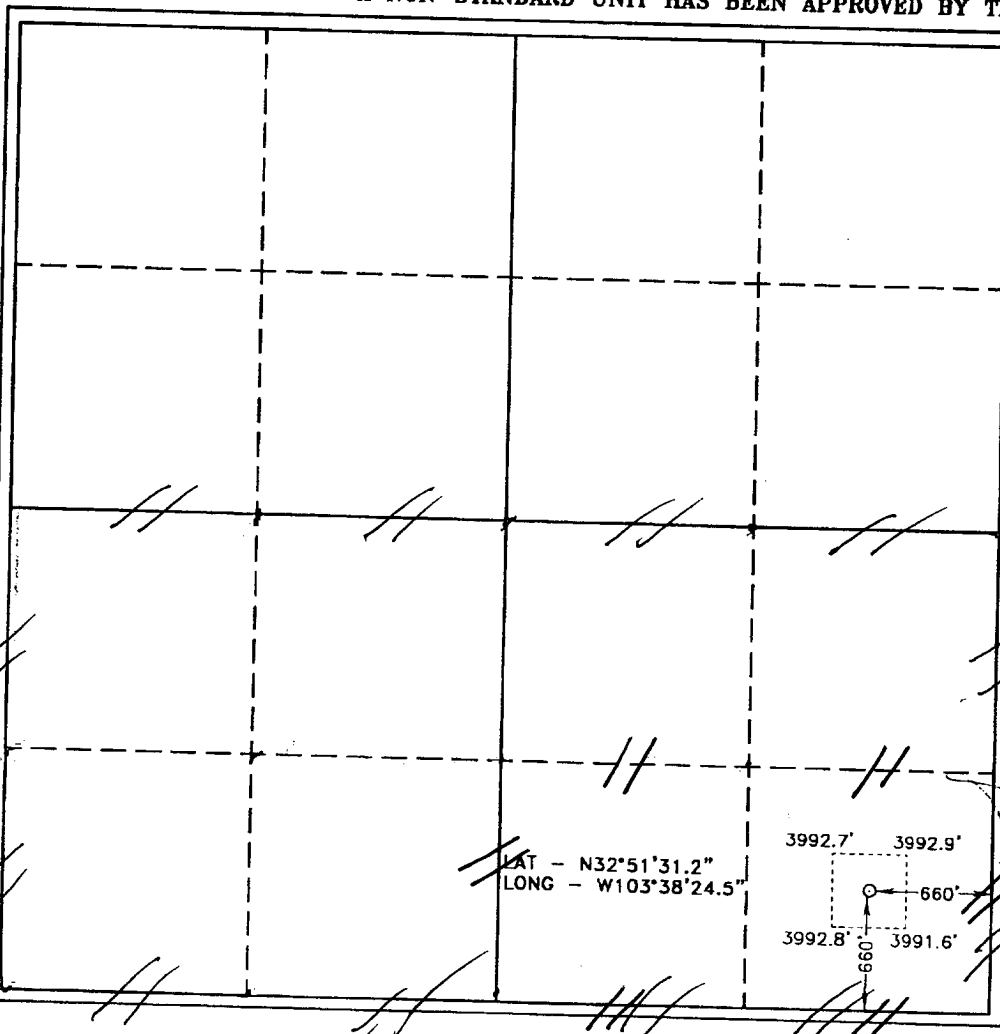

OPERATOR CERTIFICATION

I hereby certify the the information
contained herein is true and complete to the
best of my knowledge and belief.

Signature
Seyi Harris

Printed Name
Engineer

Title
09/12/05

Date

SURVEYOR CERTIFICATION

I hereby certify that the well location shown
on this plat was plotted from field notes of
actual surveys made by me or under my
supervision and that the same is true and
correct to the best of my belief.

March 8, 2001

Date Surveyed
Signature & Seal of
Professional Surveyor

W.O. No. 1225A
Certificate No. Gary L. Jones 7977
BASIN SURVEYS