

Submit 1 Copy To Appropriate District
Office
District I - (575) 393-6161
1625 N. French Dr., Hobbs, NM 88240
District II - (575) 748-1283
811 S. First St., Artesia, NM 88210
District III - (505) 334-6178
1000 Rio Brazos Rd., Aztec, NM 87410
District IV - (505) 476-3460
1220 S. St. Francis Dr., Santa Fe, NM
87505

State of New Mexico
Energy, Minerals and Natural Resources

Form C-103
October 13, 2009

RECEIVED
HOBBS
CONSERVATION DIVISION
1220 South St. Francis Dr.
Santa Fe, NM 87505
FEB 12 2013

SUNDRY NOTICES AND REPORTS ON WELLS (DO NOT USE THIS FORM FOR PROPOSALS TO DRILL OR TO DEEPEN OR PLUG BACK TO A DIFFERENT RESERVOIR. USE "APPLICATION FOR PERMIT" (FORM C-101) FOR SUCH PROPOSALS.)		WELL API NO. 30-025-25278
1. Type of Well: Oil Well <input type="checkbox"/> Gas Well <input checked="" type="checkbox"/> Other <input type="checkbox"/> Dry Hole		5. Indicate Type of Lease STATE <input checked="" type="checkbox"/> FEE <input type="checkbox"/>
2. Name of Operator Primero Operating, Inc.		6. State Oil & Gas Lease No. LG - 2616
3. Address of Operator PO Box 1433, Roswell, NM 88202-1433		7. Lease Name or Unit Agreement Name Amoco State
4. Well Location Unit Letter I : 1980 feet from the South line and 460 feet from the E line Section 36 Township 16S Range 32E NMPM Lea County		8. Well Number 1
11. Elevation (Show whether DR, RKB, RT, GR, etc.) 4249 GL		9. OGRID Number 018100
		10. Pool name or Wildcat Maljamar, Grayburg, SA

12. Check Appropriate Box to Indicate Nature of Notice, Report or Other Data

NOTICE OF INTENTION TO:

PERFORM REMEDIAL WORK ☐ PLUG AND ABANDON ☐
TEMPORARILY ABANDON ☐ CHANGE PLANS ☐
PULL OR ALTER CASING ☐ MULTIPLE COMPL ☐
DOWNHOLE COMMINGLE ☐

SUBSEQUENT REPORT OF:

REMEDIAL WORK ☐ ALTERING CASING ☐
COMMENCE DRILLING OPNS. ☐ P AND A ☐
CASING/CEMENT JOB ☐

OTHER: ☐

OTHER: Correct Dry Hole Marker ☒

13. Describe proposed or completed operations. (Clearly state all pertinent details, and give pertinent dates, including estimated date of starting any proposed work). SEE RULE 19.15.7.14 NMAC. For Multiple Completions: Attach wellbore diagram of proposed completion or recompletion.

Persuant to Letter of Violation letter Dated 3/23/2011 we have added the API# to the dry hole marker. The cellar and rathole were filled in and the old anchors on the location were removed.

NOTE: The Letter of Violation letter indicates that the dry hole marker is on the wrong hole but it is actually on the correct hole. There may be some confusion based on two different surveys.

Spud Date:

Rig Release Date:

I hereby certify that the information above is true and complete to the best of my knowledge and belief.

SIGNATURE

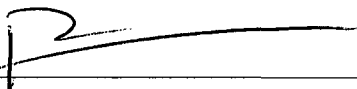

TITLE

President

DATE

2/8/2013

Type or print name Phelps White

E-mail address: pwiv@zianet.com

PHONE: 575 626 7660

For State Use Only

APPROVED BY:

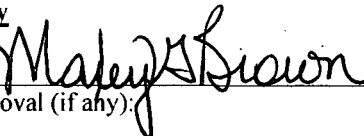

TITLE

Compliance Officer

DATE

2/18/2013

Conditions of Approval (if any):

Attachement to C-103s dated 2/8/13

PRIMERO OPERATING INC
PO BOX 1433
ROSWELL, NM 88202

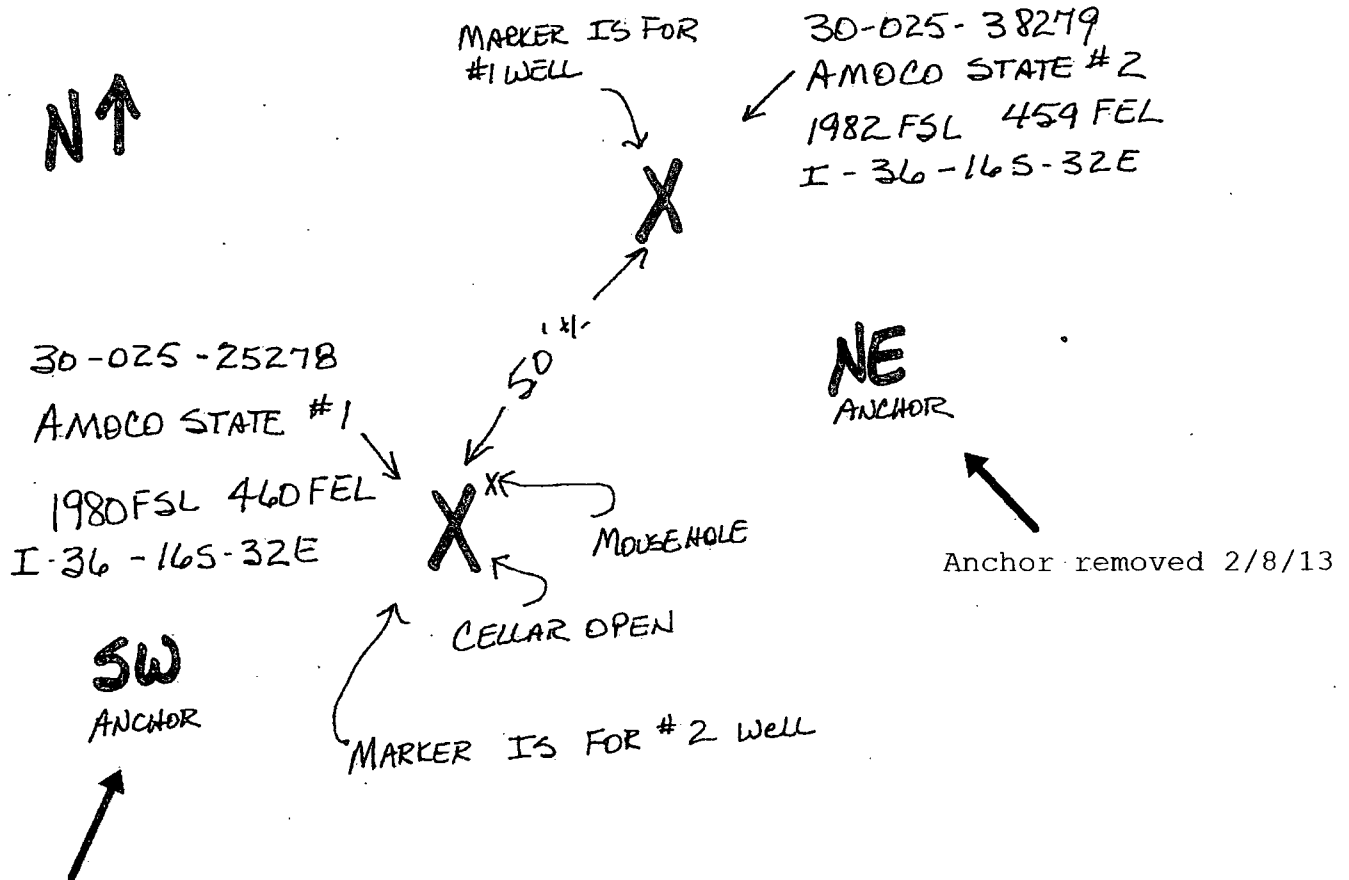

Anchor removed 2/8/13

NOTE: Letter of Violation dated 3/23/13 stated that the markers were on the wrong locations. The markers are on the correct locations the #1 well IS NE of the #2 well. It is confusing due to different surveys on different dates.

Maley Brown
COMPLIANCE OFFICER