

Submit 1 Copy To Appropriate District Office

District I - (575) 393-6161  
1625 N. French Dr., Hobbs, NM 88240  
District II - (575) 748-1283  
811 S. First St., Artesia, NM 88210  
District III - (505) 334-6178  
1000 Rio Brazos Rd., Aztec, NM 87410  
District IV - (505) 476-3460  
1220 S. St. Francis Dr., Santa Fe, NM 87505

State of New Mexico  
Energy, Minerals and Natural Resources

Form C-103  
October 13, 2009

HOBBS OCD

OIL CONSERVATION DIVISION

1220 South St. Francis Dr.  
Santa Fe, NM 87505

FEB 12 2013

RECEIVED

WELL API NO. 30-025-38279
5. Indicate Type of Lease STATE <input checked="" type="checkbox"/> FEE <input type="checkbox"/>
6. State Oil & Gas Lease No. LG - 2616
7. Lease Name or Unit Agreement Name Amoco State
8. Well Number 2
9. OGRID Number 018100
10. Pool name or Wildcat Maljamar, Grayburg, SA

SUNDRY NOTICES AND REPORTS ON WELLS  
(DO NOT USE THIS FORM FOR PROPOSALS TO DRILL OR TO DEEPEN OR PLUG BACK TO A DIFFERENT RESERVOIR. USE "APPLICATION FOR PERMIT" (FORM C-101) FOR SUCH PROPOSALS.)

1. Type of Well: Oil Well ☐ Gas Well ☒ Other ☐ Dry Hole

2. Name of Operator  
Primero Operating, Inc.

3. Address of Operator  
PO Box 1433, Roswell, NM 88202-1433

4. Well Location  
Unit Letter I : 1982 feet from the South line and 510 feet from the E line  
Section 36 Township 16S Range 32E NMPM Lea County

11. Elevation (Show whether DR, RKB, RT, GR, etc.)  
4249 GL

12. Check Appropriate Box to Indicate Nature of Notice, Report or Other Data

NOTICE OF INTENTION TO:

PERFORM REMEDIAL WORK ☐ PLUG AND ABANDON ☐  
TEMPORARILY ABANDON ☐ CHANGE PLANS ☐  
PULL OR ALTER CASING ☐ MULTIPLE COMPL ☐  
DOWNHOLE COMMINGLE ☐

OTHER: ☐

SUBSEQUENT REPORT OF:

REMEDIAL WORK ☐ ALTERING CASING ☐  
COMMENCE DRILLING OPNS. ☐ P AND A ☐  
CASING/CEMENT JOB ☐

OTHER: Correct Dry Hole Marker ☒

13. Describe proposed or completed operations. (Clearly state all pertinent details, and give pertinent dates, including estimated date of starting any proposed work). SEE RULE 19.15.7.14 NMAC. For Multiple Completions: Attach wellbore diagram of proposed completion or recompletion.

Persuant to Letter of Violation letter Dated 3/23/2011 we have added the API# to the dry hole marker.

NOTE: The Letter of Violation letter indicates that the dry hole marker is on the wrong hole but it is actually on the correct hole. There may be some confusion based on two different surveys.

Spud Date:

Rig Release Date:

I hereby certify that the information above is true and complete to the best of my knowledge and belief.

SIGNATURE

TITLE President

DATE 2/8/2013

Type or print name Phelps White

E-mail address: pwiv@zianet.com

PHONE: 575 626 7660

For State Use Only

APPROVED BY:

TITLE Compliance Officer

DATE 2/18/2013

Conditions of Approval (if any):

Attachement to C-103s dated 2/8/13

PRIMERO OPERATING INC  
PO BOX 1433  
ROSWELL, NM 88202

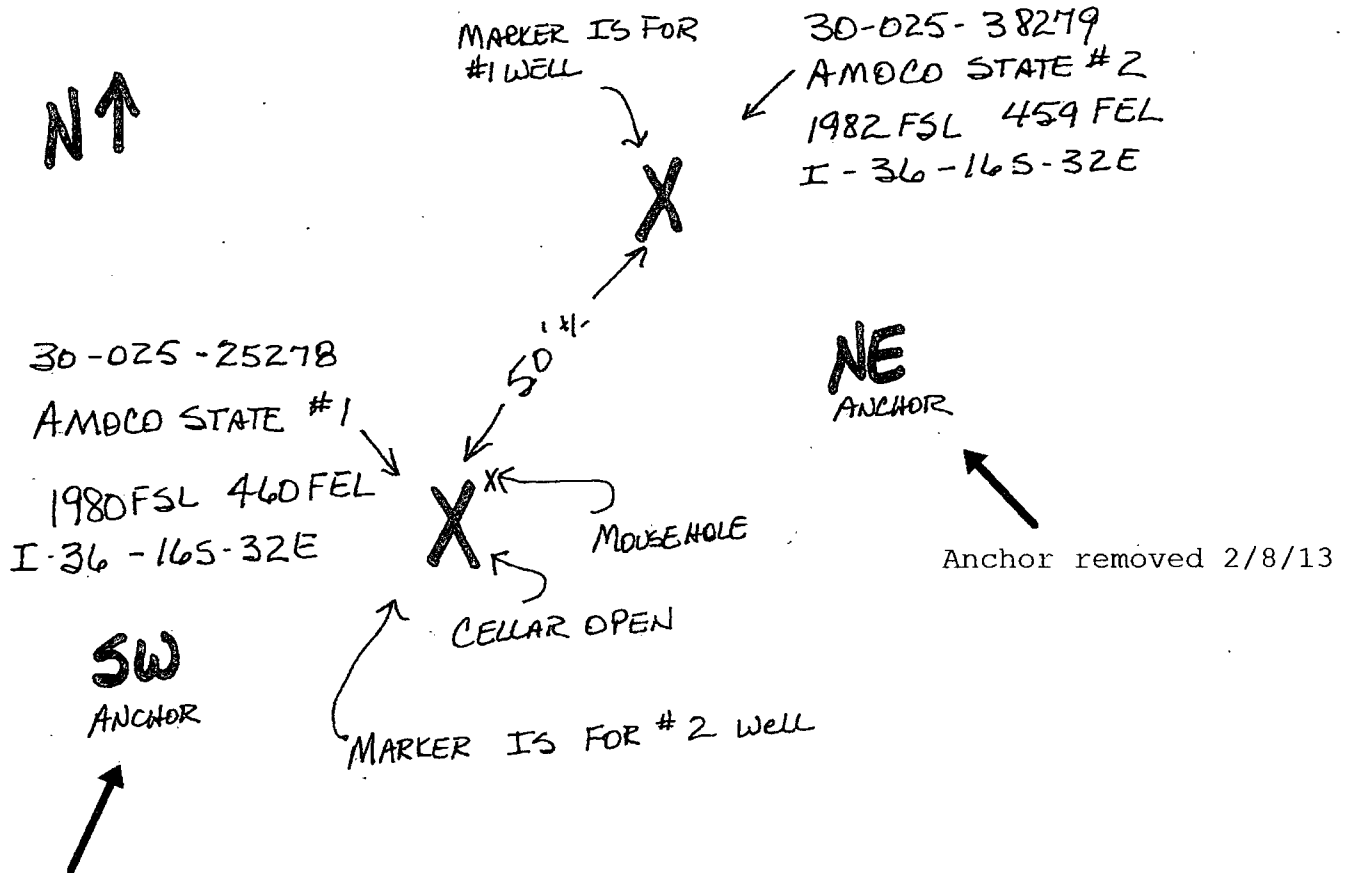

Anchor removed 2/8/13

NOTE: Letter of Violation dated 3/23/13 stated that the markers were on the wrong locations. The markers are on the correct locations the #1 well IS NE of the #2 well. It is confusing due to different surveys on different dates.

*Mateo Brown*  
COMPLIANCE OFFICER