

Submit 1 Copy To Appropriate District Office  
District I - (575) 393-6161  
1625 N. French Dr., Hobbs, NM 88240  
District II - (575) 748-1283  
811 S. First St., Artesia, NM 88210  
District III - (505) 334-6178  
1000 Rio Brazos Rd., Aztec, NM 87410  
District IV - (505) 476-3460  
1220 S. St. Francis Dr., Santa Fe, NM 87505

State of New Mexico  
Energy, Minerals and Natural Resources

OIL CONSERVATION DIVISION  
1220 South St. Francis Dr.  
Santa Fe, NM 87505

Form C-103  
Revised August 1, 2011

<b>SUNDRY NOTICES AND REPORTS ON WELLS</b> (DO NOT USE THIS FORM FOR PROPOSALS TO DRILL OR TO DEEPEN OR PLUG BACK TO A DIFFERENT RESERVOIR. USE "APPLICATION FOR PERMIT" (FORM C-101) FOR SUCH PROPOSALS.)		WELL API NO. <b>30-025-29324</b>
1. Type of Well: Oil Well <input checked="" type="checkbox"/> Gas Well <input type="checkbox"/> Other <input type="checkbox"/>		5. Indicate Type of Lease STATE <input checked="" type="checkbox"/> FEE <input type="checkbox"/>
2. Name of Operator: <b>DEVON ENERGY COMPANY, LP</b>		6. State Oil & Gas Lease No.
3. Address of Operator: <b>PO BOX 250 ARTESIA, NM 88211</b>		7. Lease Name or Unit Agreement Name ARCO STATE
4. Well Location Unit Letter <b>E</b> : <b>2310'</b> feet from the <b>NORTH</b> line and <b>930'</b> feet from the <b>WEST</b> line Section <b>35</b> Township <b>15S</b> Range <b>36E</b> NMPM County <b>LEA</b>		8. Well Number <b>1Y</b>
11. Elevation (Show whether DR, RKB, RT, GR, etc.) <b>3881'KB; 3861.5' GL; 19.5' KB to GL</b>		9. OGRID Number <b>6137</b>
		10. Pool name or Wildcat : DEAN;PERMO UPPER PENN

12. Check Appropriate Box to Indicate Nature of Notice, Report or Other Data

NOTICE OF INTENTION TO:

PERFORM REMEDIAL WORK ☐ PLUG AND ABANDON ☐  
TEMPORARILY ABANDON ☐ CHANGE PLANS ☐  
PULL OR ALTER CASING ☐ MULTIPLE COMPL ☐  
DOWNHOLE COMMINGLE ☐

OTHER: ☐

SUBSEQUENT REPORT OF:

REMEDIAL WORK ☐ ALTERING CASING ☐  
COMMENCE DRILLING OPNS. ☐ P AND A ☐  
CASING/CEMENT JOB ☐

OTHER: **Location & Pit Reclamation** ☒

13. Describe proposed or completed operations. (Clearly state all pertinent details, and give pertinent dates, including estimated date of starting any proposed work). SEE RULE 19.15.7.14 NMAC. For Multiple Completions: Attach wellbore diagram of proposed completion or recompletion.

Actions Taken:

- Devon Energy had contracted Talon/LPE to do reclamation activities at the Arco 1Y, a P&A location.
- The location, pasture and closed drilling pit were reclaimed per Landowner request. Due to high chlorides leaching to the surface in the closed drilling pit and an area of pasture they were excavated to a depth of 4-feet deep and 20 mil liners were installed.
- The impacted soil was transported to Lea Land, LLC.
- 4-feet of top soil was obtained from the landowner and placed over both liners. Once the caliche was removed from the location, top soil was used per farmer's request. He will use the land to grow his alfalfa.
- The caliche from the location was used for road repair. The drilling pit, pasture and location were re-contoured to match the surrounding terrain.
- No further actions are required.

Spud Date:

Rig Release Date:

I hereby certify that the information above is true and complete to the best of my knowledge and belief.

SIGNATURE Denise Menoud TITLE Field Admin Support DATE 7/29/15

Type or print name DENISE MENOUD E-mail address: denise.menoud@dmn.com PHONE: 575-746-5544

For State Use Only

APPROVED BY: **Accepted for Record Only** TITLE \_\_\_\_\_ DATE 8/5/2015

AUG 06 2015

ym

**ARCO 1Y**  
**\* 30-015-29324 \***

2015

Lab data and on site field titration testing for chlorides

12/16/2014., see site maps

- Sample point S-1 was excavated to at least to a depth of 2.5-feet with field titration to guide the excavation.
- Sample point S-2 was clean.
- Sample point S-3 was excavated to a depth of 2.5-feet with field titration.
- Sample point S-4 should be excavated to a depth of 2-feet.
- Sample point S-5 was excavated to a depth of 3-feet. This area was tested with a PID meter to guide the excavation.

**Laboratory Results**

The complete report is attached.

Sample ID	Depth (feet)	BTEX (mg/kg)	Chlorides (mg/kg)	TPH (mg/kg) GRO	TPH (mg/kg) DRO
S-1	0'	<0.300	7060	<10	<10
	1'	<0.300	1090	<10	<10
Refusal	1.5'	<0.300	2720	<10	<10
S-2	0'	<0.300	16	<10	<10
	1'	<0.300	<16	<10	<10
	2'	<0.300	<16	<10	<10
S-3	0'	<0.300	352	<10	<10
	1'	<0.300	3560	<10	14.4
Refusal	1.5'	<0.300	1040	<10	<10
S-4	0'	<0.300	384	<200	1890
	1'	<3.00	464	239	5460
	2'	<0.300	704	<10	137
	3'	<0.300	80	<50	260
S-5	0'	<1.20	880	144	16500
Refusal	0.5'	<1.20	64	173	9210

jm

**ARCO 1Y**  
**\* 30-015-29324 \***

2015

6/18/2015, see site maps

My field titration testing results for chlorides were as follows:

Sample ID	Depth	Chlorides (mg/kg)
P-1	0'	7161
	1'	3616
	2'	5672
P-2	0'	4112
	1'	3191
	2'	5743
P-3	0'	780
	1'	1489
	2'	1489
D-1	0'	23600
	1'	21800
	2'	16400
	3'	9100
	4'	5112
D-2	0'	25200
	1'	11210
	2'	8320
	3'	9589
	4'	10010
D-3	0'	24000
	1'	15200
	2'	14320
	3'	9600
	4'	12600

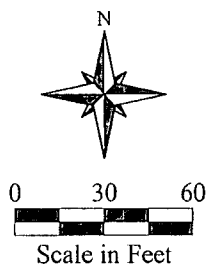
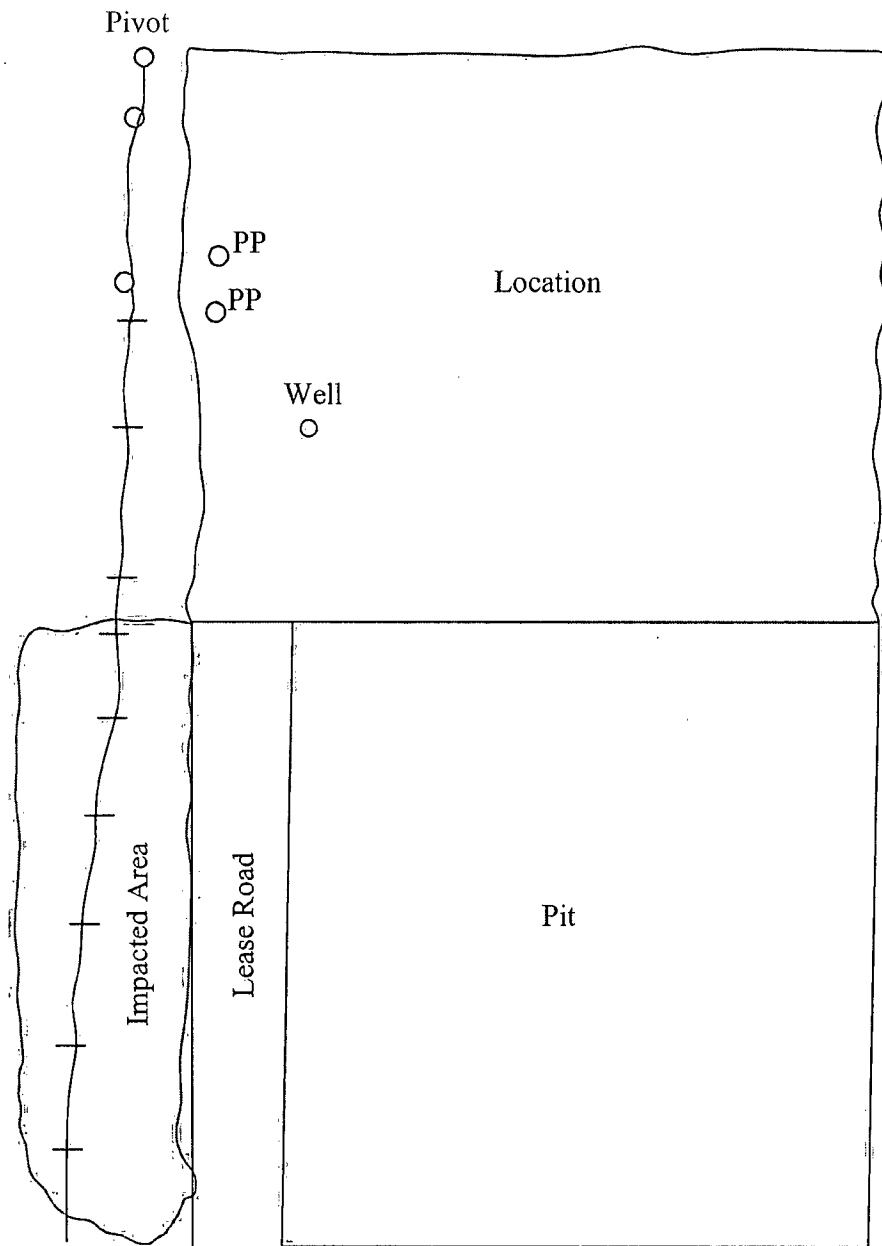

Date: 07/23/2015

Scale: 1" = 60'

Drawn By: TJS

Arco State 1Y  
Devon Energy Corporation  
Lea County, New Mexico  
Figure 1 - Site Plan

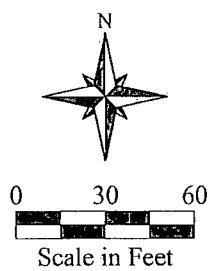
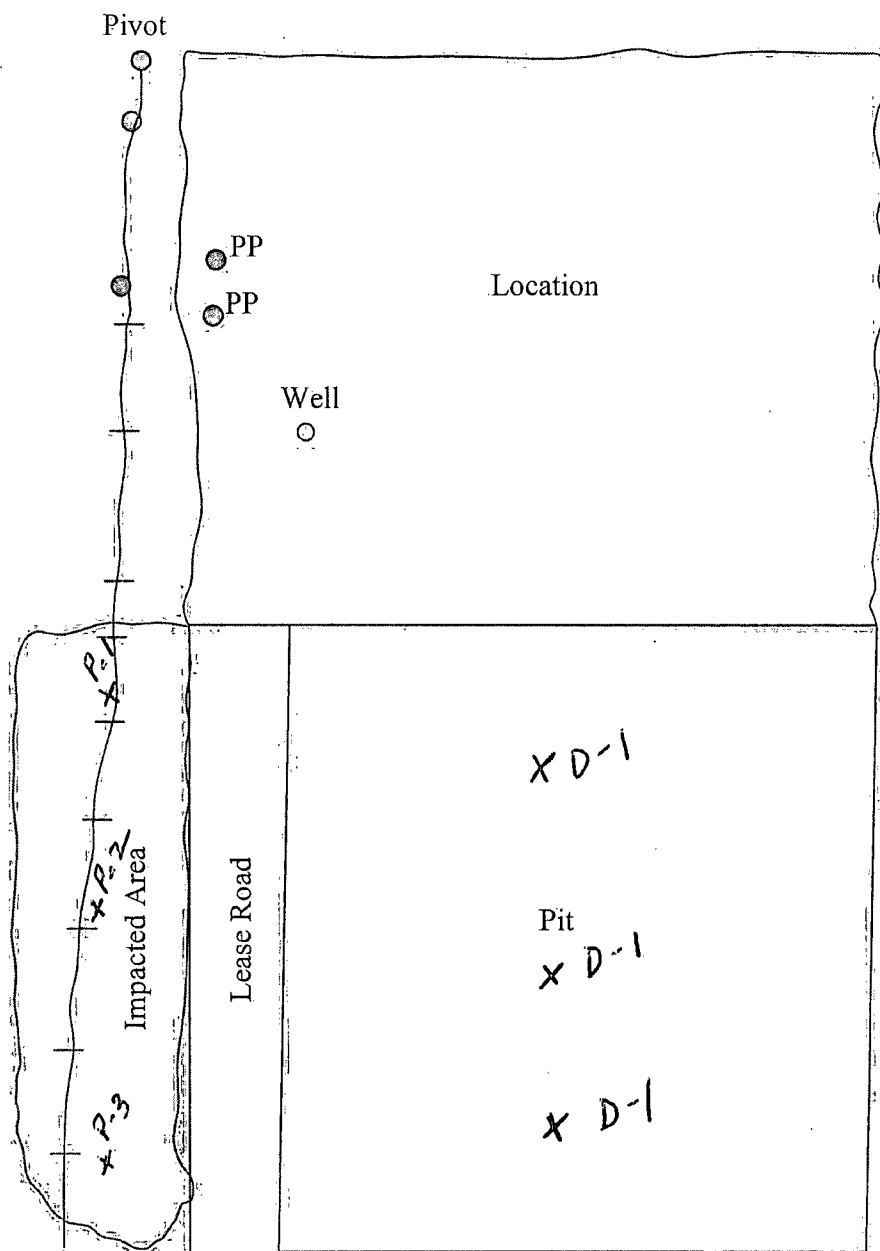

Date: 07/23/2015

Scale: 1" = 60'

Drawn By: TJS

Arco State 1Y  
 Devon Energy Corporation  
 Lea County, New Mexico  
 Figure 1 - Site Plan

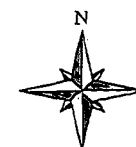

0 15 30  
Scale in Feet

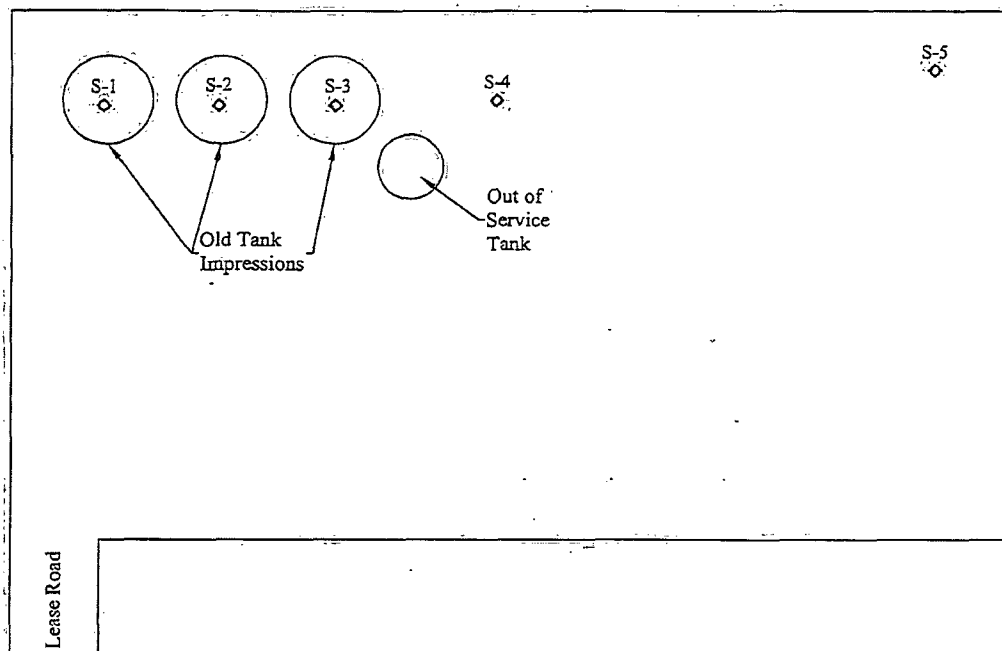

Legend  
- Sample Location



Date: 12/10/2014

Scale: 1" = 30'

Drawn By: TJS

Arco State 1Y  
Devon Energy Corporation  
Lea County, New Mexico  
Figure 1 - Site Plan

## Menoud, Denise

---

**From:** Kimberly M. Wilson <kwilson@talonlpe.com>  
**Sent:** Tuesday, July 28, 2015 12:02 PM  
**To:** Menoud, Denise; Fulks, Brett  
**Cc:** Kidd, Aaron; David Adkins  
**Subject:** Arco 1Y \* 30-025-29324 \* P&A location  
**Attachments:** Arco site map.pdf; Aroc 1Y sub sub PA c103.pdf; Arco 1Y notes.pdf; Arco 1Y sub C-103.pdf; Arco 1Y old site maps with sample loc..pdf

Good Afternoon All,

Please find the Closure report for the above location. The C-103's need signatures and filed with the NMOCD Hobbs office attention Maxey Brown. The notes are for your files along with the site map with the sample locations on it.

If you have any questions or concerns please feel free to contact me.

Thank you. I appreciated your business.

Respectfully submitted,

Kimberly

*Kimberly M. Wilson*

*Project Manager*

*TALON/LPE*

*408 W. Texas*

*Artesia, NM 88210*

*Direct: 575-616-4023*

*Cell: 575-602-3826*

*Office: 575-746-8768*

*Emergancy: 866-*

*Email: kwilson@talonlpe.com*

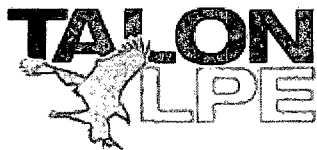

Better Business Bureau Torch Award for Marketplace Ethics: 2010 Winner, 2009 Finalist

Staples Foundation for Learning Hall of Fame Recipient: 2010

ICIC and Business Week- Top 100: 2010, 2009, 2008, 2007, 2006

Inc. 500/5000: 2012, 2011, 2010, 2009, 2008, 2007