

Submit 3 Copies To Appropriate District Office

District I

1625 N. French Dr., Hobbs, NM 88240

District II

1301 W. Grand Ave., Artesia, NM 88210

District III

1000 Rio Brazos Rd., Aztec, NM 87410

District IV

1220 S. St. Francis Dr., Santa Fe, NM 87505

State of New Mexico  
Energy, Minerals and Natural Resources

OIL CONSERVATION DIVISION  
1220 South St. Francis Dr.  
Santa Fe, NM 87505

Form C-103

May 27, 2004

WELL API NO.

30-025-37577

5. Indicate Type of Lease

STATE ☒ FEE ☐

6. State Oil & Gas Lease No.

A-1573

7. Lease Name or Unit Agreement Name

State G 33

8. Well Number

#1

9. OGRID Number

113315

10. Pool name or Wildcat

Hobbs Upper Blinbry

**SUNDRY NOTICES AND REPORTS ON WELLS**  
(DO NOT USE THIS FORM FOR PROPOSALS TO DRILL OR TO DEEPEN OR PLUG BACK TO A DIFFERENT RESERVOIR. USE "APPLICATION FOR PERMIT" (FORM C-101) FOR SUCH PROPOSALS.)

1. Type of Well: Oil Well ☒ Gas Well ☐ Other

2. Name of Operator

Texland Petroleum-Hobbs, LLC

3. Address of Operator

777 Main Street, Suite 3200, Fort Worth, Texas 76102

4. Well Location

Unit Letter E : 1680' feet from the North line and 660' feet from the West line  
Section 33 Township 18S Range 38E NMPM Lea County NM

11. Elevation (Show whether DR, RKB, RT, GR, etc.)

3642' GL

Pit or Below-grade Tank Application ☐ or Closure ☐

Pit type \_\_\_\_\_ Depth to Groundwater \_\_\_\_\_ Distance from nearest fresh water well \_\_\_\_\_ Distance from nearest surface water \_\_\_\_\_

Pit Liner Thickness: \_\_\_\_\_ mill \_\_\_\_\_ Below-Grade Tank: Volume \_\_\_\_\_ bbls; Construction Material \_\_\_\_\_

12. Check Appropriate Box to Indicate Nature of Notice, Report or Other Data

NOTICE OF INTENTION TO:

PERFORM REMEDIAL WORK ☐ PLUG AND ABANDON ☐  
TEMPORARILY ABANDON ☐ CHANGE PLANS ☐  
PULL OR ALTER CASING ☐ MULTIPLE COMPL ☐

OTHER: ☐

SUBSEQUENT REPORT OF:

REMEDIAL WORK ☐ ALTERING CASING ☐  
COMMENCE DRILLING OPNS. ☐ P AND A ☐  
CASING/CEMENT JOB ☐

OTHER: ☒ skid location

13. Describe proposed or completed operations. (Clearly state all pertinent details, and give pertinent dates, including estimated date of starting any proposed work). SEE RULE 1103. For Multiple Completions: Attach wellbore diagram of proposed completion or recompletion.

Please find attached an original "amended" C-102 for the above captioned well.  
The footage was skidded 100' north due to a gas line.

initial plat: 1780' FNL & 660' FWL of Sec. 33, T18S, R38E

amended plat: 1680' FNL & 660' FWL of Sec. 33, T18S, R38E

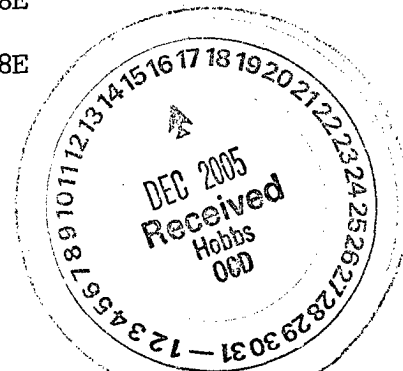

I hereby certify that the information above is true and complete to the best of my knowledge and belief. I further certify that any pit or below-grade tank has been/will be constructed or closed according to NMOC guidelines ☐, a general permit ☐ or an (attached) alternative OCD-approved plan ☐.

SIGNATURE Vickie Smith TITLE Production Analyst DATE 12/13/05

Type or print name Vickie Smith

For State Use Only

E-mail address: vsmith@texpetro.com Telephone No. 817-336-2751

DEC 21 2005

APPROVED BY: [Signature] TITLE PETROLEUM ENGINEER DATE \_\_\_\_\_

DISTRICT I  
1625 N. French Dr., Hobbs, NM 88240  
DISTRICT II  
811 South First, Artesia, NM 88210

DISTRICT III  
1000 Rio Brazos Rd., Aztec, NM 87410

DISTRICT IV  
2040 South Pacheco, Santa Fe, NM 87505

State of New Mexico  
Energy, Minerals and Natural Resources Department

Form C-102  
Revised March 17, 1999

OIL CONSERVATION DIVISION

2040 South Pacheco  
Santa Fe, New Mexico 87504-2088

DEC 2005  
Received  
Hobbs  
OCD

Submit to Appropriate District Office  
State Lease - 4 Copies  
Fee Lease - 3 Copies

AMENDED REPORT

WELL LOCATION AND ACREAGE DEDICATION PLAT

API Number 30-025-37577	Pool Code	Pool Name Hobbs Upper Blinebry
Property Code 35274	Property Name STATE "G" 33	Well Number 1
OGRID No. 113315	Operator Name TEXLAND PETROLEUM, INC.	Elevation 3642'

Surface Location

UL or lot No. E	Section 33	Township 18-S	Range 38-E	Lot Idn	Feet from the 1680	North/South line NORTH	Feet from the 660	East/West line WEST	County LEA
--------------------	---------------	------------------	---------------	---------	-----------------------	---------------------------	----------------------	------------------------	---------------

Bottom Hole Location If Different From Surface

UL or lot No.	Section	Township	Range	Lot Idn	Feet from the	North/South line	Feet from the	East/West line	County
Dedicated Acres 40	Joint or Infill	Consolidation Code	Order No.						

NO ALLOWABLE WILL BE ASSIGNED TO THIS COMPLETION UNTIL ALL INTERESTS HAVE BEEN CONSOLIDATED  
OR A NON-STANDARD UNIT HAS BEEN APPROVED BY THE DIVISION

<div><div>1680'</div><div>660'</div><div>LAT. 32°42'23.6"N LONG. 103°09'33.8"W NAD 27 Texland et al A-1573</div></div>						<div><div>OPERATOR CERTIFICATION</div><div>I hereby certify the the information contained herein is true and complete to the best of my knowledge and belief.</div><div>Vickie Smith</div><div>Signature</div><div>Vickie Smith</div><div>Printed Name</div><div>Production Analyst</div><div>Title</div><div>12/13/05</div><div>Date</div></div>
						<div><div>SURVEYOR CERTIFICATION</div><div>I hereby certify that the well location shown on this plat was plotted from field notes of actual surveys made by me or under my supervision, and that the same is true and correct to the best of my belief.</div><div>NOVEMBER 28, 2005</div><div>Date Surveyed</div><div>Signature of Gary L. Jones</div><div>Professional Surveyor</div><div>W.O. No. 6005</div><div>Certificate No. Gary L. Jones 7977</div><div>PROFESSIONAL LAND SURVEYOR</div><div>BASIN SURVEYS</div></div>

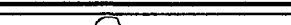
 <p>P.O. Box 1786 1120 West County Rd. Hobbs, New Mexico 88241 (505) 393-7316 - Office (505) 392-2206 - Fax basinsurveys.com</p>	W.O. Number: C:\DRAWINGS\TEXLAND\TXLND-6005-2	<p><b>TEXLAND PETROLEUM, INC.</b></p>
	Survey Date: NOVEMBER 28, 2005	
	SCALE: 1"=2000'	
	Date: NOVEMBER 29, 2005	

SECTION 33, TOWNSHIP 18 SOUTH, RANGE 38 EAST, N.M.P.M.  
LEA COUNTY, NEW MEXICO

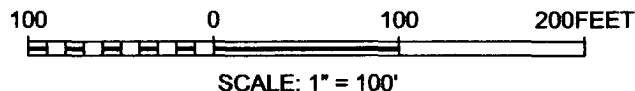
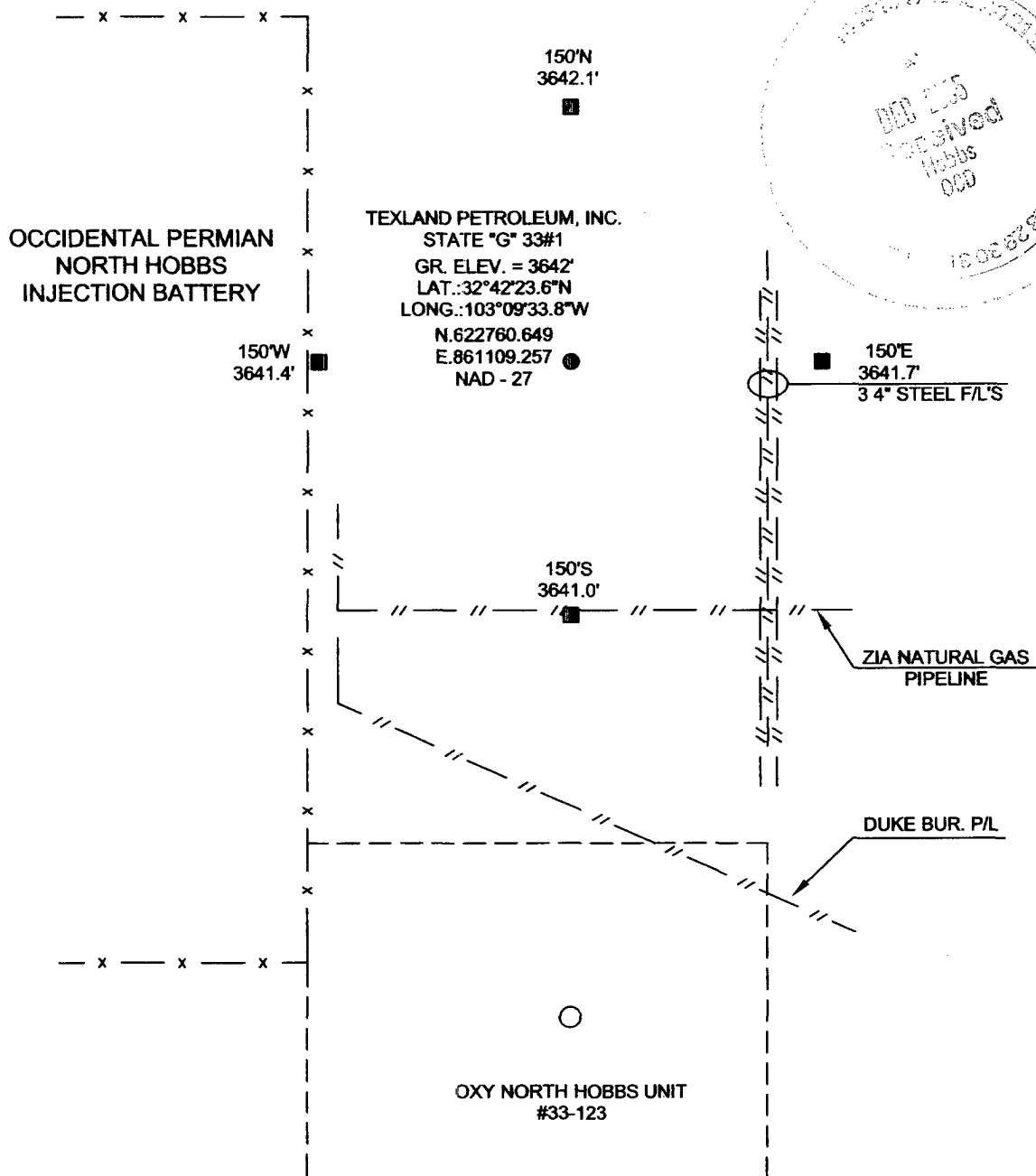

DIRECTIONS TO LOCATION:

FROM THE INTERSECTION OF GRIMES AND SANGER STREETS IN HOBBS, NEW MEXICO GO WEST ON SANGER STREET APPROX. 1.0 MILES, THEN TURN SOUTH ON A LEASE ROAD APPROX. 0.3 MILES TO THE OCCIDENTAL PERMIAN NORTH HOBBS INJECTION BATTERY. LOCATION IS ON THE EAST SIDE OF FENCE.

**BASIN SURVEYS** P.O. BOX 1786 -HOBBS, NEW MEXICO

W.O. Number: 6005

Drawn By: S.STANFIELD

Date: 11-29-2005

Disk: C:\DRAWINGS\TEXLAND\TXLND-6005-1

**TEXLAND PETROLEUM, INC**

STATE "G" 33 No.1

STATE "G" 33 No. 1 LOCATED  
1680' F.N.L. & 660' F.W.L., SECTION 33,  
TOWNSHIP 18 SOUTH, RANGE 38 EAST, N.M.P.M.  
LEA COUNTY, NEW MEXICO

Survey Date: 11-28-2005

Sheet 1 of 1 Sheets

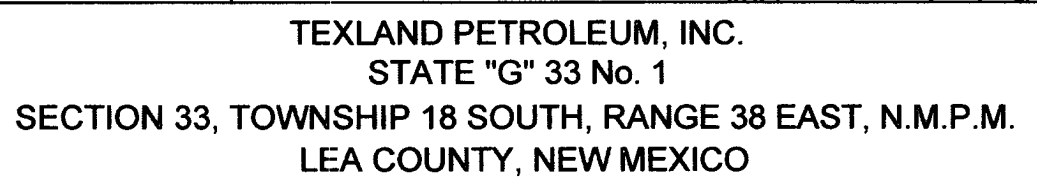
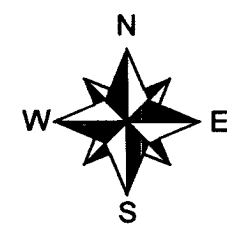

TEXLAND  
PETROLEUM, INC.