

UNITED STATES
DEPARTMENT OF THE INTERIOR
BUREAU OF LAND MANAGEMENTFORM APPROVED
OMB No. 1004-0137
Expires: March 31, 2007**SUNDRY NOTICES AND REPORTS ON WELLS****Do not use this form for proposals to drill or to re-enter an abandoned well. Use Form 3160-3 (APD) for such proposals.****SUBMIT IN TRIPLICATE- Other instructions on reverse side.**1. Type of Well
☐ Oil Well ☒ Gas Well ☐ Other2. Name of Operator **CHESAPEAKE OPERATING, INC. ATTN: LINDA GOOD**3a. Address
P.O. BOX 18496, OKLAHOMA CITY, OK 73154-04963b. Phone No. (include area code)
405-767-4275

4. Location of Well (Footage, Sec., T., R., M., or Survey Description)

**990 FNL 330 FEL NENE SEC 14-20S-35E
16 70**

5. Lease Serial No.

NMNM 16835

6. If Indian, Allottee or Tribe Name

7. If Unit or CA/Agreement, Name and/or No.

8. Well Name and No.

NEUHAUS 14 FEDERAL 5

9. API Well No.

30-025-37351

10. Field and Pool, or Exploratory Area

FEATHERSTONE EAST

11. County or Parish, State

LEA COUNTY, NM**12. CHECK APPROPRIATE BOX(ES) TO INDICATE NATURE OF NOTICE, REPORT, OR OTHER DATA**

TYPE OF SUBMISSION	TYPE OF ACTION			
<input type="checkbox"/> Notice of Intent	<input type="checkbox"/> Acidize	<input type="checkbox"/> Deepen	<input type="checkbox"/> Production (Start/Resume)	<input type="checkbox"/> Water Shut-Off
<input checked="" type="checkbox"/> Subsequent Report	<input type="checkbox"/> Alter Casing	<input type="checkbox"/> Fracture Treat	<input type="checkbox"/> Reclamation	<input type="checkbox"/> Well Integrity
<input type="checkbox"/> Final Abandonment Notice	<input type="checkbox"/> Casing Repair	<input type="checkbox"/> New Construction	<input type="checkbox"/> Recomplete	<input checked="" type="checkbox"/> Other PIPELINE
	<input type="checkbox"/> Change Plans	<input type="checkbox"/> Plug and Abandon	<input type="checkbox"/> Temporarily Abandon	
	<input type="checkbox"/> Convert to Injection	<input type="checkbox"/> Plug Back	<input type="checkbox"/> Water Disposal	

13. Describe Proposed or Completed Operation (clearly state all pertinent details, including estimated starting date of any proposed work and approximate duration thereof. If the proposal is to deepen directionally or recomple horizontally, give subsurface locations and measured and true vertical depths of all pertinent markers and zones. Attach the Bond under which the work will be performed or provide the Bond No. on file with BLM/BIA. Required subsequent reports shall be filed within 30 days following completion of the involved operations. If the operation results in a multiple completion or recompletion in a new interval, a Form 3160-4 shall be filed once testing has been completed. Final Abandonment Notices shall be filed only after all requirements, including reclamation, have been completed, and the operator has determined that the site is ready for final inspection.)

We are having problems with Duke's pipeline. Chesapeake Operating, Inc. is proposing to have Targa Gas lay approximately .20 miles 3 inch Poly SBR 11 pipeline from the Devon Energy Production Co Federal AG Com 1 well to Chesapeakes Neuhaus 14 Fed 4 well. The Chesapeake Neuhaus 14 Fed 5 will be metered at the Neuhaus 14 Fed 4. The two Chesapeake wells are located on the same lease. Targa Gas will obtain any necessary Right-of-Ways. Chesapeake Operating, Inc. is requesting permission to meter the Neuhaus 14 Fed 5 at the Neuhaus 14 Fed 4.

BLM Nationwide Bond NM 2634.

(CHK PN 891566)

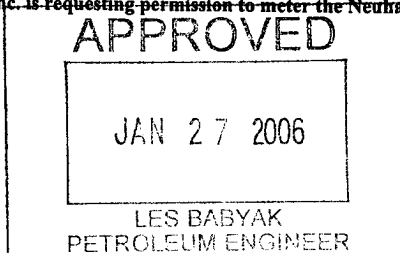

14. I hereby certify that the foregoing is true and correct
Name (Printed/Typed)

LINDA GOODTitle **PERMITTING AGENT**

Signature

Linda Good

Date

01/17/2006**THIS SPACE FOR FEDERAL OR STATE OFFICE USE**

Approved by

Conditions of approval, if any, are attached. Approval of this notice does not warrant or certify that the applicant holds legal or equitable title to those rights in the subject lease which would entitle the applicant to conduct operations thereon.

Title

Date

Office

Title 18 U.S.C. Section 1001 and Title 43 U.S.C. Section 1212, make it a crime for any person knowingly and willfully to make to any department or agency of the United States any false, fictitious or fraudulent statements or representations as to any matter within its jurisdiction.

(Instructions on page 2)

KZ

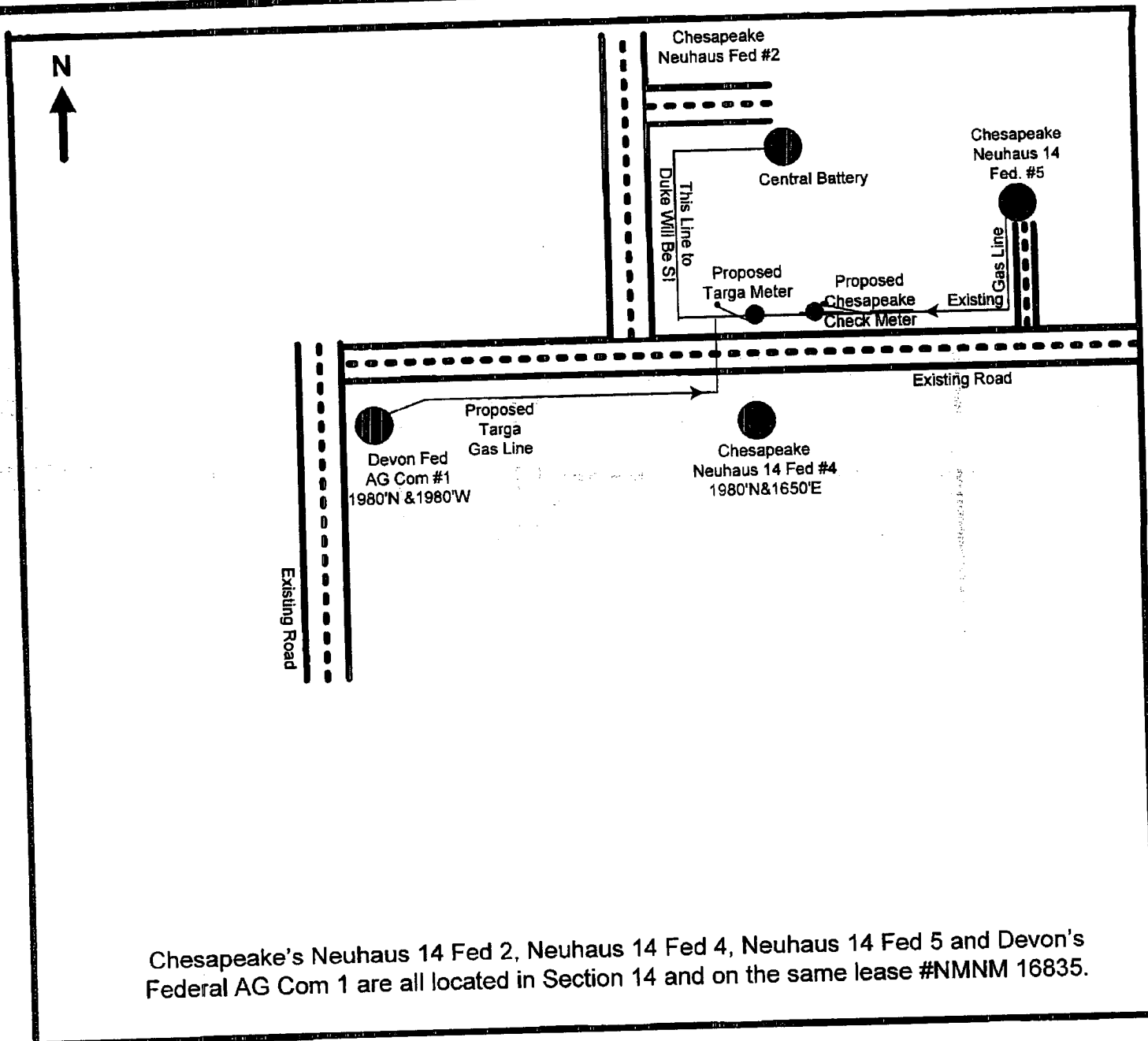
CHESAPEAKE OPERATING, INC.**NEUHAUS 14 FEDERAL 5
14-20S-35E
LEA COUNTY, NEW MEXICO**

NEUHAUS 14 FEDERAL #5 819566

Prepared by: DEBBIE HERNANDEZ
Date: 1-26-2006

Approved by:
Date: